



MODEL 50-20
MODEL 50-30

CHIP-LOK® JR.
COB ARRAY HOLDER

FEATURES/BENEFITS:



- METAL HOLDER BASE IS RESISTANT TO CREEP TO PREVENT THERMAL AND ELECTRICAL ISSUES TYPICAL AT ELEVATED OPERATING TEMPERATURES OVER TIME
- COB HOLDING FEATURES SECURES ARRAY TO HOLDER FOR EASE OF INSTALLATION
- STAINLESS STEEL BODY PROVIDES ADDITIONAL HEAT SINKING PATHS TO ALLOW ARRAY TO RUN COOLER COMPARED WITH SCREWS AND PLASTIC HOLDERS.
- HOLDER ALLOWS FOR VARIABLE WIRE ROUTING OPTIONS.

ELECTRICAL:

VOLTAGE: CLASS 2/SELV

CURRENT: CLASS 2/SELV

MECHANICAL:

DIAMETER: 1.378 in (35 mm)
 HEIGHT: 0.131 in (3.34mm)
 WEIGHT: .066 oz (1.87 g)
 SCREW SIZE: #4 or #5 (M3)
 SCREW TORQUE: 2.5-4.5 in-lb (0.3-0.5 Nm)
 SCREW CIRCLE DIA: 1.378 in (35mm) or 0.984 in (25mm)
 WIRE STRIP LENGTH: 3/16"-7/32" (5mm)

PHYSICAL:

BASE PLATE: 301 SS
 CONTACT HOUSING: THERMOPLASTIC
 ELECTRICAL CONTACTS: COPPER ALLOY
 PLATING: SILVER OVER NICKEL
 TEMPERATURE: 110°C
 RoHS AND REACH COMPLIANT HALOGEN FREE, NON-CHLORINATED & NON-BROMINATED FLAME RETARDENT

STANDARDS & SPECIFICATIONS:

RECOGNIZED COMPONENT UL 8754 (US/CANADA)
 ENEC-364-1000 (THERMAL CYCLING)
 EIA-364-31 (THERMAL SHOCK & HUMIDITY)
 EIA-364-17 (ELEVATED TEMPERATURE - LIFE)
 UL 2459 (CURRENT CYCLING - TEMP RISE)
 IEC 60068-2-7 (VIBRATION)
 US & FOREIGN PATENTS PENDING

WIRE RANGE:

	AWG (UL 496)	METRIC
SOLID	18-24 AWG	0,25 - 1,00 mm2
TIN BONDED	20-24 AWG	0,25 - 0,75 mm2
STRANDED	20-22 AWG	0,50 - 0,75 mm2

DIMENSIONS:

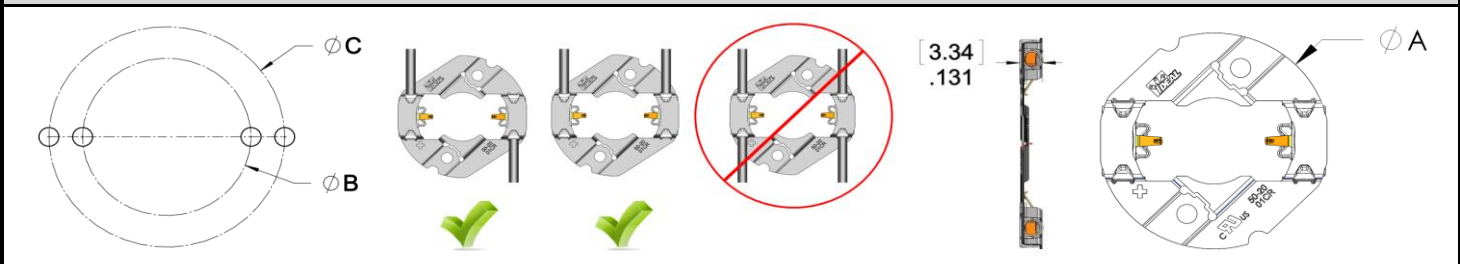

ORDERING INFO:

CATALOG #	MANUFACTURER	COB ARRAY	DIM. A in(mm)	DIM. B in(mm)	DIM. C in(mm)	CARTON QTY:	WEIGHT LBS (KG):
50-2002CT	CITIZEN	CLU02x	1.378 (35)	0.984 (25)	N/A	500	2.5 (1,1)
50-2000CR	CREE	CX_13	1.378 (35)	0.984 (25)	N/A	500	2.5 (1,1)
50-2001CR	CREE	CX_15	1.378 (35)	0.984 (25)	N/A	500	2.5 (1,1)
50-3001CR	CREE	CX_18	1.496 (38)	1.236 (31.4)	1.378 (35)	500	3.3 (1,5)
50-3002CR	CREE	CX_25	1.850 (47)	N/A	1.378 (35)	500	4.1 (1,8)
50-2002CT	EDISON	2PHM05/2PHM09	1.378 (35)	0.984 (25)	N/A	500	2.5 (1,1)
50-2002CT	LEXTAR	NIMBUS 1000	1.378 (35)	0.984 (25)	N/A	500	2.5 (1,1)
50-2000P	LUMILEDS	1202s	1.378 (35)	0.984 (25)	N/A	500	2.5 (1,1)
50-2002CT	SEOUL	SDWx1	1.378 (35)	0.984 (25)	N/A	500	2.5 (1,1)
50-2000P	NICHIA	S024	1.378 (35)	0.984 (25)	N/A	500	2.5 (1,1)
50-2000P	SHARP	MINI ZENIGATA	1.378 (35)	0.984 (25)	N/A	500	2.5 (1,1)

ORDERING INFO:

ENGINEERED SOLUTIONS
 IDEAL INDUSTRIES, INC.
 1375 PARK AVENUE SYCAMORE IL USA 60178
 P: 1-800-324-9571
 F: 1-888-222-6140
 E: oem@idealindustries.com

SALES CONTACT:



MODEL 50-21

CHIP-LOK® COB ARRAY HOLDER

FEATURES/BENEFITS:



- METAL HOLDER BASE IS RESISTANT TO CREEP TO PREVENT THERMAL AND ELECTRICAL ISSUES TYPICAL AT ELEVATED OPERATING TEMPERATURES OVER TIME
- COB HOLDING ARM SECURES ARRAY TO HOLDER FOR EASE OF INSTALLATION
- KEYWAYS ALLOW FOR PRE-INSTALLATION OF SCREWS TO EASE ASSEMBLY AND MINIMIZE DAMAGE TO PHOSPHOR
- TOUCH-SAFE DESIGN (ON SOME MODELS) IS UL RECOGNIZED FOR 250V TO ALLOW USE IN DAISY CHAINED APPLICATIONS
- STAINLESS STEEL BODY PROVIDES ADDITIONAL HEAT SINKING PATHS TO ALLOW ARRAY TO RUN COOLER COMPARED WITH SCREWS AND PLASTIC HOLDERS.

ELECTRICAL:

VOLTAGE: 250 V MAX (cUL)*
150 V MAX (ENEC)*

CURRENT: 4 A MAX (cUL)*
2 A MAX (ENEC)

*SEE ORDERING INFORMATION BELOW FOR EXCEPTIONS

MECHANICAL:

DIAMETER: 1.97 in (50.0 mm)

HEIGHT: 0.28 in (7.2 mm) MAX

WEIGHT: 0.28 oz (7.8 grams)

SCREW SIZE: #4 or #5 (M3)

SCREW TORQUE: 2.5-4.5 in-lb (0.3-0.5 Nm)

SCREW CIRCLE DIA: 1.38 in (35.0 mm)

WIRE STRIP LENGTH: 1/4"-5/16" (7 mm)

PHYSICAL:

BASE PLATE: 301 SS

CONTACT HOUSING: THERMOPLASTIC

ELECTRICAL CONTACTS: COPPER ALLOY

PLATING: SILVER OVER NICKEL

TEMPERATURE: 110°C

RoHS AND REACH COMPLIANT HALOGEN FREE, NON-CHLORINATED & NON-BROMINATED FLAME RETARDENT

STANDARDS & SPECIFICATIONS:

RECOGNIZED COMPONENT UL 496 (US/CAN) & ENEC CERTIFIED

ENEC-364-1000 (THERMAL CYCLING)

EIA-364-31 (THERMAL SHOCK & HUMIDITY)

EIA-364-17 (ELEVATED TEMPERATURE - LIFE)

UL 2459 (CURRENT CYCLING - TEMP RISE)

IEC 60068-2-7 (VIBRATION)

US & FOREIGN PATENTS PENDING

WIRE RANGE:

	AWG (UL 496)	METRIC (ENEC)
SOLID	18-24 AWG	0,25 - 1,00 mm2
STRANDED	18-22 AWG	0,50 - 1,00 mm2
TIN BONDED	18-24 AWG	0,25 -1,00 mm2

DIMENSIONS:

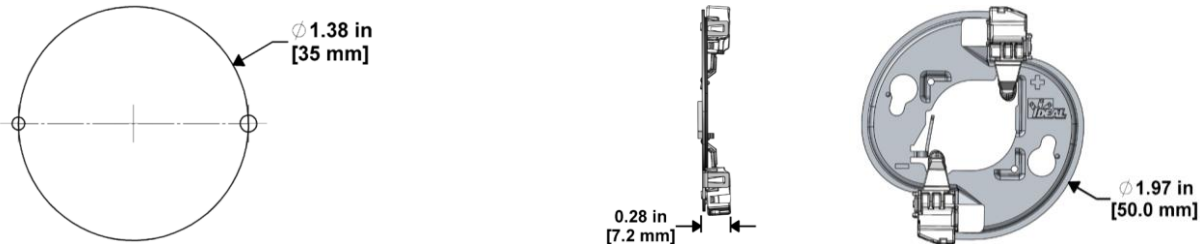

ORDERING INFO:

CATALOG #	MANUFACTURER	COB ARRAY	CARTON QTY:	WEIGHT LBS (KG):
50-2103CT	CITIZEN	CLU03x	500	9.2 (4,2)
50-2101CR	CREE	CX_18	500	9.2 (4,2)
50-2102CR	CREE	CX_25	500	9.2 (4,2)
50-2103CT	EDISON*	2PHM16/2PHM30*	500	9.2 (4,2)
50-2100LG	LG INNOTEK*	LEMWM18*	500	9.2 (4,2)
50-2100NC	NICHIA	110/121/204	500	9.2 (4,2)
50-2103NC	NICHIA	216/360	500	9.2 (4,2)
50-2100NC	PHILIPS	1203	500	9.2 (4,2)
50-2100SH	PHILIPS	1204/1205/1208	500	9.2 (4,2)
50-2102SL	SAMSUNG	LCD026	500	9.2 (4,2)
50-2103CT	SEOUL	SDWx2/SDWx3	500	9.2 (4,2)
50-2100SH	SHARP	MEGA ZENIGATA	500	9.2 (4,2)

* ARRAY HAS EXPOSED COMPONENTS; CLASS 2/SELV APPLICATIONS ONLY UNLESS LUMINARIE PROVIDES SUFFICIENT ELECTRICAL PROTECTION.

ORDERING INFO:

ENGINEERED SOLUTIONS
 IDEAL INDUSTRIES, INC.
 1375 PARK AVENUE SYCAMORE IL USA 60178
 P: 1-800-324-9571 F: 1-888-222-6140
 E: oem@idealindustries.com

SALES CONTACT:



MODEL 50-22

CHIP-LOK® COB ARRAY HOLDER

FEATURES/BENEFITS:



- METAL HOLDER BASE IS RESISTANT TO CREEP TO PREVENT THERMAL AND ELECTRICAL ISSUES TYPICAL AT ELEVATED OPERATING TEMPERATURES OVER TIME
- COB HOLDING ARM SECURES ARRAY TO HOLDER FOR EASE OF INSTALLATION
- KEYWAYS ALLOW FOR PRE-INSTALLATION OF SCREWS TO EASE ASSEMBLY AND MINIMIZE DAMAGE TO PHOSPHOR
- TOUCH-SAFE DESIGN (ON SOME MODELS) IS UL RECOGNIZED FOR 250V TO ALLOW USE IN DAISY CHAINED APPLICATIONS
- STAINLESS STEEL BODY PROVIDES ADDITIONAL HEAT SINKING PATHS TO ALLOW ARRAY TO RUN COOLER COMPARED WITH SCREWS AND PLASTIC HOLDERS.

ELECTRICAL:

VOLTAGE: 250 V MAX (cUL)*
150 V MAX (ENEC)*
CURRENT: 4 A MAX (cUL)*
2 A MAX (ENEC)

*SEE ORDERING INFORMATION BELOW FOR EXCEPTIONS

MECHANICAL:

DIAMETER: 1.97 in (50.0 mm)
HEIGHT: 0.27 in (6.98 mm) MAX
WEIGHT: 0.28 oz (7.8 grams)
SCREW SIZE: #4 or #5 (M3)
SCREW TORQUE: 2.5-4.5 in-lb (0.3-0.5 Nm)
SCREW CIRCLE DIA: 1.38 in (35.0 mm)
WIRE STRIP LENGTH: 1/4"-5/16" (7 mm)

PHYSICAL:

BASE PLATE: 301 SS
CONTACT HOUSING: THERMOPLASTIC
ELECTRICAL CONTACTS: COPPER ALLOY
PLATING: SILVER OVER NICKEL
TEMPERATURE: 110°C
RoHS AND REACH COMPLIANT HALOGEN FREE, NON-CHLORINATED & NON-BROMINATED FLAME RETARDENT

STANDARDS & SPECIFICATIONS:

RECOGNIZED COMPONENT UL 496 (US/CAN) & ENEC CERTIFIED
ENEC-364-1000 (THERMAL CYCLING)
EIA-364-31 (THERMAL SHOCK & HUMIDITY)
EIA-364-17 (ELEVATED TEMPERATURE - LIFE)
UL 2459 (CURRENT CYCLING - TEMP RISE)
IEC 60068-2-7 (VIBRATION)
US & FOREIGN PATENTS PENDING

WIRE RANGE:

	AWG (UL 496)	METRIC (ENEC)
SOLID	18-24 AWG	0,25 - 1,00 mm2
STRANDED	18-22 AWG	0,50 - 1,00 mm2
TIN BONDED	18-24 AWG	0,25 - 1,00 mm2

DIMENSIONS:



ORDERING INFO:

CATALOG #	MANUFACTURER	COB ARRAY	CARTON QTY:	WEIGHT LBS (KG):
50-2204CT	CITIZEN	CLU04x	500	9.2 (4,2)
50-2234C	CREE	CX_30	500	9.2 (4,2)
50-2204CT	EDISON*	2PHM40*	500	9.2 (4,2)
50-2204CT	LEXTAR*	NIMBUS 2000/3000/5000*	500	9.2 (4,2)
50-2204CT	LG INNOTEK*	LEMWM24*	500	9.2 (4,2)
50-2204CT	SEOUL	SDWx4/SDWx5	500	9.2 (4,2)

* ARRAY HAS EXPOSED COMPONENTS; CLASS 2/SELV APPLICATIONS ONLY UNLESS LUMINARIE PROVIDES SUFFICIENT ELECTRICAL PROTECTION.

ORDERING INFO:

ENGINEERED SOLUTIONS
IDEAL INDUSTRIES, INC.
1375 PARK AVENUE SYCAMORE IL USA 60178
P: 1-800-324-9571
F: 1-888-222-6140
E: oem@idealindustries.com

SALES CONTACT:



MODEL 50-23

CHIP-LOK®
COB ARRAY HOLDER

FEATURES/BENEFITS:



- METAL HOLDER BASE IS RESISTANT TO CREEP TO PREVENT THERMAL AND ELECTRICAL ISSUES TYPICAL AT ELEVATED OPERATING TEMPERATURES OVER TIME
- COB HOLDING ARM SECURES ARRAY TO HOLDER FOR EASE OF INSTALLATION
- KEYWAYS ALLOW FOR PRE-INSTALLATION OF SCREWS TO EASE ASSEMBLY AND MINIMIZE DAMAGE TO PHOSPHOR
- TOUCH-SAFE DESIGN (ON SOME MODELS) IS UL RECOGNIZED FOR 250V TO ALLOW USE IN DAISY CHAINED APPLICATIONS
- STAINLESS STEEL BODY PROVIDES ADDITIONAL HEAT SINKING PATHS TO ALLOW ARRAY TO RUN COOLER COMPARED WITH SCREWS AND PLASTIC HOLDERS.

ELECTRICAL:

VOLTAGE: 250 V MAX
CURRENT: 4 A MAX

MECHANICAL:

DIAMETER: 2.56 in (65.0 mm)
HEIGHT: 0.27 in (6.98 mm) MAX
WEIGHT: 0.39 oz (10.3 grams)
SCREW SIZE: #4 or #5 (M3)
SCREW TORQUE: 2.5-4.5 in-lb (0.3-0.5 Nm)
SCREW CIRCLE DIA: 1.97 in (50.0 mm)
WIRE STRIP LENGTH: 1/4"-5/16" (7 mm)

PHYSICAL:

BASE PLATE: 301 SS
CONTACT HOUSING: THERMOPLASTIC
ELECTRICAL CONTACTS: COPPER ALLOY
PLATING: SILVER OVER NICKEL
TEMPERATURE: 110°C
RoHS AND REACH COMPLIANT HALOGEN FREE, NON-CHLORINATED & NON-BROMINATED FLAME RETARDANT

STANDARDS & SPECIFICATIONS:

RECOGNIZED COMPONENT UL 496 (US/CAN) & ENEC CERTIFIED
ENEC-364-1000 (THERMAL CYCLING)
EIA-364-31 (THERMAL SHOCK & HUMIDITY)
EIA-364-17 (ELEVATED TEMPERATURE - LIFE)
UL 2459 (CURRENT CYCLING - TEMP RISE)
IEC 60068-2-7 (VIBRATION)
US & FOREIGN PATENTS PENDING

WIRE RANGE:

	AWG (UL 496)	METRIC (ENEC)
SOLID	18-24 AWG	0,25 - 1,00 mm2
STRANDED	18-22 AWG	0,50 - 1,00 mm2
TIN BONDED	18-24 AWG	0,25 - 1,00 mm2

DIMENSIONS:

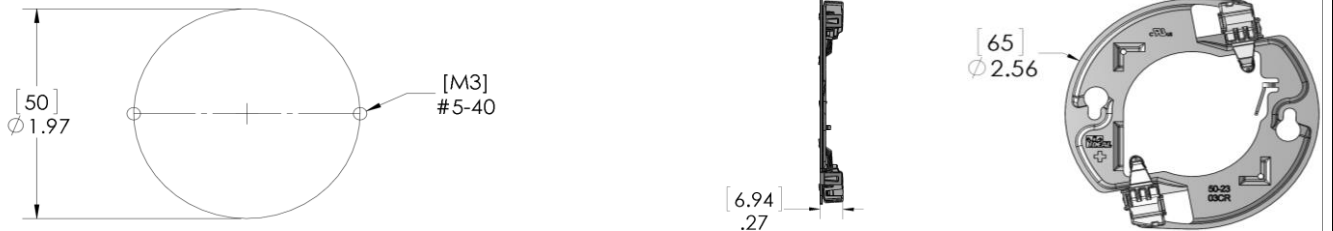

ORDERING INFO:

CATALOG #	MANUFACTURER	COB ARRAY	CARTON QTY:	WEIGHT LBS (KG):
50-2303CR	CREE	CX_35	500	9.2 (4,2)

ORDERING INFO:

ENGINEERED SOLUTIONS
IDEAL INDUSTRIES, INC.
1375 PARK AVENUE SYCAMORE IL USA 60178
P: 1-800-324-9571
F: 1-888-222-6140
E: oem@idealindustries.com

SALES CONTACT:

|

X-ON Electronics

Largest Supplier of Electrical and Electronic Components

Click to view similar products for [Ideal manufacturer](#):

Other Similar products are found below :

[30-593](#) [45-173](#) [45-098](#) [L-5361](#) [45-093](#) [45-162](#) [45-416](#) [41-990](#) [15DYS618-120150W-3](#) [25HK-AY-090A266-DH](#) [15DYS6150-3000500P](#) [30-503](#) [35-020](#) [35-060](#) [35-516](#) [45-120](#) [45-1633-1](#) [45-170](#) [45-1773-1](#) [45-1774](#) [45-1939-1](#) [45-2020-1](#) [45-2133-1](#) [45-298](#) [45-372](#) [K-6336](#) [K-8906R](#) [L-4866](#) [L-5562](#) [L-9038](#) [LB-1091](#) [35-522](#) [61-775](#) [KB-0276R](#) [30-429](#) [30-696](#) [33-856](#) [158051](#) [45-672](#) [45-292](#) [45-129](#) [34-002](#) [33-864](#)
[VDV II PRO](#) [45-1513](#) [45-1610](#) [45-2565](#) [45-260](#) [45-2835](#) [46-204](#)