

LF1 Series Adjustable Supports LED Illumination Units

Adjustable mounting angle 0° to 90° in 10° increments Flexible mounting on machines

- The adjustable supports hold the LED illumination unit at a required angle.
- In an application for inspection, the angle of the LED illumination unit can be adjusted for the convenience of the inspector.

Application Examples

Internal illumination for machine tools, metal processing machines, semiconductor production equipment, printing presses, chip mounters, and automatic production machines; illumination for visual inspection, etc.

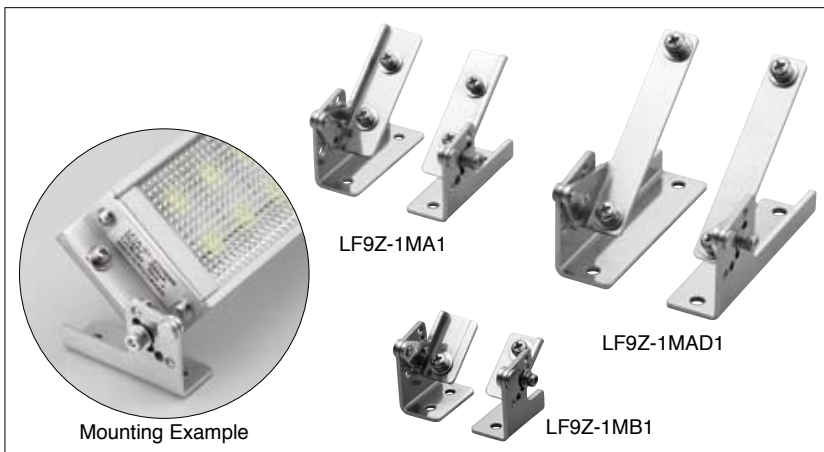

Types

Name	Ordering Type No.	Applicable LED Illumination Unit	Package Quantity	Material
Adjustable Support for LF1 Series	LF9Z-1MB1	LF1B-A, -B, and -C (-D not applicable)	1 pair (right and left)	Stainless steel
	LF9Z-1MA1	LF1A-A, -B, and -D		
	LF9Z-1MAD1	LF1A-D2F		

Dimensions

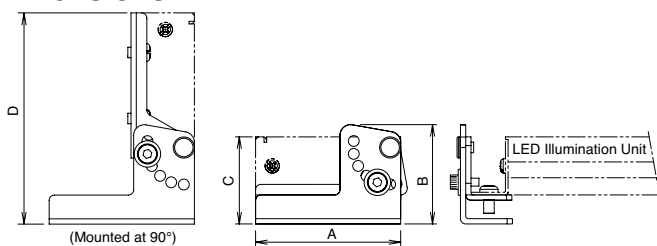

The above figure illustrates the LF9Z-1MA1.

• Dimensions (mm)

Type No.	A	B	C	D
LF9Z-1MB1	27.5	35.2	27	50.5
LF9Z-1MA1	55	37.9	33	80
LF9Z-1MAD1	88	43.2	37	121

The angle is adjusted using hex socket bolts.
Applicable environment and mechanical strength depend on the LED illumination unit.

Mounting Hole Layout

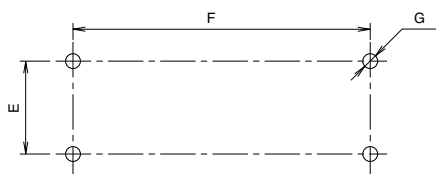

• Dimensions (mm)

Type No.	E	F	G
LF9Z-1MB1	14	(Note)	4-ø4.2
LF9Z-1MA1	25	(Note)	4-ø4.2
LF9Z-1MAD1	74	231	4-ø5.5

Note: Same as the LED illumination unit.

Specifications and other descriptions in this leaflet are subject to change without notice.



IDEC CORPORATION

IDEC CORPORATION (USA)
Tel: +1-408-747-0550 / (800) 262-IDEC (4332)
Fax: +1-408-744-9055 / (800) 635-6246
E-mail: opencontact@idec.com

IDEC CANADA LIMITED
Tel: +1-905-890-8561, Toll Free: (888) 317-4332
Fax: +1-905-890-8562
E-mail: sales@ca.idec.com

IDEC AUSTRALIA PTY. LTD.
Tel: +61-3-9763-3244, Toll Free: 1800-68-4332
Fax: +61-3-9763-3255
E-mail: sales@au.idec.com

7-31, Nishi-Miyahara 1-Chome, Yodogawa-ku, Osaka 532-8550, Japan
Tel: +81-6-6398-2571, Fax: +81-6-6392-9731
E-mail: products@idec.co.jp

IDEC ELECTRONICS LIMITED
Tel: +44-1256-321000, Fax: +44-1256-327755
E-mail: sales@uk.idec.com

IDEC ELEKTROTECHNIK GmbH
Tel: +49-40-25 30 54 - 0, Fax: +49-40-25 30 54 - 24
E-mail: service@idec.de

IDEC (SHANGHAI) CORPORATION
Tel: +86-21-5353-1000, Fax: +86-21-5353-1263
E-mail: idec@cn.idec.com

IDEC IZUMI (H.K.) CO., LTD.
Tel: +852-2803-8989, Fax: +852-2565-0171
E-mail: info@hk.idec.com

IDEC TAIWAN CORPORATION
Tel: +886-2-2698-3929, Fax: +886-2-2698-3931
E-mail: service@idec.tw

IDEC IZUMI ASIA PTE. LTD.
Tel: +65-6746-1155, Fax: +65-6844-5995
E-mail: info@sg.idec.com

X-ON Electronics

Largest Supplier of Electrical and Electronic Components

Click to view similar products for [Mounting Fixings](#) category:

Click to view products by [Idec](#) manufacturer:

Other Similar products are found below :

[007310](#) [007541](#) [6-141-P](#) [620HA038NF09](#) [620HA038NF11](#) [71-074914-006](#) [71-146610-6H](#) [712HA170B23128-N](#) [71-441549-19S](#) [71-490451-4H](#) [75-69211-3P](#) [75-69220-27S](#) [75-69224-5S](#) [770-006A109](#) [770-006A109R](#) [770-006A207](#) [770-006A208W1](#) [770-006A209](#) [770-006A306](#) [770-006A703W1](#) [770-006A704](#) [770-006A704W1](#) [770-006A705](#) [770-006A706](#) [770-006A706W1](#) [770-006A707](#) [770-006A709](#) [770-007A203](#) [770-007A203W1](#) [770-007A204W1](#) [770-007A207W1](#) [770-007A703](#) [770-007A704W1](#) [770-007A706](#) [770-007A707W1](#) [770-010Y208](#) [770-010Y308](#) [770-010Y705](#) [770-010Y706](#) [770-010Y707W1](#) [770-011T201](#) [770-011T203](#) [770-011T701W1](#) [770-011T702](#) [770-011T702W1](#) [770-011T703](#) [770-013210W1](#) [770-013311](#) [770-013312](#) [770-013709](#)