

# ACE-4520C

200 W 24V DC input 1U ATX Power Supply

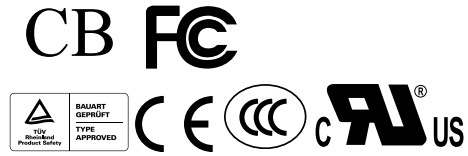

**High power capacity 200W in 1U size!!**  
**Meets ATX revision 2.0 with 20+4-pin ATX power and SATA**

## Features

1. High efficiency
2. Low ripple & noise
3. Output overvoltage protection
4. Short circuit protection on all output
5. 100% burn-in under high ambient temperature (50°C)
6. Vacuum-impregnated transformer
7. MTBF: 100K hours at 25°C
8. 100% Hi-pot tested
9. Line input fuse protection

## Specifications

Input	Voltage	18 ~ 36 VDC Input		
	Input Current	15 A(RMS) @ -24 VDC		
	Inrush Current	100 A Max for -24 VDC		
Output	Voltage	Min. Load	Max. Load	Ripple & Noise
	+5 V	1 A	12 A	50 mV P-P
	+12 V	0.5 A	15.4 A	120 mV P-P
	-12 V	0 A	0.5 A	120 mV P-P
	+3.3 V	0 A	12 A	50 mV P-P
	+5 Vsb	0 A	2 A	50 mV P-P
	+3.3V, +5V, +12V total current not exceed 184W			
Over Voltage Protection	+5 V output 5.7 V ~ 6.5 V			
	+12 V output 13.1 V ~ 14.5 V			
	+3.3 V output 3.7 V ~ 4.1 V			
	Over Circuit Protection	+5 V output 13.2 V ~ 18 V		
+12 V output 17.6 V ~ 24 V				
+3.3 V output 13.2 V ~ 18 V				
Short Circuit Protection	+3.3 V, +5 V, +12 V Shut down and latch off			
General Specifications	Output Rise Time	20 ms Max.		
	Efficiency	78%		
	MTBF	100,000 hours on max load at +25°C		
	Temperature	Operating: 0°C ~ 50°C		
		Storage: -20°C ~ 80°C		
	Relative Humidity	5% ~ 95% RH non-condensing		
Output Connector	20+4-pin ATX, 4-pin 12 V CPU, FDD, SATA, 2 x HDD			

PICMG1.0 Form Factor Backplane



20+4 pin-ATX power connector



PICMG1.3 Form Factor Backplane PE-10S/6S



## Dimensions (Unit: mm)

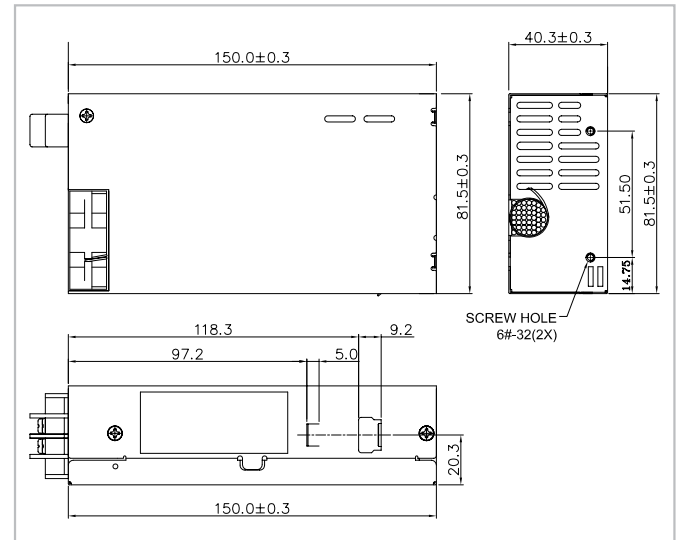

## Ordering Information

Part No.	Description
ACE-4520C-RS	200W 24 V DC input 1U ATX Power Supply

## X-ON Electronics

Largest Supplier of Electrical and Electronic Components

*Click to view similar products for [Isolated DC/DC Converters](#) category:*

*Click to view products by [IEI](#) manufacturer:*

Other Similar products are found below :

[ESM6D044440C05AAQ](#) [FMD15.24G](#) [PSL486-7LR](#) [Q48T30020-NBB0](#) [JAHW100Y1](#) [SPB05C-12](#) [SQ24S15033-PS0S](#) [18952](#) [19-130041](#)  
[CE-1003](#) [CE-1004](#) [GQ2541-7R](#) [RDS180245](#) [MAU228](#) [J80-0041NL](#) [DFC15U48D15](#) [XGS-0512](#) [XGS-1205](#) [XGS-1212](#) [XGS-2412](#) [XGS-2415](#) [XKS-1215](#) [06322](#) [NCT1000N040R050B](#) [SPB05B-15](#) [SPB05C-15](#) [L-DA20](#) [DCG40-5G](#) [QME48T40033-PGB0](#) [XKS-2415](#) [XKS-2412](#)  
[XKS-1212](#) [XKS-1205](#) [XKS-0515](#) [XKS-0505](#) [XGS-2405](#) [XGS-1215](#) [XGS-0515](#) [PS9Z-6RM4](#) [73-551-5038I](#) [AK1601-9RT](#) [VI-N61-CM](#) [VI-R5022-EXWW](#) [PSC128-7iR](#) [RPS8-350ATX-XE](#) [DAS1004812](#) [PQA30-D24-S24-DH](#) [VI-M5F-CQ](#) [VI-LN2-EW](#) [VI-PJW01-CZY](#)