



Series 03 | One-piece, non snap-open e-chain®

e-chain® non snap-open	<i>Bi</i> [mm]	<i>Ba</i> [mm]	<i>R</i> Bending radii [mm]	Weight [kg/m]
03. 05 .R.0	5	8,7	010 012 015 018 028	≈ 0,04
03. 07 .R.0	7	10,7	010 012 015 018 028	≈ 0,05
03. 10 .R.0	10	13,7	010 012 015 018 028	≈ 0,06

Supplement Part No. with required radius (*R*). Example: **03.05.028.0**

Dimensions

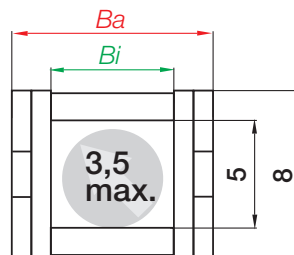
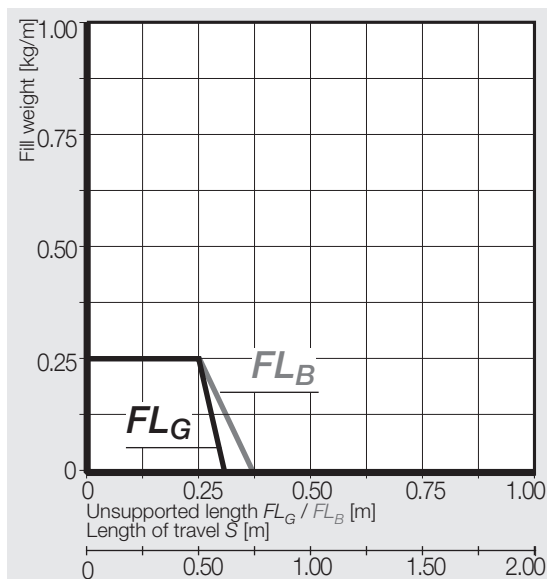

Inner height 5 mm
 Pitch 10 mm/link
 Links/m 100 (1000 mm)
 Chain length $S/2 + K$

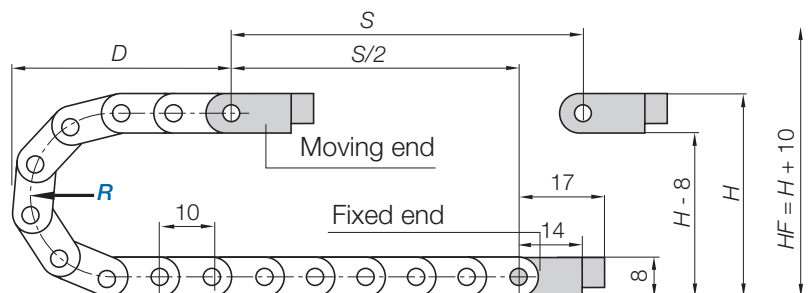

<i>R</i>	010	012	015	018	028
<i>H</i>	28	32	38	44	64
<i>D</i>	29	31	34	37	47
<i>K</i>	55	60	70	80	110

The required clearance height: $H_F = H + 10$ mm (with 0,1 kg/m fill weight)

Mounting brackets, polymer one-piece | pivoting

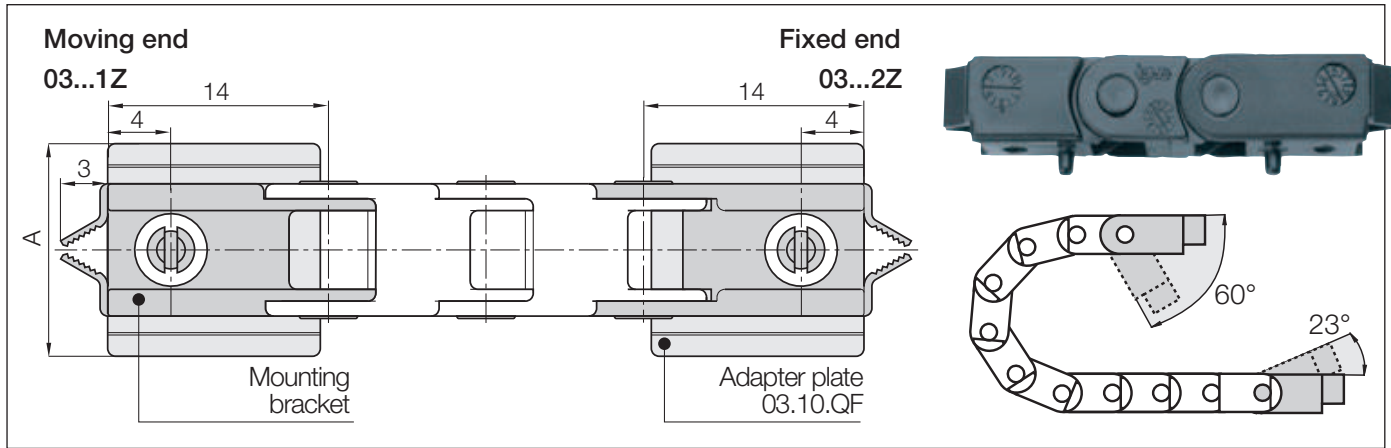

Width Index	Standard	Part No. full set	Dim. A [mm]
.05.	▶	03.05. 12Z	8,7
.07.	▶	03.07. 12Z	10,7
.10.	▶	03.10. 12Z	13,7

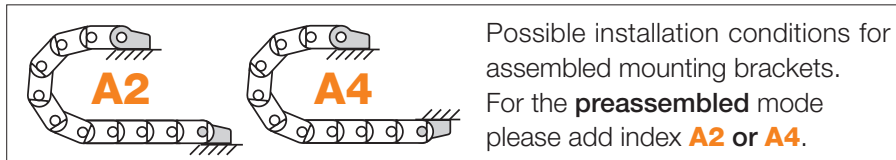

Part No. structure

03.05. 12Z **A2**

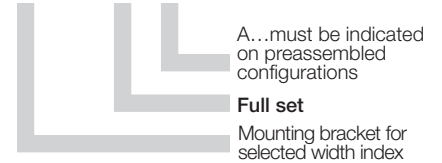

Additional Features

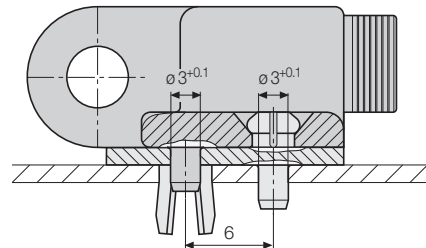

Adapter plate for rapid installation: for all sizes of Part No. 03.10.QF

The adapter has broken edges so that it can be adapted to the respective e-chain® width. It is not absolutely necessary when attaching the mounting brackets. The mounting brackets can also be screwed on without the adapter plate.

X-ON Electronics

Largest Supplier of Electrical and Electronic Components

Click to view similar products for [Cable Mounting & Accessories](#) category:

Click to view products by [Iigus](#) manufacturer:

Other Similar products are found below :

[8945](#) [8950](#) [8961](#) [582603-1](#) [CXA-0069](#) [D-150-0175CS2902](#) [70.060.1628.0](#) [770-1102](#) [770-1204](#) [770-1205-10](#) [770-1301-10](#) [770-1306](#) [770-1422](#) [770-1602](#) [770-1603](#) [770-1604](#) [770-1607](#) [790-1002](#) [809090N001](#) [843188-000](#) [843459N001](#) [8666](#) [PVC10512-BLACK-500](#) [PVC1056-BLACK-500](#) [1301800416](#) [1300830184](#) [1300830729](#) [1302000074](#) [1302261315](#) [APA18-AK](#) [MSK-0001](#) [1-787307-1](#) [1868](#) [HP-6N](#) [C-202-C](#) [CA7308-000](#) [229408-1](#) [KC-201](#) [8949](#) [8952](#) [8S23-75FR-CS8184](#) [2684](#) [9648](#) [3089](#) [A72821-000](#) [AA401](#) [173506-000](#) [1823](#) [202C302-13-02057](#)