

General characteristics

This chapter explains the technical characteristics of the PLUSO series plugs and socket-outlets for industrial purposes.

The range of products covers a wide number of different installation requirements.

The plugs and socket-outlets are suitable for fixed or mobile installations. The fixed plugs and socket-outlets may be wall or flush-mounted.

Thanks to the wide range of the ILME enclosures of the FM, FC and BK series (types BC...) the flush-mounting plugs and socket-outlets can be assembled rapidly in a group configuration.

These construction features enable ILME plugs and socket-outlets to be suitable for use in the most demanding applications:

- the mechanical industry
- the shipbuilding industry
- the chemical and petrochemical industry
- the services sector
- the building industry
- the agricultural and livestock breeding sector

The following parameters must be considered when selecting the correct type of plugs and socket-outlets:

- rated current of the device to feed through plug and socket-outlet coupling;
- the rated voltage of the power supply and the type of distribution (single phase or three-phase, with or without the neutral conductor) to determine the number of poles for the hour position.
The hour position "1h" is available for all those voltages or voltage ranges > 50V and for frequencies or ranges of frequencies not covered by the standards.
- The type of installation (fixed or mobile) to determine the construction type of the plug and socket (flush-mounting straight or inclined, wall, mobile, mobile angled).
- The location of the installation to determine the degree of protection required (IP44 or IP67) and the voltage (in some areas the installation standards require very low safety voltage).

The following types of plugs and socket-outlets are available:

- wall-mounting plugs and socket-outlets (low and extra-low voltage).
- plugs and socket-outlets and straight flush-mounting socket-outlets (low and extra-low voltage).
- plugs and inclined flush-mounting socket-outlets (low voltage)
- straight plugs and couplers (low and extra-low voltage).
- angled plugs (low voltage).
- 5-pole plugs with phase inverter (low voltage, SIP type).
- 5-pole single-block plugs and socket-outlets (low voltage, PEM type) for automated cabling.

Electrical Features

rated frequency:

0 Hz (direct current), and from 50 Hz to 500 Hz

rated operating voltage:

the standard identifies two main types of use:

- extra-low voltage socket-outlets (and relative plugs), (SELV safety requirements, in accordance with the CEI 64-8 installation standard), for effective voltage values of up to 50V inclusive
- low voltage socket-outlets (and plugs) for effective voltage values of over 50V and up to 690V

polarity:

the versions are designed with:

- 2 and 3 poles (extra-low voltage: 2P, 3P)
- 3, 4 and 5 poles (low voltage: 2P+⊕, 3P+⊕, 3P+N+⊕)

The 63A and 125A plugs and socket-outlets have an additional pilot contact.

rated current:

with 16A, 32A, 63A and 125A values (low voltage)
with 16A and 32A (extra-low voltage).

rated insulation voltage:

- 690V for low voltage plugs and socket-outlets
- 50V for extra-low voltage plugs and socket-outlets
- minimum surface insulation distance:* 10 mm (EN 60309-1)
- minimum air insulation distance:* 8 mm (for rated operating voltages higher than 500V)

breaking capacity:

1.25 times greater than the rated current value (test performed at a voltage of 1.1 times the operating voltage).

Mechanical features

- **mechanical resistance**
verified with the provisions of Article 24 of the EN 60309-1 standard (IEC 60309-1)
- **resistance to chemical agents**
see Table on page 8
- **degree of protection**
IP44 and IP67 according to EN 60529 (see information on page 7)
- **resistance to glow-wire**
in accordance with standard IEC 60695 -1-2: for enclosures: 960 °C, 850 °C and 750 °C;
for inserts: 960 °C
- **temperatures**
ambient: -25 °C ÷ +40 °C; materials limit: -40 °C ÷ +125 °C
- **self-extinguishing capacity**
classification UL 94:
for enclosures **V2 e HB**;
for 16A, 32A and 63A type inserts, **V2**;
for types 125A, **5VA e VO**

Materials

- enclosures and inserts in self-extinguishing insulating thermoplastic material
- anti-aging elastomer gaskets
- brass pins (nickel-plated for the 63A and 125A plugs and socket-outlets, on request for the 16A and 32A plugs and socket-outlets)
- self-centring brass contact tubes with zinc-plated steel spring
- zinc-plated steel assembly screws (stainless steel for the 63A and 125A socket-outlets)
- terminals with zinc-plated screws retained in their seats when unscrewed
- 32A, 63A and 125A plugs and socket-outlets with two fixing screws in the terminals as protection against accidental loss
- 63A and 125A plugs and socket-outlets terminals with zinc-plated steel plate for wire protection

The supply package

Plugs and socket-outlets are supplied with:

- anti-oil and anti-aging gaskets
- self-threading fixing screws

The following is available on request:

- cable glands, gaskets, lock nuts and sealing plugs for wall-mounting plugs and socket-outlets
- FM, FC and BK (types BC...) ILME enclosures for flush-mounting plugs and socket-outlets



Composition of the part No.: e.g. **PEW 125 12 3 PP**
 (low voltage)
 article series _____
 rated current in amperes _____
 earthing contact position in hours _____
 number of poles + earth _____
 design of plug or socket _____

PE (IP44) and PEW (IP67) socket-outlets and couplers

low voltage over 50V up to 690V

| | wall-mounting socket-outlets | | straight flush-mounting socket-outlets | | inclined flush-mounting socket-outlets | | couplers | |
|-------------|------------------------------|----------------------------|--|----------------------------|--|----------------------------|---------------------------|----------------------------|
| IP67 | | | | | | | | |
| IP44 | | | | | | | | |
| | PE...PP page 14 | PEW...PP page 15 | PE...PQ page 16 | PEW...PQ page 17 | PE...PI page 18 | PEW...PI page 19 | PE...PV page 20 | PEW...PV page 21 |
| | 16A 32A | 16A 32A 63A 125A | 16A 32A | 16A 32A 63A 125A | 16A 32A | 16A 32A 63A 125A | 16A 32A | 16A 32A 63A 125A |
| | 2P+⊕ 3P+⊕ 3P+N+⊕ | 2P+⊕ 3P+⊕ 3P+N+⊕ | 2P+⊕ 3P+⊕ 3P+N+⊕ | 2P+⊕ 3P+⊕ 3P+N+⊕ | 2P+⊕ 3P+⊕ 3P+N+⊕ | 2P+⊕ 3P+⊕ 3P+N+⊕ | 2P+⊕ 3P+⊕ 3P+N+⊕ | 2P+⊕ 3P+⊕ 3P+N+⊕ |

PE (IP44) and PEW (IP67) plugs

low voltage over 50V up to 690V

| | wall-mounting inlets | | appliance inlets | | plugs | | 90° plugs | |
|-------------|---------------------------|----------------------------|---------------------------|----------------------------|---------------------------|----------------------------|---------------------------|----------------------------|
| IP67 | | | | | | | | |
| IP44 | | | | | | | | |
| | PE...SM page 22 | PEW...SM page 23 | PE...SI page 24 | PEW...SI page 25 | PE...SV page 26 | PEW...SV page 27 | PE...SA page 28 | PEW...SA page 29 |
| | 16A 32A | 16A 32A 63A 125A | 16A 32A | 16A 32A 63A 125A | 16A 32A | 16A 32A 63A 125A | 16A 32A | 16A 32A |
| | 2P+⊕ 3P+⊕ 3P+N+⊕ | 2P+⊕ 3P+⊕ 3P+N+⊕ | 2P+⊕ 3P+⊕ 3P+N+⊕ | 2P+⊕ 3P+⊕ 3P+N+⊕ | 2P+⊕ 3P+⊕ 3P+N+⊕ | 2P+⊕ 3P+⊕ 3P+N+⊕ | 2P+⊕ 3P+⊕ 3P+N+⊕ | 2P+⊕ 3P+⊕ 3P+N+⊕ |

Composition of the part No.: e.g. **PB 16 12 2 PV**
(extra-low voltage)

article series _____
rated current in amperes _____
auxiliary reference in hours _____
number of poles _____
design of plug or socket _____

PEM single-block plugs, socket-outlets and couplers

low voltage over 200V up to 415V

wall-mounting socket-outlets

flush-mounting socket-outlets

couplers

plugs

IP44

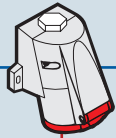

PEM...PP
page 30

16A
32A

3P+N+⊕

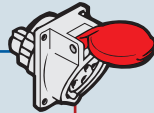

PEM...PI
page 30

16A
32A

3P+N+⊕

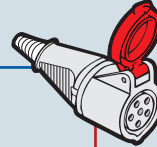

PEM...PV
page 31

16A
32A

3P+N+⊕

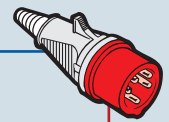

PEM...SV
page 31

16A
32A

3P+N+⊕

phase inverters type SIP (IP44) and SIPW (IP67)

low voltage over 200V up to 415V

wall-mounting phase inverters

flush-mounting phase inverters

phase inverters

IP67

IP44



SIP...SM
page 32

16A
32A

3P+N+⊕

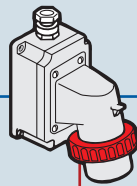

SIPW...SM
page 32

16A
32A

3P+N+⊕

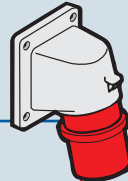

SIP...SI
page 33

16A
32A

3P+N+⊕

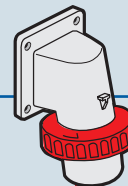

SIPW...SI
page 33

16A
32A

3P+N+⊕

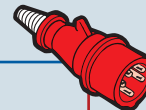

SIP...SV
page 33

16A
32A

3P+N+⊕

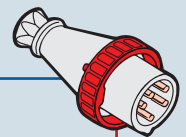

SIPW...SV
page 33

16A
32A

3P+N+⊕

PB plugs and socket-outlets

extra-low voltage up to 50V

wall-mounting socket-outlets

flush-mounting socket-outlets

couplers

appliance inlets

plugs

IP44



PB...PP
page 34

16A
32A

2P
3P

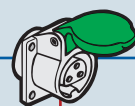

PB...PI
page 35

16A
32A

2P
3P

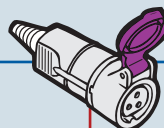

PB...PV
page 35

16A
32A

2P
3P



PB...SM
page 36

16A
32A

2P
3P

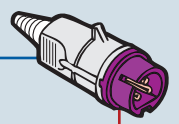

PB...SV
page 37

16A
32A

2P
3P

- Compliant with EN 60309-1 and -2
- Enclosure, insert and spring lid in insulating, thermoplastic, self-extinguishing material
- RAL 7035 grey enclosure, spring lid colour coded according to the operating voltage
- PE...PP types (IP44), spring lid, entry with threaded grommet (replaceable with a cable gland)
- PEW...PP types (IP67), spring lid with locking ring and gasket, entry with cable gland
- Terminals with retained screws
- 63A, 125A: with pilot contact
- Nickel-plated contacts, available on request for 16A and 32A (standard on 63A and 125A)**
- 125A: with terminal block for the anchoring of incoming cables, already connected to socket
- IP44 and IP67 degree of protection (EN 60529)
- With Italian Quality Mark

16A
IP44 degree of protection



32A
IP44 degree of protection



| Poles | Frequency Hz | Voltage V | Earthing contact position h | Part No. | Colour | Part No. | Colour | |
|-------------|--------------|-------------------|-----------------------------|-------------|------------|-------------|------------|--|
| 2P+ | 50 and 60 | 100 - 130 | 4 | PE 1643 PP | | PE 3243 PP | | |
| | 50 and 60 | 200 - 250 | 6 | PE 1663 PP | | PE 3263 PP | | |
| | 50 and 60 | 380 - 415 | 9 | PE 1693 PP | | PE 3293 PP | | |
| | 50 and 60 | 480 - 500 | 7 | PE 1673 PP | | PE 3273 PP | | |
| | 50 and 60 | ins. transformer | 12 | PE 16123 PP | A.V. | PE 32123 PP | A.V. | |
| | > 300 - 500 | > 50 | 2 | PE 1623 PP | | PE 3223 PP | | |
| | d.c. | > 50 - 250 | 3 | PE 1633 PP | A.V. | PE 3233 PP | A.V. | |
| | d.c. | > 250 | 8 | PE 1683 PP | A.V. | PE 3283 PP | A.V. | |
| | 3P+ | 50 and 60 | 100 - 130 | 4 | PE 1644 PP | | PE 3244 PP | |
| | | 50 and 60 | 200 - 250 | 9 | PE 1694 PP | | PE 3294 PP | |
| 50 and 60 | | 380 - 415 | 6 | PE 1664 PP | | PE 3264 PP | | |
| 60 | | 440 - 460 | 11 | PE 16114 PP | | PE 32114 PP | | |
| 50 and 60 | | 480 - 500 | 7 | PE 1674 PP | | PE 3274 PP | | |
| 50 and 60 | | 600 - 690 | 5 | PE 1654 PP | | PE 3254 PP | | |
| 50 | | 380 | 3 | PE 1634 PP | | PE 3234 PP | | |
| 60 | | 440 | 3 | PE 1634 PP | | PE 3234 PP | | |
| 100 - 300 | | > 50 | 10 | PE 16104 PP | | PE 32104 PP | | |
| > 300 - 500 | | > 50 | 2 | PE 1624 PP | | PE 3224 PP | | |
| 3P+N+ | | 50 and 60 | 57/100 - 75/130 | 4 | PE 1645 PP | | PE 3245 PP | |
| | | 50 and 60 | 120/208 - 144/250 | 9 | PE 1695 PP | | PE 3295 PP | |
| | 50 and 60 | 200/346 - 240/415 | 6 | PE 1665 PP | | PE 3265 PP | | |
| | 50 and 60 | 277/480 - 288/500 | 7 | PE 1675 PP | | PE 3275 PP | | |
| | 50 and 60 | 347/600 - 400/690 | 5 | PE 1655 PP | | PE 3255 PP | | |
| | 60 | 250/400 - 265/460 | 11 | PE 16115 PP | | PE 32115 PP | | |
| | 50 | 220/380 | 3 | PE 1635 PP | | PE 3235 PP | | |
| | 60 | 250/440 | 3 | PE 1635 PP | | PE 3235 PP | | |
| | > 300 - 500 | > 50 | 2 | PE 1625 PP | | PE 3225 PP | | |

Legend

A.V. = Colour according to voltage

(*) Green may be used together with the colour of the operating range for frequencies above 60 Hz and up to a maximum of 500 Hz.

(**) For the code of products with nickel-plated contacts (socket holes, plug pins), add "N" to the pre-code of the corresponding standard product code; for example: PE becomes PEN and PEW becomes PEWN.

Dimensions in mm

(16 / 32A) PE ... PP

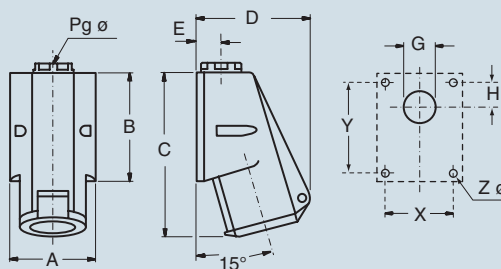

| PE ... PP | A | B | C | D | E | G | H | X | Y | Pg ø | Z ø | |
|-----------|-------|----|-----|-----|-----|----|-----|----|----|------|-----|-----|
| 16A | 2P+ | 70 | 82 | 126 | 92 | 20 | Ø22 | 16 | 53 | 65 | 16 | 4.5 |
| | 3P+ | 70 | 82 | 126 | 92 | 20 | Ø22 | 16 | 53 | 65 | 16 | 4.5 |
| | 3P+N+ | 70 | 82 | 126 | 99 | 13 | Ø22 | 16 | 53 | 65 | 16 | 4.5 |
| 32A | 2P+ | 86 | 104 | 159 | 110 | 24 | Ø28 | 17 | 61 | 79 | 21 | 6.5 |
| | 3P+ | 86 | 104 | 159 | 110 | 24 | Ø28 | 17 | 61 | 79 | 21 | 6.5 |
| | 3P+N+ | 86 | 104 | 159 | 110 | 24 | Ø28 | 17 | 61 | 79 | 21 | 6.5 |

Dimensions indicated are not binding and may be changed without prior notice.

16A
IP67 degree of protection



32A
IP67 degree of protection



63A
IP67 degree of protection



125A
IP67 degree of protection



| Part No. | Colour | Part No. | Colour | Part No. | Colour | Part No. | Colour |
|----------------|--------|----------------|--------|----------------|--------|-----------------|--------|
| PEW 1643 PP ⊕ | Yellow | PEW 3243 PP ⊕ | Yellow | PEW 6343 PP ⊕ | Yellow | PEW 12543 PP ⊕ | Yellow |
| PEW 1663 PP ⊕ | Blue | PEW 3263 PP ⊕ | Blue | PEW 6363 PP ⊕ | Blue | PEW 12563 PP ⊕ | Blue |
| PEW 1693 PP ⊕ | Red | PEW 3293 PP ⊕ | Red | PEW 6393 PP ⊕ | Red | PEW 12593 PP ⊕ | Red |
| PEW 1673 PP ⊕ | Black | PEW 3273 PP ⊕ | Black | PEW 6373 PP ⊕ | Black | PEW 12573 PP ⊕ | Black |
| PEW 16123 PP ⊕ | A.V. | PEW 32123 PP ⊕ | A.V. | PEW 63123 PP ⊕ | A.V. | PEW 125123 PP ⊕ | A.V. |
| PEW 1623 PP ⊕ | (+) | PEW 3223 PP ⊕ | (+) | | | | |
| PEW 1633 PP ⊕ | A.V. | PEW 3233 PP | A.V. | PEW 6333 PP | A.V. | PEW 12533 PP | A.V. |
| PEW 1683 PP | A.V. | PEW 3283 PP | A.V. | PEW 6383 PP | A.V. | PEW 12583 PP | A.V. |
| PEW 1644 PP ⊕ | Yellow | PEW 3244 PP ⊕ | Yellow | PEW 6344 PP ⊕ | Yellow | PEW 12544 PP ⊕ | Yellow |
| PEW 1694 PP ⊕ | Blue | PEW 3294 PP ⊕ | Blue | PEW 6394 PP ⊕ | Blue | PEW 12594 PP ⊕ | Blue |
| PEW 1664 PP ⊕ | Red | PEW 3264 PP ⊕ | Red | PEW 6364 PP ⊕ | Red | PEW 12564 PP ⊕ | Red |
| PEW 16114 PP ⊕ | Red | PEW 32114 PP ⊕ | Red | PEW 63114 PP ⊕ | Red | PEW 125114 PP ⊕ | Red |
| PEW 1674 PP ⊕ | Black | PEW 3274 PP ⊕ | Black | PEW 6374 PP ⊕ | Black | PEW 12574 PP ⊕ | Black |
| PEW 1654 PP | Black | PEW 3254 PP | Black | PEW 6354 PP | Black | PEW 12554 PP | Black |
| PEW 1634 PP ⊕ | Red | PEW 3234 PP ⊕ | Red | | | | |
| PEW 1634 PP ⊕ | Red | PEW 3234 PP ⊕ | Red | | | | |
| PEW 16104 PP ⊕ | (+) | PEW 32104 PP ⊕ | (+) | | | | |
| PEW 1624 PP ⊕ | (+) | PEW 3224 PP ⊕ | (+) | | | | |
| PEW 1645 PP ⊕ | Yellow | PEW 3245 PP ⊕ | Yellow | PEW 6345 PP ⊕ | Yellow | PEW 12545 PP ⊕ | Yellow |
| PEW 1695 PP ⊕ | Blue | PEW 3295 PP ⊕ | Blue | PEW 6395 PP ⊕ | Blue | PEW 12595 PP ⊕ | Blue |
| PEW 1665 PP ⊕ | Red | PEW 3265 PP ⊕ | Red | PEW 6365 PP ⊕ | Red | PEW 12565 PP ⊕ | Red |
| PEW 1675 PP ⊕ | Black | PEW 3275 PP ⊕ | Black | PEW 6375 PP ⊕ | Black | PEW 12575 PP ⊕ | Black |
| PEW 1655 PP | Black | PEW 3255 PP | Black | PEW 6355 PP | Black | PEW 12555 PP | Black |
| PEW 16115 PP ⊕ | Red | PEW 32115 PP ⊕ | Red | PEW 63115 PP ⊕ | Red | PEW 125115 PP ⊕ | Red |
| PEW 1635 PP ⊕ | Red | PEW 3235 PP ⊕ | Red | | | | |
| PEW 1635 PP ⊕ | Red | PEW 3235 PP ⊕ | Red | | | | |
| PEW 1625 PP ⊕ | (+) | PEW 3225 PP ⊕ | (+) | | | | |

Dimensions in mm

(16 / 32A) PEW ... PP

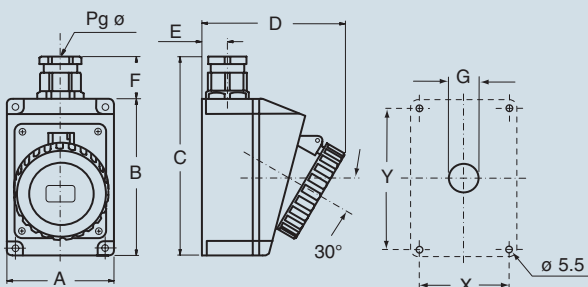

| PEW ... PP | A | B | C | D | E | F | G | X | Y | Pg ø |
|------------|-----|-----|-----|-----|----|----|-----|----|-----|------|
| 16A 2P+⊕ | 75 | 115 | 150 | 105 | 19 | 33 | Ø22 | 65 | 105 | 16 |
| 3P+⊕ | 75 | 115 | 150 | 108 | 19 | 33 | Ø22 | 65 | 105 | 16 |
| 3P+N+⊕ | 100 | 130 | 172 | 120 | 22 | 33 | Ø22 | 85 | 115 | 21 |
| 32A 2P+⊕ | 100 | 130 | 172 | 120 | 22 | 42 | Ø28 | 85 | 115 | 21 |
| 3P+⊕ | 100 | 130 | 172 | 120 | 22 | 42 | Ø28 | 85 | 115 | 21 |
| 3P+N+⊕ | 100 | 130 | 172 | 120 | 22 | 42 | Ø28 | 85 | 115 | 21 |

Dimensions in mm

(63A) PEW ... PP

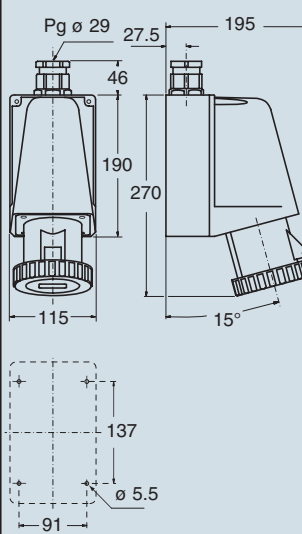

(125A) PEW ... PP

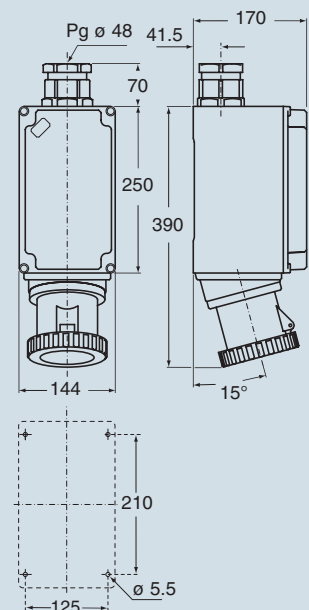

PEW...PP

- Compliant with EN 60309-1 and -2
- Enclosure, insert and spring lid in insulating, thermoplastic, self-extinguishing material
- RAL 7035 grey enclosure, spring lid colour coded according to the operating voltage
- Flange with anti-ageing gasket
- PE...PQ types (IP44), spring lid
- PEW...PQ types (IP67), spring lid with locking ring and gasket
- Terminals with retained screws
- 63A, 125A: with pilot contact
- Nickel-plated contacts, available on request for 16A and 32A (standard on 63A and 125A)**
- IP44 and IP67 degrees of protection (EN 60529)
- With Italian Quality Mark

16A
IP44 degree of protection



32A
IP44 degree of protection

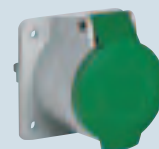

| Poles | Frequency Hz | Voltage V | Earthing contact position h | Part No. | Colour | Part No. | Colour |
|--------|--------------|-------------------|-----------------------------|-------------|--------|-------------|--------|
| 2P+⊕ | 50 and 60 | 100 - 130 | 4 | PE 1643 PQ | | PE 3243 PQ | |
| | 50 and 60 | 200 - 250 | 6 | PE 1663 PQ | | PE 3263 PQ | |
| | 50 and 60 | 380 - 415 | 9 | PE 1693 PQ | | PE 3293 PQ | |
| | 50 and 60 | 480 - 500 | 7 | PE 1673 PQ | | PE 3273 PQ | |
| | 50 and 60 | ins. transformer | 12 | PE 16123 PQ | A.V. | PE 32123 PQ | A.V. |
| | > 300 - 500 | > 50 | 2 | PE 1623 PQ | | PE 3223 PQ | |
| | d.c. | > 50 - 250 | 3 | PE 1633 PQ | A.V. | PE 3233 PQ | A.V. |
| | d.c. | > 250 | 8 | PE 1683 PQ | A.V. | PE 3283 PQ | A.V. |
| 3P+⊕ | 50 and 60 | 100 - 130 | 4 | PE 1644 PQ | | PE 3244 PQ | |
| | 50 and 60 | 200 - 250 | 9 | PE 1694 PQ | | PE 3294 PQ | |
| | 50 and 60 | 380 - 415 | 6 | PE 1664 PQ | | PE 3264 PQ | |
| | 60 | 440 - 460 | 11 | PE 16114 PQ | | PE 32114 PQ | |
| | 50 and 60 | 480 - 500 | 7 | PE 1674 PQ | | PE 3274 PQ | |
| | 50 and 60 | 600 - 690 | 5 | PE 1654 PQ | | PE 3254 PQ | |
| | 50 | 380 | 3 | PE 1634 PQ | | PE 3234 PQ | |
| | 60 | 440 | 3 | PE 1634 PQ | | PE 3234 PQ | |
| | 100 - 300 | > 50 | 10 | PE 16104 PQ | | PE 32104 PQ | |
| | > 300 - 500 | > 50 | 2 | PE 1624 PQ | | PE 3224 PQ | |
| 3P+N+⊕ | 50 and 60 | 57/100 - 75/130 | 4 | PE 1645 PQ | | PE 3245 PQ | |
| | 50 and 60 | 120/208 - 144/250 | 9 | PE 1695 PQ | | PE 3295 PQ | |
| | 50 and 60 | 200/346 - 240/415 | 6 | PE 1665 PQ | | PE 3265 PQ | |
| | 50 and 60 | 277/480 - 288/500 | 7 | PE 1675 PQ | | PE 3275 PQ | |
| | 50 and 60 | 347/600 - 400/690 | 5 | PE 1655 PQ | | PE 3255 PQ | |
| | 60 | 250/440 - 265/460 | 11 | PE 16115 PQ | | PE 32115 PQ | |
| | 50 | 220/380 | 3 | PE 1635 PQ | | PE 3235 PQ | |
| | 60 | 250/440 | 3 | PE 1635 PQ | | PE 3235 PQ | |
| | > 300 - 500 | > 50 | 2 | PE 1625 PQ | | PE 3225 PQ | |

Legend

A.V. = Colour according to voltage

(*) Green may be used together with the colour of the operating range for frequencies above 60 Hz and up to a maximum of 500 Hz.

(**) For the code of products with nickel-plated contacts (socket holes, plug pins), add "N" to the pre-code of the corresponding standard product code; for example: PE becomes PEN and PEW becomes PEWN.

Dimensions in mm

(16 / 32A) PE ... PQ

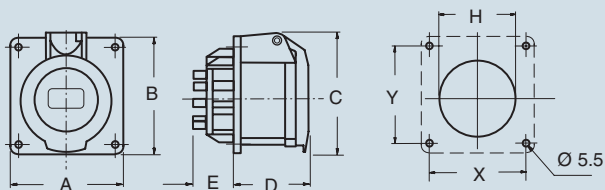

| PE...PQ | A | B | C | D | E | H | X | Y |
|---------|--------|----|----|----|----|----|------|----|
| 16A | 2P+⊕ | 65 | 65 | 71 | 52 | 27 | 60 | 52 |
| | 3P+⊕ | 65 | 65 | 75 | 53 | 27 | 61.5 | 52 |
| | 3P+N+⊕ | 80 | 80 | 86 | 53 | 27 | 70 | 60 |
| 32A | 2P+⊕ | 80 | 80 | 87 | 62 | 28 | 68 | 60 |
| | 3P+⊕ | 80 | 80 | 87 | 62 | 28 | 68 | 60 |
| | 3P+N+⊕ | 80 | 80 | 92 | 62 | 28 | 73 | 60 |

Dimensions indicated are not binding and may be changed without prior notice.

PEW...PQ flush-mounting straight socket-outlets, low voltage from over 50V up to 690V



16A
IP67 degree of protection



32A
IP67 degree of protection



63A
IP67 degree of protection



125A
IP67 degree of protection



PEW...PQ

| Part No. | Colour | Part No. | Colour | Part No. | Colour | Part No. | Colour |
|----------------|--------|----------------|--------|----------------|--------|-----------------|--------|
| PEW 1643 PQ ⊕ | Yellow | PEW 3243 PQ ⊕ | Yellow | PEW 6343 PQ ⊕ | Yellow | PEW 12543 PQ ⊕ | Yellow |
| PEW 1663 PQ ⊕ | Blue | PEW 3263 PQ ⊕ | Blue | PEW 6363 PQ ⊕ | Blue | PEW 12563 PQ ⊕ | Blue |
| PEW 1693 PQ ⊕ | Red | PEW 3293 PQ ⊕ | Red | PEW 6393 PQ ⊕ | Red | PEW 12593 PQ ⊕ | Red |
| PEW 1673 PQ ⊕ | Black | PEW 3273 PQ ⊕ | Black | PEW 6373 PQ ⊕ | Black | PEW 12573 PQ ⊕ | Black |
| PEW 16123 PQ ⊕ | A.V. | PEW 32123 PQ ⊕ | A.V. | PEW 63123 PQ ⊕ | A.V. | PEW 125123 PQ ⊕ | A.V. |
| PEW 1623 PQ ⊕ | (+) | PEW 3223 PQ ⊕ | (+) | | | | |
| PEW 1633 PQ ⊕ | A.V. | PEW 3233 PQ ⊕ | A.V. | PEW 6333 PQ | A.V. | PEW 12533 PQ | A.V. |
| PEW 1683 PQ | A.V. | PEW 3283 PQ | A.V. | PEW 6383 PQ | A.V. | PEW 12583 PQ | A.V. |
| PEW 1644 PQ ⊕ | Yellow | PEW 3244 PQ ⊕ | Yellow | PEW 6344 PQ ⊕ | Yellow | PEW 12544 PQ ⊕ | Yellow |
| PEW 1694 PQ ⊕ | Blue | PEW 3294 PQ ⊕ | Blue | PEW 6394 PQ ⊕ | Blue | PEW 12594 PQ ⊕ | Blue |
| PEW 1664 PQ ⊕ | Red | PEW 3264 PQ ⊕ | Red | PEW 6364 PQ ⊕ | Red | PEW 12564 PQ ⊕ | Red |
| PEW 16114 PQ ⊕ | Red | PEW 32114 PQ ⊕ | Red | PEW 63114 PQ ⊕ | Red | PEW 125114 PQ ⊕ | Red |
| PEW 1674 PQ ⊕ | Black | PEW 3274 PQ ⊕ | Black | PEW 6374 PQ ⊕ | Black | PEW 12574 PQ ⊕ | Black |
| PEW 1654 PQ | Black | PEW 3254 PQ | Black | PEW 6354 PQ | Black | PEW 12554 PQ | Black |
| PEW 1634 PQ ⊕ | Red | PEW 3234 PQ ⊕ | Red | | | | |
| PEW 1634 PQ ⊕ | Red | PEW 3234 PQ ⊕ | Red | | | | |
| PEW 16104 PQ ⊕ | (+) | PEW 32104 PQ ⊕ | (+) | | | | |
| PEW 1624 PQ ⊕ | (+) | PEW 3224 PQ ⊕ | (+) | | | | |
| PEW 1645 PQ ⊕ | Yellow | PEW 3245 PQ ⊕ | Yellow | PEW 6345 PQ ⊕ | Yellow | PEW 12545 PQ ⊕ | Yellow |
| PEW 1695 PQ ⊕ | Blue | PEW 3295 PQ ⊕ | Blue | PEW 6395 PQ ⊕ | Blue | PEW 12595 PQ ⊕ | Blue |
| PEW 1665 PQ ⊕ | Red | PEW 3265 PQ ⊕ | Red | PEW 6365 PQ ⊕ | Red | PEW 12565 PQ ⊕ | Red |
| PEW 1675 PQ ⊕ | Black | PEW 3275 PQ ⊕ | Black | PEW 6375 PQ ⊕ | Black | PEW 12575 PQ ⊕ | Black |
| PEW 1655 PQ | Black | PEW 3255 PQ | Black | PEW 6355 PQ | Black | PEW 12555 PQ | Black |
| PEW 16115 PQ ⊕ | Red | PEW 32115 PQ ⊕ | Red | PEW 63115 PQ ⊕ | Red | PEW 125115 PQ ⊕ | Red |
| PEW 1635 PQ ⊕ | Red | PEW 3235 PQ ⊕ | Red | | | | |
| PEW 1635 PQ ⊕ | Red | PEW 3235 PQ ⊕ | Red | | | | |
| PEW 1625 PQ ⊕ | (+) | PEW 3225 PQ ⊕ | (+) | | | | |

Dimensions in mm

(16 / 32A) PEW ... PQ

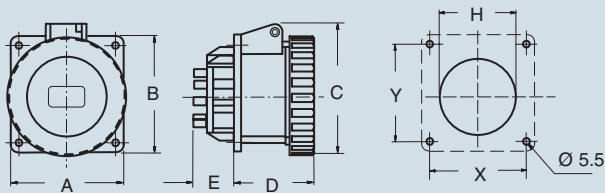

| PEW...PQ | A | B | C | D | E | H | X | Y |
|----------|----|----|-----|----|----|------|----|----|
| 16A 2P+⊕ | 65 | 65 | 77 | 52 | 27 | 60 | 52 | 52 |
| 3P+⊕ | 65 | 65 | 85 | 52 | 27 | 61.5 | 52 | 52 |
| 3P+N+⊕ | 80 | 80 | 93 | 52 | 27 | 70 | 60 | 60 |
| 32A 2P+⊕ | 80 | 80 | 98 | 62 | 28 | 68 | 60 | 60 |
| 3P+⊕ | 80 | 80 | 98 | 62 | 28 | 68 | 60 | 60 |
| 3P+N+⊕ | 80 | 80 | 105 | 62 | 28 | 73 | 60 | 60 |

Dimensions in mm

(63 / 125A) PEW ... PQ

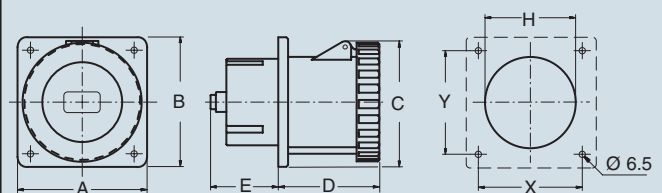

| PEW ... PQ | A | B | C | D | E | H | X | Y |
|------------|-----|-----|-----|-----|----|----|-----|-----|
| 63A 2P+⊕ | 100 | 107 | 109 | 92 | 30 | 73 | 77 | 85 |
| 3P+⊕ | 100 | 107 | 109 | 92 | 30 | 73 | 77 | 85 |
| 3P+N+⊕ | 100 | 107 | 109 | 92 | 30 | 73 | 77 | 85 |
| 125A 2P+⊕ | 130 | 130 | 130 | 101 | 68 | 91 | 104 | 104 |
| 3P+⊕ | 130 | 130 | 130 | 101 | 68 | 91 | 104 | 104 |
| 3P+N+⊕ | 130 | 130 | 130 | 101 | 68 | 91 | 104 | 104 |

- Compliant with EN 60309-1 and -2
- Enclosure, insert and spring lid in insulating, thermoplastic, self-extinguishing material
- RAL 7035 grey enclosure, spring lid colour coded according to the operating voltage
- Flange with anti-ageing gasket
- PE...PI types (IP44), spring lid
- PEW...PI types (IP67), spring lid with locking ring and gasket
- Terminals with retained screws
- 63A, 125A: with pilot contact
- Nickel-plated contacts, available on request for 16A and 32A (standard on 63A and 125A)**
- IP44 and IP67 degrees of protection (EN 60529)
- With Italian Quality Mark

16A
IP44 degree of protection



32A
IP44 degree of protection

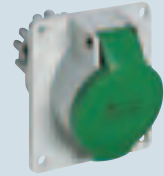

| Number of poles | Frequency Hz | Voltage V | Earthing contact position h | Part No. | Colour | Part No. | Colour | |
|-----------------|--------------|-------------------|-----------------------------|-------------|------------|-------------|------------|--|
| 2P+⊕ | 50 and 60 | 100 - 130 | 4 | PE 1643 PI | | PE 3243 PI | | |
| | 50 and 60 | 200 - 250 | 6 | PE 1663 PI | | PE 3263 PI | | |
| | 50 and 60 | 380 - 415 | 9 | PE 1693 PI | | PE 3293 PI | | |
| | 50 and 60 | 480 - 500 | 7 | PE 1673 PI | | PE 3273 PI | | |
| | 50 and 60 | ins. transformer | 12 | PE 16123 PI | A.V. | PE 32123 PI | A.V. | |
| | > 300 - 500 | > 50 | 2 | PE 1623 PI | | PE 3223 PI | | |
| | d.c. | > 50 - 250 | 3 | PE 1633 PI | A.V. | PE 3233 PI | A.V. | |
| | d.c. | > 250 | 8 | PE 1683 PI | A.V. | PE 3283 PI | A.V. | |
| | 3P+⊕ | 50 and 60 | 100 - 130 | 4 | PE 1644 PI | | PE 3244 PI | |
| | | 50 and 60 | 200 - 250 | 9 | PE 1694 PI | | PE 3294 PI | |
| 50 and 60 | | 380 - 415 | 6 | PE 1664 PI | | PE 3264 PI | | |
| 60 | | 440 - 460 | 11 | PE 16114 PI | | PE 32114 PI | | |
| 50 and 60 | | 480 - 500 | 7 | PE 1674 PI | | PE 3274 PI | | |
| 50 and 60 | | 600 - 690 | 5 | PE 1654 PI | | PE 3254 PI | | |
| 50 | | 380 | 3 | PE 1634 PI | | PE 3234 PI | | |
| 60 | | 440 | 3 | PE 1634 PI | | PE 3234 PI | | |
| 100 - 300 | | > 50 | 10 | PE 16104 PI | | PE 32104 PI | | |
| > 300 - 500 | | > 50 | 2 | PE 1624 PI | | PE 3224 PI | | |
| 3P+N+⊕ | | 50 and 60 | 57/100 - 75/130 | 4 | PE 1645 PI | | PE 3245 PI | |
| | 50 and 60 | 120/208 - 144/250 | 9 | PE 1695 PI | | PE 3295 PI | | |
| | 50 and 60 | 200/346 - 240/415 | 6 | PE 1665 PI | | PE 3265 PI | | |
| | 50 and 60 | 277/480 - 288/500 | 7 | PE 1675 PI | | PE 3275 PI | | |
| | 50 and 60 | 347/600 - 400/690 | 5 | PE 1655 PI | | PE 3255 PI | | |
| | 60 | 250/440 - 265/460 | 11 | PE 16115 PI | | PE 32115 PI | | |
| | 50 | 220/380 | 3 | PE 1635 PI | | PE 3235 PI | | |
| | 60 | 250/440 | 3 | PE 1635 PI | | PE 3235 PI | | |
| | > 300 - 500 | > 50 | 2 | PE 1625 PI | | PE 3225 PI | | |

Legend

A.V. = Colour according to voltage

(*) Green may be used together with the colour of the operating range for frequencies above 60 Hz and up to a maximum of 500 Hz.

(**) For the code of products with nickel-plated contacts (socket holes, plug pins), add "N" to the pre-code of the corresponding standard product code; for example: PE becomes PEN and PEW becomes PEWN.

Dimensions in mm

(16 / 32A) PE ... PI

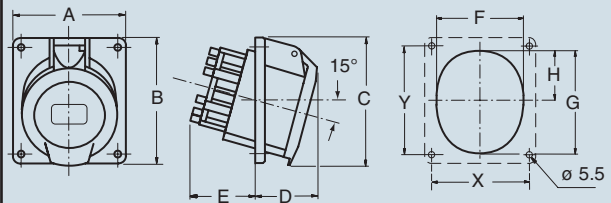

| PE ... PI | A | B | C | D | E | F | G | H | X | Y | |
|-----------|--------|----|-----|-----|----|----|----|----|------|----|----|
| 16A | 2P+⊕ | 64 | 82 | 82 | 38 | 46 | 52 | 62 | 30 | 52 | 60 |
| | 3P+⊕ | 64 | 82 | 82 | 42 | 47 | 57 | 65 | 28 | 52 | 60 |
| | 3P+N+⊕ | 92 | 100 | 100 | 43 | 47 | 66 | 78 | 37.5 | 77 | 85 |
| 32A | 2P+⊕ | 92 | 100 | 100 | 40 | 55 | 68 | 76 | 35.5 | 77 | 85 |
| | 3P+⊕ | 92 | 100 | 100 | 40 | 55 | 68 | 76 | 35.5 | 77 | 85 |
| | 3P+N+⊕ | 92 | 102 | 102 | 43 | 55 | 74 | 86 | 39.5 | 77 | 85 |

Dimensions indicated are not binding and may be changed without prior notice.

PEW...PI flush-mounting inclined socket-outlets, low voltage from over 50V up to 690V



16A
IP67 degree of protection



32A
IP67 degree of protection



63A
IP67 degree of protection



125A
IP67 degree of protection

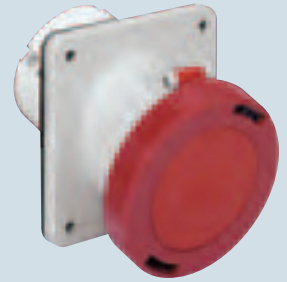

| Part No. | Colour | Part No. | Colour | Part No. | Colour | Part No. | Colour |
|----------------|--------|----------------|--------|----------------|--------|-----------------|--------|
| PEW 1643 PI ⊕ | Yellow | PEW 3243 PI ⊕ | Yellow | PEW 6343 PI ⊕ | Yellow | PEW 12543 PI ⊕ | Yellow |
| PEW 1663 PI ⊕ | Blue | PEW 3263 PI ⊕ | Blue | PEW 6363 PI ⊕ | Blue | PEW 12563 PI ⊕ | Blue |
| PEW 1693 PI ⊕ | Red | PEW 3293 PI ⊕ | Red | PEW 6393 PI ⊕ | Red | PEW 12593 PI ⊕ | Red |
| PEW 1673 PI ⊕ | Black | PEW 3273 PI ⊕ | Black | PEW 6373 PI ⊕ | Black | PEW 12573 PI ⊕ | Black |
| PEW 16123 PI ⊕ | A.V. | PEW 32123 PI ⊕ | A.V. | PEW 63123 PI ⊕ | A.V. | PEW 125123 PI ⊕ | A.V. |
| PEW 1623 PI ⊕ | (+) | PEW 3223 PI ⊕ | (+) | | | | |
| PEW 1633 PI ⊕ | A.V. | PEW 3233 PI | A.V. | PEW 6333 PI | A.V. | PEW 12533 PI | A.V. |
| PEW 1683 PI | A.V. | PEW 3283 PI | A.V. | PEW 6383 PI | A.V. | PEW 12583 PI | A.V. |
| PEW 1644 PI ⊕ | Yellow | PEW 3244 PI ⊕ | Yellow | PEW 6344 PI ⊕ | Yellow | PEW 12544 PI ⊕ | Yellow |
| PEW 1694 PI ⊕ | Blue | PEW 3294 PI ⊕ | Blue | PEW 6394 PI ⊕ | Blue | PEW 12594 PI ⊕ | Blue |
| PEW 1664 PI ⊕ | Red | PEW 3264 PI ⊕ | Red | PEW 6364 PI ⊕ | Red | PEW 12564 PI ⊕ | Red |
| PEW 16114 PI ⊕ | Red | PEW 32114 PI ⊕ | Red | PEW 63114 PI ⊕ | Red | PEW 125114 PI ⊕ | Red |
| PEW 1674 PI ⊕ | Black | PEW 3274 PI ⊕ | Black | PEW 6374 PI ⊕ | Black | PEW 12574 PI ⊕ | Black |
| PEW 1654 PI | Black | PEW 3254 PI | Black | PEW 6354 PI | Black | PEW 12554 PI | Black |
| PEW 1634 PI ⊕ | Red | PEW 3234 PI ⊕ | Red | | | | |
| PEW 1634 PI ⊕ | Red | PEW 3234 PI ⊕ | Red | | | | |
| PEW 16104 PI ⊕ | (+) | PEW 32104 PI ⊕ | (+) | | | | |
| PEW 1624 PI ⊕ | (+) | PEW 3224 PI ⊕ | (+) | | | | |
| PEW 1645 PI ⊕ | Yellow | PEW 3245 PI ⊕ | Yellow | PEW 6345 PI ⊕ | Yellow | PEW 12545 PI ⊕ | Yellow |
| PEW 1695 PI ⊕ | Blue | PEW 3295 PI ⊕ | Blue | PEW 6395 PI ⊕ | Blue | PEW 12595 PI ⊕ | Blue |
| PEW 1665 PI ⊕ | Red | PEW 3265 PI ⊕ | Red | PEW 6365 PI ⊕ | Red | PEW 12565 PI ⊕ | Red |
| PEW 1675 PI ⊕ | Black | PEW 3275 PI ⊕ | Black | PEW 6375 PI ⊕ | Black | PEW 12575 PI ⊕ | Black |
| PEW 1655 PI | Black | PEW 3255 PI | Black | PEW 6355 PI | Black | PEW 12555 PI | Black |
| PEW 16115 PI ⊕ | Red | PEW 32115 PI ⊕ | Red | PEW 63115 PI ⊕ | Red | PEW 125115 PI ⊕ | Red |
| PEW 1635 PI ⊕ | Red | PEW 3235 PI ⊕ | Red | | | | |
| PEW 1635 PI ⊕ | Red | PEW 3235 PI ⊕ | Red | | | | |
| PEW 1625 PI ⊕ | (+) | PEW 3225 PI ⊕ | (+) | | | | |

Dimensions in mm

(16 / 32A) PEW ... PI

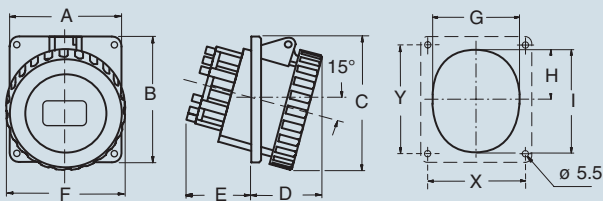

| PEW ... PI | A | B | C | D | E | F | G | H | I | X | Y |
|------------|----|-----|-----|----|----|-----|----|------|----|----|----|
| 16A 2P+⊕ | 65 | 82 | 83 | 48 | 35 | 70 | 50 | 29 | 58 | 52 | 60 |
| 3P+⊕ | 65 | 82 | 87 | 48 | 37 | 78 | 58 | 30 | 65 | 52 | 60 |
| 3P+N+⊕ | 90 | 100 | 102 | 50 | 38 | 86 | 66 | 35 | 75 | 77 | 85 |
| 32A 2P+⊕ | 90 | 100 | 116 | 50 | 50 | 92 | 68 | 37 | 78 | 77 | 85 |
| 3P+⊕ | 90 | 100 | 116 | 50 | 50 | 92 | 68 | 37 | 78 | 77 | 85 |
| 3P+N+⊕ | 90 | 100 | 118 | 50 | 50 | 100 | 73 | 42.5 | 86 | 77 | 85 |

Dimensions in mm

(63 / 125A) PEW ... PI

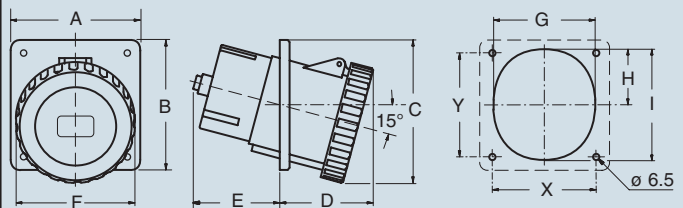

| PEW ... PI | A | B | C | D | E | F | G | H | I | X | Y |
|------------|-----|-----|-----|----|----|-----|-----|----|-----|-----|-----|
| 63A 2P+⊕ | 100 | 107 | 124 | 84 | 55 | 107 | 82 | 45 | 94 | 77 | 85 |
| 3P+⊕ | 100 | 107 | 124 | 84 | 55 | 107 | 82 | 45 | 94 | 77 | 85 |
| 3P+N+⊕ | 100 | 107 | 124 | 84 | 55 | 107 | 82 | 45 | 94 | 77 | 85 |
| 125A 2P+⊕ | 130 | 130 | 143 | 94 | 87 | 119 | 102 | 56 | 112 | 104 | 104 |
| 3P+⊕ | 130 | 130 | 143 | 94 | 87 | 119 | 102 | 56 | 112 | 104 | 104 |
| 3P+N+⊕ | 130 | 130 | 143 | 94 | 87 | 119 | 102 | 56 | 112 | 104 | 104 |

PEW...PI

- Compliant with EN 60309-1 and -2
- Enclosure, insert and spring lid in insulating, thermoplastic, self-extinguishing material
- Cable anchoring collar incorporated in the insert
- PE...PV types (IP44), enclosure and spring lid colour coded according to operating voltage, entry with grommet
- PEW...PV (IP67) types, RAL 7035 grey enclosure, spring lid with locking ring and gasket colour coded according to operating voltage, entry with cable gland
- Terminals with retained screws
- 63A, 125A: with pilot contact
- Nickel-plated contacts, available on request for 16A and 32A (standard on 63A and 125A)**
- IP44 and IP67 degrees of protection (EN 60529)
- With Italian Quality Mark

16A
IP44 degree of protection



32A
IP44 degree of protection



| Number of poles | Frequency Hz | Voltage V | Earthing contact position h | Part No. | Colour | Part No. | Colour | |
|-----------------|--------------|-------------------|-----------------------------|-------------|------------|-------------|------------|--|
| 2P+⊕ | 50 and 60 | 100 - 130 | 4 | PE 1643 PV | | PE 3243 PV | | |
| | 50 and 60 | 200 - 250 | 6 | PE 1663 PV | | PE 3263 PV | | |
| | 50 and 60 | 380 - 415 | 9 | PE 1693 PV | | PE 3293 PV | | |
| | 50 and 60 | 480 - 500 | 7 | PE 1673 PV | | PE 3273 PV | | |
| | 50 and 60 | ins. transformer | 12 | PE 16123 PV | A.V. | PE 32123 PV | A.V. | |
| | > 300 - 500 | > 50 | 2 | PE 1623 PV | | PE 3223 PV | | |
| | d.c. | > 50 - 250 | 3 | PE 1633 PV | A.V. | PE 3233 PV | A.V. | |
| | d.c. | > 250 | 8 | PE 1683 PV | A.V. | PE 3283 PV | A.V. | |
| | 3P+⊕ | 50 and 60 | 100 - 130 | 4 | PE 1644 PV | | PE 3244 PV | |
| | | 50 and 60 | 200 - 250 | 9 | PE 1694 PV | | PE 3294 PV | |
| 50 and 60 | | 380 - 415 | 6 | PE 1664 PV | | PE 3264 PV | | |
| 60 | | 440 - 460 | 11 | PE 16114 PV | | PE 32114 PV | | |
| 50 and 60 | | 480 - 500 | 7 | PE 1674 PV | | PE 3274 PV | | |
| 50 and 60 | | 600 - 690 | 5 | PE 1654 PV | | PE 3254 PV | | |
| 50 | | 380 | 3 | PE 1634 PV | | PE 3234 PV | | |
| 60 | | 440 | 3 | PE 1634 PV | | PE 3234 PV | | |
| 100 - 300 | | > 50 | 10 | PE 16104 PV | | PE 32104 PV | | |
| > 300 - 500 | | > 50 | 2 | PE 1624 PV | | PE 3224 PV | | |
| 3P+N+⊕ | | 50 and 60 | 57/100 - 75/130 | 4 | PE 1645 PV | | PE 3245 PV | |
| | 50 and 60 | 120/208 - 144/250 | 9 | PE 1695 PV | | PE 3295 PV | | |
| | 50 and 60 | 200/346 - 240/415 | 6 | PE 1665 PV | | PE 3265 PV | | |
| | 50 and 60 | 277/480 - 288/500 | 7 | PE 1675 PV | | PE 3275 PV | | |
| | 50 and 60 | 347/600 - 400/690 | 5 | PE 1655 PV | | PE 3255 PV | | |
| | 60 | 250/440 - 265/460 | 11 | PE 16115 PV | | PE 32115 PV | | |
| | 50 | 220/380 | 3 | PE 1635 PV | | PE 3235 PV | | |
| | 60 | 250/440 | 3 | PE 1635 PV | | PE 3235 PV | | |
| | > 300 - 500 | > 50 | 2 | PE 1625 PV | | PE 3225 PV | | |

Legend

A.V. = Colour according to voltage

(*) Green may be used together with the colour of the operating range for frequencies above 60 Hz and up to a maximum of 500 Hz.

(**) For the code of products with nickel-plated contacts (socket holes, plug pins), add "N" to the pre-code of the corresponding standard product code; for example: PE becomes PEN and PEW becomes PEWN.

Dimensions in mm

(16 / 32A) PE ... PV

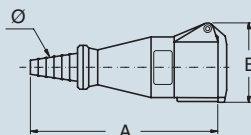

| PE...PV | A | B | ø min | ø max | |
|------------|--------|-------|-------|-------|----|
| 16A | 2P+⊕ | 157.5 | 68 | 7 | 17 |
| | 3P+⊕ | 164.5 | 76 | 7 | 17 |
| | 3P+N+⊕ | 183.5 | 83 | 9 | 22 |
| 32A | 2P+⊕ | 200.5 | 87 | 9 | 22 |
| | 3P+⊕ | 200.5 | 87 | 9 | 22 |
| | 3P+N+⊕ | 200.5 | 91 | 9 | 22 |

Dimensions indicated are not binding and may be changed without prior notice.

16A
IP67 degree of protection



32A
IP67 degree of protection



63A
IP67 degree of protection



125A
IP67 degree of protection



PEW...PV

| Part No. | Colour | Part No. | Colour | Part No. | Colour | Part No. | Colour |
|----------------|--------|----------------|--------|----------------|--------|-----------------|--------|
| PEW 1643 PV ⊕ | Yellow | PEW 3243 PV ⊕ | Yellow | PEW 6343 PV ⊕ | Yellow | PEW 12543 PV ⊕ | Yellow |
| PEW 1663 PV ⊕ | Blue | PEW 3263 PV ⊕ | Blue | PEW 6363 PV ⊕ | Blue | PEW 12563 PV ⊕ | Blue |
| PEW 1693 PV ⊕ | Red | PEW 3293 PV ⊕ | Red | PEW 6393 PV ⊕ | Red | PEW 12593 PV ⊕ | Red |
| PEW 1673 PV ⊕ | Black | PEW 3273 PV ⊕ | Black | PEW 6373 PV ⊕ | Black | PEW 12573 PV ⊕ | Black |
| PEW 16123 PV ⊕ | A.V. | PEW 32123 PV ⊕ | A.V. | PEW 63123 PV ⊕ | A.V. | PEW 125123 PV ⊕ | A.V. |
| PEW 1623 PV ⊕ | (+) | PEW 3223 PV ⊕ | (+) | | | | |
| PEW 1633 PV ⊕ | A.V. | PEW 3233 PV | A.V. | PEW 6333 PV | A.V. | PEW 12533 PV | A.V. |
| PEW 1683 PV | A.V. | PEW 3283 PV | A.V. | PEW 6383 PV | A.V. | PEW 12583 PV | A.V. |
| PEW 1644 PV ⊕ | Yellow | PEW 3244 PV ⊕ | Yellow | PEW 6344 PV ⊕ | Yellow | PEW 12544 PV ⊕ | Yellow |
| PEW 1694 PV ⊕ | Blue | PEW 3294 PV ⊕ | Blue | PEW 6394 PV ⊕ | Blue | PEW 12594 PV ⊕ | Blue |
| PEW 1664 PV ⊕ | Red | PEW 3264 PV ⊕ | Red | PEW 6364 PV ⊕ | Red | PEW 12564 PV ⊕ | Red |
| PEW 16114 PV ⊕ | Red | PEW 32114 PV ⊕ | Red | PEW 63114 PV ⊕ | Red | PEW 125114 PV ⊕ | Red |
| PEW 1674 PV ⊕ | Black | PEW 3274 PV ⊕ | Black | PEW 6374 PV ⊕ | Black | PEW 12574 PV ⊕ | Black |
| PEW 1654 PV | Black | PEW 3254 PV | Black | PEW 6354 PV | Black | PEW 12554 PV | Black |
| PEW 1634 PV ⊕ | Red | PEW 3234 PV ⊕ | Red | | | | |
| PEW 1634 PV ⊕ | Red | PEW 3234 PV ⊕ | Red | | | | |
| PEW 16104 PV ⊕ | (+) | PEW 32104 PV ⊕ | (+) | | | | |
| PEW 1624 PV ⊕ | (+) | PEW 3224 PV ⊕ | (+) | | | | |
| PEW 1645 PV ⊕ | Yellow | PEW 3245 PV ⊕ | Yellow | PEW 6345 PV ⊕ | Yellow | PEW 12545 PV ⊕ | Yellow |
| PEW 1695 PV ⊕ | Blue | PEW 3295 PV ⊕ | Blue | PEW 6395 PV ⊕ | Blue | PEW 12595 PV ⊕ | Blue |
| PEW 1665 PV ⊕ | Red | PEW 3265 PV ⊕ | Red | PEW 6365 PV ⊕ | Red | PEW 12565 PV ⊕ | Red |
| PEW 1675 PV ⊕ | Black | PEW 3275 PV ⊕ | Black | PEW 6375 PV ⊕ | Black | PEW 12575 PV ⊕ | Black |
| PEW 1655 PV | Black | PEW 3255 PV | Black | PEW 6355 PV | Black | PEW 12555 PV | Black |
| PEW 16115 PV ⊕ | Red | PEW 32115 PV ⊕ | Red | PEW 63115 PV ⊕ | Red | PEW 125115 PV ⊕ | Red |
| PEW 1635 PV ⊕ | Red | PEW 3235 PV ⊕ | Red | | | | |
| PEW 1635 PV ⊕ | Red | PEW 3235 PV ⊕ | Red | | | | |
| PEW 1625 PV ⊕ | (+) | PEW 3225 PV ⊕ | (+) | | | | |

Dimensions in mm

(16 / 32A) PEW ... PV

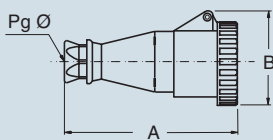

| PEW...PV | A | B | Pg ø |
|----------|-----|-----|------|
| 16A 2P+⊕ | 153 | 77 | 16 |
| 3P+⊕ | 158 | 85 | 16 |
| 3P+N+⊕ | 166 | 93 | 21 |
| 32A 2P+⊕ | 183 | 98 | 21 |
| 3P+⊕ | 183 | 98 | 21 |
| 3P+N+⊕ | 188 | 105 | 21 |

Dimensions in mm

(63 / 125A) PEW ... PV

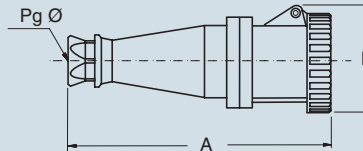

| PEW...PV | A | B | Pg ø |
|-----------|-----|-------|--------|
| 63A 2P+⊕ | 277 | 108.5 | 36 |
| 3P+⊕ | 277 | 108.5 | 36 |
| 3P+N+⊕ | 277 | 108.5 | 36 |
| 125A 2P+⊕ | 324 | 120.5 | 2" gas |
| 3P+⊕ | 324 | 120.5 | 2" gas |
| 3P+N+⊕ | 324 | 120.5 | 2" gas |

- Compliant with EN 60309-1 and -2
- Enclosure, insert and locking ring in insulating, thermoplastic, self-extinguishing material
- PE...SM types (IP44), enclosure colour coded according to operating voltage, top entry with threaded grommet (replaceable with cable gland)
- PEW...SM types (IP67), RAL 7035 grey enclosure, locking ring with gasket colour coded according to operating voltage, top entry with cable gland
- Terminals with retained screws
- 63A, 125A: with pilot contact
- Nickel-plated contacts, available on request for 16A and 32A (standard on 63A and 125A)**
- 125A: with terminal block for the anchoring of incoming cables, already connected to socket
- IP44 and IP67 degrees of protection (EN 60529)
- ® With Italian Quality Mark

16A
IP44 degree of protection



32A
IP44 degree of protection



| Number of poles | Frequency Hz | Voltage V | Earthing contact position h | Part No. | Colour | Part No. | Colour | |
|-----------------|--------------|-------------------|-----------------------------|---------------|--------------|---------------|--------------|--|
| 2P+⊕ | 50 and 60 | 100 - 130 | 4 | PE 1643 SM ® | | PE 3243 SM ® | | |
| | 50 and 60 | 200 - 250 | 6 | PE 1663 SM ® | | PE 3263 SM ® | | |
| | 50 and 60 | 380 - 415 | 9 | PE 1693 SM ® | | PE 3293 SM ® | | |
| | 50 and 60 | 480 - 500 | 7 | PE 1673 SM ® | | PE 3273 SM ® | | |
| | 50 and 60 | ins. transformer | 12 | PE 16123 SM ® | A.V. | PE 32123 SM ® | A.V. | |
| | > 300 - 500 | > 50 | 2 | PE 1623 SM ® | | PE 3223 SM ® | | |
| | d.c. | > 50 - 250 | 3 | PE 1633 SM ® | A.V. | PE 3233 SM ® | A.V. | |
| | d.c. | > 250 | 8 | PE 1683 SM | A.V. | PE 3283 SM | A.V. | |
| | 3P+⊕ | 50 and 60 | 100 - 130 | 4 | PE 1644 SM ® | | PE 3244 SM ® | |
| | | 50 and 60 | 200 - 250 | 9 | PE 1694 SM ® | | PE 3294 SM ® | |
| 50 and 60 | | 380 - 415 | 6 | PE 1664 SM ® | | PE 3264 SM ® | | |
| 60 | | 440 - 460 | 11 | PE 16114 SM ® | | PE 32114 SM ® | | |
| 50 and 60 | | 480 - 500 | 7 | PE 1674 SM ® | | PE 3274 SM ® | | |
| 50 and 60 | | 600 - 690 | 5 | PE 1654 SM | | PE 3254 SM | | |
| 50 | | 380 | 3 | PE 1634 SM ® | | PE 3234 SM ® | | |
| 60 | | 440 | 3 | PE 1634 SM ® | | PE 3234 SM ® | | |
| 100 - 300 | | > 50 | 10 | PE 16104 SM ® | | PE 32104 SM ® | | |
| > 300 - 500 | | > 50 | 2 | PE 1624 SM ® | | PE 3224 SM ® | | |
| 3P+N+⊕ | | 50 and 60 | 57/100 - 75/130 | 4 | PE 1645 SM ® | | PE 3245 SM ® | |
| | | 50 and 60 | 120/208 - 144/250 | 9 | PE 1695 SM ® | | PE 3295 SM ® | |
| | | 50 and 60 | 200/346 - 240/415 | 6 | PE 1665 SM ® | | PE 3265 SM ® | |
| | 50 and 60 | 277/480 - 288/500 | 7 | PE 1675 SM ® | | PE 3275 SM ® | | |
| | 50 and 60 | 347/600 - 400/690 | 5 | PE 1655 SM | | PE 3255 SM | | |
| | 60 | 250/440 - 265/460 | 11 | PE 16115 SM ® | | PE 32115 SM ® | | |
| | 50 | 220/380 | 3 | PE 1635 SM ® | | PE 3235 SM ® | | |
| | 60 | 250/440 | 3 | PE 1635 SM ® | | PE 3235 SM ® | | |
| | > 300 - 500 | > 50 | 2 | PE 1625 SM ® | | PE 3225 SM ® | | |

Legend

A.V. = Colour according to voltage

(*) Green may be used together with the colour of the operating range for frequencies above 60 Hz and up to a maximum of 500 Hz.

(**) For the code of products with nickel-plated contacts (socket holes, plug pins), add "N" to the pre-code of the corresponding standard product code; for example: PE becomes PEN and PEW becomes PEWN.

Accessories for IP67 plugs (optional)

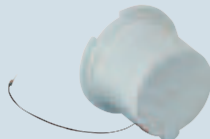

Loose protective cover

| Size | Polarity | Part No. |
|------|----------|------------|
| 16A | 2P+⊕ | PEW 163 CS |
| 16A | 3P+⊕ | PEW 164 CS |
| 16A | 3P+N+⊕ | PEW 165 CS |
| 32A | 2/3P+⊕ | PEW 324 CS |
| 32A | 3P+N+⊕ | PEW 325 CS |
| 63A | All | PEW 63 CS |
| 125A | All | PEW 125 CS |

Dimensions indicated are not binding and may be changed without prior notice.

Dimensions in mm

(16 / 32A) PE ... SM

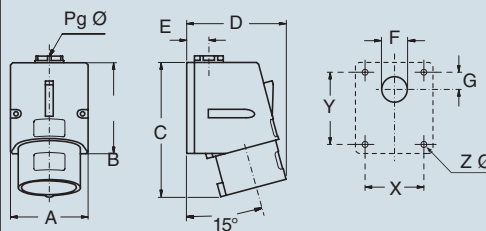

| PE...SM | A | B | C | D | E | F | G | X | Y | Z | Pg Ø | |
|---------|--------|----|-----|-----|----|----|----|----|----|----|------|----|
| 16A | 2P+⊕ | 70 | 82 | 115 | 75 | 20 | 23 | 16 | 53 | 65 | 4.5 | 16 |
| | 3P+⊕ | 70 | 82 | 117 | 75 | 20 | 23 | 16 | 53 | 65 | 4.5 | 16 |
| | 3P+N+⊕ | 70 | 82 | 121 | 90 | 20 | 23 | 16 | 53 | 65 | 4.5 | 16 |
| 32A | 2P+⊕ | 86 | 104 | 145 | 95 | 24 | 29 | 17 | 61 | 79 | 6.5 | 21 |
| | 3P+⊕ | 86 | 104 | 145 | 95 | 24 | 29 | 17 | 61 | 79 | 6.5 | 21 |
| | 3P+N+⊕ | 86 | 104 | 147 | 95 | 24 | 29 | 17 | 61 | 79 | 6.5 | 21 |

PEW...SM wall-mounting plugs, low voltage from over 50V up to 690V



16A
IP67 degree of protection



32A
IP67 degree of protection



63A
IP67 degree of protection



125A
IP67 degree of protection



| Part No. | Colour | Part No. | Colour | Part No. | Colour | Part No. | Colour |
|----------------|--------|----------------|--------|----------------|--------|-----------------|--------|
| PEW 1643 SM ⊕ | Yellow | PEW 3243 SM ⊕ | Yellow | PEW 6343 SM ⊕ | Yellow | PEW 12543 SM ⊕ | Yellow |
| PEW 1663 SM ⊕ | Blue | PEW 3263 SM ⊕ | Blue | PEW 6363 SM ⊕ | Blue | PEW 12563 SM ⊕ | Blue |
| PEW 1693 SM ⊕ | Red | PEW 3293 SM ⊕ | Red | PEW 6393 SM ⊕ | Red | PEW 12593 SM ⊕ | Red |
| PEW 1673 SM ⊕ | Black | PEW 3273 SM ⊕ | Black | PEW 6373 SM ⊕ | Black | PEW 12573 SM ⊕ | Black |
| PEW 16123 SM ⊕ | A.V. | PEW 32123 SM ⊕ | A.V. | PEW 63123 SM ⊕ | A.V. | PEW 125123 SM ⊕ | A.V. |
| PEW 1623 SM ⊕ | (+) | PEW 3223 SM ⊕ | (+) | | | | |
| PEW 1633 SM ⊕ | A.V. | PEW 3233 SM ⊕ | A.V. | PEW 6333 SM | A.V. | PEW 12533 SM | A.V. |
| PEW 1683 SM | A.V. | PEW 3283 SM | A.V. | PEW 6383 SM | A.V. | PEW 12583 SM | A.V. |
| PEW 1644 SM ⊕ | Yellow | PEW 3244 SM ⊕ | Yellow | PEW 6344 SM ⊕ | Yellow | PEW 12544 SM ⊕ | Yellow |
| PEW 1694 SM ⊕ | Blue | PEW 3294 SM ⊕ | Blue | PEW 6394 SM ⊕ | Blue | PEW 12594 SM ⊕ | Blue |
| PEW 1664 SM ⊕ | Red | PEW 3264 SM ⊕ | Red | PEW 6364 SM ⊕ | Red | PEW 12564 SM ⊕ | Red |
| PEW 16114 SM ⊕ | Red | PEW 32114 SM ⊕ | Red | PEW 63114 SM ⊕ | Red | PEW 125114 SM ⊕ | Red |
| PEW 1674 SM ⊕ | Black | PEW 3274 SM ⊕ | Black | PEW 6374 SM ⊕ | Black | PEW 12574 SM ⊕ | Black |
| PEW 1654 SM | Black | PEW 3254 SM | Black | PEW 6354 SM | Black | PEW 12554 SM | Black |
| PEW 1634 SM ⊕ | Red | PEW 3234 SM ⊕ | Red | | | | |
| PEW 1634 SM ⊕ | Red | PEW 3234 SM ⊕ | Red | | | | |
| PEW 16104 SM ⊕ | (+) | PEW 32104 SM ⊕ | (+) | | | | |
| PEW 1624 SM ⊕ | (+) | PEW 3224 SM ⊕ | (+) | | | | |
| PEW 1645 SM ⊕ | Yellow | PEW 3245 SM ⊕ | Yellow | PEW 6345 SM ⊕ | Yellow | PEW 12545 SM ⊕ | Yellow |
| PEW 1695 SM ⊕ | Blue | PEW 3295 SM ⊕ | Blue | PEW 6395 SM ⊕ | Blue | PEW 12595 SM ⊕ | Blue |
| PEW 1665 SM ⊕ | Red | PEW 3265 SM ⊕ | Red | PEW 6365 SM ⊕ | Red | PEW 12565 SM ⊕ | Red |
| PEW 1675 SM ⊕ | Black | PEW 3275 SM ⊕ | Black | PEW 6375 SM ⊕ | Black | PEW 12575 SM ⊕ | Black |
| PEW 1655 SM | Black | PEW 3255 SM | Black | PEW 6355 SM | Black | PEW 12555 SM | Black |
| PEW 16115 SM ⊕ | Red | PEW 32115 SM ⊕ | Red | PEW 63115 SM ⊕ | Red | PEW 125115 SM ⊕ | Red |
| PEW 1635 SM ⊕ | Red | PEW 3235 SM ⊕ | Red | | | | |
| PEW 1635 SM ⊕ | Red | PEW 3235 SM ⊕ | Red | | | | |
| PEW 1625 SM ⊕ | (+) | PEW 3225 SM ⊕ | (+) | | | | |

Dimensions in mm

(16 / 32A) PEW ... SM

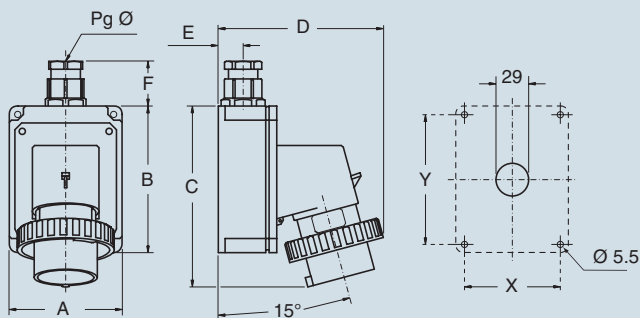

| PEW...SM | A | B | C | D | E | F | X | Y | Pg ø | |
|----------|--------|-----|-----|-----|-----|----|----|----|------|----|
| 16A | 2P+⊕ | 75 | 115 | 144 | 126 | 19 | 35 | 65 | 105 | 16 |
| | 3P+⊕ | 75 | 115 | 144 | 134 | 19 | 35 | 65 | 105 | 16 |
| | 3P+N+⊕ | 100 | 130 | 164 | 145 | 22 | 42 | 85 | 115 | 21 |
| 32A | 2P+⊕ | 100 | 130 | 178 | 154 | 22 | 42 | 85 | 115 | 21 |
| | 3P+⊕ | 100 | 130 | 178 | 154 | 22 | 42 | 85 | 115 | 21 |
| | 3P+N+⊕ | 100 | 130 | 178 | 160 | 22 | 42 | 85 | 115 | 21 |

Dimensions in mm

(63A) PEW ... SM

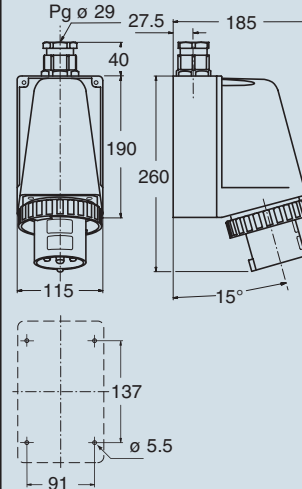

(125A) PEW ... SM

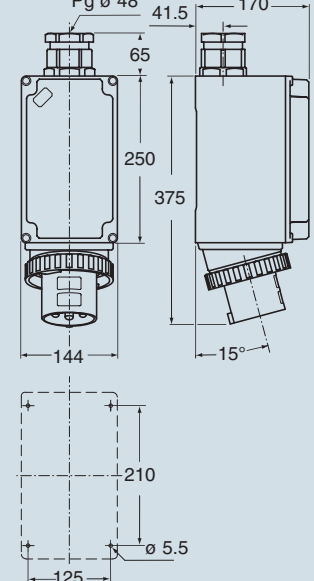

PEW...SM



- Compliant with EN 60309-1 and -2
- Enclosure, insert and locking ring in insulating, thermoplastic, self-extinguishing material
- Flange with anti-ageing gasket
- PE...SI types (IP44), RAL 7035 grey enclosure, plug mouth colour coded according to operating voltage
- PEW...SI (IP67) types, RAL 7035 grey enclosure, locking ring with gasket colour coded according to operating voltage
- Terminals with retained screws
- 63A, 125A: with pilot contact
- Nickel-plated contacts, available on request for 16A and 32A (standard on 63A and 125A)**
- IP44 and IP67 degrees of protection (EN 60529)
- With Italian Quality Mark

16A
IP44 degree of protection



32A
IP44 degree of protection



| Number of poles | Frequency Hz | Voltage V | Earthing contact position h | Part No. | Colour | Part No. | Colour | |
|-----------------|--------------|-------------------|-----------------------------|-------------|------------|-------------|------------|--|
| 2P+⊕ | 50 and 60 | 100 - 130 | 4 | PE 1643 SI | | PE 3243 SI | | |
| | 50 and 60 | 200 - 250 | 6 | PE 1663 SI | | PE 3263 SI | | |
| | 50 and 60 | 380 - 415 | 9 | PE 1693 SI | | PE 3293 SI | | |
| | 50 and 60 | 480 - 500 | 7 | PE 1673 SI | | PE 3273 SI | | |
| | 50 and 60 | ins. transformer | 12 | PE 16123 SI | A.V. | PE 32123 SI | A.V. | |
| | > 300 - 500 | > 50 | 2 | PE 1623 SI | | PE 3223 SI | | |
| | d.c. | > 50 - 250 | 3 | PE 1633 SI | A.V. | PE 3233 SI | A.V. | |
| | d.c. | > 250 | 8 | PE 1683 SI | A.V. | PE 3283 SI | A.V. | |
| | 3P+⊕ | 50 and 60 | 100 - 130 | 4 | PE 1644 SI | | PE 3244 SI | |
| | | 50 and 60 | 200 - 250 | 9 | PE 1694 SI | | PE 3294 SI | |
| 50 and 60 | | 380 - 415 | 6 | PE 1664 SI | | PE 3264 SI | | |
| 60 | | 440 - 460 | 11 | PE 16114 SI | | PE 32114 SI | | |
| 50 and 60 | | 480 - 500 | 7 | PE 1674 SI | | PE 3274 SI | | |
| 50 and 60 | | 600 - 690 | 5 | PE 1654 SI | | PE 3254 SI | | |
| 50 | | 380 | 3 | PE 1634 SI | | PE 3234 SI | | |
| 60 | | 440 | 3 | PE 1634 SI | | PE 3234 SI | | |
| 100 - 300 | | > 50 | 10 | PE 16104 SI | | PE 32104 SI | | |
| > 300 - 500 | | > 50 | 2 | PE 1624 SI | | PE 3224 SI | | |
| 3P+N+⊕ | 50 and 60 | 57/100 - 75/130 | 4 | PE 1645 SI | | PE 3245 SI | | |
| | 50 and 60 | 120/208 - 144/250 | 9 | PE 1695 SI | | PE 3295 SI | | |
| | 50 and 60 | 200/346 - 240/415 | 6 | PE 1665 SI | | PE 3265 SI | | |
| | 50 and 60 | 277/480 - 288/500 | 7 | PE 1675 SI | | PE 3275 SI | | |
| | 50 and 60 | 347/600 - 400/690 | 5 | PE 1655 SI | | PE 3255 SI | | |
| | 60 | 250/440 - 265/460 | 11 | PE 16115 SI | | PE 32115 SI | | |
| | 50 | 220/380 | 3 | PE 1635 SI | | PE 3235 SI | | |
| | 60 | 250/440 | 3 | PE 1635 SI | | PE 3235 SI | | |
| | > 300 - 500 | > 50 | 2 | PE 1625 SI | | PE 3225 SI | | |

Legend

A.V. = Colour according to voltage

(*) Green may be used together with the colour of the operating range for frequencies above 60 Hz and up to a maximum of 500 Hz.

(**) For the code of products with nickel-plated contacts (socket holes, plug pins), add "N" to the pre-code of the corresponding standard product code; for example: PE becomes PEN and PEW becomes PEWN.

Accessories for IP67 plugs (optional)



Loose protective cover

| Size | Polarity | Part No. |
|------|----------|------------|
| 16A | 2P+⊕ | PEW 163 CS |
| 16A | 3P+⊕ | PEW 164 CS |
| 16A | 3P+N+⊕ | PEW 165 CS |
| 32A | 2/3P+⊕ | PEW 324 CS |
| 32A | 3P+N+⊕ | PEW 325 CS |
| 63A | All | PEW 63 CS |
| 125A | All | PEW 125 CS |

Dimensions indicated are not binding and may be changed without prior notice.

Dimensions in mm

(16 / 32A) PE ... SI

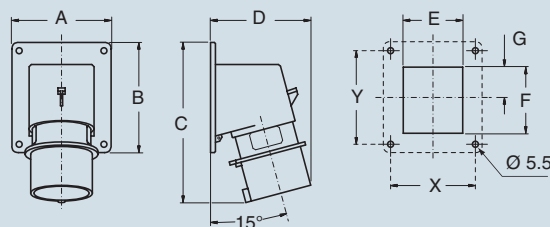

| PE...SI | A | B | C | D | E | F | G | X | Y | |
|---------|--------|----|-----|-----|-----|----|----|------|----|----|
| 16A | 2P+⊕ | 65 | 82 | 126 | 81 | 41 | 43 | 21.5 | 52 | 60 |
| | 3P+⊕ | 65 | 82 | 126 | 81 | 47 | 43 | 21.5 | 52 | 60 |
| | 3P+N+⊕ | 90 | 100 | 146 | 93 | 54 | 60 | 27.5 | 77 | 85 |
| 32A | 2P+⊕ | 90 | 100 | 160 | 101 | 55 | 60 | 27.5 | 77 | 85 |
| | 3P+⊕ | 90 | 100 | 160 | 101 | 55 | 60 | 27.5 | 77 | 85 |
| | 3P+N+⊕ | 90 | 100 | 160 | 106 | 62 | 60 | 27.5 | 77 | 85 |

PEW flush-mounting plugs, low voltage from over 50V up to 690V



16A
IP67 degree of protection



32A
IP67 degree of protection



63A
IP67 degree of protection



125A
IP67 degree of protection



| Part No. | Colour | Part No. | Colour | Part No. | Colour | Part No. | Colour |
|----------------|--------|----------------|--------|----------------|--------|-----------------|--------|
| PEW 1643 SI ⊕ | Yellow | PEW 3243 SI ⊕ | Yellow | PEW 6343 SI ⊕ | Yellow | PEW 12543 SI ⊕ | Yellow |
| PEW 1663 SI ⊕ | Blue | PEW 3263 SI ⊕ | Blue | PEW 6363 SI ⊕ | Blue | PEW 12563 SI ⊕ | Blue |
| PEW 1693 SI ⊕ | Red | PEW 3293 SI ⊕ | Red | PEW 6393 SI ⊕ | Red | PEW 12593 SI ⊕ | Red |
| PEW 1673 SI ⊕ | Black | PEW 3273 SI ⊕ | Black | PEW 6373 SI ⊕ | Black | PEW 12573 SI ⊕ | Black |
| PEW 16123 SI ⊕ | A.V. | PEW 32123 SI ⊕ | A.V. | PEW 63123 SI ⊕ | A.V. | PEW 125123 SI ⊕ | A.V. |
| PEW 1623 SI ⊕ | (+) | PEW 3223 SI ⊕ | (+) | | | | |
| PEW 1633 SI ⊕ | A.V. | PEW 3233 SI | A.V. | PEW 6333 SI | A.V. | PEW 12533 SI | A.V. |
| PEW 1683 SI | A.V. | PEW 3283 SI | A.V. | PEW 6383 SI | A.V. | PEW 12583 SI | A.V. |
| PEW 1644 SI ⊕ | Yellow | PEW 3244 SI ⊕ | Yellow | PEW 6344 SI ⊕ | Yellow | PEW 12544 SI ⊕ | Yellow |
| PEW 1694 SI ⊕ | Blue | PEW 3294 SI ⊕ | Blue | PEW 6394 SI ⊕ | Blue | PEW 12594 SI ⊕ | Blue |
| PEW 1664 SI ⊕ | Red | PEW 3264 SI ⊕ | Red | PEW 6364 SI ⊕ | Red | PEW 12564 SI ⊕ | Red |
| PEW 16114 SI ⊕ | Red | PEW 32114 SI ⊕ | Red | PEW 63114 SI ⊕ | Red | PEW 125114 SI ⊕ | Red |
| PEW 1674 SI ⊕ | Black | PEW 3274 SI ⊕ | Black | PEW 6374 SI ⊕ | Black | PEW 12574 SI ⊕ | Black |
| PEW 1654 SI | Black | PEW 3254 SI | Black | PEW 6354 SI | Black | PEW 12554 SI | Black |
| PEW 1634 SI ⊕ | Red | PEW 3234 SI ⊕ | Red | | | | |
| PEW 1634 SI ⊕ | Red | PEW 3234 SI ⊕ | Red | | | | |
| PEW 16104 SI ⊕ | (+) | PEW 32104 SI ⊕ | (+) | | | | |
| PEW 1624 SI ⊕ | (+) | PEW 3224 SI ⊕ | (+) | | | | |
| PEW 1645 SI ⊕ | Yellow | PEW 3245 SI ⊕ | Yellow | PEW 6345 SI ⊕ | Yellow | PEW 12545 SI ⊕ | Yellow |
| PEW 1695 SI ⊕ | Blue | PEW 3295 SI ⊕ | Blue | PEW 6395 SI ⊕ | Blue | PEW 12595 SI ⊕ | Blue |
| PEW 1665 SI ⊕ | Red | PEW 3265 SI ⊕ | Red | PEW 6365 SI ⊕ | Red | PEW 12565 SI ⊕ | Red |
| PEW 1675 SI ⊕ | Black | PEW 3275 SI ⊕ | Black | PEW 6375 SI ⊕ | Black | PEW 12575 SI ⊕ | Black |
| PEW 1655 SI | Black | PEW 3255 SI | Black | PEW 6355 SI | Black | PEW 12555 SI | Black |
| PEW 16115 SI ⊕ | Red | PEW 32115 SI ⊕ | Red | PEW 63115 SI ⊕ | Red | PEW 125115 SI ⊕ | Red |
| PEW 1635 SI ⊕ | Red | PEW 3235 SI ⊕ | Red | | | | |
| PEW 1635 SI ⊕ | Red | PEW 3235 SI ⊕ | Red | | | | |
| PEW 1625 SI ⊕ | (+) | PEW 3225 SI ⊕ | (+) | | | | |

Dimensions in mm

(16 / 32A) PEW ... SI

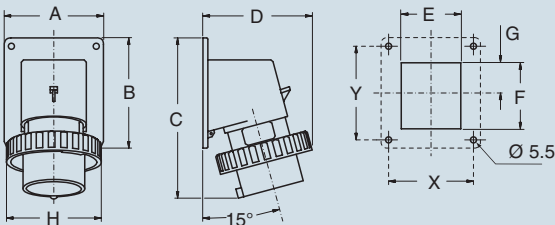

| PEW...SI | A | B | C | D | E | F | G | H | X | Y |
|----------|----|-----|-----|-----|----|----|------|-----|----|----|
| 16A 2P+⊕ | 65 | 82 | 126 | 81 | 41 | 43 | 21.5 | 70 | 52 | 60 |
| 3P+⊕ | 65 | 82 | 126 | 81 | 47 | 43 | 24.5 | 78 | 52 | 60 |
| 3P+N+⊕ | 90 | 100 | 146 | 93 | 54 | 60 | 27.5 | 86 | 77 | 85 |
| 32A 2P+⊕ | 90 | 100 | 160 | 101 | 55 | 60 | 27.5 | 92 | 77 | 85 |
| 3P+⊕ | 90 | 100 | 160 | 101 | 55 | 60 | 27.5 | 92 | 77 | 85 |
| 3P+N+⊕ | 90 | 100 | 160 | 101 | 62 | 60 | 27.5 | 100 | 77 | 85 |

Dimensions in mm

(63A) PEW ... SI

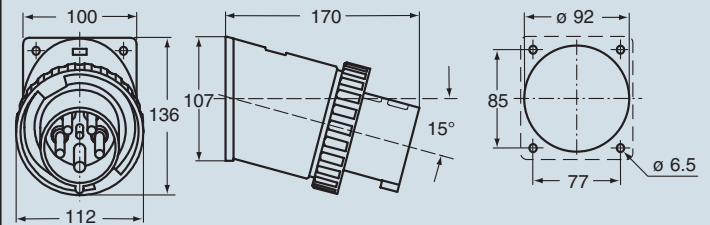

(125A) PEW ... SI

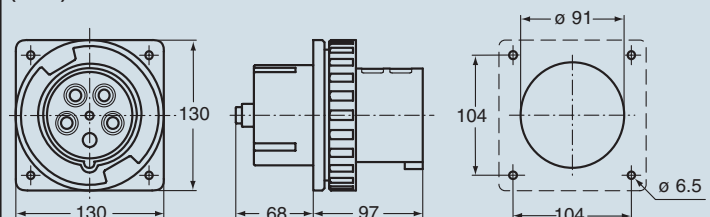

PEW.SI

- Compliant with EN 60309-1 and -2
- Enclosure, insert and locking ring in insulating, thermoplastic, self-extinguishing material
- Cable anchoring collar incorporated in the insert
- PE...SV types (IP44), entry with grommet, enclosure colour coded according to operating voltage
- PEW...SV types (IP67), cable entry with grommet, RAL 7035 grey enclosure, locking ring with gasket colour coded according to operating voltage
- Terminals with retained screws
- 63A, 125A: with pilot contact
- Nickel-plated contacts, available on request for 16A and 32A (standard on 63A and 125A)**
- IP44 and IP67 degrees of protection (EN 60529)
- With Italian Quality Mark

16A
IP44 degree of protection



32A
IP44 degree of protection



| Number of poles | Frequency Hz | Voltage V | Earthing contact position h | Part No. | Colour | Part No. | Colour | |
|-----------------|--------------|-------------------|-----------------------------|-------------|------------|-------------|------------|--|
| 2P+⊕ | 50 and 60 | 100 - 130 | 4 | PE 1643 SV | | PE 3243 SV | | |
| | 50 and 60 | 200 - 250 | 6 | PE 1663 SV | | PE 3263 SV | | |
| | 50 and 60 | 380 - 415 | 9 | PE 1693 SV | | PE 3293 SV | | |
| | 50 and 60 | 480 - 500 | 7 | PE 1673 SV | | PE 3273 SV | | |
| | 50 and 60 | ins. transformer | 12 | PE 16123 SV | A.V. | PE 32123 SV | A.V. | |
| | > 300 - 500 | > 50 | 2 | PE 1623 SV | | PE 3223 SV | | |
| | d.c. | > 50 - 250 | 3 | PE 1633 SV | A.V. | PE 3233 SV | A.V. | |
| | d.c. | > 250 | 8 | PE 1683 SV | A.V. | PE 3283 SV | A.V. | |
| | 3P+⊕ | 50 and 60 | 100 - 130 | 4 | PE 1644 SV | | PE 3244 SV | |
| | | 50 and 60 | 200 - 250 | 9 | PE 1694 SV | | PE 3294 SV | |
| 50 and 60 | | 380 - 415 | 6 | PE 1664 SV | | PE 3264 SV | | |
| 60 | | 440 - 460 | 11 | PE 16114 SV | | PE 32114 SV | | |
| 50 and 60 | | 480 - 500 | 7 | PE 1674 SV | | PE 3274 SV | | |
| 50 and 60 | | 600 - 690 | 5 | PE 1654 SV | | PE 3254 SV | | |
| 50 | | 380 | 3 | PE 1634 SV | | PE 3234 SV | | |
| 60 | | 440 | 3 | PE 1634 SV | | PE 3234 SV | | |
| 100 - 300 | | > 50 | 10 | PE 16104 SV | | PE 32104 SV | | |
| > 300 - 500 | | > 50 | 2 | PE 1624 SV | | PE 3224 SV | | |
| 3P+N+⊕ | 50 and 60 | 57/100 - 75/130 | 4 | PE 1645 SV | | PE 3245 SV | | |
| | 50 and 60 | 120/208 - 144/250 | 9 | PE 1695 SV | | PE 3295 SV | | |
| | 50 and 60 | 200/346 - 240/415 | 6 | PE 1665 SV | | PE 3265 SV | | |
| | 50 and 60 | 277/480 - 288/500 | 7 | PE 1675 SV | | PE 3275 SV | | |
| | 50 and 60 | 347/600 - 400/690 | 5 | PE 1655 SV | | PE 3255 SV | | |
| | 60 | 250/440 - 265/460 | 11 | PE 16115 SV | | PE 32115 SV | | |
| | 50 | 220/380 | 3 | PE 1635 SV | | PE 3235 SV | | |
| | 60 | 250/440 | 3 | PE 1635 SV | | PE 3235 SV | | |
| | > 300 - 500 | > 50 | 2 | PE 1625 SV | | PE 3225 SV | | |

Legend

A.V. = Colour according to voltage

(*) Green may be used together with the colour of the operating range for frequencies above 60 Hz and up to a maximum of 500 Hz.

(**) For the code of products with nickel-plated contacts (socket holes, plug pins), add "N" to the pre-code of the corresponding standard product code; for example: PE becomes PEN and PEW becomes PEWN.

Accessories for IP67 plugs (optional)



Loose protective cover

| Size | Polarity | Part No. |
|------|----------|------------|
| 16A | 2P+⊕ | PEW 163 CS |
| 16A | 3P+⊕ | PEW 164 CS |
| 16A | 3P+N+⊕ | PEW 165 CS |
| 32A | 2/3P+⊕ | PEW 324 CS |
| 32A | 3P+N+⊕ | PEW 325 CS |
| 63A | All | PEW 63 CS |
| 125A | All | PEW 125 CS |

Dimensions indicated are not binding and may be changed without prior notice.

Dimensions in mm

(16 / 32A) PE ... SV

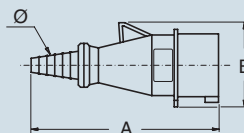

| PE...SV | A | B | ø min | ø max | |
|---------|--------|-------|-------|-------|----|
| 16A | 2P+⊕ | 143.5 | 59 | 7 | 17 |
| | 3P+⊕ | 148.5 | 66 | 7 | 17 |
| | 3P+N+⊕ | 167.5 | 75 | 9 | 22 |
| 32A | 2P+⊕ | 187 | 80 | 9 | 22 |
| | 3P+⊕ | 187 | 80 | 9 | 22 |
| | 3P+N+⊕ | 192.5 | 87 | 9 | 22 |

16A
IP67 degree of protection



32A
IP67 degree of protection



63A
IP67 degree of protection



125A
IP67 degree of protection



| Part No. | Colour | Part No. | Colour | Part No. | Colour | Part No. | Colour |
|----------------|--------|----------------|--------|----------------|--------|-----------------|--------|
| PEW 1643 SV ⊕ | Yellow | PEW 3243 SV ⊕ | Yellow | PEW 6343 SV ⊕ | Yellow | PEW 12543 SV ⊕ | Yellow |
| PEW 1663 SV ⊕ | Blue | PEW 3263 SV ⊕ | Blue | PEW 6363 SV ⊕ | Blue | PEW 12563 SV ⊕ | Blue |
| PEW 1693 SV ⊕ | Red | PEW 3293 SV ⊕ | Red | PEW 6393 SV ⊕ | Red | PEW 12593 SV ⊕ | Red |
| PEW 1673 SV ⊕ | Black | PEW 3273 SV ⊕ | Black | PEW 6373 SV ⊕ | Black | PEW 12573 SV ⊕ | Black |
| PEW 16123 SV ⊕ | A.V. | PEW 32123 SV ⊕ | A.V. | PEW 63123 SV ⊕ | A.V. | PEW 125123 SV ⊕ | A.V. |
| PEW 1623 SV ⊕ | (+) | PEW 3223 SV ⊕ | (+) | | | | |
| PEW 1633 SV ⊕ | A.V. | PEW 3233 SV | A.V. | PEW 6333 SV | A.V. | PEW 12533 SV | A.V. |
| PEW 1683 SV | A.V. | PEW 3283 SV | A.V. | PEW 6383 SV | A.V. | PEW 12583 SV | A.V. |
| PEW 1644 SV ⊕ | Yellow | PEW 3244 SV ⊕ | Yellow | PEW 6344 SV ⊕ | Yellow | PEW 12544 SV ⊕ | Yellow |
| PEW 1694 SV ⊕ | Blue | PEW 3294 SV ⊕ | Blue | PEW 6394 SV ⊕ | Blue | PEW 12594 SV ⊕ | Blue |
| PEW 1664 SV ⊕ | Red | PEW 3264 SV ⊕ | Red | PEW 6364 SV ⊕ | Red | PEW 12564 SV ⊕ | Red |
| PEW 16114 SV ⊕ | Red | PEW 32114 SV ⊕ | Red | PEW 63114 SV ⊕ | Red | PEW 125114 SV ⊕ | Red |
| PEW 1674 SV ⊕ | Black | PEW 3274 SV ⊕ | Black | PEW 6374 SV ⊕ | Black | PEW 12574 SV ⊕ | Black |
| PEW 1654 SV | Black | PEW 3254 SV | Black | PEW 6354 SV | Black | PEW 12554 SV | Black |
| PEW 1634 SV ⊕ | Red | PEW 3234 SV ⊕ | Red | | | | |
| PEW 1634 SV ⊕ | Red | PEW 3234 SV ⊕ | Red | | | | |
| PEW 16104 SV ⊕ | (+) | PEW 32104 SV ⊕ | (+) | | | | |
| PEW 1624 SV ⊕ | (+) | PEW 3224 SV ⊕ | (+) | | | | |
| PEW 1645 SV ⊕ | Yellow | PEW 3245 SV ⊕ | Yellow | PEW 6345 SV ⊕ | Yellow | PEW 12545 SV ⊕ | Yellow |
| PEW 1695 SV ⊕ | Blue | PEW 3295 SV ⊕ | Blue | PEW 6395 SV ⊕ | Blue | PEW 12595 SV ⊕ | Blue |
| PEW 1665 SV ⊕ | Red | PEW 3265 SV ⊕ | Red | PEW 6365 SV ⊕ | Red | PEW 12565 SV ⊕ | Red |
| PEW 1675 SV ⊕ | Black | PEW 3275 SV ⊕ | Black | PEW 6375 SV ⊕ | Black | PEW 12575 SV ⊕ | Black |
| PEW 1655 SV | Black | PEW 3255 SV | Black | PEW 6355 SV | Black | PEW 12555 SV | Black |
| PEW 16115 SV ⊕ | Red | PEW 32115 SV ⊕ | Red | PEW 63115 SV ⊕ | Red | PEW 125115 SV ⊕ | Red |
| PEW 1635 SV ⊕ | Red | PEW 3235 SV ⊕ | Red | | | | |
| PEW 1635 SV ⊕ | Red | PEW 3235 SV ⊕ | Red | | | | |
| PEW 1625 SV ⊕ | (+) | PEW 3225 SV ⊕ | (+) | | | | |

Dimensions in mm

(16 / 32A) PEW ... SV

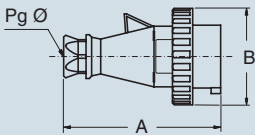

| PEW...SV | A | B | Pg ø |
|----------|-----|------|------|
| 16A 2P+⊕ | 137 | 70 | 16 |
| 3P+⊕ | 142 | 78 | 16 |
| 3P+N+⊕ | 150 | 86 | 21 |
| 32A 2P+⊕ | 170 | 92 | 21 |
| 3P+⊕ | 170 | 92 | 21 |
| 3P+N+⊕ | 175 | 99.5 | 21 |

Dimensions in mm

(63 / 125A) PEW ... SV

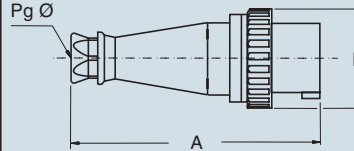

| PEW...SV | A | B | Pg ø |
|-----------|-------|-----|--------|
| 63A 2P+⊕ | 264.5 | 112 | 36 |
| 3P+⊕ | 264.5 | 112 | 36 |
| 3P+N+⊕ | 264.5 | 112 | 36 |
| 125A 2P+⊕ | 310 | 130 | 2" gas |
| 3P+⊕ | 310 | 130 | 2" gas |
| 3P+N+⊕ | 310 | 130 | 2" gas |

- Compliant with EN 60309-1 and -2
- Enclosure, insert and locking ring in insulating, thermoplastic, self-extinguishing material
- Cable anchoring collar incorporated in the insert
- Entry with cable gland
- PE...SA types (IP44), enclosure colour coded according to operating voltage
- PEW...SA types (IP67), RAL 7035 grey enclosure, locking ring with gasket colour coded according to operating voltage
- Terminals with retained screws
- Nickel-plated contacts, available on request for 16A and 32A**
- IP44 and IP67 degrees of protection (EN 60529)
- With Italian Quality Mark

16A
IP44 degree of protection



32A
IP44 degree of protection



| Number of poles | Frequency Hz | Voltage V | Earthing contact position h | Part No. | Colour | Part No. | Colour | |
|-----------------|--------------|-------------------|-----------------------------|-------------|------------|-------------|------------|--|
| 2P+⊕ | 50 and 60 | 100 - 130 | 4 | PE 1643 SA | | PE 3243 SA | | |
| | 50 and 60 | 200 - 250 | 6 | PE 1663 SA | | PE 3263 SA | | |
| | 50 and 60 | 380 - 415 | 9 | PE 1693 SA | | PE 3293 SA | | |
| | 50 and 60 | 480 - 500 | 7 | PE 1673 SA | | PE 3273 SA | | |
| | 50 and 60 | ins. transformer | 12 | PE 16123 SA | A.V. | PE 32123 SA | A.V. | |
| | > 300 - 500 | > 50 | 2 | PE 1623 SA | | PE 3223 SA | | |
| | d.c. | > 50 - 250 | 3 | PE 1633 SA | A.V. | PE 3233 SA | A.V. | |
| | d.c. | > 250 | 8 | PE 1683 SA | A.V. | PE 3283 SA | A.V. | |
| | 3P+⊕ | 50 and 60 | 100 - 130 | 4 | PE 1644 SA | | PE 3244 SA | |
| | | 50 and 60 | 200 - 250 | 9 | PE 1694 SA | | PE 3294 SA | |
| 50 and 60 | | 380 - 415 | 6 | PE 1664 SA | | PE 3264 SA | | |
| 60 | | 440 - 460 | 11 | PE 16114 SA | | PE 32114 SA | | |
| 50 and 60 | | 480 - 500 | 7 | PE 1674 SA | | PE 3274 SA | | |
| 50 and 60 | | 600 - 690 | 5 | PE 1654 SA | | PE 3254 SA | | |
| 50 | | 380 | 3 | PE 1634 SA | | PE 3234 SA | | |
| 60 | | 440 | 3 | PE 1634 SA | | PE 3234 SA | | |
| 100 - 300 | | > 50 | 10 | PE 16104 SA | | PE 32104 SA | | |
| > 300 - 500 | | > 50 | 2 | PE 1624 SA | | PE 3224 SA | | |
| 3P+N+⊕ | 50 and 60 | 57/100 - 75/130 | 4 | PE 1645 SA | | PE 3245 SA | | |
| | 50 and 60 | 120/208 - 144/250 | 9 | PE 1695 SA | | PE 3295 SA | | |
| | 50 and 60 | 200/346 - 240/415 | 6 | PE 1665 SA | | PE 3265 SA | | |
| | 50 and 60 | 277/480 - 288/500 | 7 | PE 1675 SA | | PE 3275 SA | | |
| | 50 and 60 | 347/600 - 400/690 | 5 | PE 1655 SA | | PE 3255 SA | | |
| | 60 | 250/440 - 265/460 | 11 | PE 16115 SA | | PE 32115 SA | | |
| | 50 | 220/380 | 3 | PE 1635 SA | | PE 3235 SA | | |
| | 60 | 250/440 | 3 | PE 1635 SA | | PE 3235 SA | | |
| | > 300 - 500 | > 50 | 2 | PE 1625 SA | | PE 3225 SA | | |

Legend

A.V. = Colour according to voltage

(*) Green may be used together with the colour of the operating range for frequencies above 60 Hz and up to a maximum of 500 Hz.

(**) For the code of products with nickel-plated contacts (socket holes, plug pins), add "N" to the pre-code of the corresponding standard product code; for example: PE becomes PEN and PEW becomes PEWN.

Accessories for IP67 plugs (optional)

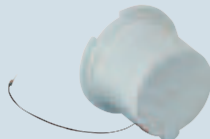

Loose protective cover

| Size | Polarity | Part No. |
|------|----------|------------|
| 16A | 2P+⊕ | PEW 163 CS |
| 16A | 3P+⊕ | PEW 164 CS |
| 16A | 3P+N+⊕ | PEW 165 CS |
| 32A | 2/3P+⊕ | PEW 324 CS |
| 32A | 3P+N+⊕ | PEW 325 CS |

Dimensions indicated are not binding and may be changed without prior notice.

Dimensions in mm

(16 / 32A) PE ... SA

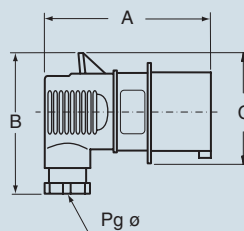

| PE...SA | A | B | C | Pg ø |
|---------|--------|-----|-----|------|
| 16A | 2P+⊕ | 100 | 77 | 59 |
| | 3P+⊕ | 100 | 84 | 68 |
| | 3P+N+⊕ | 106 | 91 | 77 |
| 32A | 2P+⊕ | 131 | 100 | 82 |
| | 3P+⊕ | 131 | 100 | 82 |
| | 3P+N+⊕ | 131 | 107 | 93 |

16A
IP67 degree of protection

32A
IP67 degree of protection



| Part No. | Colour | Part No. | Colour |
|----------------|--------|----------------|--------|
| PEW 1643 SA ⊕ | Yellow | PEW 3243 SA ⊕ | Yellow |
| PEW 1663 SA ⊕ | Blue | PEW 3263 SA ⊕ | Blue |
| PEW 1693 SA ⊕ | Red | PEW 3293 SA ⊕ | Red |
| PEW 1673 SA ⊕ | Black | PEW 3273 SA ⊕ | Black |
| PEW 16123 SA ⊕ | A.V. | PEW 32123 SA ⊕ | A.V. |
| PEW 1623 SA ⊕ | (+) | PEW 3223 SA ⊕ | (+) |
| PEW 1633 SA ⊕ | A.V. | PEW 3233 SA | A.V. |
| PEW 1683 SA | A.V. | PEW 3283 SA | A.V. |
| PEW 1644 SA ⊕ | Yellow | PEW 3244 SA ⊕ | Yellow |
| PEW 1694 SA ⊕ | Blue | PEW 3294 SA ⊕ | Blue |
| PEW 1664 SA ⊕ | Red | PEW 3264 SA ⊕ | Red |
| PEW 16114 SA ⊕ | Red | PEW 32114 SA ⊕ | Red |
| PEW 1674 SA ⊕ | Black | PEW 3274 SA ⊕ | Black |
| PEW 1654 SA | Black | PEW 3254 SA | Black |
| PEW 1634 SA ⊕ | Red | PEW 3234 SA ⊕ | Red |
| PEW 1634 SA ⊕ | Red | PEW 3234 SA ⊕ | Red |
| PEW 16104 SA ⊕ | (+) | PEW 32104 SA ⊕ | (+) |
| PEW 1624 SA ⊕ | (+) | PEW 3224 SA ⊕ | (+) |
| PEW 1645 SA ⊕ | Yellow | PEW 3245 SA ⊕ | Yellow |
| PEW 1695 SA ⊕ | Blue | PEW 3295 SA ⊕ | Blue |
| PEW 1665 SA ⊕ | Red | PEW 3265 SA ⊕ | Red |
| PEW 1675 SA ⊕ | Black | PEW 3275 SA ⊕ | Black |
| PEW 1655 SA | Black | PEW 3255 SA | Black |
| PEW 16115 SA ⊕ | Red | PEW 32115 SA ⊕ | Red |
| PEW 1635 SA ⊕ | Red | PEW 3235 SA ⊕ | Red |
| PEW 1635 SA ⊕ | Red | PEW 3235 SA ⊕ | Red |
| PEW 1625 SA ⊕ | (+) | PEW 3225 SA ⊕ | (+) |

Dimensions in mm

(16 / 32A) PEW ...SA

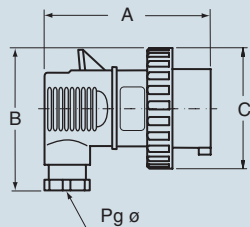

| PEW...SA | A | B | C | Pg ø |
|----------|-----|-----|----|------|
| 16A 2P+⊕ | 100 | 77 | 59 | 13.5 |
| 3P+⊕ | 100 | 84 | 68 | 16 |
| 3P+N+⊕ | 106 | 91 | 77 | 16 |
| 32A 2P+⊕ | 131 | 100 | 82 | 21 |
| 3P+⊕ | 131 | 100 | 82 | 21 |
| 3P+N+⊕ | 131 | 107 | 93 | 21 |

- Compliant with EN 60309-1 and -2
- Enclosure and insert in insulating, thermoplastic and self-extinguishing material
- RAL 7035 grey enclosure, red spring lid (colour coded according to operating voltage)
- Elongated grounding contact to ensure maximum protection (if the electric wire is stretched, the grounding wire will be the last to detach)
- Contact terminals oriented in the same direction to facilitate automated wiring
- Cable anchorage with retained screws
- Nickel-plated contacts on request
- IP44 class of protection (EN 60529)
- With Italian Quality Mark

16A - 32A wall-mounting socket IP44 degree of protection



16A - 32A flush-mounting socket IP44 degree of protection



| Number of poles | Frequency Hz | Voltage V | Rated current | Earthing cont. position h | Part No. | Colour | Part No. | Colour |
|-----------------|--------------|-------------------|---------------|---------------------------|-------------|--------|-------------|--------|
| 3P+N+ | 50 and 60 | 200/346 - 240/415 | 16A | 6 | PEM 1665 PP | | PEM 1665 PI | |
| | 50 and 60 | 200/346 - 240/415 | 32A | 6 | PEM 3265 PP | | PEM 3265 PI | |

Version

In PEM plugs and socket-outlets, the contact holding insert (main part) is incorporated in the front of the enclosure. In these versions, the screws of the 5 terminals are oriented in the same direction in order to simplify automated wiring. The grounding pin is longer at the rear to provide greater safety if the cable anchor breaks. As the wires in the multiple cable are generally cut at the same length, the longer grounding terminal ensures that the last wire to be detached from the terminal is the protective one (PE) if the cable anchor breaks.

Dimensions in mm

PEM ... PP

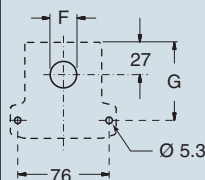
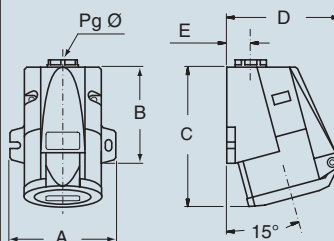

| Type | A | B | C | D | E | F | G | Pg \varnothing |
|------|----|-----|-----|-----|----|----|----|------------------|
| 16A | 88 | 80 | 115 | 95 | 20 | 23 | 65 | 16 |
| 32A | 95 | 105 | 145 | 110 | 24 | 29 | 85 | 21 |

Dimensions in mm

PEM ... PI

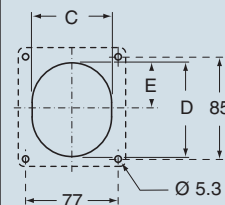
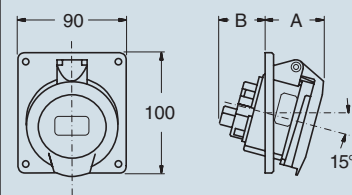

| Type | A | B | C | D | E |
|------|----|----|----|----|----|
| 16A | 48 | 38 | 66 | 78 | 38 |
| 32A | 50 | 52 | 74 | 86 | 40 |

Dimensions indicated are not binding and may be changed without prior notice.

PEM...

16A and 32A coupler socket-outlet
IP44 degree of protection

16A and 32A plugs
IP44 degree of protection

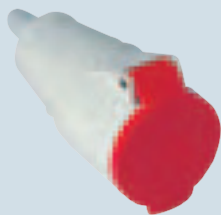

| Part No. | Colour |
|--------------------------|--------|
| PEM 1665 PV [®] | |
| PEM 3265 PV [®] | |

| Part No. | Colour |
|--------------------------|--------|
| PEM 1665 SV [®] | |
| PEM 3265 SV [®] | |

Dimensions in mm

Dimensions in mm

PEM ... PV

PEM ... SV

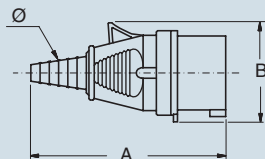
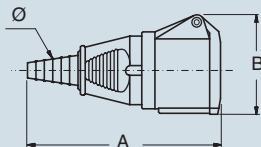

| Type | A | B | ø min | ø max |
|------|-----|----|-------|-------|
| 16A | 158 | 83 | 9 | 22 |
| 32A | 180 | 90 | 9 | 22 |

| Type | A | B | ø min | ø max |
|------|-----|----|-------|-------|
| 16A | 145 | 75 | 9 | 22 |
| 32A | 170 | 87 | 9 | 22 |

- Compliant with EN 60309-1 and -2
- Enclosure and insert in insulating, thermoplastic and self-extinguishing material
- SIP... types (IP44), red enclosure (colour coded according to operating voltage)
SIPW...types RAL 7035 grey enclosure, red bayonet ring (colour coded according to operating voltage)
- Built-in phase inverter device, operated by means of a screwdriver
- SIP... types (IP44), entry with threaded grommet,
SIPW...types (IP67), entry with cable gland,
- Terminals with retained screws
- Nickel-plated contacts on request
- IP44 and IP67 degrees of protection (EN 60529)

16A and 32A wall-mounting plugs IP44 degree of protection



16A and 32A wall-mounting plugs IP67 degree of protection



| Number of poles | Frequency Hz | Voltage V | Rated current | Earthing cont. position h | Part No. | Colour | Part No. | Colour |
|-----------------|--------------|-------------------|---------------|---------------------------|--------------------|--------|---------------------|--------|
| 3P+N+⊕ | 50 and 60 | 200/346 - 240/415 | 16A | 6 | SIP 1665 SM | | SIPW 1665 SM | |
| | 50 and 60 | 200/346 - 240/415 | 32A | 6 | SIP 3265 SM | | SIPW 3265 SM | |

Version

SIP plugs incorporate a mechanical device that exchanges the position of the pins of phases L2 and L3 (phase inverter); this enables the phase cycles to be adapted to the required direction of rotation of three-phase motors. The device can be regulated on the contact side using a screwdriver without having to disassemble the plug.



Accessories for IP67 plugs (optional)

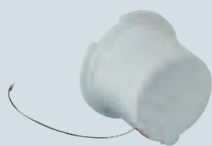

Loose protective cover

| Size | Part No. |
|------------|-------------------|
| 16A | PEW 165 CS |
| 32A | PEW 325 CS |

Dimensions indicated are not binding and may be changed without prior notice.

Dimensions in mm

SIP ... SM

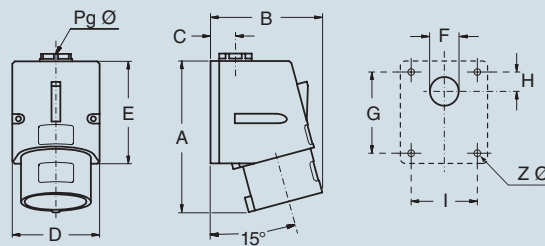

| Type | A | B | C | D | E | F | G | H | I | Z | Pg | Ø |
|------------|-----|----|----|----|-----|----|----|----|----|-----|----|---|
| 16A | 121 | 90 | 20 | 70 | 82 | 23 | 65 | 16 | 53 | 4.3 | 16 | |
| 32A | 147 | 95 | 24 | 86 | 104 | 29 | 79 | 17 | 61 | 6.3 | 21 | |

SIPW ... SM

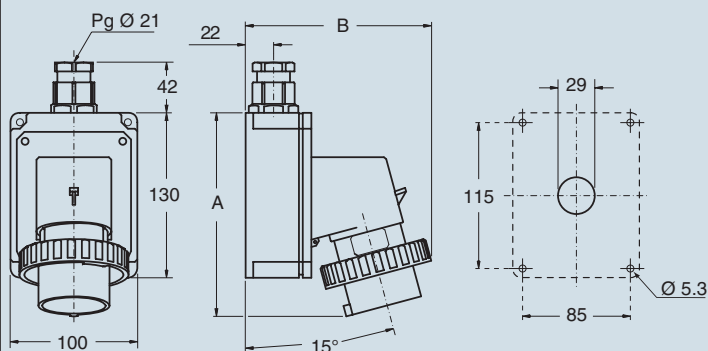

| Type | A | B |
|------------|-----|-----|
| 16A | 164 | 145 |
| 32A | 178 | 160 |

16A and 32A flush-mounting plugs
IP44 degree of protection



16A and 32A flush-mounting plugs
IP67 degree of protection



16A and 32A plugs
IP44 degree of protection



16A and 32A plugs
IP67 degree of protection



| Part No. | Colour | Part No. | Colour | Part No. | Colour | Part No. | Colour |
|-------------|--------|--------------|--------|-------------|--------|--------------|--------|
| SIP 1665 SI | | SIPW 1665 SI | | SIP 1665 SV | | SIPW 1665 SV | |
| SIP 3265 SI | | SIPW 3265 SI | | SIP 3265 SV | | SIPW 3265 SV | |

Dimensions in mm

SIP ... SI

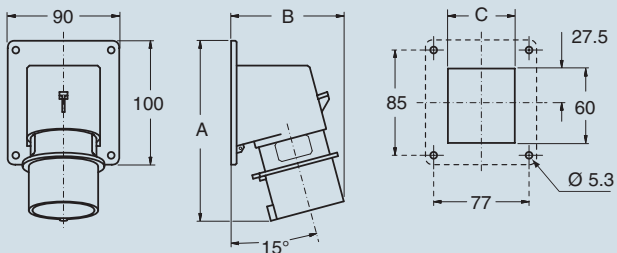

| Type | A | B | C |
|------|-----|-----|----|
| 16A | 146 | 93 | 54 |
| 32A | 160 | 106 | 62 |

SIPW ... SI

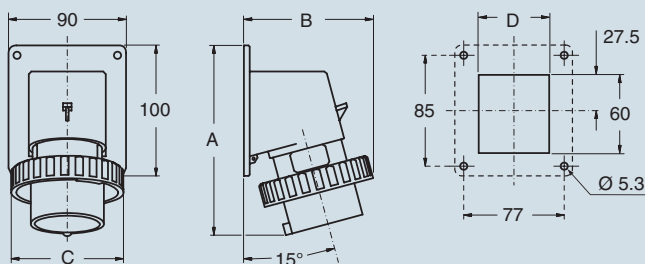

| Type | A | B | C | D |
|------|-----|-----|-----|----|
| 16A | 146 | 99 | 86 | 54 |
| 32A | 160 | 113 | 100 | 62 |

Dimensions in mm

SIP ... SV

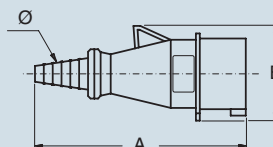

| Type | A | B | ø min | ø max |
|------|-------|----|-------|-------|
| 16A | 167.5 | 75 | 9 | 22 |
| 32A | 192.5 | 87 | 9 | 22 |

SIPW ... SV

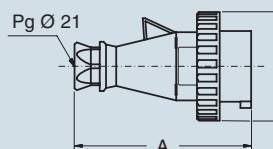

| Type | A | B |
|------|-----|------|
| 16A | 150 | 86 |
| 32A | 175 | 99.5 |

SIP...

- Compliant with EN 60309-1 and -2
- Enclosure, insert and spring lid in insulating, thermoplastic, self-extinguishing material
- RAL 7035 grey enclosure
- Spring lid colour coded according to operating voltage and frequency
- Wall-mounting types PB...PP, top entry with threaded grommet (replaceable with cable gland)
- Flush-mounting types PB...PI, flange with anti-aging gasket
- Coupler types PB...PV, cable anchoring collar incorporated in the insert, entry with grommet
- Terminals with retained screws
- Nickel-plated contacts on request
- IP44 degree of protection (EN 60529)
- With Italian Quality Mark

16A wall-mounting socket
IP44 degree of protection



32A wall-mounting socket
IP44 degree of protection



| Number of poles | Frequency Hz | Voltage V | Earthing contact position h | Part No. | Colour | Part No. | Colour |
|-----------------|----------------------|---------------------|-----------------------------|-------------|--------|-------------|--------|
| 2P | 50 and 60 | 20 - 25 | - | PB 16002 PP | | PB 32002 PP | |
| | 50 and 60 | 40 - 50 | 12 | PB 16122 PP | | PB 32122 PP | |
| | > 100 - 200 included | 20 - 25 and 40 - 50 | 4 | PB 16042 PP | | PB 32042 PP | |
| | 300 | 20 - 25 and 40 - 50 | 2 | PB 16022 PP | | PB 32022 PP | |
| | 400 | 20 - 25 and 40 - 50 | 3 | PB 16032 PP | | PB 32032 PP | |
| | > 400 - 500 included | 20 - 25 and 40 - 50 | 11 | PB 16112 PP | | PB 32112 PP | |
| | DC | 20 - 25 and 40 - 50 | 10 | PB 16102 PP | | PB 32102 PP | |
| 3P | 50 and 60 | 20 - 25 | - | PB 16003 PP | | PB 32003 PP | |
| | 50 and 60 | 40 - 50 | 12 | PB 16123 PP | | PB 32123 PP | |
| | > 100 - 200 included | 20 - 25 and 40 - 50 | 4 | PB 16043 PP | | PB 32043 PP | |
| | 300 | 20 - 25 and 40 - 50 | 2 | PB 16023 PP | | PB 32023 PP | |
| | 400 | 20 - 25 and 40 - 50 | 3 | PB 16033 PP | | PB 32033 PP | |
| | > 400 - 500 included | 20 - 25 and 40 - 50 | 11 | PB 16113 PP | | PB 32113 PP | |
| | | | | | | PB 32103 PP | |

(*) Green may be used together with the colour of the operating range for frequencies above 60 Hz and up to a maximum of 500 Hz.

Dimensions in mm

(16 / 32A) PB ... PP

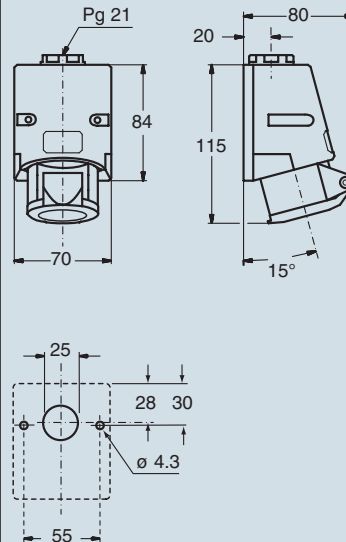

Dimensions indicated are not binding and may be changed without prior notice.

16A flush-mounting socket-outlets
IP44 degree of protection

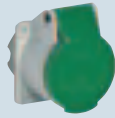

32A flush-mounting socket-outlets
IP44 degree of protection



16A couplers
IP44 degree of protection



32A couplers
IP44 degree of protection



| Part No. | Colour | Part No. | Colour | Part No. | Colour | Part No. | Colour |
|---------------|--------|---------------|--------|---------------|--------|---------------|--------|
| PB 16002 PI ☉ | | PB 32002 PI ☉ | | PB 16002 PV ☉ | | PB 32002 PV ☉ | |
| PB 16122 PI ☉ | | PB 32122 PI ☉ | | PB 16122 PV ☉ | | PB 32122 PV ☉ | |
| PB 16042 PI ☉ | | PB 32042 PI ☉ | | PB 16042 PV ☉ | | PB 32042 PV ☉ | |
| PB 16022 PI ☉ | | PB 32022 PI ☉ | | PB 16022 PV ☉ | | PB 32022 PV ☉ | |
| PB 16032 PI ☉ | | PB 32032 PI ☉ | | PB 16032 PV ☉ | | PB 32032 PV ☉ | |
| PB 16112 PI ☉ | | PB 32112 PI ☉ | | PB 16112 PV ☉ | | PB 32112 PV ☉ | |
| PB 16102 PI ☉ | | PB 32102 PI ☉ | | PB 16102 PV ☉ | | PB 32102 PV ☉ | |
| PB 16003 PI ☉ | | PB 32003 PI ☉ | | PB 16003 PV ☉ | | PB 32003 PV ☉ | |
| PB 16123 PI ☉ | | PB 32123 PI ☉ | | PB 16123 PV ☉ | | PB 32123 PV ☉ | |
| PB 16043 PI ☉ | | PB 32043 PI ☉ | | PB 16043 PV ☉ | | PB 32043 PV ☉ | |
| PB 16023 PI ☉ | | PB 32023 PI ☉ | | PB 16023 PV ☉ | | PB 32023 PV ☉ | |
| PB 16033 PI ☉ | | PB 32033 PI ☉ | | PB 16033 PV ☉ | | PB 32033 PV ☉ | |
| PB 16113 PI ☉ | | PB 32113 PI ☉ | | PB 16113 PV ☉ | | PB 32113 PV ☉ | |

Dimensions in mm

(16 / 32A) PB ... PI

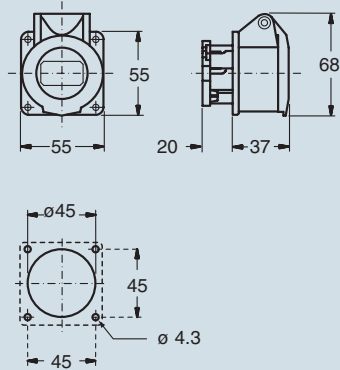

Dimensions in mm

(16 / 32A) PB ... PV

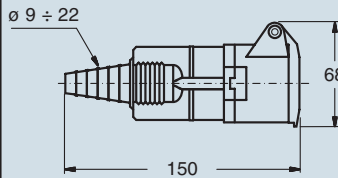

- Compliant with EN 60309-1 and -2
- Enclosure and insert in insulating, thermoplastic and self-extinguishing material
- RAL 7035 grey enclosure
- Plug mouth colour coded according to operating voltage and frequency
- PB...SM wall-mounting types, top entry with threaded grommet (replaceable with cable gland)
- PB...SV coupler types, cable anchoring collar incorporated in the collar, entry with grommet
- Terminals with retained screws
- Nickel-plated contacts on request
- IP44 degree of protection (EN 60529)
- With Italian Quality Mark

16A wall-mounting plugs
IP44 degree of protection



32A wall-mounting plugs
IP44 degree of protection



PB...SM

| Number of poles | Frequency Hz | Voltage V | Earthing contact position h | Part No. | Colour | Part No. | Colour |
|-----------------|----------------------|---------------------|-----------------------------|--------------------|--------|--------------------|--------|
| 2P | 50 and 60 | 20 - 25 | - | PB 16002 SM | | PB 32002 SM | |
| | 50 and 60 | 40 - 50 | 12 | PB 16122 SM | | PB 32122 SM | |
| | > 100 - 200 included | 20 - 25 and 40 - 50 | 4 | PB 16042 SM | | PB 32042 SM | |
| | 300 | 20 - 25 and 40 - 50 | 2 | PB 16022 SM | | PB 32022 SM | |
| | 400 | 20 - 25 and 40 - 50 | 3 | PB 16032 SM | | PB 32032 SM | |
| | > 400 - 500 included | 20 - 25 and 40 - 50 | 11 | PB 16112 SM | | PB 32112 SM | |
| | DC | 20 - 25 and 40 - 50 | 10 | PB 16102 SM | | PB 32102 SM | |
| 3P | 50 and 60 | 20 - 25 | - | PB 16003 SM | | PB 32003 SM | |
| | 50 and 60 | 40 - 50 | 12 | PB 16123 SM | | PB 32123 SM | |
| | > 100 - 200 included | 20 - 25 and 40 - 50 | 4 | PB 16043 SM | | PB 32043 SM | |
| | 300 | 20 - 25 and 40 - 50 | 2 | PB 16023 SM | | PB 32023 SM | |
| | 400 | 20 - 25 and 40 - 50 | 3 | PB 16033 SM | | PB 32033 SM | |
| | > 400 - 500 included | 20 - 25 and 40 - 50 | 11 | PB 16113 SM | | PB 32113 SM | |
| | | | | | | PB 32103 SM | |

(*) Green may be used together with the colour of the operating range for frequencies above 60 Hz and up to a maximum of 500 Hz.

Dimensions in mm

(16 / 32A) PB ... SM

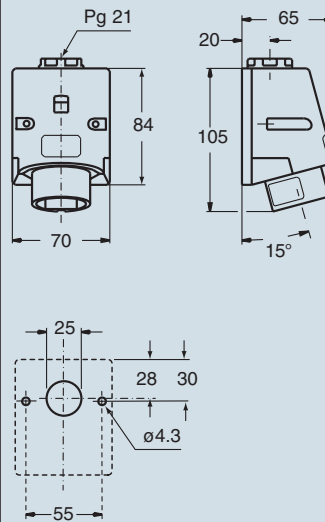

Dimensions indicated are not binding and may be changed without prior notice.

16A plugs
IP44 degree of protection

32A plugs
IP44 degree of protection



| Part No. | Colour | Part No. | Colour |
|---------------|--------|---------------|--------|
| PB 16002 SV ☉ | | PB 32002 SV ☉ | |
| PB 16122 SV ☉ | | PB 32122 SV ☉ | |
| PB 16042 SV ☉ | | PB 32042 SV ☉ | |
| PB 16022 SV ☉ | | PB 32022 SV ☉ | |
| PB 16032 SV ☉ | | PB 32032 SV ☉ | |
| PB 16112 SV ☉ | | PB 32112 SV ☉ | |
| PB 16102 SV ☉ | | PB 32102 SV ☉ | |
| PB 16003 SV ☉ | | PB 32003 SV ☉ | |
| PB 16123 SV ☉ | | PB 32123 SV ☉ | |
| PB 16043 SV ☉ | | PB 32043 SV ☉ | |
| PB 16023 SV ☉ | | PB 32023 SV ☉ | |
| PB 16033 SV ☉ | | PB 32033 SV ☉ | |
| PB 16113 SV ☉ | | PB 32113 SV ☉ | |

Dimensions in mm

(16 / 32A) PB ... SV

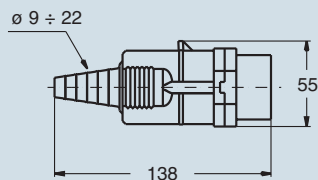

X-ON Electronics

Largest Supplier of Electrical and Electronic Components

Click to view similar products for [ilme](#) manufacturer:

Other Similar products are found below :

[CSHF 10](#) [CZAP 25 L](#) [CDSHF 18](#) [CHI 06 LS](#) [TAPC 06 L25](#) [CHO 24](#) [CNEM 24 T](#) [TAPC 10.25](#) [TAPH 16.32](#) [TAPW 06 L25](#) [PE3264SV](#)
[PE1664SV](#) [CXM4/0](#) [COB 06 CMS](#) [APV21](#) [PEW3265PV](#) [CQEM18](#) [CCPZTP](#) [CZIR 06 L](#) [CHP 06 LS2](#) [TAPC 24.32](#) [TAVH 10 G32](#) [THCH](#)
[06 LG](#) [THIW 10](#) [THIW 16](#) [AS C21T](#) [PEW1663SV](#) [CQEF32](#) [CK 03 IAPNS](#) [TAVC 10 G32](#) [PE3265PV](#) [PE1643PI](#) [CHC10LG](#) [AS C36T](#)
[CDMD0.5](#) [CCMA4.0](#) [CSHM 24](#) [JNEM 06](#) [TAVW 10 G32](#) [CAVR 06 L21](#) [CK 03 C](#) [TAVC 06 LG25](#) [AS C16T](#) [AS C21O](#) [MHP 48 LS50](#)
[PEW3263PV](#) [CQEF10](#) [TAVH 10 G25](#) [CRR 36](#) [CRR 42](#)