

Engineer Drawing

NOTES:

MATERIAL:

- 1.HOUSING:THERMO-PLASTIC. UL 94V-0 NATURE
- 2.CONTACT:PHOSPHOR BRONZE
- CONTACT:SEE ORDER INFORMATION; SOLDER:GOLD FLASH UNDERPLATING:50~120u" NICKEL OVERALL

ELECTRICAL:

- 1.CURRENT RATING:0.5A 60V AC/DC
- 2.WITHSTANDING VOLTAGE:150V AC for 1 min
- 3.CONTACT RESISTANCE:90mΩ MAX
- 4.INSULATION RESISTANCE:1000MΩ MIN

ENVIRONMENTAL:

- 1. OPERATING TEMPERATURE:-55°C TO +125 °C

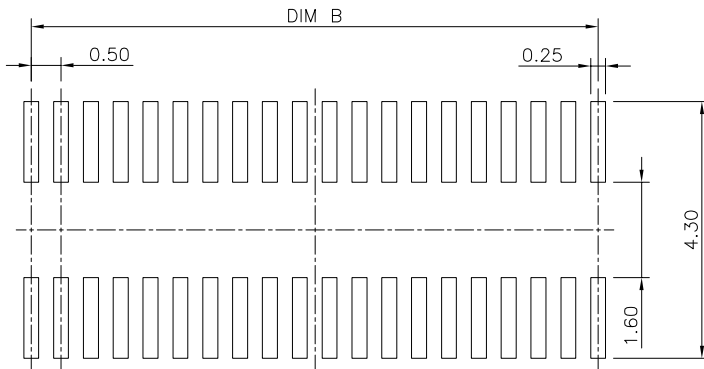
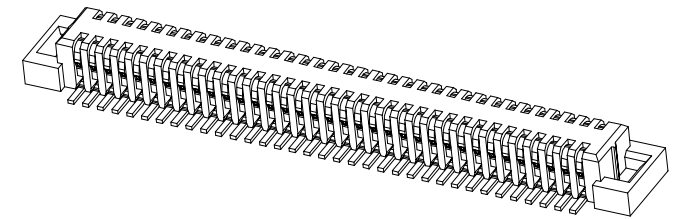
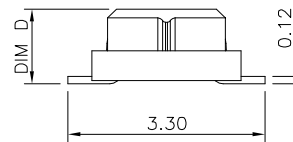
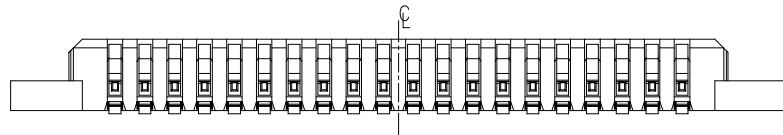
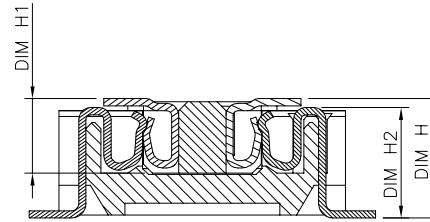
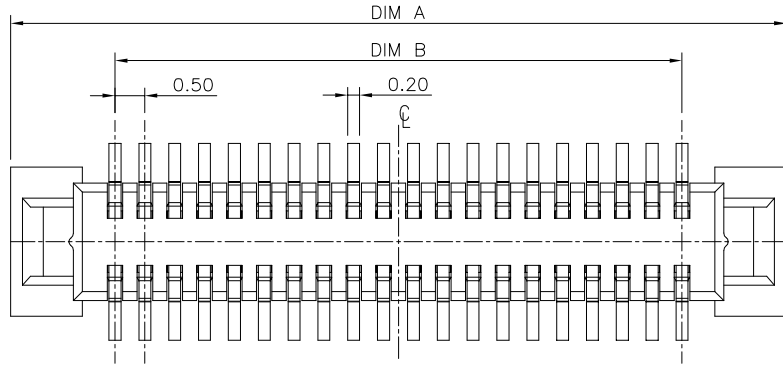

RECOMMENDED PCB LAYOUT
TOLERANCE:±0.05

- IPCB05XX2* ** * * *
- ① ② ③ ④ ⑤ ⑥
- ① Series Type
 - ② Type
 - ③ Pin code.
 - ④ internal code
 - ⑤ Company code.
 - ⑥ other code

PIN	DIM A	DIM B
10P	5.50	2.00
12P	6.00	2.50
14P	6.50	3.00
16P	7.00	3.50
20P	8.00	4.50
22P	8.50	5.00
24P	9.00	5.50
30P	10.50	7.00
34P	11.50	8.00
40P	13.00	9.50
50P	15.50	12.00
60P	18.00	14.50
70P	20.50	17.00
80P	23.00	19.50
100P	28.00	24.50

DIM H	DIM H1	DIM H2
1.50	1.25	1.35
2.00	1.25	1.85
2.50	1.75	1.85

<p>TOLERANCE</p> <p>X ±0.5 XX ±0.25</p> <p>X ±0.35 .XXX ±0.15</p> <p>ANGLES ± 0.3°</p> <p>UNLESS OTHERWISE SPECIFIED</p>			www. i-ncp. com		
	PART NO. IPCB05XX2 xx		TITLE: 0.5mm Borad to Borad		
	DRAWING NO. IPCB05XX2		H=1.5/2.0/2.5mm male		
		SHEET 1 OF 1	UNITS mm	SCALE 1:1	REV. 01

X-ON Electronics

Largest Supplier of Electrical and Electronic Components

Click to view similar products for [Board to Board & Mezzanine Connectors](#) category:

Click to view products by [INCP](#) manufacturer:

Other Similar products are found below :

[589158040000018](#) [MDF7C-18P-2.54DSA\(55\)](#) [FCN-268F036-G/BD](#) [FCN-268M012-G/0D](#) [FCN-268M024-G/1D](#) [MIS-048-01-F-D-DP-K](#)
[832-10-034-10-001000](#) [FX4C-80S-1.27DSA](#) [93696-330](#) [224393](#) [FCN-235D050-G/C](#) [210-93-314-41-105000](#) [MDF7-40DP-2.54DSA\(55\)](#)
[MIT-114-03-F-D-K](#) [55323-1519](#) [026-6203-PDB](#) [027-6203-PDB](#) [069159702701000](#) [101A10019X](#) [105061100000861+](#) [55650-0588-C](#) [75140-](#)
[7012](#) [87471-650](#) [YTW-30-07-H-Q-410-140](#) [YTT-112-01-H-Q](#) [063209](#) [10124054-515LF](#) [68685-603](#) [8-1616154-3](#) [MIS-019-01-F-D](#) [YTQ-](#)
[12103HQ](#) [541371078](#) [IL-WX-10PB-HF-B-E1000E](#) [FCN-214J100-G/0](#) [FCN-230C068-E/S](#) [354184](#) [MIT-019-04-F-D-K](#) [P50-028-DDS-TG](#)
[53309-2471](#) [54546-2071](#) [1586617-1](#) [504208-3010](#) [504208-5010](#) [504248-1010](#) [504248-1210](#) [504248-2010](#) [LST-115-07-S-D](#) [LST-105-07-G-](#)
[D](#) [9159005551906](#) [6258](#)