

Engineer Drawing

Specifications :

- Voltage rating: 250V AC / DC
- Current rating: 5A AC / DC
- Withstanding voltage: 1000V AC/minute
- Temperature range: -40°C~+105°C
- Insulation resistance: ≥1000MΩ
- Contact resistance: ≤10mΩ
- After environmental testing: ≤20mΩ
- Material: N-PA66 94V-2

P-PA66 94V-0

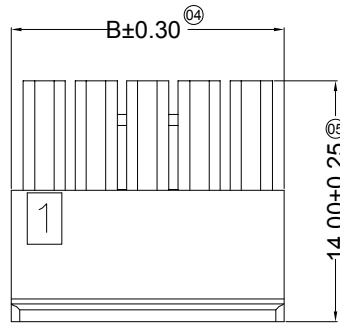
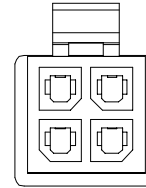
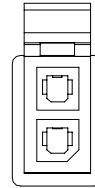
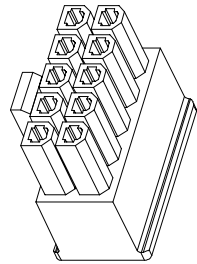
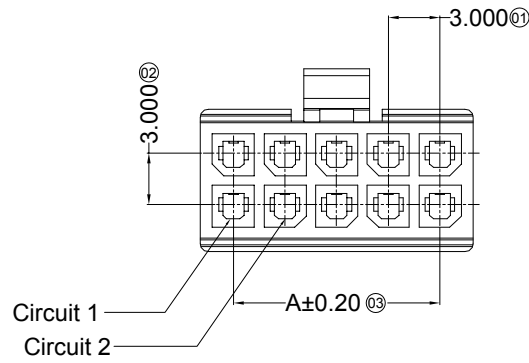

2*03P-2*12P

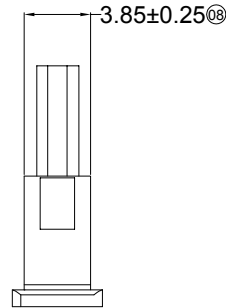
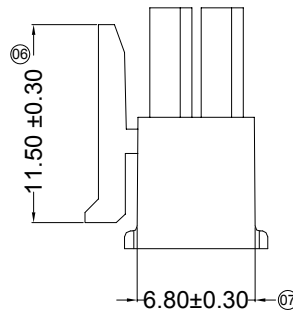

2*01P

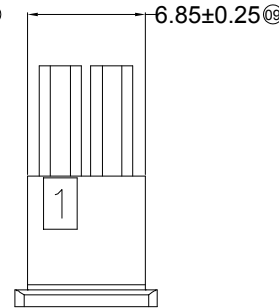

2*02P

Poles	Dimensions(mm)		Poles	Dimensions(mm)	
	A	B		A	B
2*01			2*07	18.00	21.85
2*02	3.00		2*08	21.00	24.85
2*03	6.00	9.85	2*09	24.00	27.85
2*04	9.00	12.85	2*10	27.00	30.85
2*05	12.00	15.85	2*11	30.00	33.85
2*06	15.00	18.85	2*12	33.00	36.85

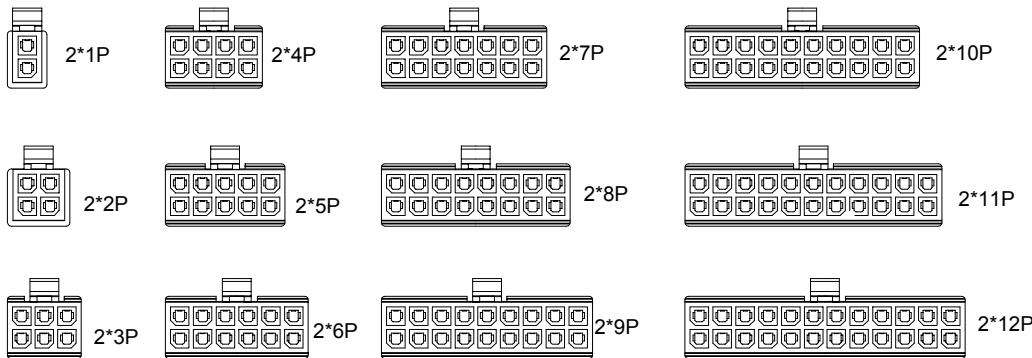

IPCW300H ** * * * * *

① ② ③ ④ ⑤ ⑥ ⑦

- ① Series Type
- ② Pin code.
- ③ Material code.
- ④ Appereace code.
- ⑤ Internal code
- ⑥ Company code.
- ⑦ Other code.

TOLERANCE .X ±0.30 .XX ±0.20 .XXX ±0.10 UNLESS OTHERWISE SPECIFIED			www.i-ncp.com	
	PART NO. IPCW300H XX		TITLE: Pitch 3.0mm housing	
	DRAWING NO. IPCW300H			
		④ SHEET 1 OF 1	UNITS mm	SCALE 1:1
				REV. 01

X-ON Electronics

Largest Supplier of Electrical and Electronic Components

Click to view similar products for [Headers & Wire Housings](#) category:

Click to view products by [INCP](#) manufacturer:

Other Similar products are found below :

[0015917161](#) [0022155065](#) [57102-F02-18ULF](#) [58102-G61-06LF](#) [582553-1](#) [01.001.5753.1](#) [0050291907](#) [02.125.8002.8](#) [609-3404](#) [61062-3](#)
[CSU011177004](#) [622-0430](#) [622-3653LF](#) [63453-116](#) [636-1030](#) [636-1427](#) [636-3427](#) [636-4007](#) [641938-9](#) [65495-038](#) [65692-001LF](#) [65781-018](#)
[65781-047](#) [65817-010LF](#) [65817-015LF](#) [67095-007LF](#) [67601157](#) [68631-112](#) [699319-000](#) [70.362.1628.0](#) [70-4210](#) [70-4226B](#) [70-4853B](#) [707-](#)
[5028](#) [71.350.2428.0](#) [733-134](#) [733-162](#) [760-3052](#) [MHR-64-VUAL](#) [80.063.4001.1](#) [800-90-001-10-001000](#) [801-43-002-10-013000](#)
[801-43-006-10-002000](#) [803-43-024-10-001000](#) [803-93-012-10-001000](#) [8-1437020-4](#) [819-22-004-30-001101](#) [820-22-006-30-001101](#)
[820-22-008-30-001101](#) [821-22-002-10-001101](#)