

ROHS COMPLIANT

REV.	DESCRIPTION	DATE	ECN NO.
01	NEW DESIGN	2018/11/29	-

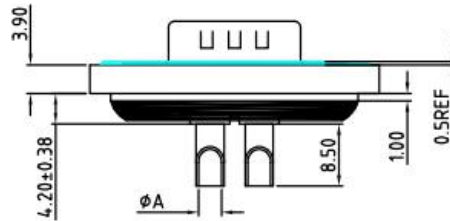
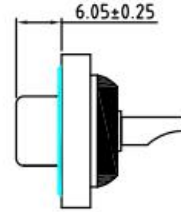
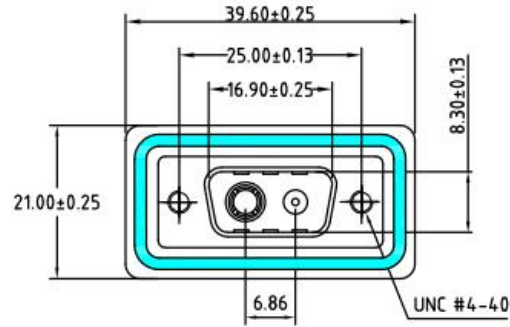

REMARKS:

1. MATERIALS AND FINISH

SHELL : STEEL MATERIAL, FRONT NICKEL FINISHED
 BACK SHELL TIN FINISHED
 INSULATOR : PBT THERMOPLASTIC, 30% GLASS
 FILLED, UL 94V-0 RATED
 CONTACT MATERIAL : BRASS
 CONTACT FINISH : FULL GOLD FLASH

2. ELECTRICAL CHARACTERISTICS

CONTACT CURRENT RATING : 10/20/30/40AMPS
 CONTACT RESISTANCE : 2.7 MILLIOHMS MAX.
 DIELECTRIC WITHSTANDING VOLTAGE : 1000 V AC MIN.
 INSULATION RESISTANCE : 5000 MEGAOHMS MIN.
 TEMPERATURE RATING : -55°C ~ +125°C

Current Rating	Dimension
	φ A
40 AMPS	φ3.75
30 AMPS	φ3.2
20 AMPS	φ2.8
10 AMPS	φ1.7

DRAWN:	JEFF.ZHOU	2018.11.29	东莞市赢海电子有限公司
CHECKED:	KEVIN.JIN	2018.11.29	
APPROVED:	JINGUO.YANG	2018.11.29	
	Sheet 1 of 1	Code 000	TITLE:
Dimensions in mm(inches)		Scale 1:1	HIGH CURRENT CONNECTOR,SOLDER TYPE_WATERPROOF
TOLERANCE UNLESS SPECIFIED: .XX ± 0.13		Angles:±2°	REV. 01 Part No: GDM2W2F/M-20A180°

X-ON Electronics

Largest Supplier of Electrical and Electronic Components

Click to view similar products for [INGHAI](#) manufacturer:

Other Similar products are found below :

[GDM09F-180](#) [GDM09M-180](#) [GDM13W3F-20A90](#) [GDM13W3M-20A90](#) [GDM15F-180](#) [GDM15M-180](#) [GDM25F-180](#) [GDM25M-180](#)
[GDM2W2F/F-20A180](#) [GDM2W2F/M-20A180](#) [GDM37F-180](#) [GDM37M-180](#) [GDM5W5M-20A180](#) [GDP09F-180](#) [GDP09M-180](#) [GDP25M-180](#) [GDP37F-180](#) [GDP37M-180](#) [GDP50F-180](#) [GDP50M-180](#) [GDR09F-180](#) [GDR09M-180](#) [GHDM15F-180](#) [GHDM15M-180](#) [GHDM62M-180](#) [GHDP15F-180](#) [GHDP15M-180](#) [GHDP62F-180](#) [GHDP62M-180](#) [GMA2718H09-B38-3P](#) [GMA2718H09-F42-4P](#) [GMA3325H10-B38-3P](#) [GMA3526H10-B26](#) [GMA3729H11-F42](#) [GMA3730H11-B38](#) [GMA4030H11-F26](#) [GMBO3015GSB-45DB](#) [GMBU14065CSC-42DB](#) [GMBU14065CSC-44DB](#) [GMBU14065CSC-46DB](#) [GMBU16065CSC-01-41DB](#) [GMBU16065CSC-01-43DB](#) [GMBU16065CSC-01-45DB](#) [GMBU16065CSC-02-41DB](#) [GMBU16065CSC-02-43DB](#) [GMBU16065CSC-02-45DB](#) [GMBU4015CSC-50DB](#) [GMBU4015CSC-52DB](#) [GMBU4015CSC-54DB](#) [GMBU6027CSC-03-50DB](#)