

Receptacle  
**KS-100 47 40**  
Item KS-1004740

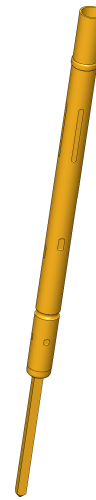

**ingun**<sup>®</sup>  
Partner for Future Technology

**INGUN SELECTION**



1:1

# Receptacle

## KS-100 47 40

Item KS-1004740



### General data

|                               |                         |
|-------------------------------|-------------------------|
| Product group                 | Receptacles (KS)        |
| Series                        | KS-100                  |
| Sub-series                    | KS-100 press-in version |
| Type of receptacle connection | Wire-wrap               |
| Press ring                    | No                      |
| Surface area                  | Gold                    |
| Collar diameter               | 1.8 mm [.070 in]        |
| Collar height                 | 4 mm [.157 in]          |
| Wire-wrap post length         | 9.3 mm [.366 in]        |
| Knurl                         | No                      |
| Vacuum-tight                  | yes (< 1 ccm / min)     |
| RoHS-compliant                | Yes                     |

### INGUN SELECTION

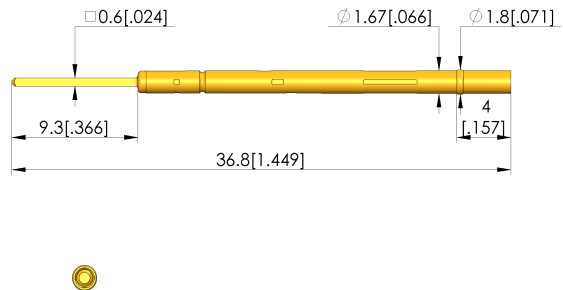

### Mounting hole

|                       |                                 |
|-----------------------|---------------------------------|
| Mounting hole in CEM1 | 1.68 - 1.69 mm [.066 - .066 in] |
| Mounting hole in FR4  | 1.69 - 1.70 mm [.066 - .066 in] |

### Mechanical data

|                |                   |
|----------------|-------------------|
| Total length   | 36.8 mm [1.44 in] |
| Outer diameter | 1.67 mm [.065 in] |

### INGUN Prüfmittelbau GmbH

Max-Stromeyer-Straße 162  
78467, Constance, Germany  
Phone +49 7531 8105-0  
Customer hotline +49 7531 8105-888  
Fax +49 7531 8105-65  
info@ingun.com



Weitere Informationen zum Thema  
Test probes



## X-ON Electronics

Largest Supplier of Electrical and Electronic Components

*Click to view similar products for [Contact Probes](#) category:*

*Click to view products by [INGUN](#) manufacturer:*

Other Similar products are found below :

[CT5253](#) [S-4-C-5-G S/C](#) [SS-75-B-2.4-G](#) [ICT-100-J-17-G](#) [300106-000-1103](#) [ICT-100-A-8-G S/C](#) [ICT-075-B-10-G-S S/C](#) [S-2-D-8.3-G D/C](#)  
[ICT-100-T-8-G S/C](#) [GSS-4-7-G](#) [S-0-B9-2.5-G S/C](#) [SS-40-J-2.4-G D/C](#) [S-0-V-3.7-G S/C](#) [SX-1-U-6.6-G D/C](#) [SS-50-J-5.1-G S/C](#) [SS-40-J-1.8-](#)  
[G-N/L D/C](#) [SS-3-7-G S/C W/HOLE .373 OAL](#) [SS-10-7-G S/C W/HOLE .373 OAL](#) [SS-1-7-G S/C W/HOLE .385 OAL](#) [SHE-5-H-18.7-G](#)  
[SHE-5-B-18.7-G](#) [SHE-3-A-7-G](#) [SH-4-A-10-G S/C](#) [S-50C-HS-4.3-DG-S](#) [S-5-F-8-G S/C SS SPGS](#) [S-5-F-16.4-G S/C](#) [S-4-K-5-G S/C](#) [S-4-E-5-](#)  
[D S/C](#) [S-2-J-8.3-G D/C](#) [S-2-E-10-D D/C](#) [S-2-A-10-D D/C](#) [S-100-UR-5.5-G-S](#) [S-100-T-8-RT](#) [S-100-J-17-G](#) [S-100-HK-10-G](#) [S-100-D-6.7-G](#)  
[S-100-B-3.5-G-S](#) [S-100-B-3.5-G](#) [S-1-U-6.6-D D/C .670 OAL](#) [S-1-A-6.6-D D/C .670 OAL](#) [S-075-S-3.8-RT](#) [S-075-J-3-G](#) [S-075-B-3-G](#) [S-075-](#)  
[A-7-G](#) [S-00-U-1.6-G D/C SS SPG](#) [S-00-ES-2-G D/C](#) [S-0-U-3.7-D S/C](#) [RX-100-SC](#) [RH-100-WW-429](#) [QUAD-0C-12-1](#)