

KS with a square post and press ring

KS-100 47 G

Item KS-10047G



ingun[®]

Partner for Future Technology

INGUN SELECTION

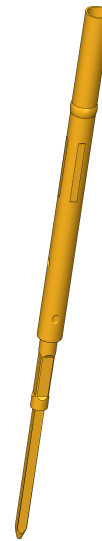

1:1

KS with a square post and press ring

KS-100 47 G

Item KS-10047G



GO TO PRODUCT

ingun®

Partner for Future Technology

General data

Product group	Receptacles (KS)
Series	KS-100
Sub-series	KS-100 press-in version
Type of receptacle connection	Wire-wrap
Press ring	Yes
Surface area	Gold
Collar diameter	1.85 mm [.072 in]
Collar height	7.6 mm [.299 in]
Wire-wrap post length	10 mm [.393 in]
Knurl	No
Vacuum-tight	yes (< 1 ccm / min)
RoHS-compliant	Yes

INGUN SELECTION

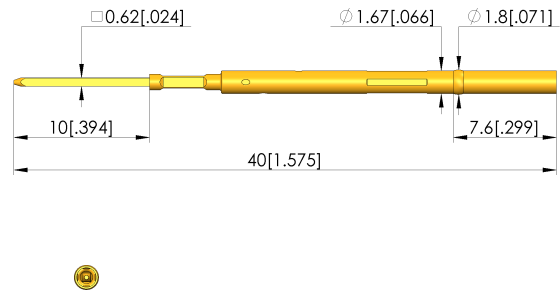

Mounting hole

Mounting hole in CEM1	1.68 - 1.69 mm [.066 - .066 in]
Mounting hole in FR4	1.69 - 1.70 mm [.066 - .066 in]
Mounting hole with press ring in CEM1	1.70 - 1.75 mm [.066 - .068 in]
Mounting hole with press ring in FR4	1.70 - 1.75 mm [.066 - .068 in]

Mechanical data

Total length	40 mm [1.57 in]
Outer diameter	1.67 mm [.065 in]

INGUN Prüfmittelbau GmbH

Max-Stromeyer-Straße 162
78467, Constance, Germany
Phone +49 7531 8105-0
Customer hotline +49 7531 8105-888
Fax +49 7531 8105-65
info@ingun.com



Prices and delivery times on request.
Technical changes reserved. 11/22 EN

Weitere Informationen zum Thema
Test probes



RECEPTACLES

X-ON Electronics

Largest Supplier of Electrical and Electronic Components

Click to view similar products for [Contact Probes](#) category:

Click to view products by [INGUN](#) manufacturer:

Other Similar products are found below :

[CT5253](#) [S-4-C-5-G S/C](#) [SS-75-B-2.4-G](#) [ICT-100-J-17-G](#) [300106-000-1103](#) [ICT-100-A-8-G S/C](#) [ICT-075-B-10-G-S S/C](#) [S-2-D-8.3-G D/C](#)
[ICT-100-T-8-G S/C](#) [GSS-4-7-G](#) [S-0-B9-2.5-G S/C](#) [SS-40-J-2.4-G D/C](#) [S-0-V-3.7-G S/C](#) [SX-1-U-6.6-G D/C](#) [SS-50-J-5.1-G S/C](#) [SS-40-J-1.8-](#)
[G-N/L D/C](#) [SS-3-7-G S/C W/HOLE .373 OAL](#) [SS-10-7-G S/C W/HOLE .373 OAL](#) [SS-1-7-G S/C W/HOLE .385 OAL](#) [SHE-5-H-18.7-G](#)
[SHE-5-B-18.7-G](#) [SHE-3-A-7-G](#) [SH-4-A-10-G S/C](#) [S-50C-HS-4.3-DG-S](#) [S-5-F-8-G S/C SS SPGS](#) [S-5-F-16.4-G S/C](#) [S-4-K-5-G S/C](#) [S-4-E-5-](#)
[D S/C](#) [S-2-J-8.3-G D/C](#) [S-2-E-10-D D/C](#) [S-2-A-10-D D/C](#) [S-100-UR-5.5-G-S](#) [S-100-T-8-RT](#) [S-100-J-17-G](#) [S-100-HK-10-G](#) [S-100-D-6.7-G](#)
[S-100-B-3.5-G-S](#) [S-100-B-3.5-G](#) [S-1-U-6.6-D D/C .670 OAL](#) [S-1-A-6.6-D D/C .670 OAL](#) [S-075-S-3.8-RT](#) [S-075-J-3-G](#) [S-075-B-3-G](#) [S-075-](#)
[A-7-G](#) [S-00-U-1.6-G D/C SS SPG](#) [S-00-ES-2-G D/C](#) [S-0-U-3.7-D S/C](#) [RX-100-SC](#) [RH-100-WW-429](#) [QUAD-0C-12-1](#)