

版数 REV.	年月日 DATE	DCN NO.	変更内容 DESCRIPTION	製図 DR.	担当 CHK.	査閲 APPD.	承認 APPD.

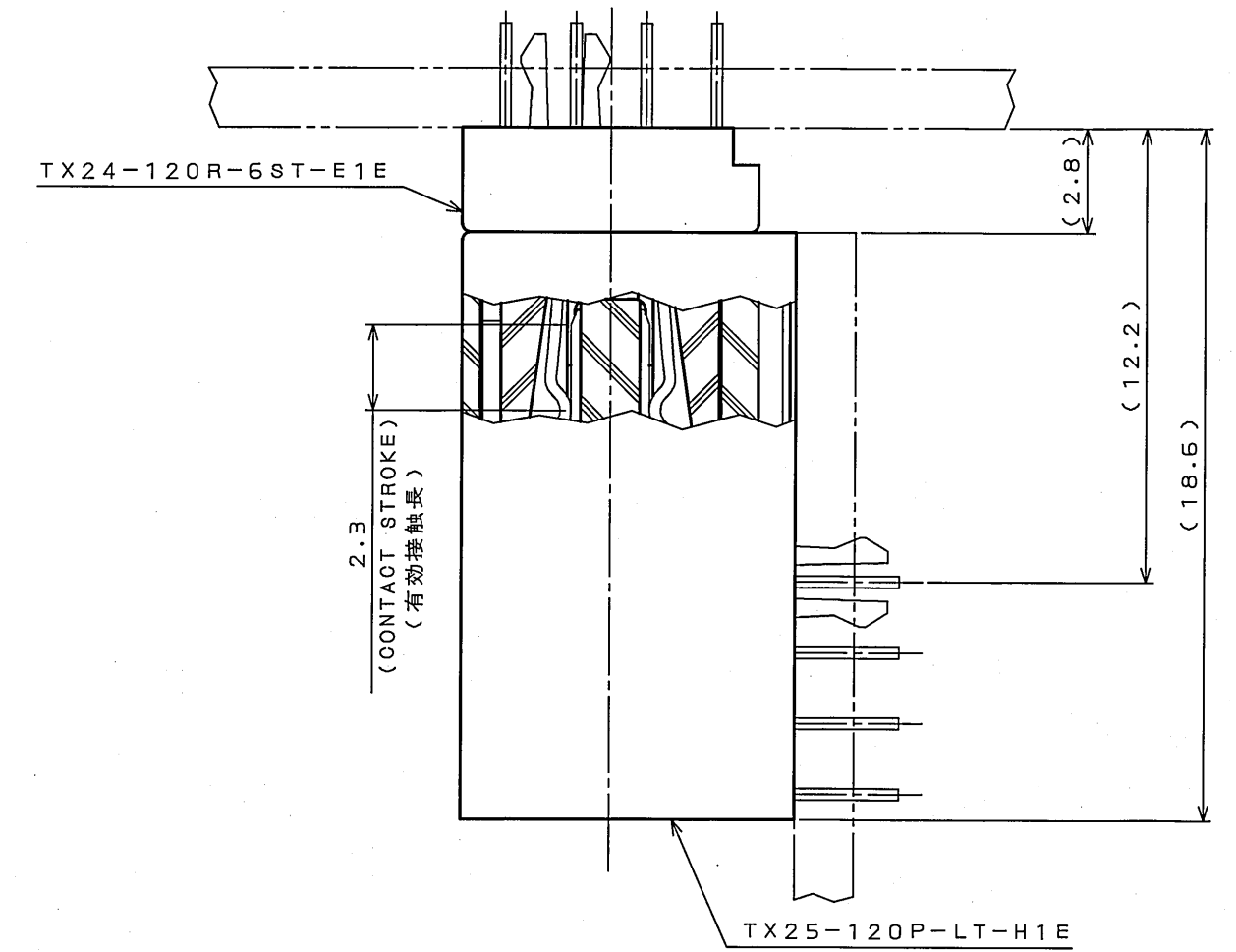

MATED CONDITION (REF.)  
嵌合状態図 (参考)  
(SCALE 5:1)

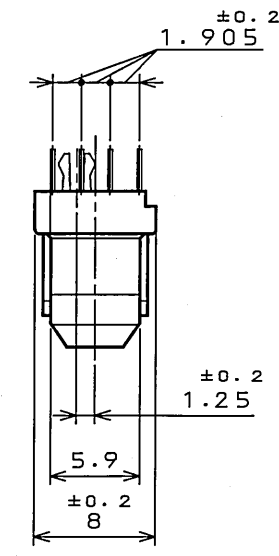
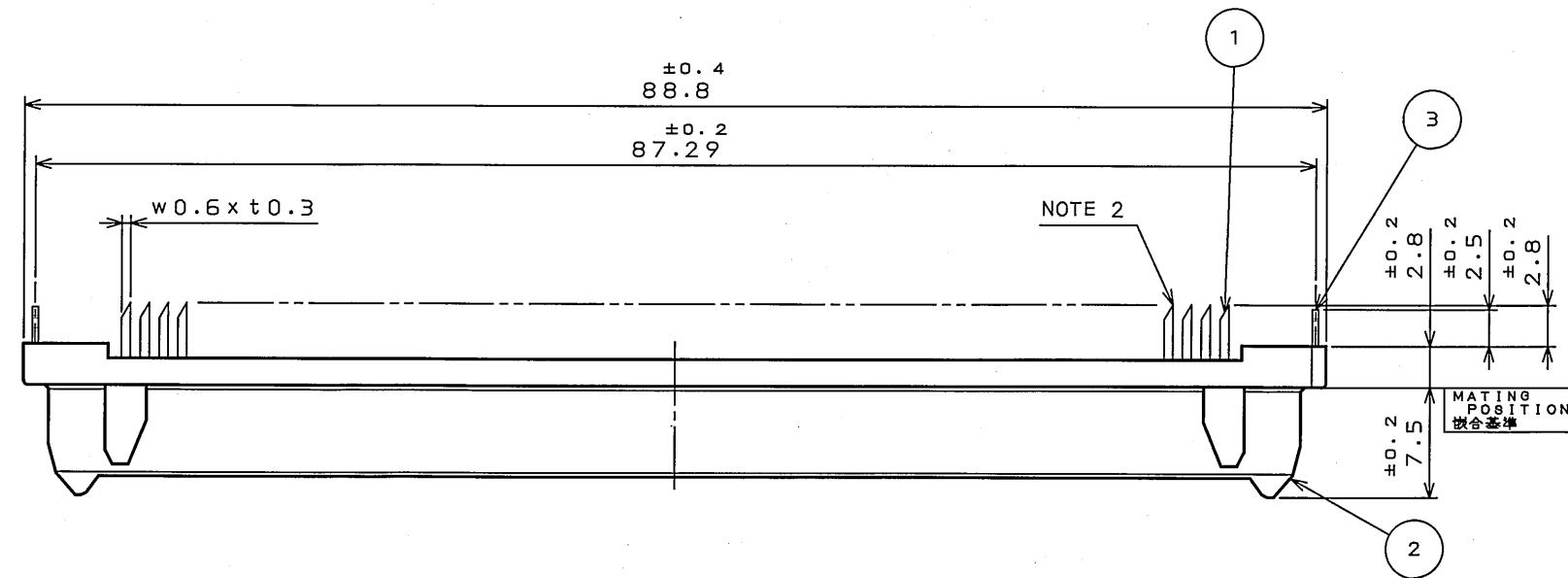
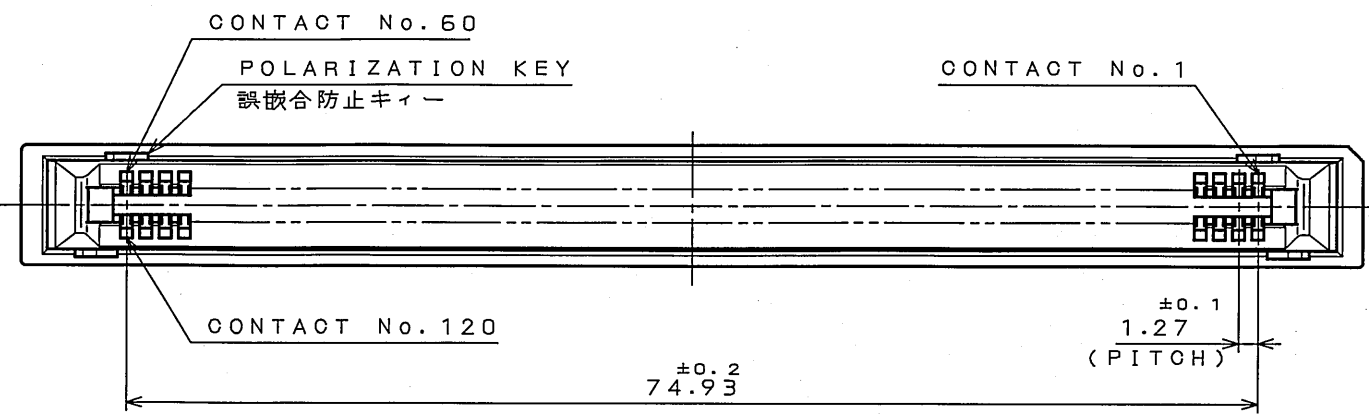

DESIGNATION

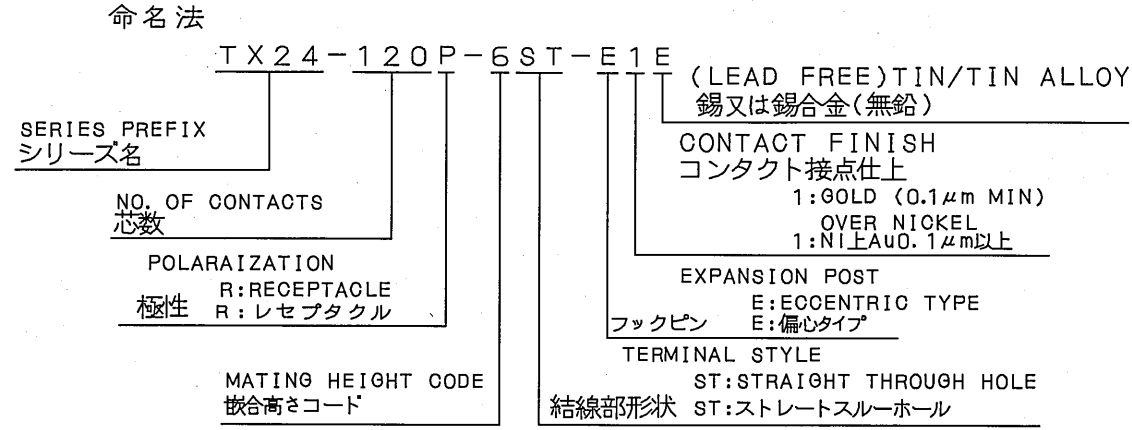
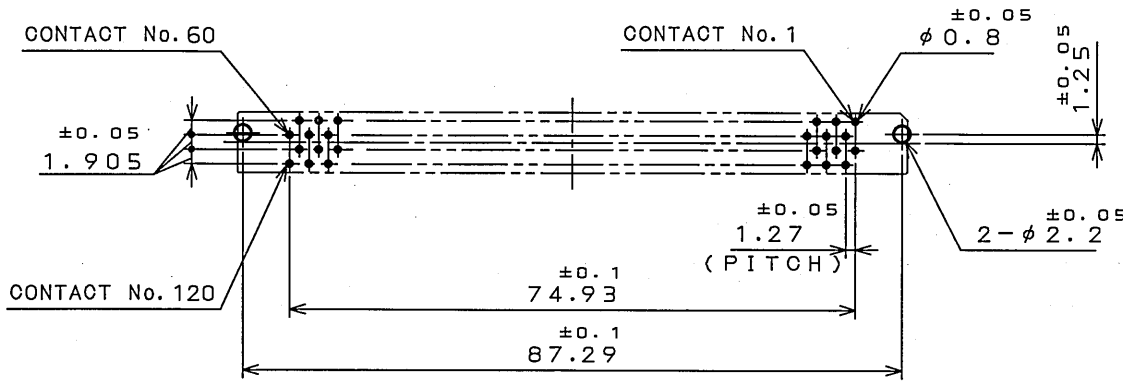
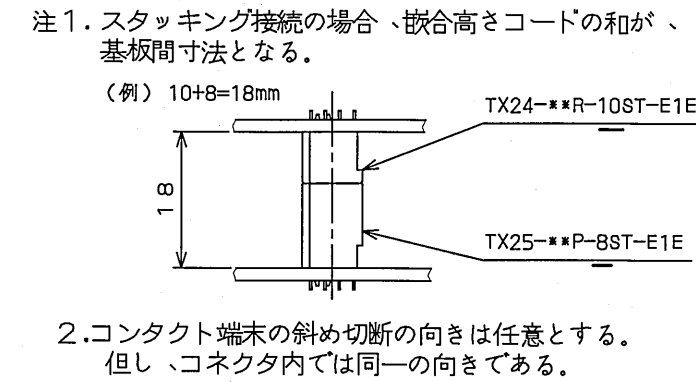

TABLE 1. CONTACT FINISH

AREA	FINISH	1
CONTACT AREA 接触部	GOLD (0.1μm MIN.) OVER NICKEL NI 上 Au0.1μm 以上	
TERMINAL AREA 結線部	(LEAD FREE) TIN/TIN ALLOY 錫または錫合金(無鉛)	

NOTE 1. STACKING HEIGHT = HEIGHT CODE OF TX24 + HEIGHT CODE OF TX25  
(EX.) 10+8=18mm

2. DIRECTION OF CUTTING EDGE OF CONTACTS TERMINAL IS OPTIONAL. BUT, IN THE CONNECTOR, IT MUST FACE THE SAME SIDE.



APPLICABLE P.C.B. DIMENSION (REF.)  
適合基板寸法 (参考)  
(SCALE 1:1)

3	HOOK PIN	2	COPPER ALLOY (LEAD FREE) TIN/TIN ALLOY	
2	INSULATOR	1	GLASS FILLED PBT	UL94 V-1 BLACK
1	CONTACT	120	COPPER ALLOY	SEE TABLE 1
符号 NO.	名称 DESCRIPTION	個数 QTY.	材料 MATERIAL	仕上 FINISH
仕様書 (SPECIFICATION)		第1版 (ORIGINAL DATE)	尺度 (SCALE)	シリーズ (SERIES)
JACS-1425-50*		5.Nov.2004	2:1	TX24
公差 (GENERAL TOLERANCE)		製図 DR.	名称 (TITLE)	
寸法 (DIMENSION)		担当 CHK. M.KIMURA	TX24-120R-6ST-E1E	
角度 (ANGLES)		査閲 APPD.	承認 APPD. S. Kashiragi	
. ±0.8	X° ±	承認 APPD.	質量 (MASS)	
.X ±0.4	X°X' ±		図面番号 (DRAWING NO.)	
.XX ±0.1			SJ102397	
.XXX ±			版数 (REV.)	

DOF-0-213E(03.08)

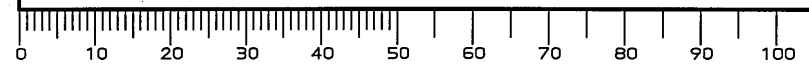

SIZE A2

## X-ON Electronics

Largest Supplier of Electrical and Electronic Components

*Click to view similar products for [Board to Board & Mezzanine Connectors](#) category:*

*Click to view products by [JAE](#) manufacturer:*

Other Similar products are found below :

[589158040000018](#) [MDF7C-18P-2.54DSA\(55\)](#) [FCN-230C068-11](#) [FCN-268F012-G/BD](#) [FCN-268F036-G/BD](#) [FCN-268M012-G/0D](#) [FCN-268M024-G/1D](#) [FCN-723J004/1](#) [MIS-048-01-F-D-DP-K](#) [832-10-034-10-001000](#) [FX4C-80S-1.27DSA](#) [FCN-214Q030-G/0](#) [FCN-234P048-G/0](#) [FCN-235D050-G/C](#) [210-93-314-41-105000](#) [2-22603-0](#) [MDF7-40DP-2.54DSA\(55\)](#) [AXG720047](#) [MIT-114-03-F-D-K](#) [55323-1519](#) [DF33-2P-3.3DSA\(24\)](#) [YFT-20-05-H-03-SB-K](#) [503308-3040](#) [026-6203-PDB](#) [027-6203-PDB](#) [069159702701000](#) [10123981-102LF](#) [101A10019X](#) [55650-0588-C](#) [68682-310LF](#) [68684-306](#) [75140-7012](#) [87471-650](#) [YTW-30-07-H-Q-410-140](#) [FCN-268F024-G0D](#) [10124054-515LF](#) [68685-603](#) [8-1616154-3](#) [MIS-019-01-F-D](#) [FCN-268M024-G/3D](#) [FCN-268M036-G/BD](#) [20021832-06016C1LF](#) [KX15-20KLDL-E1000E](#) [AXE810124](#) [FCN-214J100-G/0](#) [FCN-230C068-E/S](#) [AXE812124](#) [AXE816124](#) [AXE720127](#) [354184](#)