

# **JBC**

[www.jbctools.com](http://www.jbctools.com)

## **INSTRUCTION MANUAL**



### **WS440**

High-Temperature  
Wire Stripper Tweezers

# Index

	Page
Packing List .....	3
Features and Connections .....	4
Changing Cartridges .....	5
Stripping a Wire .....	6
Adjustable Strip Gauge .....	6
Cartridge Range .....	7
Sealing Plug Replacement .....	8
Accessories .....	9-10
Safety .....	11
Specifications .....	13

This manual corresponds to the following reference:

**WS440-A**

## Packing List

The following items are included:



**High-Temperature Wire Stripper Tweezers** ..... 1 unit



**Screw Driver** ..... 1 unit  
Ref. 0023511



**Metal Brush** ..... 1 unit  
Ref. 0022793



**WS440 Sealing Plug** ..... 2 units  
Ref. OB3000 (includes 10x)



**Manual** ..... 1 unit  
Ref. 0023034

# Features and Connections

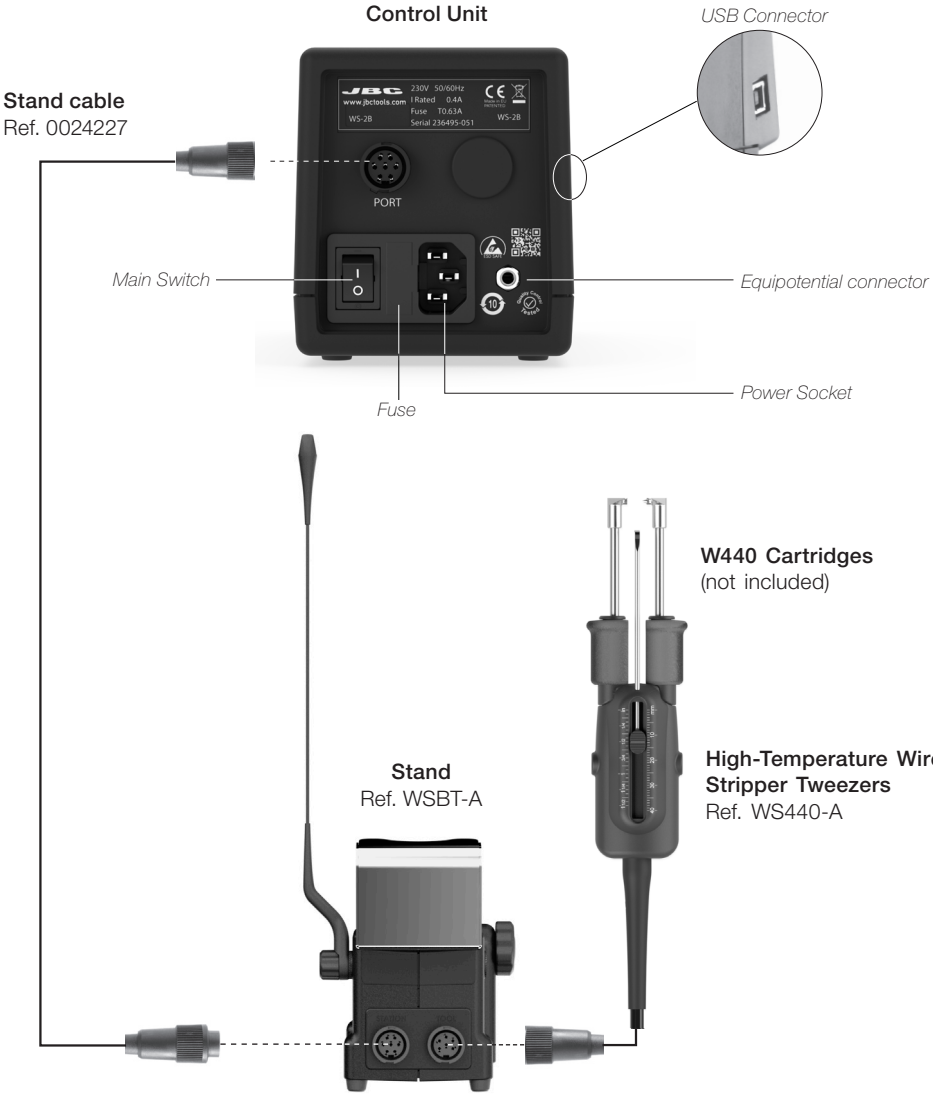

## Changing Cartridges

### 1. Removing

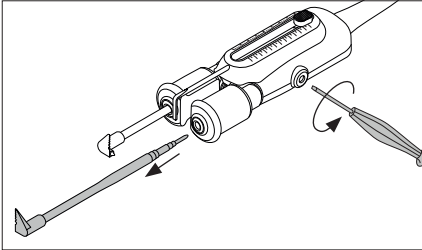

Loosen the screws and remove the cartridges.

### 2. Inserting

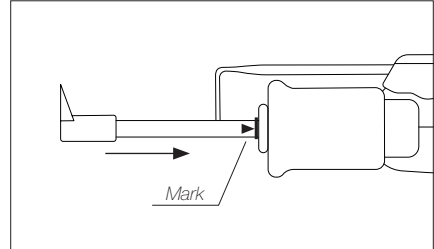

Insert the cartridge until the reference mark. Take the mark as reference and check that both tips match.

**Important:** It is essential to insert the cartridge till the mark for a good connection.

### 3. Positioning

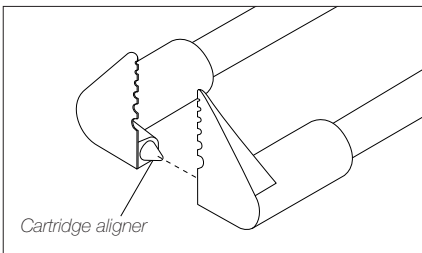

Align the cartridges in working position using a flat pliers (JBC Ref. PLR-195). The conical cartridge aligner helps centering both cartridges and ensure a good functionality.

### 4. Fixing

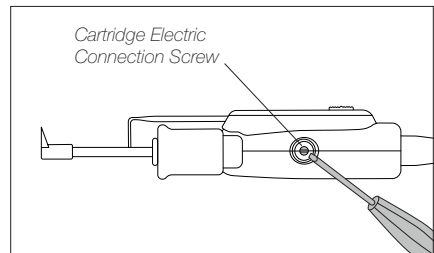

Fix the cartridges in its working position, by tightening the screw.

**Important:** It is essential to tighten the screws for the tool to function.

# Stripping a Wire

## 1. Align Wire

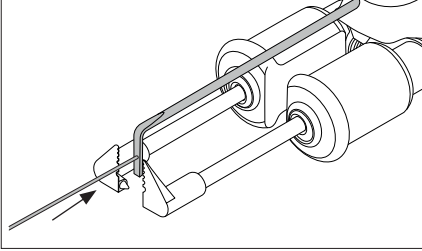

Place the wire touching the strip gauge.

## 2. Close Cartridges

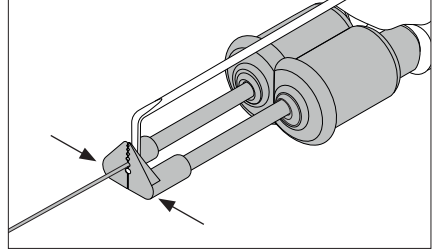

Choose cartridges according to the wire diameter. Pinch the wire with the blades. The pinched area will be melted by heat.

## 3. Remove Wire

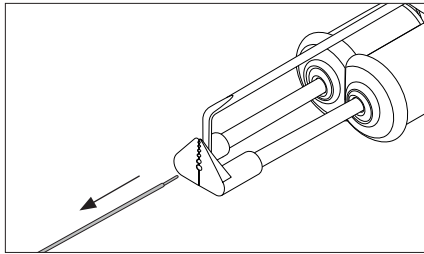

Pull the wire stripper toward to strip off the wire end.

# Adjustable Strip Gauge

Adjust the strip gauge according to your stripping requirements.

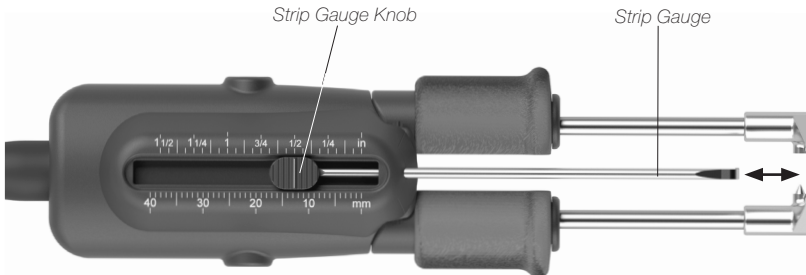

## Cartridge Range

**WS440-A** is compatible with **W440** Blade Cartridge Range. Find the model that best suits your soldering needs on [www.jbctools.com](http://www.jbctools.com).

If an application requires a special tip design, contact JBC by mail [customtips@jbctools.com](mailto:customtips@jbctools.com).

Cartridge Ref.	Tip Hole ø mm / in	AWG Stranded	AWG Solid	
W440021	0,16 / 0,0063	36 (7x44)	34	
	0,25 / 0,0098	32 (19x44)	30	
	0,32 / 0,0126	30 (7x38)	28	
		30 (19x42)		
	0,40 / 0,0157	28 (19x40)	26	
		27 (7x35)		
	0,51 / 0,0201	26 (19x38)	24	
		26 (10x36)		
0,64 / 0,0252	24 (19x36)	22		
	24 (7x32)			

Cartridge Ref.	Tip Hole ø mm / in	AWG Stranded	AWG Solid	
W440023	0,40 / 0,0157	28 (19x40)	26	
		27 (7x35)		
	0,51 / 0,0201	26 (19x38)	24	
		26 (10x36)		
	0,64 / 0,0252	24 (19x36)	22	
		24 (7x32)		
	0,81 / 0,0319	22 (19x34)	20	
	1,02 / 0,0402	20 (42x36)	18	
20 (19x32)				
20 (7x28)				
1,29 / 0,0508	18 (19x30)	16		

Cartridge Ref.	Tip mm / in	
W440025	Flat Blade 12,5 / 0.4921	

# Sealing Plug Replacement

The Sealing Plug is meant to prevent undesirable flux vapors or particles from entering inside the tool.

Its usage is highly recommended for intensive applications when soldering is exposed to FOD environments or for applications where the soldering iron works close to vertical position.

⚠ Before replacing the seal, unplug the power supply and make sure the device is not hot.

## 1. Removing

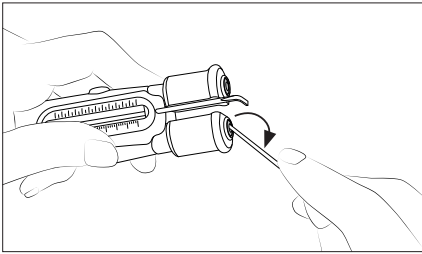

Enter a small shaft or screwdriver in order to gently lift and pull the sealing plug. Do not insert the tool more than 8 mm deep. Never use a cartridge to do this operation.

## 2. Mounting

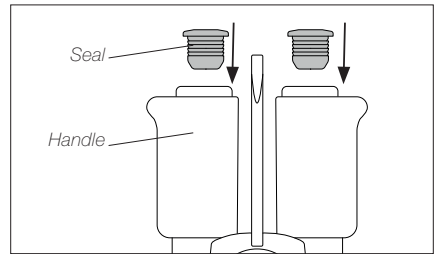

**Note** the sealing plug mounting position: The chamfered side has to be positioned towards the handle.

## 3. Inserting

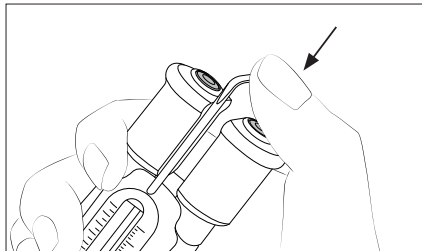

Gently push the sealing plug inside the handle until it is completely into the handle. Handle and seal edges have to be aligned.



## Accessories

### Flat Screw Driver

To open or fix the wire stripper screws use JBC Flat Screw Driver Ref. 0023511.



### Cartridge Extractor Pliers\*

To manipulate the cartridges use JBC Cartridge Extractor Pliers Ref. PLR195. More Information at [www.jbctools.com](http://www.jbctools.com)



### Removing

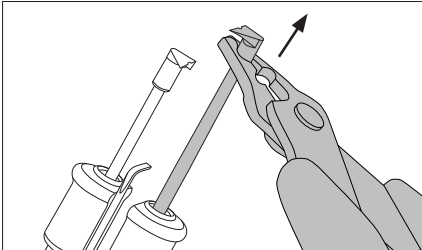

Remove cartridges with JBC pliers.

### Inserting and Positioning

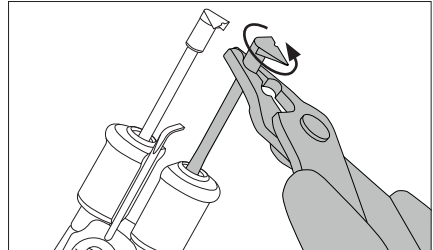

Align cartridges with JBC pliers.

### Metal Brush

For cleaning the tips if unwanted material is stuck there. Metal Brush Ref. 0022793.



\* Not included

## Grips for WS440\*

W3533 Grips  
Ref. 0023533



\* Not included

Easily replace the damaged grips using the fitters like shown in the pictures.

### 1. Inserting Fitters

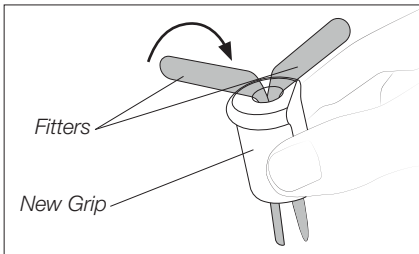

Insert the fitters into the new grip.

### 2. Placing Fitters

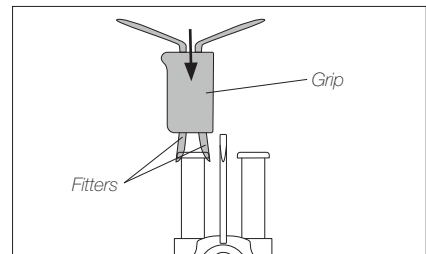

Place the fitters inserted into the grip at the top of the tweezers.

### 3. Pushing Grips

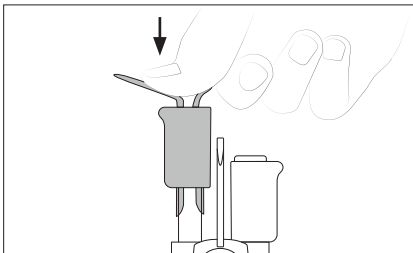

Push the grip with the fitters onto the tweezers.

### 4. Removing Fitters

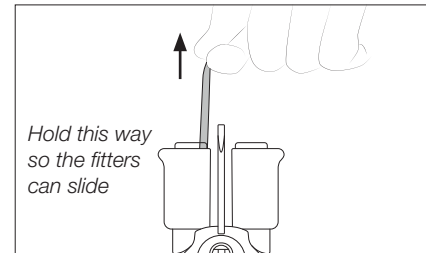

To remove the fitters, hold the grip and pull them out. Use pliers if necessary.

## Safety

### Warning

- Do not touch the blade or the metal parts around.
- Do not allow the blade be close to flammable materials.
- Keep your workplace clean and tidy. Wear appropriate protection glasses and gloves when working to avoid personal harm.
- This appliance can be used by children over the age of eight and also persons with reduced physical, sensory or mental capabilities or lack of experience provided that they have been given adequate supervision or instruction concerning use of the appliance and understand the hazards involved.
- Maintenance must not be carried out by children unless supervised.
- Place the tool on the stand when is not in use.
- Turn off the power when not in use, changing parts or storing.

### Caution

- Do not use the Wire Stripper for other applications than wire stripping.
- Do not modify or customize the Wire Stripper.
- Do not hit the blade against workbench to eliminate stripped insulation debris. This behavior would damage the blade.
- Remove power from the tool by holding the plug, not the wires.
- Be careful with the fumes produced when stripping. We recomend to use our fume extractor.

# Specifications

## WS440

### High-Temperature Wire Stripper Tweezers

Ref.: **WS440-A**

- Max. Power per Cartridge: 40W
- Cable Length: 1.2 m / 47.2 in
- Dimensions / Weight: 97 x 36 x 27 mm / 0.12 kg  
(L x W x H) 3.82 x 1.42 x 1.06 in / 0.26 lb
  
- Package Dimensions / Weight: 277 x 73 x 50 mm / 0.16 kg  
(L x W x H) 10.91 x 2.87 x 1.97 lb / 0.35 lb

Complies with CE standards  
ESD Safe

# JBC

## Warranty

JBC's 2 year warranty covers this equipment against all manufacturing defects, including the replacement of defective parts and labour.

Warranty does not cover product wear or misuse.

In order for the warranty to be valid, equipment must be returned, postage paid, to the dealer where it was purchased.

**Get 1 extra year JBC warranty by registering here:**  
<https://www.jbctools.com/productregistration/>  
**within 30 days of purchase.**



This product should not be thrown in the garbage.

In accordance with the European directive 2012/19/EU, electronic equipment at the end of its life must be collected and returned to an authorized recycling facility.



[www.jbctools.com](http://www.jbctools.com)

## X-ON Electronics

Largest Supplier of Electrical and Electronic Components

*Click to view similar products for [Soldering & Desoldering Stations](#) category:*

*Click to view products by [JBC Tools](#) manufacturer:*

Other Similar products are found below :

[GS1116](#) [WESD51D](#) [BH-010](#) [T0058768747](#) [CA0202](#) [CA0201](#) [WXD2N](#) [Q-7100-9000](#) [ALFA](#) [T0058757898](#) [WXD2010N](#) [T0058768762](#)  
[145-2000-ESDN](#) [T0058758721N](#) [0008473](#) [WTL1000-1](#) [700-3051-ESD](#) [0051514699N](#) [0051512199N](#) [T0058768725N](#) [ZD-415R](#) [ZD-415R-H](#)  
[WELPB102](#) [CVC-7CN0004P](#) [CVC-9CH0025S](#) [CVC-8CH0010S](#) [CV-H5-DSHP](#) [AP-SF](#) [AT-SA](#) [AT-SB](#) [DN-SF](#) [DR-SF](#) [DS-SF](#) [HD-SF](#)  
[0016344](#) [00B.SA.0](#) [0120CDK](#) [0551903](#) [0DIG20A45](#) [0IC1100A](#) [0ICV2000XV](#) [0T56](#) [CL-SFE/1 FILTERS](#) [PX0410/03P/5055](#) [RA150](#)  
[10G.SA.0](#) [36A.SA](#) [3C.SA](#) [3.TA](#) [AT850D/P](#)