



SPECIFICATIONS

Rated Current: 3.0AMP
 Contact Resistance: 20mΩ Max
 Withstand Voltage: 1000V AC/DC
 Insulation Resistance: 1000MΩ Min
 Operation Temperature: -40°C to +105°C

Contact Material: Brass

Contact Plating: Au or Sn Over Ni

Insulator Material: Polyester (UL94V-0)

Standard: PBT

Max. Processing Temp: 180°C for 30-60 seconds
 (200°C for 10 seconds)

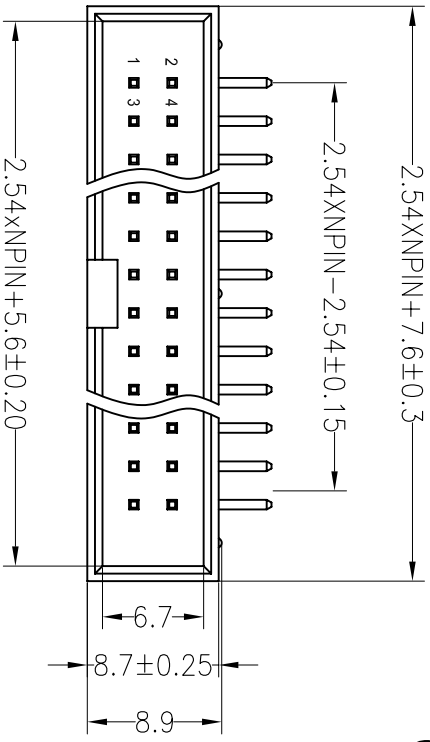

Recommended P.C.B Layout (Top Side)
 (PCB BOARD TOLERANCE ±0.05)

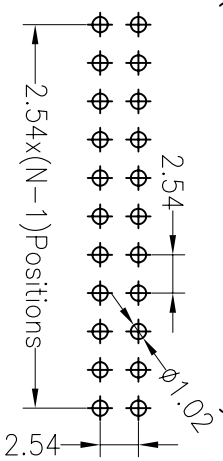

Ordering Information

3210-XX R XX X B K00 X 01

- No. of Pins Per Row: 6--64
- Contact Plating: G0:Gold Flash, G1:3U" Gold, G2:5U" Gold, G3:10U" Gold, G4:15U" Gold, G5:30U" Gold
- Insulator Material Option: A=BK-PBT, B=BK-PA66, C=BK-PA6T, D=BK-PA46, F=BK-LCP
- Packing: 0=PE Bag, A=Troy, T=Tube, P=Tube+Cap
- SN: Tin

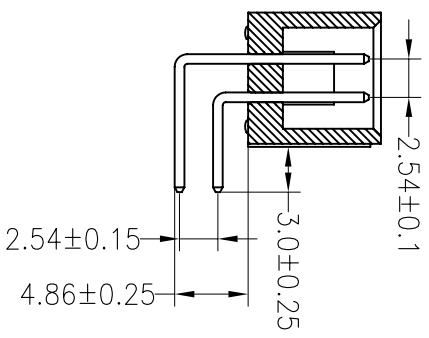
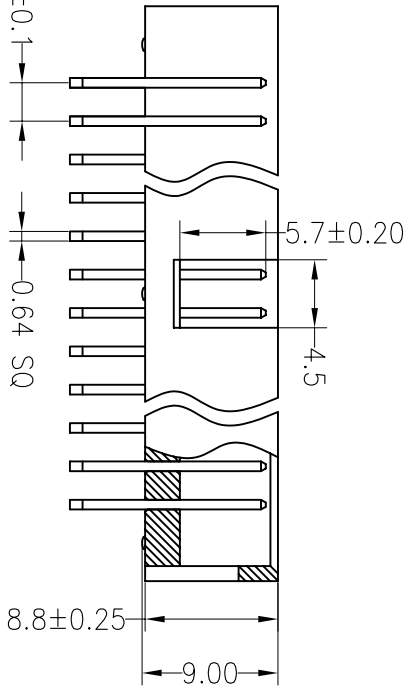

REV	DATE	MODIFICATION DESCRIPTION	CHANGE	OPERATION		DRAW	YYSUsheng	13.08.15	SCALE		FIT	SHEET	PROJ.	PART NO.	TITLE:
				X.X	±0.30				UNIT	mm					
A	2012.09.10	NEW DRAWING		X.XX	±0.20	CHECK			A4	1/1			3210-XXRXXBK00X01	2.54mm Box Header H8.8mm 90°	
B	2013.08.15	变更项目针长,将原来的L=16.5/21.5改成L=16.0/21.0	YYSUSHENG	Angle	±3°	APPROVE									
1				DIM	TOL										

JIN 深圳市锦凌电子有限公司
 SHENZHEN JINLING ELECTRONIC CO.,LTD
 Tel: 86-755-2997-5806/5802 Fax: 86-755-2997-5992

X-ON Electronics

Largest Supplier of Electrical and Electronic Components

Click to view similar products for [Headers & Wire Housings](#) category:

Click to view products by [JILN](#) manufacturer:

Other Similar products are found below :

[95000-104TRLF](#) [10135584-644402LF](#) [DF62W-EP2022PCA](#) [95000-106TRLF](#) [DF62W-2022SCA](#) [DF62W-EP2022PC](#) [2203348](#) [DF62W-2022SC](#) [1084018](#) [1029039](#) [1084017](#) [802-10-012-10-002000](#) [1112640](#) [1112639](#) [891-007-9SS-BST1T](#) [000-34000](#) [0008550134](#) [0009482033](#) [0009507031](#) [57102-F02-18ULF](#) [57102-S06-03LF](#) [57202-S52-04LF](#) [PCN6-15S-2.5E](#) [0039019024](#) [58102-G61-06LF](#) [582553-1](#) [0009485154](#) [0009508121](#) [0022285053](#) [0050291907](#) [018731A](#) [LY20-4P-DT1-P1E-BR](#) [02.125.8002.8](#) [60101931](#) [60598-1 \(Cut Strip\)](#) [M1625-3R/100](#) [61062-3](#) [61082-181009](#) [CSU011177004](#) [636-1427](#) [638009-1](#) [641938-9](#) [641991-4](#) [644168-1](#) [644827-2](#) [647662-1](#) [65039-019ELF](#) [65692-001LF](#) [65781-018](#) [65781-047](#)