



SPECIFICATIONS

Rated Current:3.0AMP
 Contact Resistance:20mΩ Max
 Withstand Voltage:1000V AC/DC
 Insulation Resistance:1000MΩ Min
 Operation Temperature:-40°c to +105°c

Contact Material:Brass
 Contact Plating:Au or Sn Over Ni
 Insulator Material:Polyester(UL94V-0)
 Standard: PA6T
 Max.Processing Temp: 230°C for 30-60 seconds
 (260°C for 10 seconds)

Ordering Information

3210 XX M XX X B K00 X 01

No. of Pins-64P

Contact Plating
 G0:Gold Flash
 G1:1.0U" Gold
 G2:1.5U" Gold
 G3:2U" Gold
 G4:3U" Gold
 G5:5U" Gold
 G6:10U" Gold
 G7:15U" Gold
 S0:Gold Flash/Tin
 SN:Tin

Insulator Material Option
 A=BK-PBT
 C=BK-PA6T
 D=BK-PA46
 E=BK-PA9T
 F=BK-LCP

Packing code stream
 0=PE Bag
 A=Troy
 T=Tube
 P=Tube+Cap
 01~99

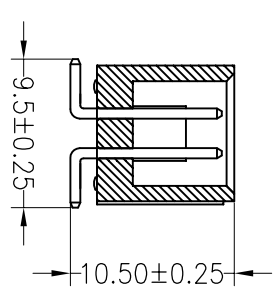
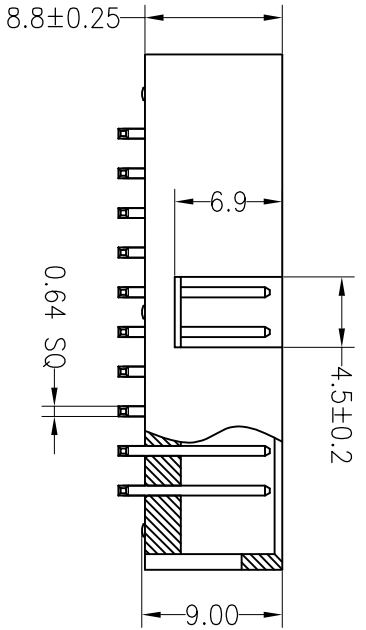
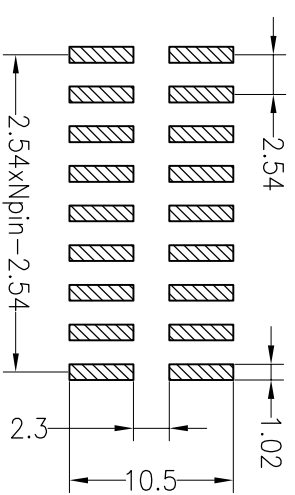
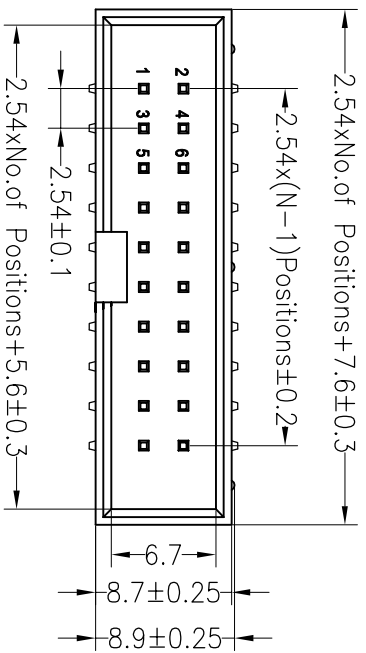

OPERATION		DRAW		SCALE		FIT		TITLE:	
X.X	±0.30	JinChengXin	19.09.21	UNIT	mm	A4	1/1	PART NO.	3210XXMXXXXBK00X01
X.XX	±0.20	CHECK		SIZE		SHEET	1/1	PROJ.	
X:XXX	±0.10	APPROVE		ANGLE	±3°				
REV	DATE	MODIFICATION DESCRIPTION	CHANGE	DIM	TOL				
A0	2019.09.21	NEW DRAWING							
1									

JIN SHENZHEN JINLING ELECTRONIC CO.,LTD
 深圳市锦凌电子有限公司
 Tel: 86-755-2997-5806/5802 Fax: 86-755-2997-5992

2.54mm Box Header H8.8mm SMT

X-ON Electronics

Largest Supplier of Electrical and Electronic Components

Click to view similar products for [Headers & Wire Housings](#) category:

Click to view products by [JILN](#) manufacturer:

Other Similar products are found below :

[95000-104TRLF](#) [10135584-644402LF](#) [DF62W-EP2022PCA](#) [95000-106TRLF](#) [DF62W-2022SCA](#) [DF62W-EP2022PC](#) [2203348](#) [DF62W-2022SC](#) [1084018](#) [1029039](#) [1084017](#) [802-10-012-10-002000](#) [1112640](#) [1112639](#) [891-007-9SS-BST1T](#) [000-34000](#) [0008550134](#) [0009482033](#) [0009507031](#) [57102-F02-18ULF](#) [57102-S06-03LF](#) [57202-S52-04LF](#) [PCN6-15S-2.5E](#) [0039019024](#) [58102-G61-06LF](#) [582553-1](#) [0009485154](#) [0009508121](#) [0022285053](#) [0050291907](#) [018731A](#) [LY20-4P-DT1-P1E-BR](#) [02.125.8002.8](#) [60101931](#) [60598-1 \(Cut Strip\)](#) [M1625-3R/100](#) [61062-3](#) [61082-181009](#) [CSU011177004](#) [636-1427](#) [638009-1](#) [641938-9](#) [641991-4](#) [644168-1](#) [644827-2](#) [647662-1](#) [65039-019ELF](#) [65692-001LF](#) [65781-018](#) [65781-047](#)