

SPECIFICATIONS

Rated Current: 3.0AMP
Contact Resistance: 30mΩ Max
Withstand Voltage: 1000V AC/DC
Insulation Resistance: 1000MΩ Min
Operation Temperature: -40°C to +105°C

Contact Material: Brass
Contact Plating: Au or Sn Over Ni
Insulator Material: Polyester (UL94V-0)
Standard: PBT
Max. Processing Temp: 180°C for 30-60 seconds
(200°C for 10 seconds)

Ordering Information

3511 3 XX A F R XX BNA1

No. of Pins 30~120PIN
Contact Type F=Female

Contact Plating
G0: Gold Flash
S0: Gold Flash/Tin
S1: 2U" Gold/Tin
S2: 5U" Gold/Tin
S3: 10U" Gold/Tin
S4: 15U" Gold/Tin
S5: 30U" Gold/Tin
SN: Tin

Recommended P.C.B Layout(Top Side)

Dimension antitheses list	
ITEM	A
Standard	2.90
Alternate	

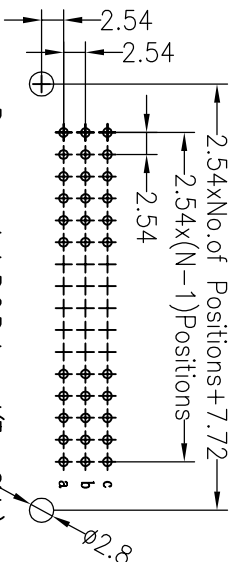
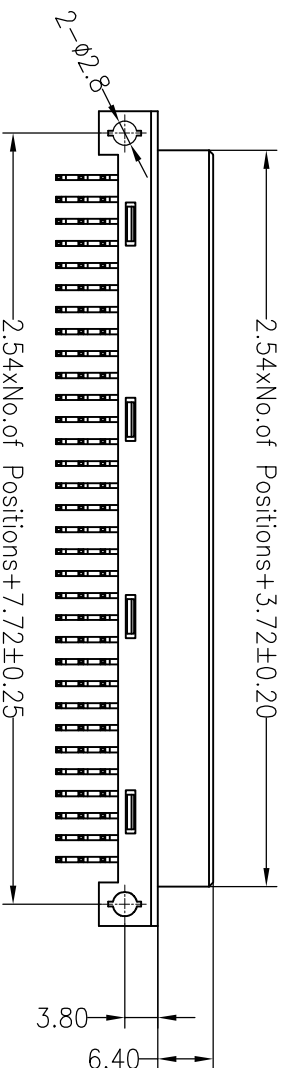
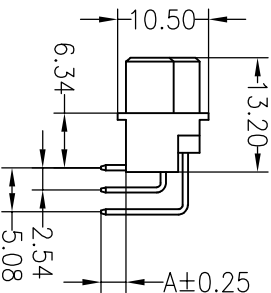
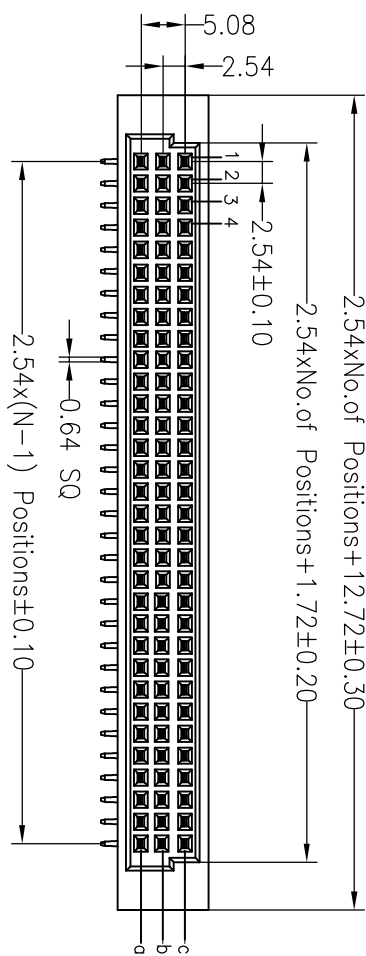
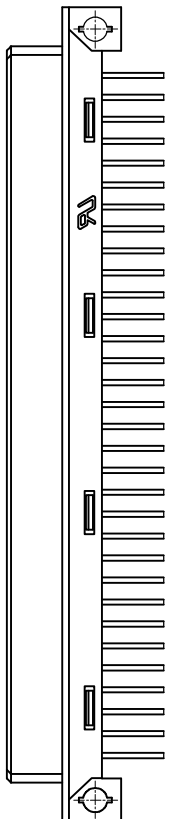

REV	DATE	MODIFICATION DESCRIPTION	CHANGE	DIM	TOL	APPROVE	PROL.	TITLE:
A0	2015.04.23	NEW DRAWING		X.XXX	±0.10			PART NO. 35113XXAFRXXBNA1
1				Angle	±3°			DIN 41612 90° 3xN PIN Female

OPERATION	DRAW	SCALE	FIT
X.X	YYuSheng	15.04.23	mm
X.XX	CHECK		A4
X.XXX	APPROVE		1/1

SHENZHEN JINLING ELECTRONIC CO.,LTD	深圳市锦凌电子有限公司
Tel: 86-755-2997-5806/5802	
Fax: 86-755-2997-5892	

X-ON Electronics

Largest Supplier of Electrical and Electronic Components

Click to view similar products for [Board to Board & Mezzanine Connectors](#) category:

Click to view products by [JILN](#) manufacturer:

Other Similar products are found below :

[589158040000018](#) [MDF7C-18P-2.54DSA\(55\)](#) [FCN-268F036-G/BD](#) [FCN-268M012-G/0D](#) [FCN-268M024-G/1D](#) [FCN-723J004/1](#) [MIS-048-01-F-D-DP-K](#) [832-10-034-10-001000](#) [FX4C-80S-1.27DSA](#) [93696-330](#) [224393](#) [FCN-235D050-G/C](#) [210-93-314-41-105000](#) [2-22603-0](#) [MDF7-40DP-2.54DSA\(55\)](#) [5031084030](#) [MIT-114-03-F-D-K](#) [55323-1519](#) [45970-4130](#) [YFT-20-05-H-03-SB-K](#) [503308-3040](#) [026-6203-PDB](#) [027-6203-PDB](#) [069159702701000](#) [101A10019X](#) [105061100000861+](#) [55650-0588-C](#) [75140-7012](#) [87471-650](#) [YTW-30-07-H-Q-410-140](#) [YTT-112-01-H-Q](#) [063209](#) [0717420006](#) [FCN-268F024-G0D](#) [10124054-515LF](#) [68685-603](#) [8-1616154-3](#) [MIS-019-01-F-D](#) [YTQ-11201HQ](#) [IL-WX-10PB-HF-B-E1000E](#) [YFT-50-05-H-10-SB-K](#) [FCN-268M024-G/3D](#) [MDF7-16DP-2.54DSA\(55\)](#) [AXE810124](#) [FCN-214J100-G/0](#) [FCN-230C068-E/S](#) [AXE812124](#) [74220-001](#) [354184](#) [P50-028-DDS-TG](#)