

SPECIFICATIONS

Rated Current: 3.0AMP
 Contact Resistance: 20mΩ Max
 Withstand Voltage: 1000V AC/DC
 Insulation Resistance: 1000MΩ Min
 Operation Temperature: -40°C to +105°C

Contact Material: Brass
 Contact Plating: Au or Sn Over Ni
 Insulator Material: Polyester (UL94V-0)
 Standard: PBT
 Max. Processing Temp: 180°C for 30-60 seconds
 (200°C for 10 seconds)

Note:
 6P Without Slot "W" and "N"
 8P~12P With Slot "W", Without Slot "N"
 14P~64P With Slot "W" and "N"

Ordering Information

5314 XX Y B XX X X 01

No. of Pins: 06~64P
 Contact Plating: SO-Gold Flash / Ni
 NI: NI
 Insulation Color: B=Black, G=Grey
 Option Type: W=With Bump, N=Without Bump

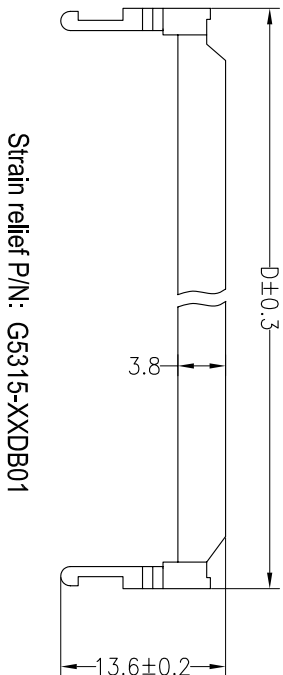

Strain relief P/N: G5315-XXDB01

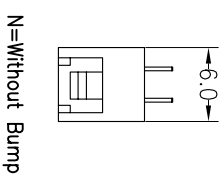
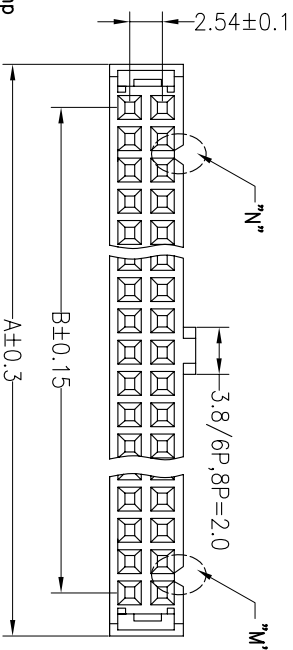
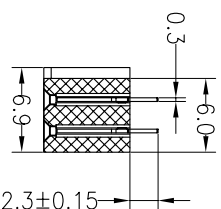
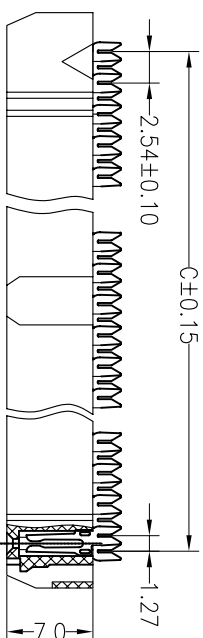
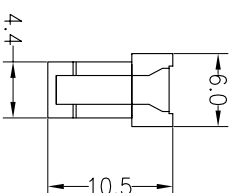
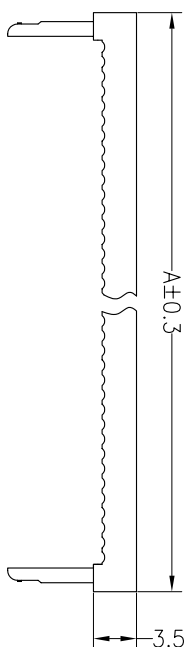
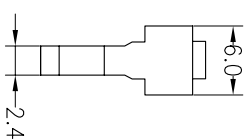

| Pin | Dimension mm | | | |
|-----|--------------|-------|-------|-------|
| | A | B | C | D |
| 06 | 12.42 | 5.08 | 6.35 | 12.12 |
| 08 | 14.96 | 7.62 | 8.89 | 14.66 |
| 10 | 17.50 | 10.16 | 11.43 | 17.20 |
| 12 | 20.04 | 12.70 | 13.97 | 19.74 |
| 14 | 22.58 | 15.24 | 16.51 | 22.28 |
| 16 | 25.12 | 17.78 | 19.05 | 24.82 |
| 18 | 27.66 | 20.32 | 21.59 | 27.36 |
| 20 | 30.20 | 22.86 | 24.13 | 29.90 |
| 24 | 35.28 | 27.94 | 29.21 | 34.98 |
| 26 | 37.82 | 30.48 | 31.75 | 37.52 |
| 28 | 40.36 | 33.02 | 34.29 | 40.06 |
| 30 | 42.90 | 35.56 | 36.83 | 42.60 |
| 34 | 47.98 | 40.64 | 41.91 | 47.68 |
| 40 | 55.60 | 48.26 | 49.53 | 55.30 |
| 44 | 60.68 | 53.34 | 54.61 | 60.38 |
| 50 | 68.30 | 60.96 | 62.23 | 68.00 |
| 60 | 81.00 | 73.66 | 74.93 | 80.70 |
| 64 | 86.08 | 78.74 | 80.01 | 85.78 |

| OPERATION | DRAW | | YTYuSheng | 16.01.19 |
|-----------|-------|-----|-----------|----------|
| | UNIT | FIT | | |
| X.X | ±0.30 | mm | | |
| X.XX | ±0.20 | | | |
| X.XXX | ±0.10 | | | |
| Angle | ±3° | | | |
| DIM | TOL | | | |

| SCALE | FIT |
|-------|-----|
| A4 | 1/1 |

JIN 深圳市锦凌电子有限公司
 SHENZHEN JINLING ELECTRONIC CO.,LTD
 Tel: 86-755-2997-5806/5802 Fax: 86-755-2997-5992

| REV | DATE | MODIFICATION DESCRIPTION | CHANGE | APPROVE | TITLE: |
|-----|------------|--------------------------|--------|---------|-----------------------|
| A0 | 2016.01.19 | NEW DRAWING | | | 5314XXYBXXXX01 |
| 1 | | | | | 2.54 IDC Y- TYPE NPin |

X-ON Electronics

Largest Supplier of Electrical and Electronic Components

Click to view similar products for [jiln](#) manufacturer:

Other Similar products are found below :

[JL15EDGVC-38106G01](#) [331010SG0ABLA02](#) [JL950-95004B01](#) [JL25C-76204B01](#) [JL15EDGVC-35005G01](#) [JL25C-76206B01](#)
[321006RG0ABK00A01](#) [JL2EDGR-50806G01](#) [331026SG0ABLA02](#) [531440YBS0BW01](#) [321050MG0CBK00A01](#) [531412YBS0BW01](#)
[321034RG0ABK00A01](#) [JL15EDGVC-35009G01](#) [JL15EDGRC-38110G01](#) [331030SG0ABLA02](#) [321010RG0ABK00A02](#) [JL301-50009U02](#)
[JL250-35006E01](#) [531416YBS0BW01](#) [JL2EDGR-50808G01](#) [JL15EDGK-35003G01](#) [JL15EDGVC-25004G01](#) [JL2EDGRC-50808G01](#)
[JL2EDGRC-50809G01](#) [JL15EDGVC-38108G01](#) [JL45C-09505B01](#) [JL15EDGVC-38110G01](#) [JL15EDGK-35012G01](#) [JL127-50003G01](#)
[JL250-12106B01](#) [JL2EDGRC-50812G01](#) [JL103-50003G01](#) [JL15EDGVC-35010G01](#) [JL250-35005E01](#) [JL500H-50003G01](#) [JL500H-](#)
[50002G01](#) [JL15EDGVC-38107G01](#) [JL850-85004BA1](#) [JL2EDGV-50809G01](#) [JL500HH-50803G01](#) [321040RG0ABK00A01](#) [JL2EDGR-](#)
[50812G01](#) [JL15EDGKD-25002G01](#) [331008SG0ABLA02](#) [JL2EDGV-50810G01](#) [JL500HH-50003G01](#) [531416YBS0BW02](#)
[331040SG0ABLA02](#) [JL2EDGR-50807G01](#)