

SPECIFICATIONS

Rated Current: 3.0AMP
 Contact Resistance: 20mΩ Max
 Withstand Voltage: 1000V AC/DC
 Insulation Resistance: 1000MΩ Min
 Operation Temperature: -40°C to +105°C

Contact Material: Brass
 Contact Plating: Au or Sn Over Ni
 Insulator Material: Polyester (UL94V-0)
 Standard: PBT
 Max. Processing Temp: 180°C for 30-60 seconds
 (200°C for 10 seconds)

Note:

6P Without Slot "N" and "N"
 8P~12P With Slot "M", Without Slot "N"
 14P~64P With Slot "M" and "N"

Ordering Information

5314 XX Y B XX X X 01

No. of Pins: 06~64P
 Contact Plating: S0:Gold Flash/Ni, NI:NI
 Insulation Color: B=Black, G=Grey
 Option Type: W=With Bump, N=Without Bump

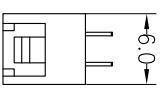
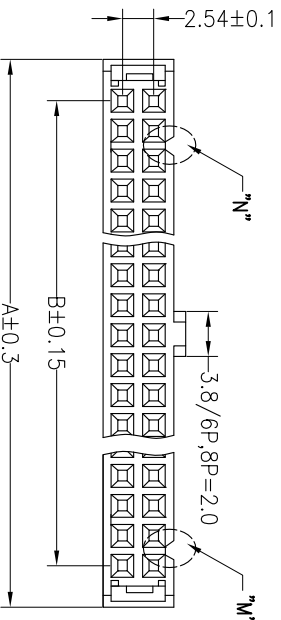
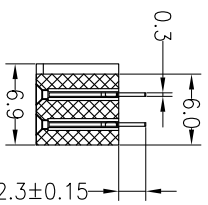
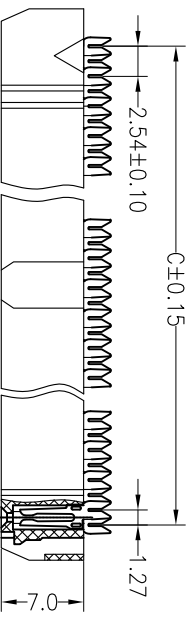
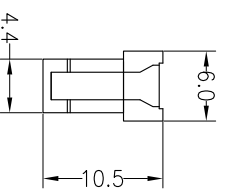
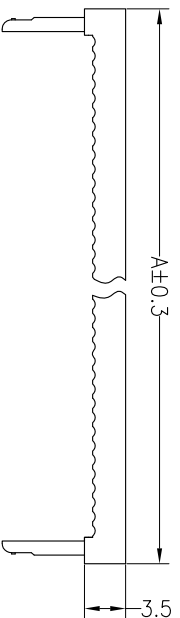

N=Without Bump

Pin	Dimension mm			
	A	B	C	D
06	12.42	5.08	6.35	12.12
08	14.96	7.62	8.89	14.66
10	17.50	10.16	11.43	17.20
12	20.04	12.70	13.97	19.74
14	22.58	15.24	16.51	22.28
16	25.12	17.78	19.05	24.82
18	27.66	20.32	21.59	27.36
20	30.20	22.86	24.13	29.90
24	35.28	27.94	29.21	34.98
26	37.82	30.48	31.75	37.52
28	40.36	33.02	34.29	40.06
30	42.90	35.56	36.83	42.60
34	47.98	40.64	41.91	47.68
40	55.60	48.26	49.53	55.30
44	60.68	53.34	54.61	60.38
50	68.30	60.96	62.23	68.00
60	81.00	73.66	74.93	80.70
64	86.08	78.74	80.01	85.78

OPERATION		DRAW		SCALE		FIT		PART NO.	TITLE:
X.X	±0.30	Y.YuSheng	16.01.19	UNIT	mm	A4	1/1		
X.XX	±0.20	CHECK		SIZE				5314XXYBXXXX01	2.54 IDC Y- TYPE NPin
X:XXX	±0.10			SHEET					
Angle	±3°	APPROVE		PROJ.					
DIM	TOL								

JIN 深圳市锦凌电子有限公司
 SHENZHEN JINLING ELECTRONIC CO.,LTD
 Tel: 86-755-2997-5806/5802 Fax: 86-755-2997-5992

REV	DATE	MODIFICATION DESCRIPTION	CHANGE
A0	2016.01.19	NEW DRAWING	

X-ON Electronics

Largest Supplier of Electrical and Electronic Components

Click to view similar products for [Headers & Wire Housings](#) category:

Click to view products by [JILN](#) manufacturer:

Other Similar products are found below :

[95000-104TRLF](#) [10135584-644402LF](#) [DF62W-EP2022PCA](#) [95000-106TRLF](#) [DF62W-2022SCA](#) [DF62W-EP2022PC](#) [2203348](#) [DF62W-2022SC](#) [1084018](#) [1029039](#) [1084017](#) [802-10-012-10-002000](#) [1112640](#) [1112639](#) [891-007-9SS-BST1T](#) [000-34000](#) [0008550134](#) [0009482033](#) [0009507031](#) [57102-F02-18ULF](#) [57102-S06-03LF](#) [57202-S52-04LF](#) [PCN6-15S-2.5E](#) [0039019024](#) [58102-G61-06LF](#) [582553-1](#) [0009485154](#) [0009508121](#) [0022285053](#) [0050291907](#) [018731A](#) [LY20-4P-DT1-P1E-BR](#) [02.125.8002.8](#) [60101931](#) [60598-1 \(Cut Strip\)](#) [M1625-3R/100](#) [61062-3](#) [61082-181009](#) [CSU011177004](#) [636-1427](#) [638009-1](#) [641938-9](#) [641991-4](#) [644168-1](#) [644827-2](#) [647662-1](#) [65039-019ELF](#) [65692-001LF](#) [65781-018](#) [65781-047](#)