

**HSF** ROHS **us** **CE**

**SPECIFICATIONS**

Rated(额定参数): 300V,8A  
 Dielectric strength(抗电强度): AC1500V/1 Minute  
 Insulation Resistance(绝缘电阻):1000MΩ Min  
 Contact Resistance(接触电阻):20mΩ Max  
 Wire Range(线径):26~16AWG  
 Strip length(剥线长度):10mm  
 Temp. range(操作温度): -40℃~+105℃  
 MAX Soldering(瞬时温度):+250℃,5s

Housing Material(塑件): PA66 (UL94 V-0)  
 Contact(端子): Phosphor Bronze, Tin plating(磷铜镀锡)  
 Reed(弹片): Stainless steel (不锈钢)

	PITCH RANGE		NOMINAL DIMENSION RANGE					
	IN MM		IN MM		IN MM		IN MM	
TO	OVER	OVER	TO	OVER	TO	OVER	TO	OVER
6	10	10	30	60	60	100	100	OVER
	10	24	30	TO	TO	TO	150	150
			60	100	150			
±0.10	±0.15	±0.25	±0.30	±0.30	±0.50	±0.70	±1.00	

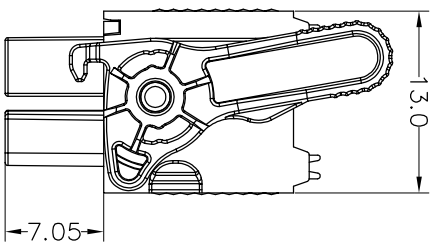
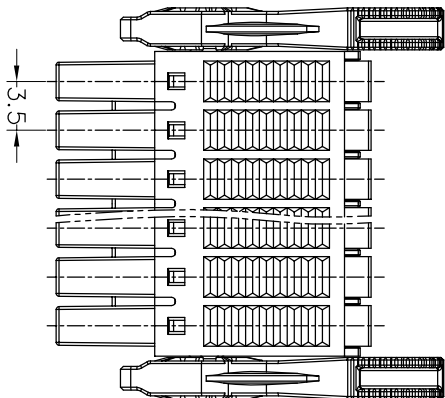
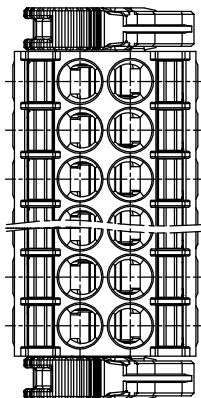
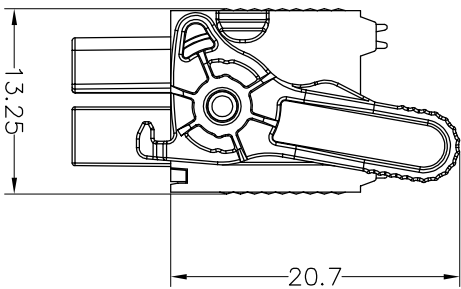

**Ordering Information**

**JL15EDGKNHG - 350 XX X X 1**

Pitch  
350=3.5PH  
No.of pins  
4P~48P  
Housing Color  
B=Black  
G=Green  
U=Blue  
R=Red  
W=White  
Y=Yellow  
O=Orange  
E=Grey  
Packing  
0=Pe bog  
A=Tray

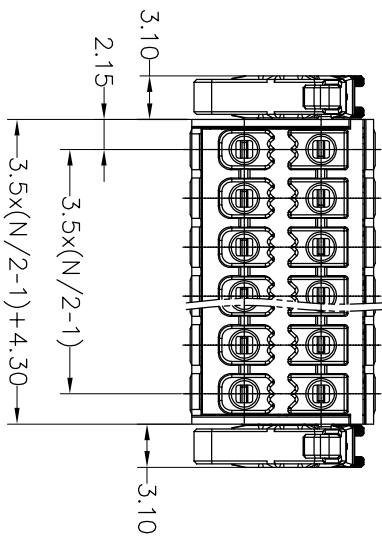

OPERATION		DRAW		SCALE		FIT		PART NO.	
XX	±0.30	yyusheng	19.12.15	UNIT	mm	A4		JL15EDGKNHG-350XXXXX1	
X:XX	±0.20	CHECK		SIZE					
X:XXX	±0.10			SHEET	1/1				
Angle	±3°	APPROVE		PROJ.					
DIM	TOL								
1	2	3	4	5	6	7	8	9	
REV	DATE	MODIFICATION DESCRIPTION	CHANGE			TITLE:		3.5mm Pitch Female Pluggable Terminal Blocks	
A0	2019.12.15	NEW DRAWING							

**JILN** 深圳市锦凌电子有限公司  
 SHENZHEN JINLING ELECTRONIC CO.,LTD  
 Tel: 86-755-2997-5806/5802 Fax: 86-755-2997-5992

## X-ON Electronics

Largest Supplier of Electrical and Electronic Components

*Click to view similar products for [Pluggable Terminal Blocks](#) category:*

*Click to view products by [JILN](#) manufacturer:*

Other Similar products are found below :

[57.510.0053](#) [MC 1.5/ 6-ST-3.5 GY AU](#) [ET02015000J0G](#) [734-104](#) [734-302](#) [860505](#) [860516](#) [860810](#) [GBPACX-12](#) [93.731.4953.0](#) [PV05-5,08-K](#) [PVP03-3,50](#) [PVP04-3,50](#) [PVS02-5,00](#) [1-1986160-3](#) [1377680000](#) [1531000000](#) [1546228-5](#) [ELFP03110](#) [ELFT07250](#) [ELVD12100](#) [ELVF09400](#) [ELVP03100](#) [ELXH071G0E](#) [1700410](#) [1702246](#) [1705229](#) [1714537](#) [1717806](#) [1719600](#) [1728941](#) [1734692](#) [1734795](#) [1740291](#) [1740628](#) [1746952](#) [1750207](#) [1752865](#) [1754115](#) [1754144](#) [1756913](#) [1760051](#) [1760336](#) [1765111](#) [1776388](#) [1777701](#) [1783410](#) [1800227](#) [1801080](#) [1809474](#)