

SPECIFICATIONS

Rated (额定参数) : 300V, 8A
 Dielectric strength (抗电强度) : AC2000V/1 Minute
 Insulation Resistance (绝缘电阻) : 1000MΩ Min
 Contact Resistance (接触电阻) : 20mΩ Max
 Wire Range (线径) : 28~12AWG
 Strip length (剥线长度) : 5-8mm
 Temp. range (操作温度) : -40°C~+105°C
 MAX Soldering (瞬时温度) : +250°C, 5s

Housing Material (塑件) : PA66 (UL94 V-0)
 Contact(端子): Brass, Tin plating(黄铜镀锡)
 Clamp(方块): Brass(黄铜), Ni plating(镀镍)
 Screw (螺丝): M2.0, Steel, Tin plating(钢, 镀镍)

	PITCH RANGE		NOMINAL DIMENSION RANGE					
	IN	MM	IN	MM	OVER	OVER	OVER	OVER
T0	6	10	TO	30	TO	60	TO	100
6	10	24	TO	30	TO	60	TO	150
±0.10	±0.15	±0.25	±0.30	±0.30	±0.50	±0.70	±1.00	

Ordering Information

JL15EDGKR-381 XX G 01

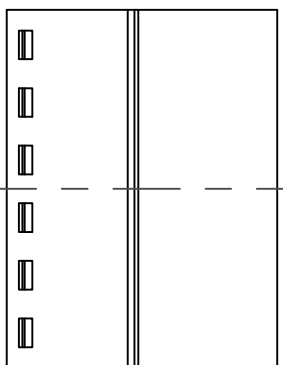
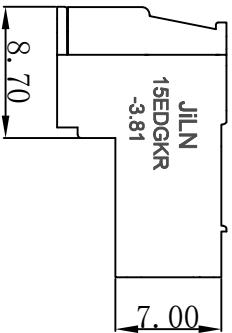
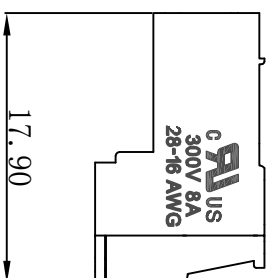
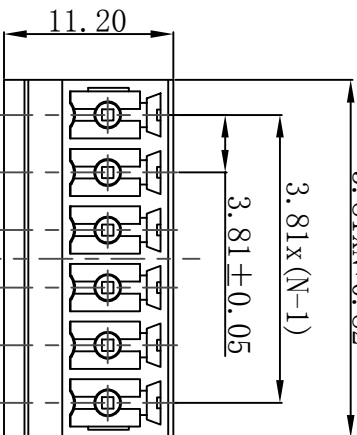
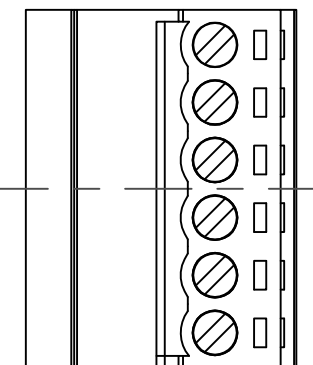
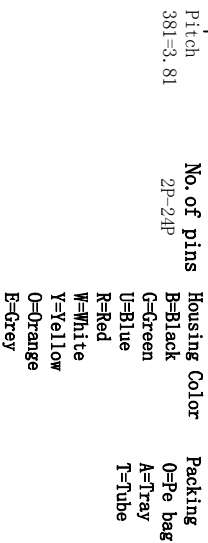

DRAW	SHUANG PING ZHENG		SCALE	FIT	PART NO.	TITLE:
	CHECK	LICHAO LIU	UNIT	mm		
APPROVE	YONGLIANG GAO		SIZE	A4	JL15EDGKR-381XXG01	JL15EDGKR-3.81-XXP插拔式母座/绿色
			SHEET	1/1		
			PROJ.			

JILIN 东莞市锦凌电子有限公司
 DONGGUAN JINLING ELECTRONIC CO., LTD

JL15EDGKR-381XXG01

JL15EDGKR-3.81-XXP插拔式母座/绿色

X-ON Electronics

Largest Supplier of Electrical and Electronic Components

Click to view similar products for [Pluggable Terminal Blocks](#) category:

Click to view products by [JILN](#) manufacturer:

Other Similar products are found below :

[57.510.0053](#) [MC 1.5/ 6-ST-3.5 GY AU](#) [ET02015000J0G](#) [734-104](#) [734-302](#) [860505](#) [860516](#) [860810](#) [GBPACX-12](#) [93.731.4953.0](#) [PV05-5,08-K](#) [PVP03-3,50](#) [PVP04-3,50](#) [PVS02-5,00](#) [1-1986160-3](#) [1377680000](#) [1531000000](#) [1546228-5](#) [ELFP03110](#) [ELFT07250](#) [ELVD12100](#) [ELVF09400](#) [ELVP03100](#) [ELXH071G0E](#) [1700410](#) [1702246](#) [1705229](#) [1714537](#) [1717806](#) [1719600](#) [1728941](#) [1734692](#) [1734795](#) [1740291](#) [1740628](#) [1746952](#) [1750207](#) [1752865](#) [1754115](#) [1754144](#) [1756913](#) [1760051](#) [1760336](#) [1765111](#) [1776388](#) [1777701](#) [1783410](#) [1800227](#) [1801080](#) [1809474](#)