

# HSF ROHS cPAI<sup>®</sup> us CE

## SPECIFICATIONS

Rated(额定参数): 150V,4A  
 Dielectric strength(抗电强度): AC1250V/1 Minute  
 Insulation Resistance(绝缘电阻):1000MΩ Min  
 Contact Resistance(接触电阻):20mΩ Max  
 Temp. range(操作温度): -40℃~+105℃  
 MAX Soldering(瞬时温度):+250℃,5s

Housing Material(塑件): PA66 (UL94 V-0)  
 Contact(端子): Brass, Tin plating(黄铜镀锡)

| PITCH RANGE |       | NOMINAL DIMENSION RANGE |       |
|-------------|-------|-------------------------|-------|
| IN MM       |       | IN MM                   |       |
| OVER        | OVER  | OVER                    | OVER  |
| TO          | TO    | TO                      | TO    |
| 6           | 10    | 30                      | 60    |
| 10          | 24    | TO                      | TO    |
|             |       | 60                      | 100   |
|             |       | TO                      | TO    |
|             |       | 100                     | 150   |
|             |       | TO                      | TO    |
|             |       | 150                     | 150   |
| ±0.10       | ±0.15 | ±0.25                   | ±0.30 |
|             |       | ±0.30                   | ±0.50 |
|             |       | ±0.50                   | ±0.70 |
|             |       | ±0.70                   | ±1.00 |

## Ordering Information

JL15EDGRC - XXX XX X X 1

Pitch  
 250=2.50PH  
 254=2.54PH

No.of pins  
 2P~24P

Housing Color  
 B=Black  
 G=Green  
 U=Blue  
 R=Red  
 W=White  
 Y=Yellow  
 O=Orange  
 E=Grey

Packing  
 O=Pe bag  
 T=Tube  
 A=Troy

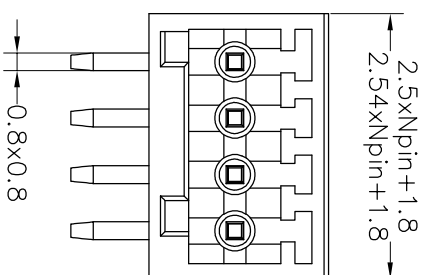
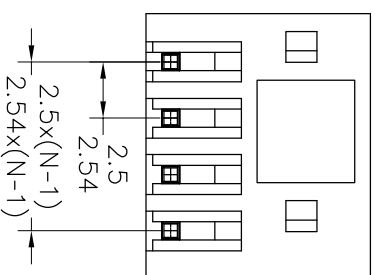
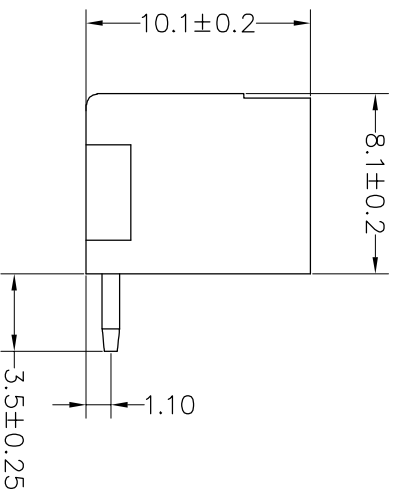

| REV | DATE       | MODIFICATION DESCRIPTION | CHANGE | DIM   | TOL | APPROVE | OPERATION | DRAW  | yiyusheng | 17.01.05 | SCALE | FIT | SIZE | SHEET | PROU.               | PART NO.   | TITLE: |
|-----|------------|--------------------------|--------|-------|-----|---------|-----------|-------|-----------|----------|-------|-----|------|-------|---------------------|--|--------|
| A0  | 2017.01.05 | NEW DRAWING              |        | Angle | ±3° |         | ±0.20     | CHECK |           |          | mm    | A4  | 1/1  |       | JL15EDGRC-XXXXXXXX1 | 2.50/2.54mm Pitch Male Pluggable Terminal Blocks |        |
| 1   |            |                          |        |       |     |         | ±0.30     |       |           |          |       |     |      |       |                     |  |        |
|     |            |                          |        |       |     |         | X:XX      |       |           |          |       |     |      |       |                     |  |        |
|     |            |                          |        |       |     |         | X:XXX     |       |           |          |       |     |      |       |                     |  |        |

**JIN** 深圳市锦凌电子有限公司  
 SHENZHEN JINLING ELECTRONIC CO.,LTD  
 Tel: 86-755-2997-5806/5802 Fax: 86-755-2997-5992

## X-ON Electronics

Largest Supplier of Electrical and Electronic Components

*Click to view similar products for [Pluggable Terminal Blocks](#) category:*

*Click to view products by [JILN](#) manufacturer:*

Other Similar products are found below :

[57.404.7553](#) [57.504.0053.7](#) [57.510.0053](#) [57.910.6153](#) [01.112.1453](#) [CTB932VE/6](#) [MC 1.5/ 6-ST-3.5 GY AU](#) [ET02015000J0G](#) [734-104](#) [734-302](#) [734-304](#) [8-141-P](#) [FKCT 2.5/ 3-ST KMGY](#) [860505](#) [860508](#) [860516](#) [860810](#) [861908](#) [GBPACX-12](#) [93.731.4953.0](#) [PV05-5,08-K](#) [PVP02-5,00](#) [PVP04-3,50](#) [PVS02-5,00](#) [1-1986160-3](#) [H-10](#) [ELFH09150](#) [ELFH16150](#) [ELFP03110](#) [ELFT06250](#) [ELFT07250](#) [ELVF09400](#) [ELVP03100](#) [ELXH03100](#) [ELXH071G0E](#) [ELXP041G0](#) [ELXT046G0](#) [1700101](#) [1700410](#) [1700425](#) [1703176](#) [1703243](#) [1705229](#) [1710175](#) [1714537](#) [1717806](#) [1719600](#) [1729386](#) [1734692](#) [1734795](#)