

SPECIFICATIONS

Rated(额定参数): 150V,4A
 Dielectric strength(抗电强度): AC:1250V/1 Minute
 Insulation Resistance(绝缘电阻):1000MΩ Min
 Contact Resistance(接触电阻):20mΩ Max
 Temp. range(操作温度): -40℃~+105℃
 MAX Soldering(瞬时温度):+250°C,5s

Housing Material(塑件): PA66 (UL94 V-0)
 Contact(端子): Brass, Tin plating(黄铜镀锡)

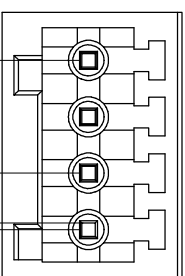
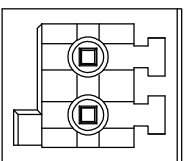
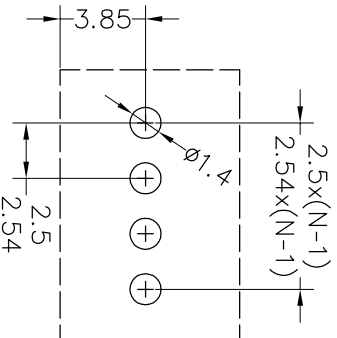

Recommended P.C.B Layout(Top Side)

PITCH RANGE	NOMINAL DIMENSION RANGE	
	IN MM	IN MM
OVER 6	OVER 10	OVER 30
TO 6	TO 10	TO 30
OVER 10	OVER 24	OVER 60
TO 10	TO 24	TO 60
OVER 150	OVER 100	OVER 150
TO 150	TO 100	TO 150
±0.10	±0.15	±0.25
		±0.30
		±0.30
		±0.50
		±0.70
		±1.00

Ordering Information

JL15EDGVC-XXX XX X X 1

Pitch
 250=2.50PH
 254=2.54PH

No. of pins
 2P~24P

Housing Color
 B=Black
 G=Green
 U=Blue
 R=Red
 W=White
 Y=Yellow
 O=Orange
 E=Grey

Packing
 O=Pe bag
 T=Tube
 A=Troy

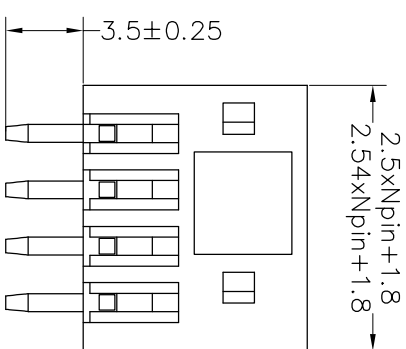
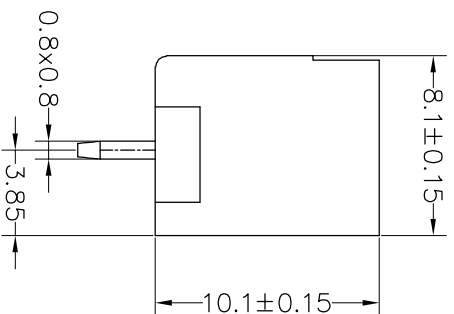

OPERATION		DRAW		SCALE		FIT		PART NO.	
XX	±0.30	yiyusheng	19.08.28	UNIT	mm	A4	1/1	JL15EDGVC-XXXXXX1	
X:XX	±0.20	CHECK		SIZE					
X:XXX	±0.10			SHEET					
Angle	±3°	APPROVE		PROJ.					
REV	DATE	MODIFICATION DESCRIPTION	CHANGE	DIM	TOL	TITLE: 2.50/2.54mm Pitch Male Pluggable Terminal Blocks			
1						A			

JILIN 深圳市锦凌电子有限公司
 SHENZHEN JINLING ELECTRONIC CO.,LTD
 Tel: 86-755-2997-5806/5802 Fax: 86-755-2997-5992

X-ON Electronics

Largest Supplier of Electrical and Electronic Components

Click to view similar products for [Pluggable Terminal Blocks](#) category:

Click to view products by [JILN](#) manufacturer:

Other Similar products are found below :

[57.510.0053](#) [MC 1.5/ 6-ST-3.5 GY AU](#) [ET02015000J0G](#) [860505](#) [860516](#) [860810](#) [GBPACX-12](#) [93.731.4953.0](#) [PV05-5,08-K](#) [PVP03-3,50](#)
[PVS02-5,00](#) [1-1986160-3](#) [1377680000](#) [1531000000](#) [1546228-5](#) [ELFP03110](#) [ELFP10210](#) [ELFT07250](#) [ELVD12100](#) [ELVF09400](#)
[ELVP03100](#) [ELXH071G0E](#) [1700410](#) [1702246](#) [1705229](#) [1714537](#) [1717806](#) [1719600](#) [1728941](#) [1734692](#) [1740291](#) [1740628](#) [1740990](#)
[1746952](#) [1752865](#) [1754115](#) [1754144](#) [1756913](#) [1760051](#) [1760336](#) [1765111](#) [1776388](#) [1777701](#) [1783410](#) [1800227](#) [1801080](#) [1809474](#)
[1812513](#) [1823215](#) [1836066](#)