

**HSF** RoHS

**SPECIFICATIONS**

Rated(额定参数): 300V,8A

Dielectric strength(抗电强度): AC1600V/1 Minute

Insulation Resistance(绝缘电阻):1000MΩ Min

Contact Resistance(接触电阻):20mΩ Max

Temp. range(操作温度): -40℃~+105℃

MAX Soldering(瞬时温度):+250℃,5s

Housing Material(塑件): PA66 (UL94 V-0)

Contact(端子): Brass, Tin plating(黄铜镀锡)

PITCH RANGE IN MM			NOMINAL DIMENSION RANGE IN MM				
TO	OVER	OVER	TO	OVER	OVER	OVER	OVER
6	6 TO 10	10 TO 24	30	30 TO 60	60 TO 100	100 TO 150	150
±0.10	±0.15	±0.25	±0.30	±0.30	±0.50	±0.70	±1.00

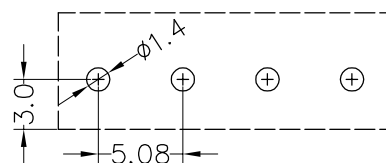
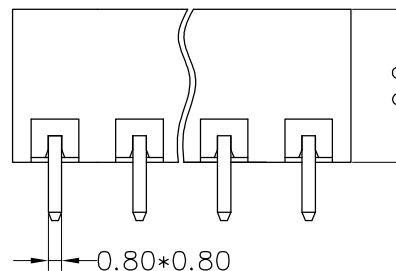
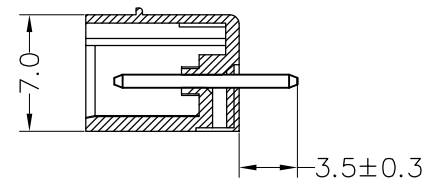
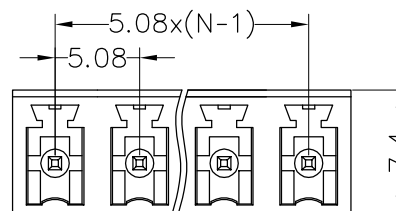
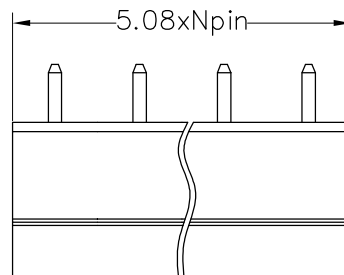
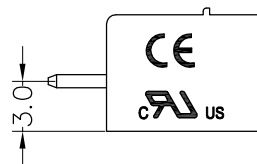

**Ordering Information**

**JL15EDGVC - 508 XX G X 1**

- Pitch 508=5.08PH
- No.of pins 2P~14P
- Housing Color  
B=Black  
G=Green  
U=Blue  
R=Red  
W=White  
Y=Yellow  
O=Orange  
E=Grey
- Packing  
O=Pe bag  
T=Tube  
A=Tray

Recommended P.C.B Layout(Top Side)

OPERATION		DRAW	yiyusheng	19.05.21	SCALE	FIT
X.X	±0.30					
X.XX	±0.20	CHECK			UNIT	mm
X.XXX	±0.10					
Angle	±3°	APPROVE			SIZE	A4
DIM	TOL					
					SHEET	1/1
					PROJ.	

**JILN** 深圳市锦凌电子有限公司  
**SHENZHEN JINLING ELECTRONIC CO.,LTD**  
 Tel: 86-755-2997-5806/5802 Fax: 86-755-2997-5992

A0	2019.05.21	NEW DRAWING	
REV	DATE	MODIFICATION DESCRIPTION	CHANGE

PART NO. JL15EDGVC-508XXGX1  
 TITLE: 5.08mm Pitch Male L=11.0mm Pluggable Terminal Blocks

## X-ON Electronics

Largest Supplier of Electrical and Electronic Components

*Click to view similar products for [Pluggable Terminal Blocks](#) category:*

*Click to view products by [JILN](#) manufacturer:*

Other Similar products are found below :

[57.510.0053](#) [MC 1.5/ 6-ST-3.5 GY AU](#) [ET02015000J0G](#) [734-104](#) [734-302](#) [860505](#) [860516](#) [860810](#) [GBPACX-12](#) [93.731.4953.0](#) [PV05-5,08-K](#) [PVP03-3,50](#) [PVP04-3,50](#) [PVS02-5,00](#) [1-1986160-3](#) [1377680000](#) [1531000000](#) [1546228-5](#) [ELFP03110](#) [ELFT07250](#) [ELVD12100](#) [ELVF09400](#) [ELVP03100](#) [ELXH071G0E](#) [1700410](#) [1702246](#) [1705229](#) [1714537](#) [1717806](#) [1719600](#) [1728941](#) [1734692](#) [1734795](#) [1740291](#) [1740628](#) [1746952](#) [1750207](#) [1752865](#) [1754115](#) [1754144](#) [1756913](#) [1760051](#) [1760336](#) [1765111](#) [1776388](#) [1777701](#) [1783410](#) [1800227](#) [1801080](#) [1809474](#)