

SPECIFICATIONS

Rated(额定参数): 300V,1.5A
 Dielectric strength(抗电强度): AC2000V/1 Minute
 Insulation Resistance(绝缘电阻):1000MΩ Min
 Contact Resistance(接触电阻):20mΩ Max
 Temp. range(操作温度): -40℃~+105℃
 MAX Soldering(瞬时温度):+250℃,5s

Housing Material(塑件): PA66 (UL94 V-0)
 Contact(端子): Brass, Tin plating(黄铜镀锡)

PITCH RANGE		NOMINAL DIMENSION RANGE	
IN MM	OVER	IN MM	OVER
TO 6	10	TO 30	60
TO 10	24	TO 60	100
TO 15		TO 100	150
±0.10	±0.15	±0.25	±0.30
		±0.30	±0.50
			±1.00

Ordering Information

JL2EDGR-XXX XX G X 1

- Pitch
500=5.0PH
508=5.08PH
- No. of pins
2P~24P
- Housing Color
B=Black
G=Green
U=Blue
R=Red
W=White
Y=Yellow
E=Grey
- Packing
0=Pe bag
T=Tube
A=Troy

Recommended P.C.B Layout(Top Side)

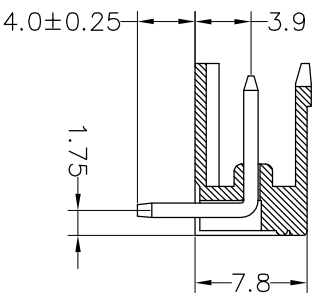
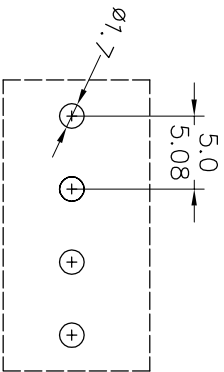
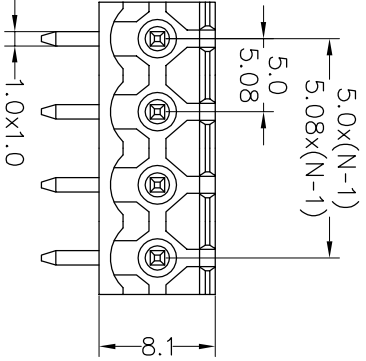
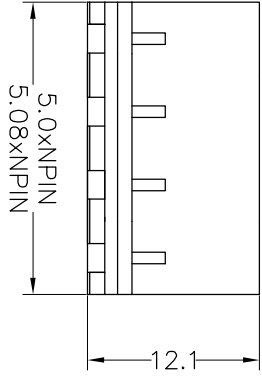

OPERATION		DRAW		BEN		17.01.05		SCALE		FIT		PART NO.	
XX	±0.30							UNIT	mm				JL2EDGR-XXXXXXG1
X:XX	±0.20	CHECK						SIZE	A4	SHEET		1/1	5.0/5.08mm Pitch Male
X:XXX	±0.10	APPROVE						PROU.		TITLE:		Pluggable Terminal Blocks	
Angle	±3°												
DIM	TOL	CHANGE											
REV	DATE	MODIFICATION DESCRIPTION											
A0	2017.01.05	NEW DRAWING											
1													

JIN 深圳市锦凌电子有限公司
 SHENZHEN JINLING ELECTRONIC CO.,LTD
 Tel: 86-755-2997-5806/5802 Fax: 86-755-2997-5992

X-ON Electronics

Largest Supplier of Electrical and Electronic Components

Click to view similar products for [Pluggable Terminal Blocks](#) category:

Click to view products by [JILN](#) manufacturer:

Other Similar products are found below :

[57.404.7553](#) [57.504.0053.7](#) [57.510.0053](#) [57.910.6153](#) [01.112.1453](#) [CTB932VE/6](#) [MC 1.5/ 6-ST-3.5 GY AU](#) [ET02015000J0G](#) [734-104](#) [734-302](#) [734-304](#) [8-141-P](#) [FKCT 2.5/ 3-ST KMGY](#) [860505](#) [860508](#) [860516](#) [860810](#) [861908](#) [GBPACX-12](#) [93.731.4953.0](#) [PV05-5,08-K](#) [PVP02-5,00](#) [PVP04-3,50](#) [PVS02-5,00](#) [1-1986160-3](#) [H-10](#) [ELFH09150](#) [ELFH16150](#) [ELFP03110](#) [ELFT06250](#) [ELFT07250](#) [ELVF09400](#) [ELVP03100](#) [ELXH03100](#) [ELXH071G0E](#) [ELXP041G0](#) [ELXT046G0](#) [1700101](#) [1700410](#) [1700425](#) [1703176](#) [1703243](#) [1705229](#) [1710175](#) [1714537](#) [1717806](#) [1719600](#) [1729386](#) [1734692](#) [1734795](#)