

SPECIFICATIONS

Rated(额定参数): 300V,1.5A
 Dielectric strength(抗电强度): AC2000V/1 Minute
 Insulation Resistance(绝缘电阻):1000MΩ Min
 Contact Resistance(接触电阻):20mΩ Max
 Temp. range(操作温度): -40℃~+105℃
 MAX Soldering(瞬时温度):+250℃,5s

Housing Material(塑件): PA66 (UL94 V-0)
 Contact(端子): Brass, Tin plating(黄铜镀锡)

| PITCH RANGE | | NOMINAL DIMENSION RANGE | | | | | |
|-------------|-------|-------------------------|-------|-------|-------|-------|-------|
| IN MM | | IN MM | | IN MM | | IN MM | |
| OVER | TO | OVER | TO | OVER | TO | OVER | TO |
| 6 | 10 | 10 | 24 | 30 | 60 | 100 | 150 |
| ±0.10 | ±0.15 | ±0.25 | ±0.30 | ±0.30 | ±0.50 | ±0.70 | ±1.00 |

Ordering Information

JL2EDGVC-XXX XX G X 1

Pitch
 500=5.00PH
 508=5.08PH

No. of pins
 2P~24P

Housing Color
 B=Black
 G=Green
 U=Blue
 R=Red
 W=White
 Y=Yellow
 O=Orange
 E=Grey

Packing
 O=Pe bog
 A=Troy
 T=Tube

Recommended P.C.B Layout(Top Side)

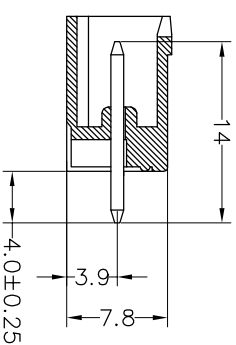
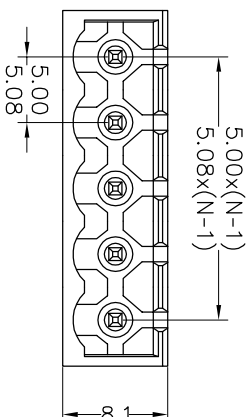
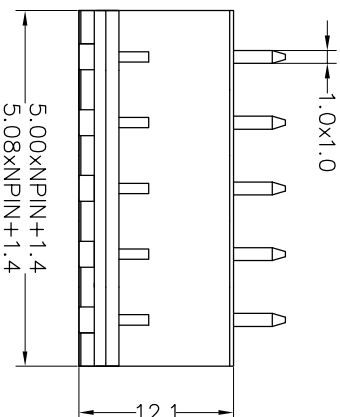
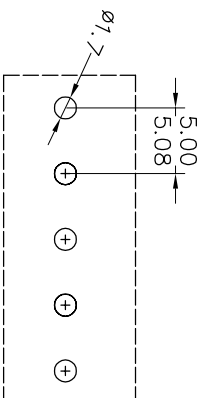

| OPERATION | | DRAW | | SCALE | | FIT | | PART NO. | |
|-----------|-------|---------|---------|--|----|---------------------------|-----|------------------------|--|
| XX | ±0.30 | yy | yusheng | UNIT | mm | 1/1 | A4 | JL2EDGVC-500(508)XXGX1 | |
| X:XX | ±0.20 | CHECK | | SIZE | | SHEET | 1/1 | 5.00/5.08mm Pitch Male | |
| X:XXX | ±0.10 | APPROVE | | PROU. | | Pluggable Terminal Blocks | | | |
| Angle | ±3° | | | TITLE: | | | | | |
| DIM | TOL | | | REV 1 DATE 2018.12.24 MODIFICATION DESCRIPTION NEW DRAWING | | | | | |
| CHANGE | | CHANGE | | CHANGE | | CHANGE | | CHANGE | |

JILIN 深圳市锦凌电子有限公司
 SHENZHEN JINLING ELECTRONIC CO.,LTD
 Tel: 86-755-2997-5806/5802 Fax: 86-755-2997-5992

X-ON Electronics

Largest Supplier of Electrical and Electronic Components

Click to view similar products for [Pluggable Terminal Blocks](#) category:

Click to view products by [JILN](#) manufacturer:

Other Similar products are found below :

[57.404.7553](#) [57.504.0053.7](#) [57.510.0053](#) [57.910.6153](#) [01.112.1453](#) [CTB932VE/6](#) [MC 1.5/ 6-ST-3.5 GY AU](#) [ET02015000J0G](#) [734-104](#) [734-302](#) [734-304](#) [8-141-P](#) [FKCT 2.5/ 3-ST KMGY](#) [860505](#) [860508](#) [860516](#) [860810](#) [861908](#) [GBPACX-12](#) [93.731.4953.0](#) [PV05-5,08-K](#) [PVP02-5,00](#) [PVP04-3,50](#) [PVS02-5,00](#) [1-1986160-3](#) [H-10](#) [1546228-5](#) [ELFH09150](#) [ELFH16150](#) [ELFP03110](#) [ELFT06250](#) [ELFT07250](#) [ELVF09400](#) [ELVP03100](#) [ELXH03100](#) [ELXH071G0E](#) [ELXP041G0](#) [ELXT046G0](#) [1700101](#) [1700410](#) [1700425](#) [1703176](#) [1703243](#) [1705229](#) [1710175](#) [1714537](#) [1717806](#) [1719600](#) [1728941](#) [1729386](#)