

RoHS

MAPX

MODIFICATION

DRW

DATE

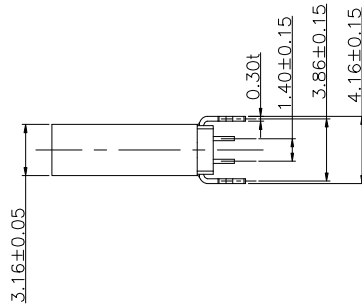
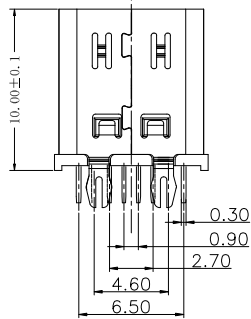
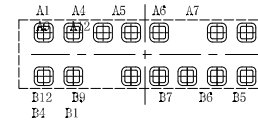
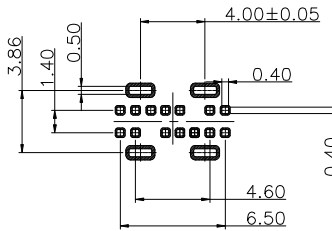
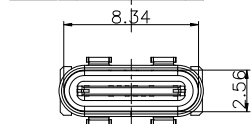
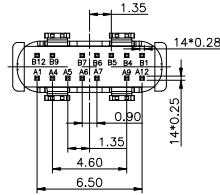
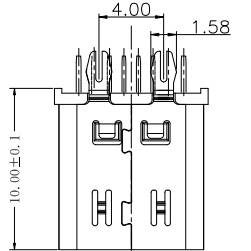

RECOMMENDED P.C.B. LAYOUT  
TOLERANCE UNSPECIFIED ±0.05mm

A1	QND	B12	QND
A4	VBUS	B9	VBUS
A5	CC1	B8	
A6	DP1	B7	DN2
A7	DM1	B6	DP2
A8		B5	CC2
A9	VBUS	B4	VBUS
A12	QND	B1	QND
PIN	SIGNAL NAME	PIN	SIGNAL NAME

NOTE :  
UT03FD014SX01ZA

1. Seletive Plating
  - S1:5u" Gold In Contact Area
  - 100u" Tin In Tail Area
  - S2:0.8u" Gold In Contact Area
  - 100u" Tin In Tail Area
  - S3:10u" Gold In Contact Area
  - 100u" Tin In Tail Area
  - S4:15u" Gold In Contact Area
  - 100u" Tin In Tail Area
  - S5:30u" Gold In Contact Area
  - 100u" Tin In Tail Area

7				
6				
5				
4	TYPE C MD	HIGH TEMP	BLACK	UL 94V-0
3	CENTER PIECE	STAINLESS STEEL	—	NO Plated
2	TYPE C TERMINAL	COPPER ALLOY	—	Gold Plated
1	SHELL	STAINLESS STEEL	—	Ni Plated
NO.	DESCRIPTION	MATERIAL	COLOR	REMARK

产品图			
PRODUCT CHART DWG			
公差一览表			
TOLERANCE UNLESS OTHERWISE			
X.	±0.25	X.	±5.°
.X	±0.20	.X	±2.°
.XX	±0.15	.XX	±1.°
.XXX	±0.05	.XXX	±0.5°

深圳市精拓金电子有限公司  
Shenzhen Jing Tuo Jin Electronics Co., Ltd.

单位	MM	制图	YANG	制图料号	918-418K2022Y40021
UNITS	MM	DRAWING	YANG	PRODUCT PART NO.	918-418K2022Y40021
比例	1:1	审核	郭治富	产品名称	TYPE-C3.1母座立式10.0四鱼叉
SCALE	1:1	CHKD	郭治富	PRODUCT NO.	脚不锈钢有弹LCP黑胶14PIN四卡点
日期	2020-05-22	核准	黄国荣	角法	⊕
DATE	2020-05-22	APPD	黄国荣	VIEW	版本
					VER
					AD

## X-ON Electronics

Largest Supplier of Electrical and Electronic Components

*Click to view similar products for [USB Connectors](#) category:*

*Click to view products by [Jing](#) manufacturer:*

Other Similar products are found below :

[950](#) [MUSBD11135](#) [17-200721](#) [217450-1](#) [KMBVX-TH-5S-B30](#) [KUSBX-AS2N-W](#) [KUSBX-SMT2AP1S-W30](#) [935](#) [957](#) [30-498-6](#) [SK-60A-2](#)  
[1734082-1](#) [30-470](#) [30-489](#) [30-541](#) [A-USB A-2P-C](#) [MIKROE-1451](#) [USBFTVSCCG](#) [1-1734084-2](#) [10135326-001LF](#) [4198](#) [USB-A-D-VT](#)  
[USB-A-S-RA-TSMT](#) [1310-1023-02](#) [690-024-633-031](#) [UB-20PMFP-LC7001](#) [17-200011](#) [UB-20AFMM-LL7A01](#) [1040870124](#) [CAP-](#)  
[WCCMLPB1](#) [CAP-WCCMLPC1](#) [2274475-3](#) [UB-20BMFA-SL8001](#) [914-614A2025S10200](#) [USB3FTV7SAGF059](#) [ZX40-B-5S-1500-](#)  
[STDA\(30\)](#) [GSB3116344HR](#) [USB3FTV2SAZNF459](#) [USB3FTV7SAZNF459](#) [U221-041N-1WVS62-F5D](#) [HYCW153-USBD05-500B](#)  
[HYCW219-USBD05-075B](#) [HYCW148-USBD05-117B](#) [HYCW149-USBD05-740B](#) [HYCW204-USBD05-108B](#) [HYCW214-USBA04-113B](#)  
[HYCW213-USBA04-113B](#) [UB-20AMFM-SL7A01](#) [KMMX-BSMT35S-1-B30TR](#) [2345986-1](#)