



## Schottky Barrier Diode

### FEATURES

- Low Forward Voltage Drop
- Guard Ring Construction for Transient Protection
- Negligible Reverse Recovery Time
- Low Capacitance

### PINNING

PIN	DESCRIPTION
1	Cathode
2	Anode

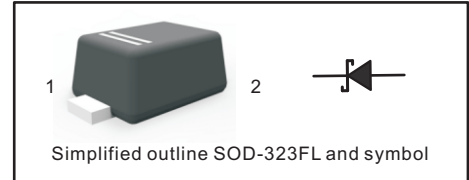

### MECHANICAL DATA

- Case: SOD-323FL
- Terminals: Solderable per MIL-STD-750, Method 2026
- Approx. Weight: 4.5mg / 0.00016oz

### Maximum Ratings and Electrical characteristics

Ratings at 25 °C ambient temperature unless otherwise specified.

Parameter	Symbols	SD103AWSFL	SD103BWSFL	SD103CWSFL	Units
Peak Repetitive Reverse Voltage	$V_{RRM}$	40	30	20	V
RMS reverse voltage	$V_{RMS}$	28	21	14	V
Working Peak Reverse Voltage	$V_{DC}$	40	30	20	V
Peak Forward Surge Current, 1.0s single half sine-wave superimposed on rated load (JEDEC method)	$I_{FSM}$	1.5			A
Maximum Instantaneous Forward Voltage	$V_F$	$I_F=20mA$			0.37
		$I_F=200mA$			0.60
Power Dissipation	$P_D$	200			mW
Reverse current	$I_R$	SD103AWSFL, $V_R=30V$	5	–	uA
		SD103BWSFL, $V_R=20V$	–	5	
		SD103CWSFL, $V_R=10V$	–	–	
Thermal Resistance, Junction to Ambient Air	$R_{\theta JA}$	300			°C/W
Reverse voltage	$V_{(BR)R}$	SD103AWSFL	40		V
		SD103BWSFL	30		
		SD103CWSFL	20		
Reverse recovery time	$t_{rr}$	$I_F=I_R=200mA, I_{rr}=0.1 \times I_R, R_L=100\Omega$			ns
Forward Continuons Current	$I_{FM}$	350			mA
Total capacitance	$C_{tot}$	$V_R=0V, f=1MHz$			pF
Junction temperature	$T_j$	125			°C
Storage temperature	$T_{stg}$	-55 ~ +150			°C



Fig.1 Forward Current Derating Curve

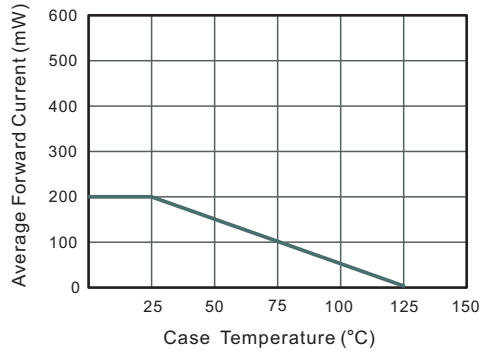

Fig.2 Typical Reverse Characteristics

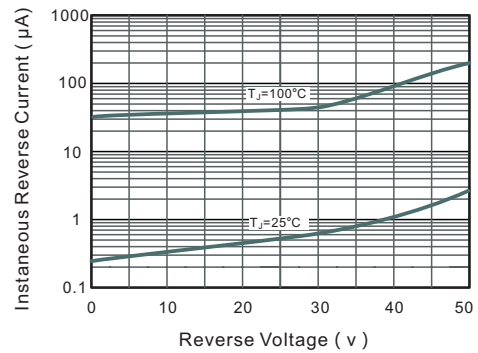

Fig.3 Forward Characteristics

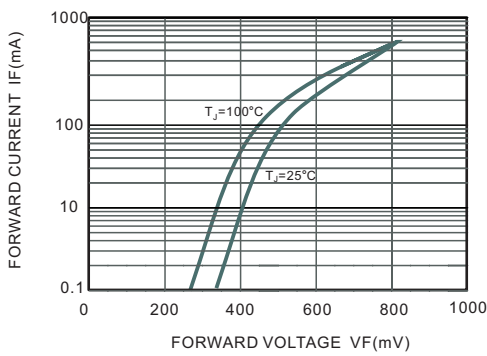

Fig.4 Maximum Non-Repetitive Peak Forward Surge Current

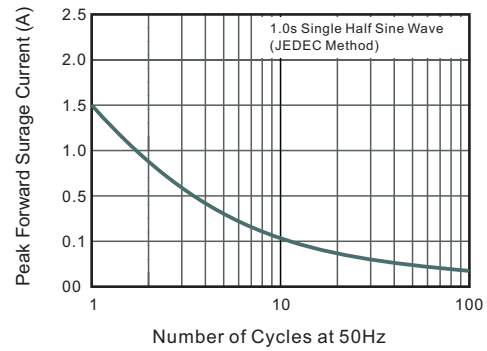
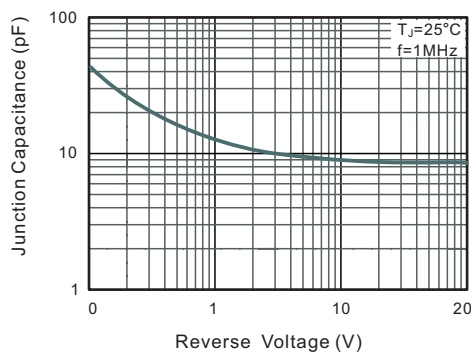

Fig.5 Typical Junction Capacitance





**PACKAGE OUTLINE**

Plastic surface mounted package; 2 leads

SOD-323FL

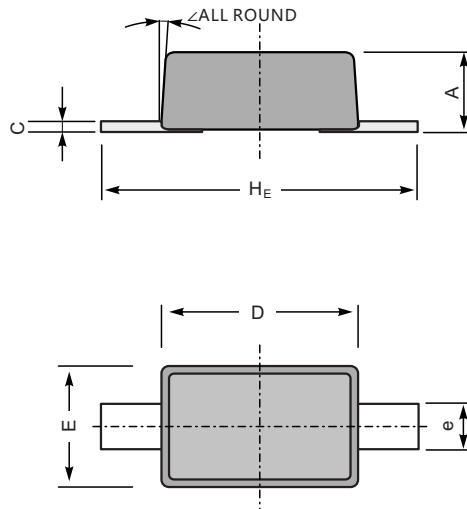

UNIT		A	C	D	E	e	H <sub>E</sub>	∠
mm	max	1.0	0.25	1.8	1.35	0.4	2.7	8°
	min	0.8	0.05	1.6	1.15	0.25	2.3	
mil	max	39	9.8	71	53	18	106	
	min	31	2.0	63	45	10	91	

**The recommended mounting pad size**

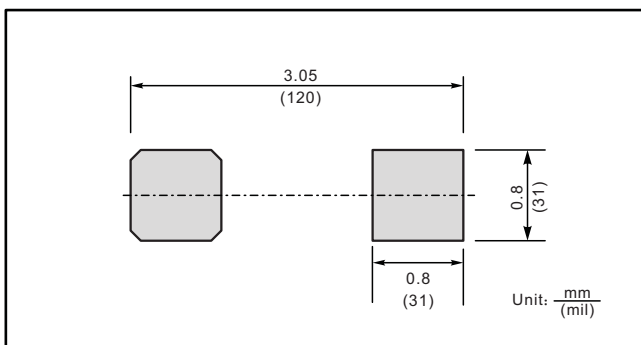

**Marking**

Type number	Marking code
SD103AWSFL	S4
SD103BWSFL	S5
SD103CWSFL	S6

## X-ON Electronics

Largest Supplier of Electrical and Electronic Components

*Click to view similar products for [Schottky Diodes & Rectifiers](#) category:*

*Click to view products by [Jingdao](#) manufacturer:*

Other Similar products are found below :

[MA4E2039](#) [MA4E2508M-1112](#) [MBR1545CT](#) [MMBD301M3T5G](#) [RB160M-50TR](#) [D83C](#) [BAS16E6433HTMA1](#) [BAT 54-02LRH E6327](#)  
[NRVBAF360T3G](#) [NSR05F40QNXT5G](#) [NTE555](#) [JANS1N6640](#) [SK310-T](#) [SK34B-TP](#) [SS3003CH-TL-E](#) [GA01SHT18](#)  
[CRS10I30A\(TE85L,QM](#) [MA4E2501L-1290](#) [MBRA140TRPBF](#) [MBRB30H30CT-1G](#) [BAT 15-04R E6152](#) [JANTX1N5712-1](#) [DMJ3940-000](#)  
[SB007-03C-TB-E](#) [SK33B-TP](#) [NRVBB20100CTT4G](#) [NRVBM120LT1G](#) [NTSB30U100CT-1G](#) [VS-6CWQ10FNHM3](#) [CRG04\(T5L,TEMQ\)](#)  
[ACDBA1100LR-HF](#) [ACDBA1200-HF](#) [ACDBA240-HF](#) [ACDBA3100-HF](#) [CDBQC0530L-HF](#) [CDBQC0240LR-HF](#) [ACDBA260LR-HF](#)  
[ACDBA1100-HF](#) [MA4E2502L-1246](#) [10BQ015-M3/5BT](#) [NRVBM120ET1G](#) [CRS08TE85LQM](#) [PMAD1108-LF](#) [B120Q-13-F](#) [1N5819T-G](#)  
[B0530WSQ-7-F](#) [PDS1040Q-13](#) [B160BQ-13-F](#) [SDM05U20CSP-7](#) [B140S1F-7](#)