



Silicon Planar Zener Diodes

Features

- Total power dissipation: max. 500 mW
- Small plastic package suitable for surface mounted design
- Tolerance approximately ± 5%

PINNING

| PIN | DESCRIPTION |
|-----|-------------|
| 1   | Cathode     |
| 2   | Anode       |

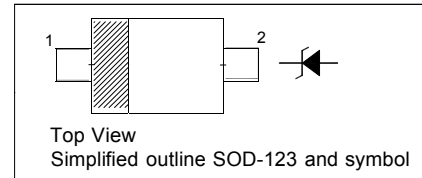

Absolute Maximum Ratings (T<sub>a</sub> = 25 °C)

| Parameter                 | Symbol           | Value         | Unit |
|---------------------------|------------------|---------------|------|
| Power Dissipation         | P <sub>tot</sub> | 500           | mW   |
| Junction Temperature      | T <sub>J</sub>   | 150           | °C   |
| Storage Temperature Range | T <sub>Stg</sub> | - 55 to + 150 | °C   |

Characteristics at T<sub>a</sub> = 25 °C

| Parameter                                    | Symbol           | Max. | Unit |
|--|------------------|------|------|
| Thermal Resistance Junction to Ambient Air   | R <sub>thA</sub> | 340  | °C/W |
| Forward Voltage<br>at I <sub>F</sub> = 10 mA | V <sub>F</sub>   | 0.9  | V    |

**Silicon Planar Zener Diodes****Characteristics at  $T_a = 25\text{ }^\circ\text{C}$** 

| Type    | Marking Code | Zener Voltage Range <sup>1)</sup> |                |                   | Dynamic Impedance <sup>2)</sup> |                | Reverse Leakage Current       |               |
|---------|--------------|-----------------------------------|----------------|-------------------|---------------------------------|----------------|-------------------------------|---------------|
|         |              | $V_{znom}$<br>V                   | $I_{ZT}$<br>mA | for $V_{ZT}$<br>V | $Z_{ZT}$ (Max.)<br>$\Omega$     | at $I_Z$<br>mA | $I_R$ (Max.)<br>$\mu\text{A}$ | at $V_R$<br>V |
| MM1Z2V0 | 4A           | 2.0                               | 5              | 1.8...2.15        | 100                             | 5              | 120                           | 0.5           |
| MM1Z2V2 | 4B           | 2.2                               | 5              | 2.08...2.33       | 100                             | 5              | 120                           | 0.7           |
| MM1Z2V4 | 4C           | 2.4                               | 5              | 2.28...2.56       | 100                             | 5              | 120                           | 1             |
| MM1Z2V7 | 4D           | 2.7                               | 5              | 2.5...2.9         | 110                             | 5              | 120                           | 1             |
| MM1Z3V0 | 4E           | 3.0                               | 5              | 2.8...3.2         | 120                             | 5              | 50                            | 1             |
| MM1Z3V3 | 4F           | 3.3                               | 5              | 3.1...3.5         | 130                             | 5              | 20                            | 1             |
| MM1Z3V6 | 4H           | 3.6                               | 5              | 3.4...3.8         | 130                             | 5              | 10                            | 1             |
| MM1Z3V9 | 4J           | 3.9                               | 5              | 3.7...4.1         | 130                             | 5              | 5                             | 1             |
| MM1Z4V3 | 4K           | 4.3                               | 5              | 4...4.6           | 130                             | 5              | 5                             | 1             |
| MM1Z4V7 | 4M           | 4.7                               | 5              | 4.4...5           | 130                             | 5              | 2                             | 1             |
| MM1Z5V1 | 4N           | 5.1                               | 5              | 4.8...5.4         | 130                             | 5              | 2                             | 1.5           |
| MM1Z5V6 | 4P           | 5.6                               | 5              | 5.2...6           | 80                              | 5              | 1                             | 2.5           |
| MM1Z6V2 | 4R           | 6.2                               | 5              | 5.8...6.6         | 50                              | 5              | 1                             | 3             |
| MM1Z6V8 | 4X           | 6.8                               | 5              | 6.4...7.2         | 30                              | 5              | 0.5                           | 3.5           |
| MM1Z7V5 | 4Y           | 7.5                               | 5              | 7...7.9           | 30                              | 5              | 0.5                           | 4             |
| MM1Z8V2 | 4Z           | 8.2                               | 5              | 7.7...8.7         | 30                              | 5              | 0.5                           | 5             |
| MM1Z9V1 | 5A           | 9.1                               | 5              | 8.5...9.6         | 30                              | 5              | 0.5                           | 6             |
| MM1Z10  | 5B           | 10                                | 5              | 9.4...10.6        | 30                              | 5              | 0.1                           | 7             |
| MM1Z11  | 5C           | 11                                | 5              | 10.4...11.6       | 30                              | 5              | 0.1                           | 8             |
| MM1Z12  | 5D           | 12                                | 5              | 11.4...12.7       | 35                              | 5              | 0.1                           | 9             |
| MM1Z13  | 5E           | 13                                | 5              | 12.4...14.1       | 35                              | 5              | 0.1                           | 10            |
| MM1Z15  | 5F           | 15                                | 5              | 13.8...15.6       | 40                              | 5              | 0.1                           | 11            |
| MM1Z16  | 5H           | 16                                | 5              | 15.3...17.1       | 40                              | 5              | 0.1                           | 12            |
| MM1Z18  | 5J           | 18                                | 5              | 16.8...19.1       | 45                              | 5              | 0.1                           | 13            |
| MM1Z20  | 5K           | 20                                | 5              | 18.8...21.2       | 50                              | 5              | 0.1                           | 15            |
| MM1Z22  | 5M           | 22                                | 5              | 20.8...23.3       | 55                              | 5              | 0.1                           | 17            |
| MM1Z24  | 5N           | 24                                | 5              | 22.8...25.6       | 60                              | 5              | 0.1                           | 19            |
| MM1Z27  | 5P           | 27                                | 5              | 25.1...28.9       | 70                              | 2              | 0.1                           | 21            |
| MM1Z30  | 5R           | 30                                | 5              | 28...32           | 80                              | 2              | 0.1                           | 23            |
| MM1Z33  | 5X           | 33                                | 5              | 31...35           | 80                              | 2              | 0.1                           | 25            |
| MM1Z36  | 5Y           | 36                                | 5              | 34...38           | 90                              | 2              | 0.1                           | 27            |
| MM1Z39  | 5Z           | 39                                | 2.5            | 37...41           | 100                             | 2              | 2                             | 30            |
| MM1Z43  | 6A           | 43                                | 2.5            | 40...46           | 130                             | 2              | 2                             | 33            |
| MM1Z47  | 6B           | 47                                | 2.5            | 44...50           | 150                             | 2              | 2                             | 36            |
| MM1Z51  | 6C           | 51                                | 2.5            | 48...54           | 180                             | 2              | 1                             | 39            |
| MM1Z56  | 6D           | 56                                | 2.5            | 52...60           | 180                             | 2              | 1                             | 43            |
| MM1Z62  | 6E           | 62                                | 2.5            | 58...66           | 200                             | 2              | 0.2                           | 47            |
| MM1Z68  | 6F           | 68                                | 2.5            | 64...72           | 250                             | 2              | 0.2                           | 52            |
| MM1Z75  | 6H           | 75                                | 2.5            | 70...79           | 300                             | 2              | 0.2                           | 57            |

<sup>1)</sup>  $V_Z$  is tested with pulses (20 ms).<sup>2)</sup>  $Z_{ZT}$  is measured at  $I_Z$  by given a very small A.C. current signal.



Silicon Planar Zener Diodes

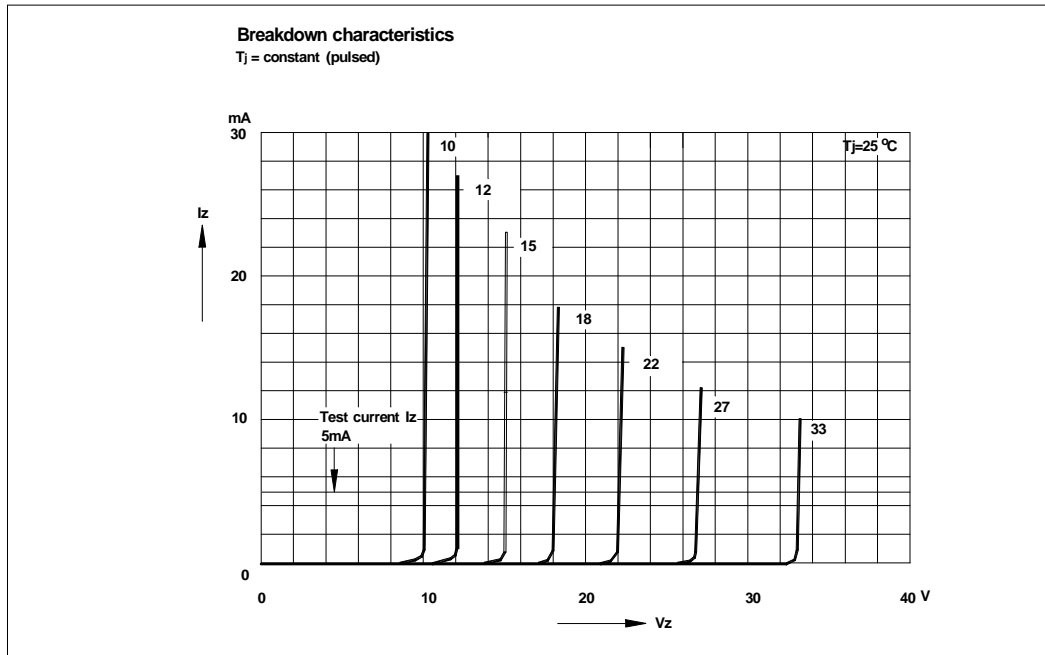
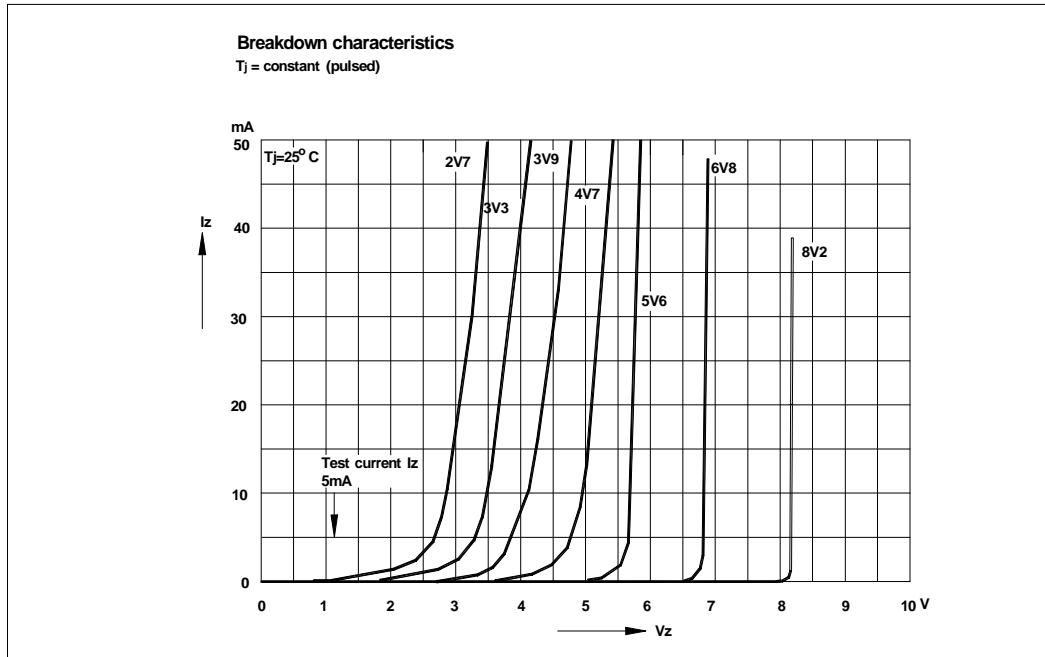



PACKAGE OUTLINE

Plastic surface mounted package; 2 leads

SOD-123

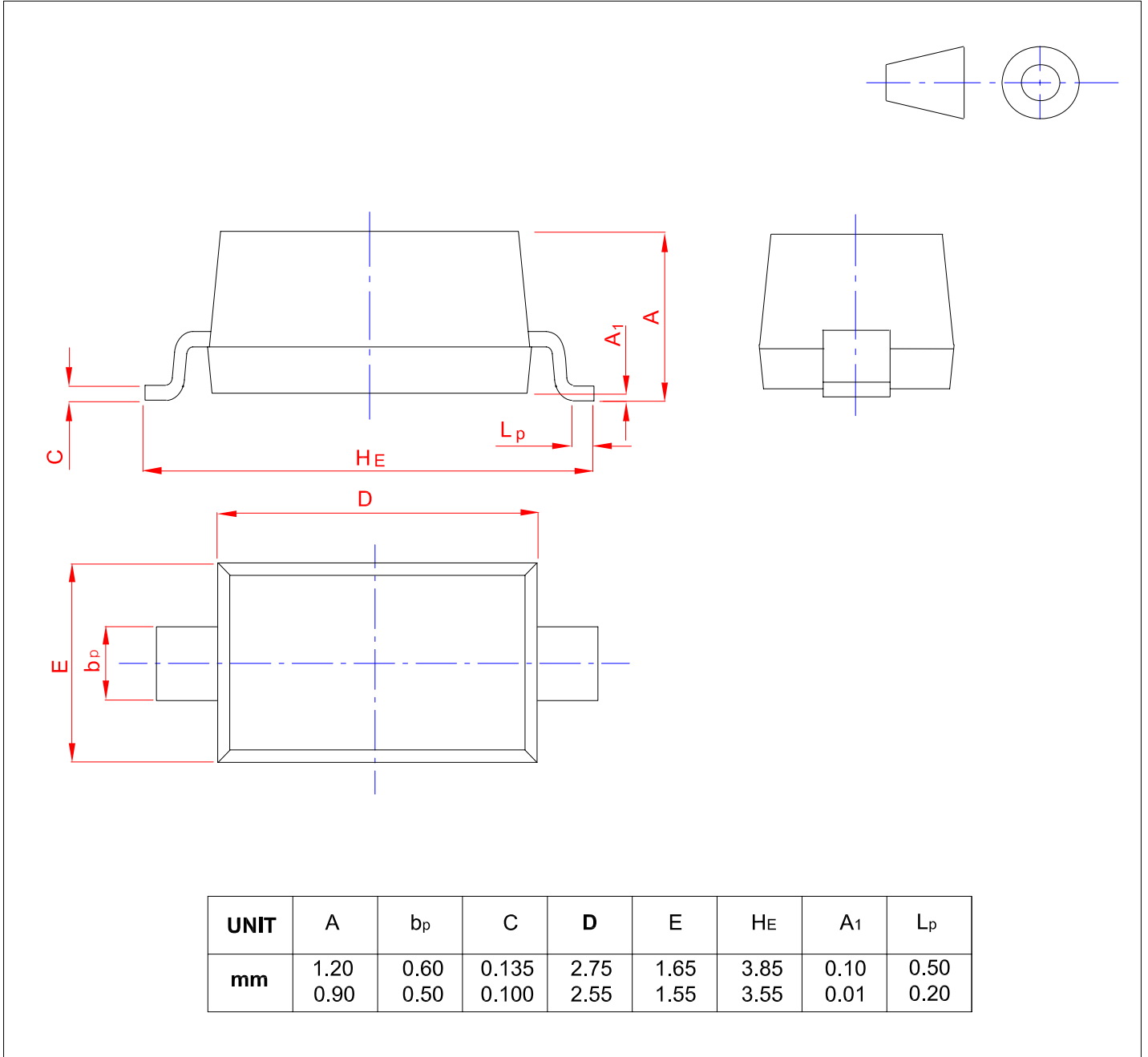

## X-ON Electronics

Largest Supplier of Electrical and Electronic Components

*Click to view similar products for [Zener Diodes](#) category:*

*Click to view products by [Jinyu](#) manufacturer:*

Other Similar products are found below :

[MMSZ5245BS-7-F](#) [RKZ13B2KG#P1](#) [RKZ5.6B2KJ#R1](#) [EDZTE6113B](#) [EDZTE6116B](#) [EDZTE616.8B](#) [1N747A](#) [1N966B](#) [NTE5116A](#)  
[NTE5121A](#) [NTE5139A](#) [NTE5147A](#) [NTE5152A](#) [NTE5155A](#) [NTE5156A](#) [NTE5164A](#) [JANS1N4974US](#) [SMAJ4764A-TP](#) [RKZ5.1BKU#P6](#)  
[3SMAJ5946B-TP](#) [3SMAJ5950B-TP](#) [3SMBJ5920B-TP](#) [3SMBJ5925B-TP](#) [TDZTR24](#) [441774C](#) [MMSZ4678-TP](#) [MMSZ5232BQ-13-F](#)  
[BZG04-36](#) [BZG05C9V1-HE3-TR](#) [HZM30NBTR-E](#) [UDZTE-175.1B](#) [3SMAJ5945B-TP](#) [3SMAJ5947B-TP](#) [3SMBJ5941B-TP](#) [DL4746A-TP](#)  
[RKZ18B2KK#R1](#) [RKZ10B2KL#R1](#) [RKZ6.8B2KL#R1](#) [RKZ8.2B2KL#R1](#) [DZ2S240M0L](#) [SMAZ27-TP](#) [SMBZ5920B-E3/52](#) [ZMM3.0](#)  
[RD16UM-T1-A](#) [RD39S-T1-A](#) [RD9.1S-T1-A](#) [RD10S-T1-A](#) [RD20S-T1-A](#) [RD2.2S-T1-A](#) [RD2.7UM-T1-A](#)