

D ± 0.10  
02P ~ 10P

P/N LEGEND

A1253 HA-XP  
① ② ③

- ① Series No.
- ② Connector type: H=Housing
- ③ No. of circuits

SPECIFICATIONS

Current Rating: 1A AC,DC  
Voltage Rating: 150V AC,DC  
Temperature Range: -25°C ~ +85°C  
Contact Resistance: 20mΩ Max.  
Insulation Resistance: 500MΩ Min.  
Withstanding Voltage: 500V AC/minute  
Material: Nylon 66,UL94V-0  
Color: Natural(White)

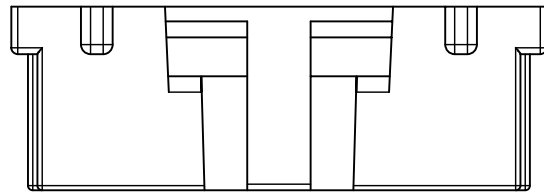

D ± 0.10  
11P ~ 30P

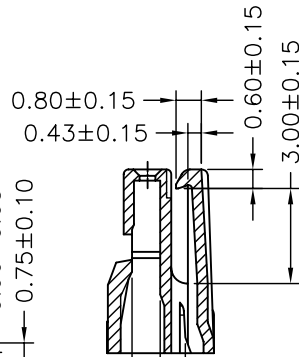

0.80 ± 0.15  
0.43 ± 0.15

0.60 ± 0.15  
3.00 ± 0.15

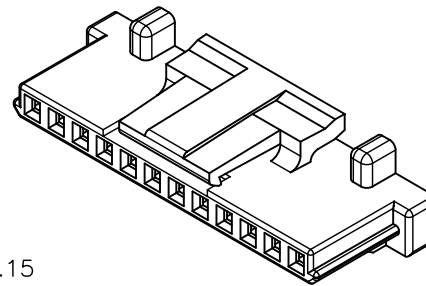

Circuit No.	Dimensions			
	A	B	C	D
02P	1.25	4.40	2.75	1.10
03P	2.50	5.65	4.00	1.95
04P	3.75	6.90	5.25	3.20
05P	5.00	8.15	6.50	3.20
06P	6.25	9.40	7.75	3.20
07P	7.50	10.65	9.00	3.20
08P	8.75	11.90	10.25	3.20
09P	10.00	13.15	11.50	3.20
10P	11.25	14.40	12.75	3.20
11P	12.50	15.65	14.00	4.70
12P	13.75	16.90	15.25	4.70
13P	15.00	18.15	16.50	4.70
14P	16.25	19.40	17.75	4.70
15P	17.50	20.65	19.00	4.70
16P	18.75	21.90	20.25	4.70
20P	23.75	26.90	25.25	4.70
25P	30.00	33.15	31.50	5.70
30P	36.25	39.40	37.75	5.70

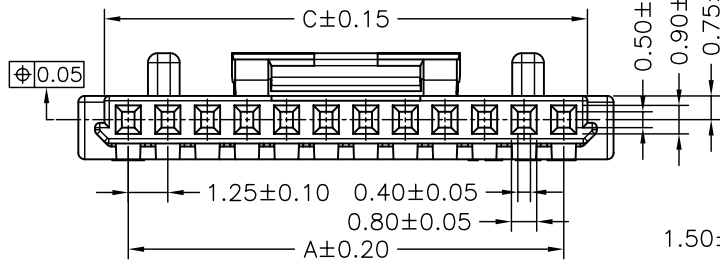

± 0.05

C ± 0.15

0.50 ± 0.05  
0.90 ± 0.05  
0.75 ± 0.10

0.90 ± 0.15  
0.89 ± 0.08

SEC:A-A

1.25 ± 0.10  
0.40 ± 0.05  
0.80 ± 0.05

A ± 0.20

1.50 ± 0.10  
1.50 ± 0.10  
0.15 ± 0.10

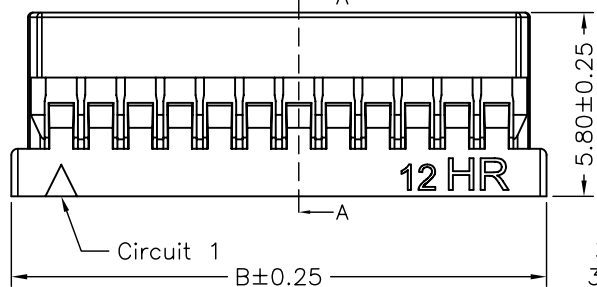

12 HR

5.80 ± 0.25  
2.00 ± 0.15  
3.35 ± 0.20

B ± 0.25

						燦達電子工業股份有限公司 JOINT TECH ELECTRONIC IND. CO., LTD.					
UNIT		SCALE	SHEET	TITLE:							
mm			1 of 1	1.25mm PITCH HOUSING-LOCK TYPE							
DRAWN BY		APPROVED BY						DRAW NO. :		REV. BO	
歐陽小強		謝瑞清									
2007.12.23		2007.12.23									
GENERAL TOLERANCE											
B0	XXXXXXXXXX	2017.07.05	周傑亮	X.X ± 0.25	ANGLE ±						
A5	EN1103220076	2011.03.22	陳敏	X.XX ± 0.15							
REV.	DESCRIPTION	DATE	DATE	X.XXX ± 0.05							

DRAW NO. : A1253HA-XP

## X-ON Electronics

Largest Supplier of Electrical and Electronic Components

*Click to view similar products for [Headers & Wire Housings](#) category:*

*Click to view products by [Joint Tech](#) manufacturer:*

Other Similar products are found below :

[0015917161](#) [0022155065](#) [57102-F02-18ULF](#) [58102-G61-06LF](#) [582553-1](#) [01.001.5753.1](#) [0050291907](#) [02.125.8002.8](#) [609-3404](#) [61062-3](#)  
[CSU011177004](#) [622-0430](#) [622-3653LF](#) [63453-116](#) [636-1030](#) [636-1427](#) [636-3427](#) [636-4007](#) [641938-9](#) [65495-038](#) [65692-001LF](#) [65781-018](#)  
[65781-047](#) [65817-010LF](#) [65817-015LF](#) [67095-007LF](#) [67601157](#) [68631-112](#) [68645-018](#) [699319-000](#) [70.362.1628.0](#) [70-4210](#) [70-4226B](#) [70-](#)  
[4853B](#) [71.350.2428.0](#) [733-134](#) [733-162](#) [760-3052](#) [MHR-64-VUAL](#) [80.063.4001.1](#) [800-90-001-10-001000](#) [801-43-002-10-013000](#)  
[801-43-006-10-002000](#) [803-43-024-10-001000](#) [803-93-012-10-001000](#) [8-1437020-4](#) [819-22-004-30-001101](#) [820-22-006-30-001101](#)  
[820-22-008-30-001101](#) [821-22-002-10-001101](#)