

REV.	DESCRIPTION	DATE	NAME	X.XXX±0.05	ANGLE	DRAWN BY 周傑亮 2013.01.03	APPROVED BY 謝瑞清 2008.12.25	GENERAL TOLERANCE	UNIT	SCALE	SHEET	TITLE: 聯達電子工業股份有限公司 JOINT TECH ELECTRONIC IND. CO., LTD.
A3	EN1008030208	2010.08.03	陳敏	X.XX±0.15								
A4	EN1012300309	2011.02.17	陳敏	X.X±0.25		2008.12.25			mm	1 : 1	1 of 2	1.25mm PITCH 180° WAFER-SMT TYPE, WITHOUT BOSS
A5	EN109190398	2011.09.19	陳敏									DRAW NO. : A1253WVA-S-XPXXXXXXXXXX
B0	EN1205170160	2012.05.21	陳敏									REV. B3
B1	EN1207030214	2012.05.31	周傑亮									
B2	EN1303010062	2013.01.03	周傑亮									
B3	EN1506170003	2015.06.17	唐騰鳳									

Dimensions		A		B		C	
Circuit	No.	A	B	C	A	B	C
30P	36.25	42.45	6.00				
25P	30.00	36.20	6.00				
20P	23.75	29.95	5.00				
15P	17.50	23.70	5.00				
14P	16.25	22.45	5.00				
13P	15.00	21.20	5.00				
12P	13.75	19.95	5.00				
11P	12.50	18.70	5.00				
10P	11.25	17.45	3.50				
09P	10.00	16.20	3.50				
08P	8.75	14.95	3.50				
07P	7.50	13.70	3.50				
06P	6.25	12.45	3.50				
05P	5.00	11.20	3.50				
04P	3.75	9.95	3.50				
03P	2.50	8.70	3.50				
02P	1.25	7.45	3.50				

P/N LEGEND

① Series No. A1253 WVA-S-XP N X B XX X 00 L

② Connector type: WVA=Vertical A Type

③ Mounting type: S=SMT

④ No. of circuits

⑤ Material: 6=Nylon 6T-V0; L=LCP-V0

⑥ Color: B=Black

⑦ Pin Material: Brass/Gold-flash

⑧ Nickel-plated 30u" ↓

⑨ Solder Tabs: Brass/Gold-flash

⑩ Nickel-plated 30u" ↓

⑪ Material: LCP/Nylon 6T,UL94V-0

⑫ Color: Natural(Black)

SPECIFICATIONS

Current Rating: 1A AC,DC

Voltage Rating: 150V AC,DC

Temperature Range: -25°C ~ +85°C

Contact Resistance: 20mΩ Max.

Insulation Resistance: 500MΩ Min.

Withstanding Voltage: 500V AC/minute

① Packing code: L=Tape&Reel(With cap)

② Option code:00=Standard

③ G=Gold-flash;T1=Matte Tin-plated

④ Plating code for contacts: Gold Flash on Solder Area

⑤ S5=Gold-plated 15u" on Contact Area

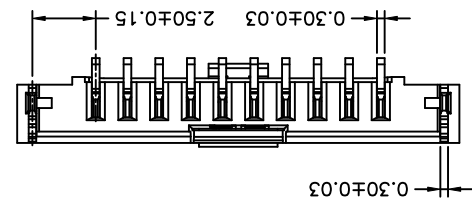
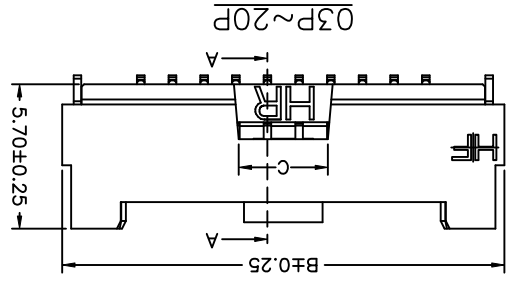
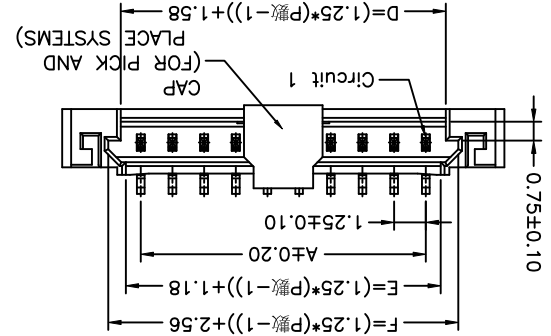
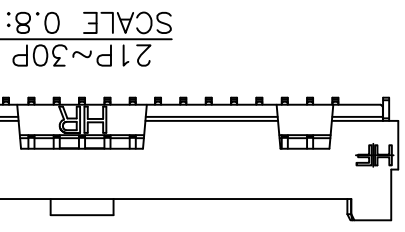
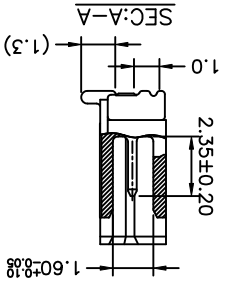
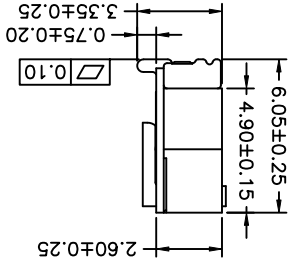
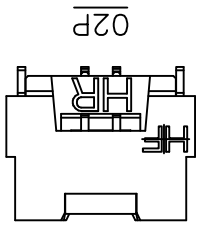
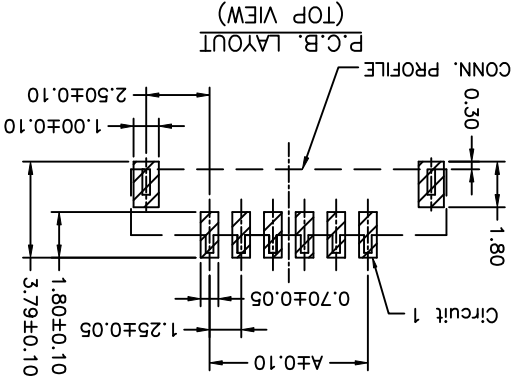
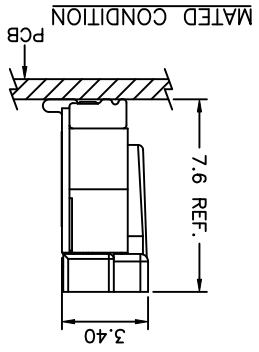
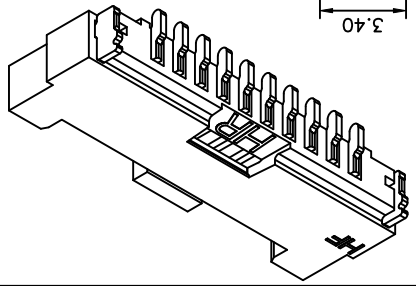

1 2 3 4

A B C D

X-ON Electronics

Largest Supplier of Electrical and Electronic Components

Click to view similar products for [Headers & Wire Housings](#) category:

Click to view products by [Joint Tech](#) manufacturer:

Other Similar products are found below :

[95000-104TRLF](#) [10135584-644402LF](#) [DF62W-EP2022PCA](#) [95000-106TRLF](#) [DF62W-2022SCA](#) [DF62W-EP2022PC](#) [2203348](#) [DF62W-2022SC](#) [1084018](#) [1029039](#) [1084017](#) [802-10-012-10-002000](#) [1112640](#) [1112639](#) [891-007-9SS-BST1T](#) [000-34000](#) [0008550134](#) [0009482033](#) [0009507031](#) [57102-F02-18ULF](#) [57102-S06-03LF](#) [57202-S52-04LF](#) [PCN6-15S-2.5E](#) [0039019024](#) [58102-G61-06LF](#) [582553-1](#) [0009485154](#) [0009508121](#) [0022285053](#) [0050291907](#) [018731A](#) [LY20-4P-DT1-P1E-BR](#) [02.125.8002.8](#) [60101931](#) [60598-1 \(Cut Strip\)](#) [M1625-3R/100](#) [61062-3](#) [61082-181009](#) [CSU011177004](#) [636-1427](#) [638009-1](#) [641938-9](#) [641991-4](#) [644168-1](#) [644827-2](#) [647662-1](#) [65039-019ELF](#) [65692-001LF](#) [65781-018](#) [65781-047](#)