

SPECIFICATIONS
 Current Rating: 2A AC,DC
 Voltage Rating: 250V AC,DC
 Temperature Range: -25°C ~ +85°C
 Contact Resistance: 30mΩ Max.
 Insulation Resistance: 1000MΩ Min.
 Withstanding Voltage: 800V AC/minute
 Pin Material: Brass/Tin-plated
 Material: Nylon 66,UL94V-0
 Color: Black

Ordering Information & Dimensions

PART NO.	Dimensions	
	A	B
A2211WV-2X02P	2.00	6.00
A2211WV-2X03P	4.00	8.00
A2211WV-2X04P	6.00	10.00
A2211WV-2X05P	8.00	12.00
A2211WV-2X06P	10.00	14.00
A2211WV-2X07P	12.00	16.00
A2211WV-2X08P	14.00	18.00
A2211WV-2X09P	16.00	20.00
A2211WV-2X10P	18.00	22.00
A2211WV-2X11P	20.00	24.00
A2211WV-2X12P	22.00	26.00
A2211WV-2X13P	24.00	28.00
A2211WV-2X14P	26.00	30.00
A2211WV-2X15P	28.00	32.00
A2211WV-2X16P	30.00	34.00
A2211WV-2X17P	32.00	36.00
A2211WV-2X18P	34.00	38.00
A2211WV-2X19P	36.00	40.00
A2211WV-2X20P	38.00	42.00

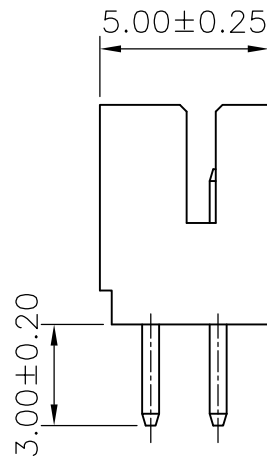
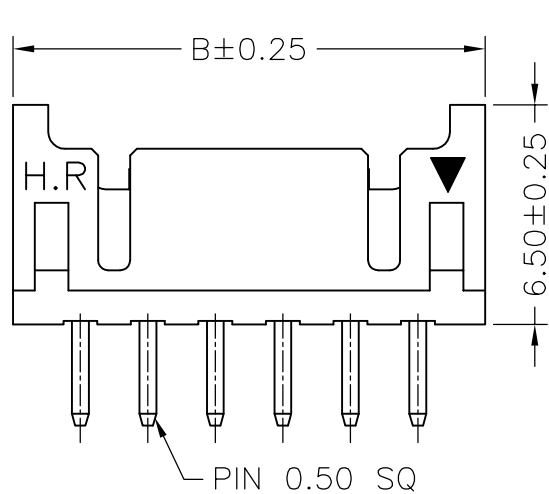
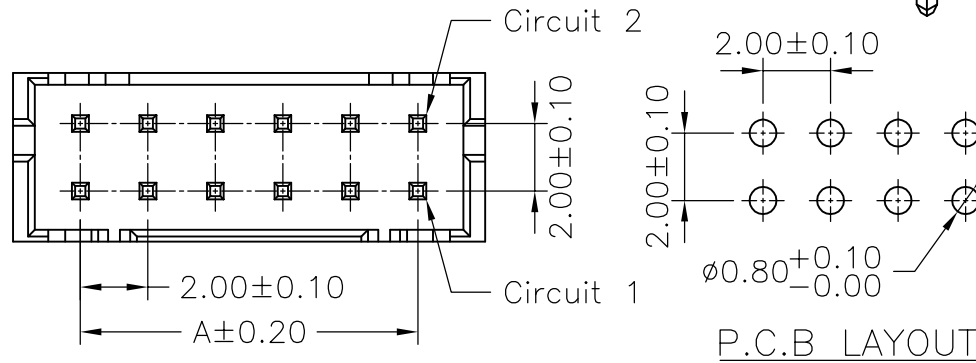

				JOINT TECH ELECTRONIC IND. CO., LTD. JOY DAY INDUSTRIAL CO., LTD.	
				UNIT	SCALE
		mm		1 of 1	2.00mm PITCH 180° WAFER
		DRAWN BY		APPROVED BY	
		董正一		董正一	
		2001.02.01		2001.02.01	
		GENERAL TOLERANCE			
B1	REVISE	2007.02.27	X. X±0.25	ANGLE±	
B0	NEW RELEASE	2005.12.05	X. XX±0.15		
REV.	DESCRIPTION	DATE	X. XXX±0.05		
DRAW NO.:					REV.
A2211WV-2XNP					B1

X-ON Electronics

Largest Supplier of Electrical and Electronic Components

Click to view similar products for [Headers & Wire Housings](#) category:

Click to view products by [Joint Tech](#) manufacturer:

Other Similar products are found below :

[57102-F02-18ULF](#) [58102-G61-06LF](#) [0009485154](#) [009176003701906](#) [0050291907](#) [02.125.8002.8](#) [609-3404](#) [61062-3](#) [622-0430](#) [622-3653LF](#)
[63453-116](#) [636-1030](#) [636-1427](#) [636-3427](#) [636-4007](#) [641938-9](#) [644827-2](#) [65495-038](#) [65692-001LF](#) [65781-018](#) [65781-047](#) [65817-010LF](#)
[65817-015LF](#) [66207-023LF](#) [67016-026LF](#) [67095-007LF](#) [68631-112](#) [68645-018](#) [68648-049](#) [699319-000](#) [70.362.1628.0](#) [70-4210](#) [70-4226B](#)
[70-4853B](#) [707-5020](#) [707-5028](#) [71.350.2428.0](#) [71961-016LF](#) [733-134](#) [754199-000](#) [760-3052](#) [787-8014-00](#) [FCN-367T-T012/H](#) [80.063.4001.1](#)
[800-90-001-10-001000](#) [800-90-010-10-002000](#) [801-43-002-10-013000](#) [801-43-006-10-002000](#) [803-41-018-10-001000](#) [803-43-014-20-](#)
[001000](#)