

Solderless splices

BUTT

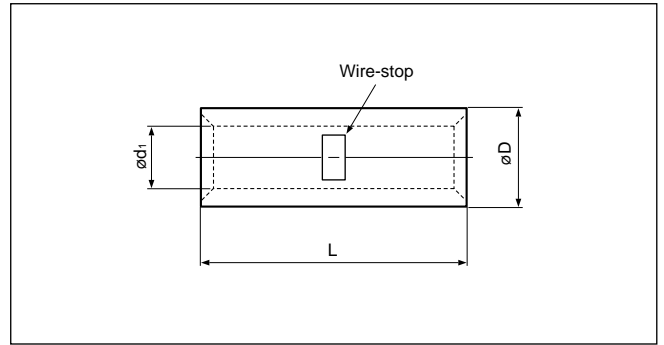

Non-insulated

Certificate No.: E42024 LR20812

Applicable Wire AWG# (mm ²)	Part No.	Standard	Dimensions mm (in.)			Tool No.												Qty/box							
			L	ø D	ø d ₁	YHT-2210	YHT-8S	YA-1	YA-2	YA-4	YA-5	YPT-60N	YPT-150-1	BCT-0514L	BCT-860L	BCT-8150L	E-4 YF-1 EP-1		YET-60-1	YET-150-1	YET-300-1	E-4 YF-1 YET-300N			
22 to 16 (0.25 to 1.65)	C-1.25		15.0 (.591)	3.3 (.130)	1.7 (.067)	0	0	0	0															1,000	
16 to 14 (1.04 to 2.63)	C-2		15.0 (.591)	4.1 (.161)	2.3 (.091)	0	0	0	0																
12 to 10 (2.63 to 6.64)	C-5.5		15.0 (.591)	5.4 (.213)	3.4 (.134)	0	0	0	0																
8 (6.64 to 10.52)	C-8		21.0 (.827)	7.0 (.276)	4.5 (.177)	0				0	0	0	0	0	0	0	0	0	0	0	0	0	0	0	500
6 (10.52 to 16.78)	C-14		26.0(1.024)	8.9 (.350)	5.8 (.228)																				200
4 (16.78 to 26.66)	C-22		29.0(1.142)	11.3 (.445)	7.7 (.303)																				100
2 (26.66 to 42.42)	C-38		32.0(1.260)	13.2 (.520)	9.4 (.370)																				
1/0 (42.42 to 60.57)	C-60		36.0(1.417)	15.3 (.602)	11.4 (.449)																				50
2/0 (60.57 to 76.28)	C-70		37.0(1.457)	17.5 (.689)	13.3 (.524)																				
3/0 (76.28 to 96.3)	C-80		38.0(1.496)	19.5 (.768)	14.5 (.571)																				
4/0 (96.3 to 117.2)	C-100		38.0(1.496)	22.1 (.870)	16.4 (.646)																				25
250 to 300MCM (117.2 to 152.05)	C-150		54.0(2.126)	26.4(1.039)	19.5 (.768)																				
350MCM (152.05 to 192.6)	C-180		57.0(2.244)	28.5(1.122)	21.0 (.827)																	0	0		20
400MCM (192.6 to 242.27)	C-200		63.0(2.480)	32.4(1.276)	24.0 (.945)																	0	0		
N.A. (250)	C-250		63.0(2.480)	35.0(1.378)	26.0(1.024)																		0		10
600 to 650MCM (242.27 to 325)	C-325			72.0(2.835)	37.0(1.457)	28.0(1.102)																0	0		

Note:1) Delivery lead times may vary depending on the product. Contact JST for details.

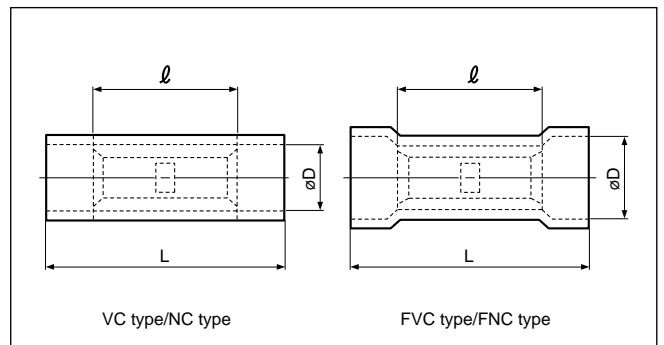
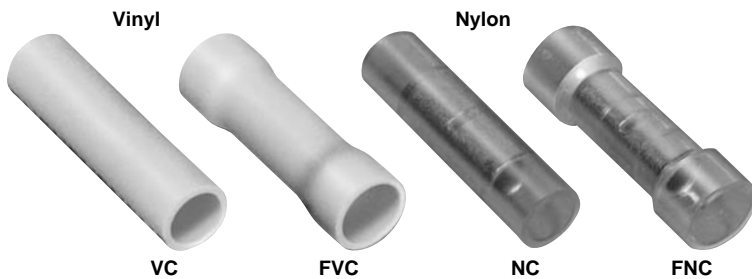

Vinyl or Nylon insulated

Certificate No.: E42024 LR20812

Applicable Wire AWG# (mm ²)	Part No.		Standard	Dimensions mm (in.)			Color	Tool No.							Qty/box											
	Vinyl	Nylon		L	ℓ	øD		YNT-2216	YNT-1614	YNT-1210S	YA-1	YA-2	YA-4	BCT-0514L	Vinyl	Nylon										
22 to 16 *(0.25 to 1.65)	VC-1.25	NC-1.25		22.7 (.894)	15.0 (.591)	3.2 (.126)	0																			
	FVC-1.25	FNC-1.25				4.0 (.157)																			1,000	500
16 to 14 (1.04 to 2.63)	VC-2	NC-2		22.7 (.894)	15.0 (.591)	3.9 (.154)	0																			
	FVC-2	FNC-2				4.5 (.177)																				1,000
12 to 10 (2.63 to 6.64)	VC-5.5	NC-5.5		26.7(1.051)	15.0 (.591)	5.4 (.213)	0																			
	FVC-5.5	FNC-5.5				6.8 (.268)																				500

Note:1) *The crimping will be more secure if the total cross-sectional area of the wire is at least 0.5 mm².
 Examples: If the cross-sectional area of the wire is 0.3 mm², fold the wire in two when crimping the terminal.
 If the cross-sectional area of the wire is 0.5 mm², crimp the terminal onto the wire as it is.
 2) Delivery lead times may vary depending on the product. Contact JST for details.

Solderless splices

BUTT

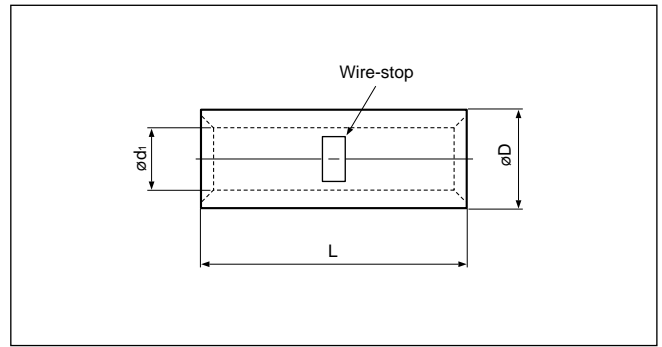
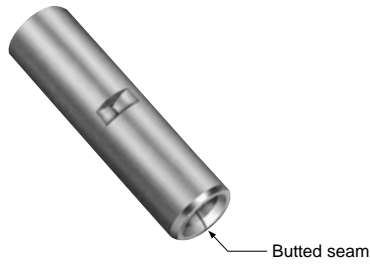

Non-insulated

Certificate No.: E42024 LR20812

Applicable Wire AWG#(mm ²)	Part No.	Standard	Dimensions mm (in.)			Tool No.					Qty/box	
			L	ø D	ø d ₁	YHT-2210	YA-1	YA-2	YA-4	BCT-0514L		
22 to 16 (0.25 to 1.65)	WSC-1.25		15.0 (.591)	3.3 (.130)	1.7 (.067)	0	0	0	0	0	1,000	
16 to 14 (1.04 to 2.63)	WSC-2		15.0 (.591)	4.0 (.157)	2.3 (.091)	0	0	0	0	0		
12 to 10 (2.63 to 6.64)	WSC-5.5		15.0 (.591)	5.5 (.217)	3.4 (.134)	0	0	0	0	0		

Note:1) These products have a butted seam.

2) Delivery lead times may vary depending on the product. Contact JST for details.

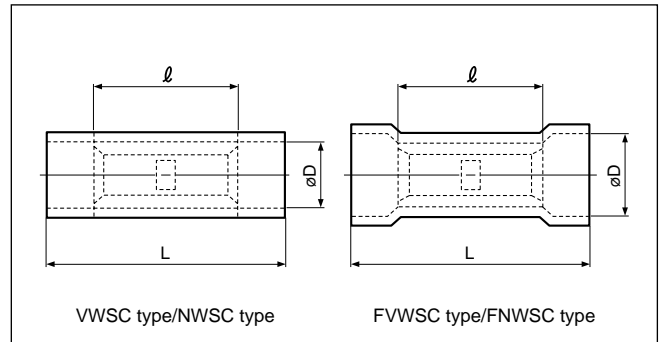
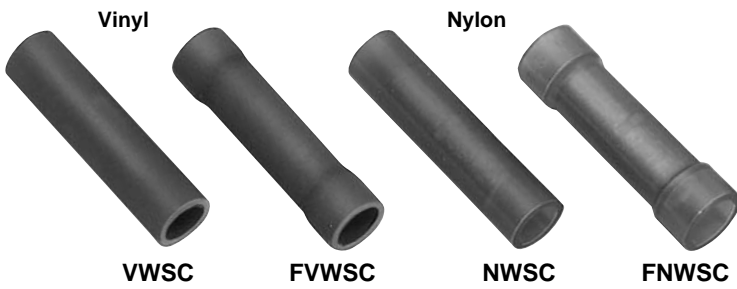

Vinyl or Nylon insulated

Certificate No.: E42024 LR20812

Applicable Wire AWG#(mm ²)	Part No.		Standard	Dimensions mm (in.)			Color	Tool No.					Qty/box		
	Vinyl	Nylon		L	l	ø D		YNT-2216	YNT-1614	YNT-1210S	YA-1	YA-2	YA-4	BCT-0514L	Vinyl
22 to 16 *(0.25 to 1.65)	VWSC-1.25	NWSC-1.25		22.7 (.894)	15.0 (.591)	3.2 (.126)	0			0	0	0	0	1,000	500
	FVWSC-1.25	FNWSC-1.25				4.0 (.157)									
16 to 14 (1.04 to 2.63)	VWSC-2	NWSC-2		22.7 (.894)	15.0 (.591)	3.9 (.154)	0		0	0	0	0	1,000	500	
	FVWSC-2	FNWSC-2				4.5 (.177)									500
12 to 10 (2.63 to 6.64)	VWSC-5.5	NWSC-5.5		26.7(1.051)	15.0 (.591)	5.4 (.213)	0		0		0	0	500	500	
	FVWSC-5.5	FNWSC-5.5				6.8 (.268)									250

Note:1) These products have a butted seam.

2) *The crimping will be more secure if the total cross-sectional area of the wire is at least 0.5 mm².

Examples: If the cross-sectional area of the wire is 0.3 mm², fold the wire in two when crimping the terminal.

If the cross-sectional area of the wire is 0.5 mm², crimp the terminal onto the wire as it is.

3) Delivery lead times may vary depending on the product. Contact JST for details.

X-ON Electronics

Largest Supplier of Electrical and Electronic Components

Click to view similar products for [RF Connector Accessories](#) category:

Click to view products by [JST manufacturer](#):

Other Similar products are found below :

[89674-0712](#) [FERRULE-174](#) [R141802000](#) [R141842000](#) [R141862000W](#) [R280907000](#) [RFI75-3](#) [AX102907](#) [HP-500](#) [2098-3251-94](#) [KA-81-02](#)
[KA-81-05](#) [KN-89-12](#) [89674-0805](#) [FERRULE-223](#) [202102-11](#) [R280468000](#) [R280510000](#) [RFI155-1](#) [RFI25-12-D3](#) [RFI25-4-D2](#) [RFI75-12-D2](#)
[RFI97-14](#) [360HS001M2508M6](#) [4-1532137-4](#) [HRM-514S\(40\)](#) [5-21085-0](#) [111062-0490](#) [112122-SOD-LUG](#) [IPP-2014](#) [RFI95-14-D2](#) [MX-](#)
[913/U\(45\)](#) [1736-1511-075](#) [RFI75-2-D3](#) [RFI25-3-D3](#) [R280469010](#) [RFI85-4](#) [896110450](#) [660-024M09S5-01](#) [1403137-1](#) [360HB001M2512H](#)
[360HS001M1716M3](#) [380HS115M2508H3](#) [380HS001M1716M4](#) [FERRULE-316DB](#) [105274-2000](#) [73415-1970](#) [R280755050W](#) [52014041A](#)
[R447120000](#)