

环保要求 RoHS 2.0

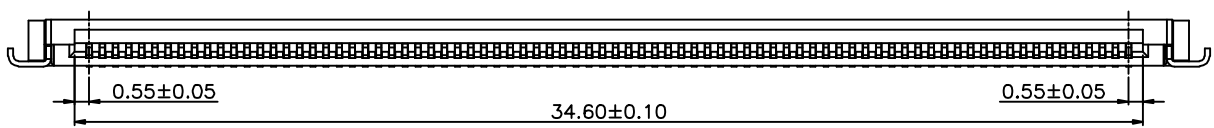

NOTES:
 1.MATERIAL:
 HOUSING:THERMOPLASTIC(UL94V-0) NATURE
 ACTUATOR:THERMOPLASTIC(UL94V-0) BLACK
 TERMINAL:PHOSPHOR BRONZE PLATED GOLD MIN 1u" FOR SOLDERING
 AREA AND CONNECT AREA, PLATED NI MIN 30u" FOR ALLOVER UNDER.
 FITTING NAIL:PHOSPHOR BRONZE MATTE TIN MIN 80u" PLATED FOR ALLOVER PLATED NI MIN 30u" FOR ALLOVER UNDER.
 2.SPECIFICATION
 CURRENT RATING: 0.5A 50VAC/DC
 CONTACT RESISTANCE: 30mΩ MAX
 INSULATION RESISTANCE: 100MΩ MIN AT 500V DC
 OPERATING TEMPERATURE RANGE: -25°C TO +85°C
 WITHSTANDING VOLTANG: 500V AC/minute

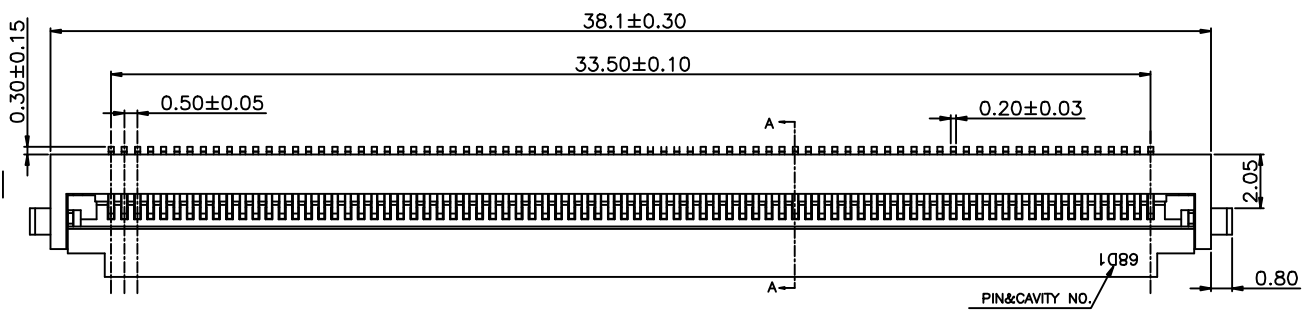
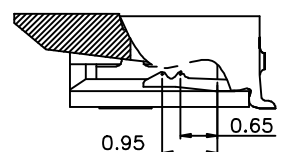
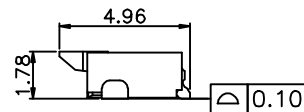

SECTION A-A
SCALE 2:1

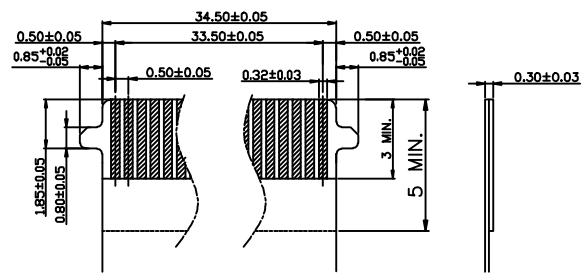

RECOMMENDED FFC DIM.
WITH LOCK

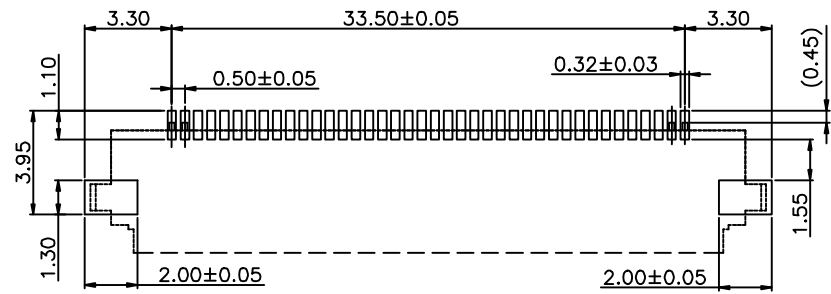

P.C.B LAYOUT REF
TOLERANCE:±0.05

深圳市钜硕电子有限公司 SHENZHEN JUSHUO ELECTRONIC CO.,LTD				产品料号: AFC18-S68FIA-00			
UNLESS OTHERWISE SPECIFIED		APPROVED BY		DATE		TITLE	
TOLERANCES ARE		CHECKED BY		DATE		FPC CONN. 0.5P H1.8	
XX ±0.30		DRAWN BY		DATE		FLIP TYPE 68Pin 成品图	
XXX ±0.20		DATE		DATE		DOCUMENT NO	
XXX ±0.10		DATE		DATE		DOCUMENT NO	
ANG ±1°		DATE		DATE		DOCUMENT NO	
UNIT	SIZE	DRAWING NO	REV	SHEET	SCALE		
MM	A4		A	1/1	1:1		
TION	CHK	DATE					

X-ON Electronics

Largest Supplier of Electrical and Electronic Components

Click to view similar products for [FFC & FPC Connectors](#) category:

Click to view products by [JUSHUO](#) manufacturer:

Other Similar products are found below :

[00-6200-227-022-800](#) [006205250500825+](#) [006205280500825+](#) [FPH-1602G](#) [FPH-2022G](#) [52610-1275](#) [501864-3091-TR225](#)
[086222026001800](#) [52610-0675](#) [62674-201121DLF](#) [62684-36210E9ALF](#) [52746-1671-TR250](#) [10051922-2810EHLF](#) [686322124422](#) [XF3M-](#)
[2915-1B-R100](#) [AYF353125A](#) [AYF530665TA](#) [AYF534065TA](#) [AYF351525](#) [086212040340800+](#) [AYF530365TA](#) [67000-004LF](#)
[006207341915000+](#) [207356-1](#) [67000-003LF](#) [HFW14R-2STE9LF](#) [SFW12R-5STE9LF](#) [SFW18R-1STAE9LF](#) [SFW4R-5STE9LF](#) [52807-0430](#)
[046283021002868+](#) [502250-8027](#) [104267-9617](#) [66987-011LF](#) [HFW8S-2STAE1HLF](#) [67000-008LF](#) [HFW22R-2STE1H1LF](#) [0781271110](#)
[5019511030](#) [200528-0260](#) [5039084120](#) [503908-5120](#) [SFW20R-1STGE5LF](#) [FH12-18S-0.5SH](#) [686116183522](#) [FH64MA-11S-0.25SHW](#)
[686114183522](#) [502078-5362](#) [FH52K-68S-0.5SH](#) [FH26W-23S-0.3SHW\(60\)](#)