

ABIDE BY ROHS

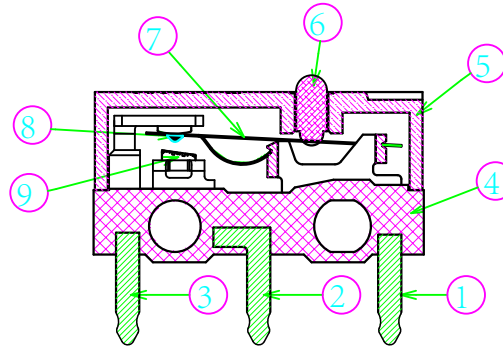

■ Specification :

- 1. Rating : DC30V 0.1A ; Circuit: COM-NO
- 2. Contact Resistance : 100mΩ Max
- 3. Insulation Resistance : 100MΩ Min(DC250V)
- 4. Withstand Voltage : AC500V(50-60Hz) for 1 minute
- 5. Operation Force : 65±15 gf
- 6. Releasing Force : 20gf (Min)
- 7. Operating Position : 6.90±0.2 mm
- 8. Mechanical Life : 30,000,000 Cycles(min)

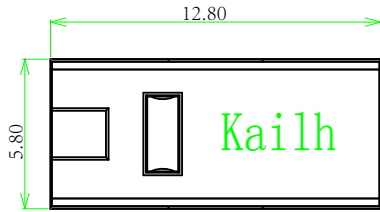
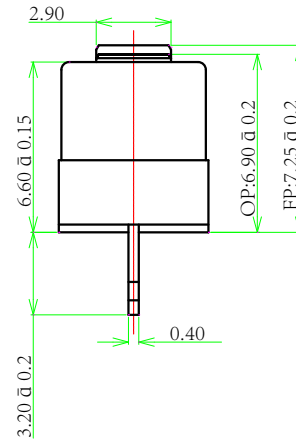
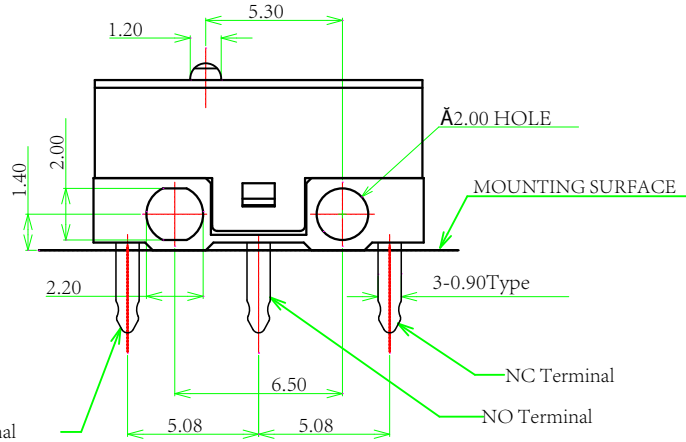

Com Terminal

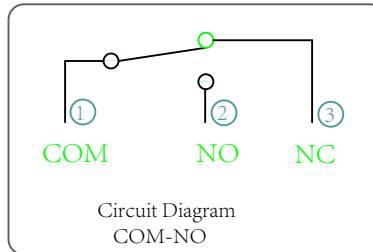
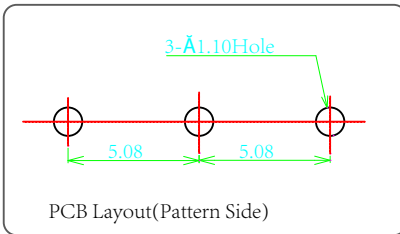

ITEM	PART NAME	TER.NO.	QTY.	MATERIAL	FINISHING	REMARK
⑨	Contact	1	1	Silver Alloy	Natural	
⑧	Contact	1	1	Composite gold	Natural	
⑦	Shrapnel	1	1	Copper Alloy	Natural	
⑥	Keystoke	1	1	POM	Blue	
⑤	Cover	1	1	PBT	Black	
④	Base	1	1	PBT	Black	
③	Nc Terminal	3	1	BRASS	Ag-Plated	
②	No Terminal	2	1	BRASS	Ag-Plated	
①	Com Terminal	1	1	BRASS	Ag-Plated	

APPROVALS		DATE	东莞市凯华电子有限公司 DONGGUAN CITY KAIHUA ELECTRONICS CO.,LTD			
DRAWN	Jerry.Ye	2015.04.25	TITLE:		30M Micro Switch	
CHECKED			Customer No.			
APPROVALS			PART NO.		CMI126603D09	
TOLERANCES ARE		30 -A- ±0.30 10 -A- ±0.20 5 -A- ±0.15 4 -A- ±0.10	ANGLE	UNIT: mm	SCALE: 1:1	PROJ :
			DRAWING NO.	KHA-MI1266-004EN	SHEET 1 OF 1	

ECN NO.	REV.	DATE.	DESCRIPTION.	CHANGE.	CHECK.	APPRO.
	B	2016.04.25	UPDATED SWITCH STRUCTURE		L.Zhang	
	A	2015.09.02	NEW		L.Zhang	

X-ON Electronics

Largest Supplier of Electrical and Electronic Components

Click to view similar products for [Basic / Snap Action Switches](#) category:

Click to view products by [Kailh](#) manufacturer:

Other Similar products are found below :

[5SM901-S12](#) [5SM9-S12N195](#) [602EN532](#) [602EN535-RB](#) [604HE162](#) [604HE223-6B](#) [624HE17-RB](#) [6HM82](#) [6HM89](#) [6SE1](#) [6SX1-H58](#)
[70500216](#) [70599106](#) [71051](#) [MBH2731](#) [79211923](#) [79218589](#) [7AS12](#) [MIL30126AB6BBMD4A12XAU](#) [ML-1155](#) [ML-1376](#) [831010C3.0](#)
[831090C2.EL](#) [83131904](#) [84212012](#) [8AS239](#) [8HM73-3](#) [8SX26-H33](#) [914CE1-6G](#) [PL-100](#) [11SM1077-H4](#) [11SM1077-H58](#) [11SM1-TN107](#)
[11SM405](#) [11SM8423-H2](#) [11SX37-T](#) [11SX48-H58](#) [11SM2442-T](#) [11SM76-T](#) [11SM77-H58](#) [11SM863-T](#) [11SM866](#) [A7CN-1M-1-LEFT](#)
[A831700C7.0](#) [121EN188-R](#) [1245.0120](#) [125EN56-RB](#) [1267.0101](#) [1267.7101](#) [D459-PBAA](#)