

KY2302S

20V N-Channel Mosfet

FEATURES

- $R_{DS(ON)} \leq 80m\Omega$ (53m Ω Typ.)
@ $V_{GS}=4.5V$
- $R_{DS(ON)} \leq 115m\Omega$ (72m Ω Typ.)
@ $V_{GS}=2.5V$

APPLICATIONS

- Load Switch for Portable Devices
- DC/DC Converter

MARKING

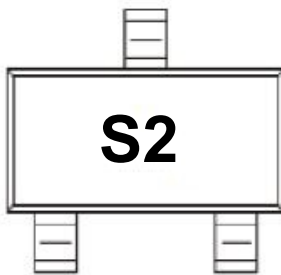

Other Marking: "A2SHB"

SOT-23

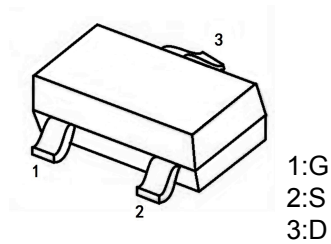

N-CHANNEL MOSFET

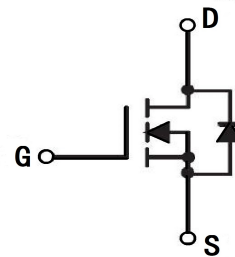

Maximum ratings (Ta=25°C unless otherwise noted)

Parameter	Symbol	Value	Unit
Drain-Source Voltage	V_{DS}	20	V
Gate-Source Voltage	V_{GS}	± 10	
Continuous Drain Current	I_D	2	A
Pulsed Drain Current	I_{DM}	8	
Maximum Power Dissipation	P_D	0.4	W
Thermal Resistance from Junction to Ambient($t \leq 5s$)	$R_{\theta JA}$	312	$^{\circ}C/W$
Junction Temperature	T_J	150	$^{\circ}C$
Storage Temperature	T_{stg}	-55 ~ +150	

KY2302S

MOSFET ELECTRICAL CHARACTERISTICS $T_a=25\text{ }^\circ\text{C}$ unless otherwise specified

Symbol	Parameter	Test Condition	Min.	Typ.	Max.	Unit
Off Characteristics						
$V_{(BR)DSS}$	Drain-source breakdown voltage	$V_{GS} = 0V, I_D = 250\mu A$	20	-	-	V
I_{DSS}	Zero gate voltage drain current	$V_{DS} = 20V, V_{GS} = 0V$	-	-	1	μA
I_{GSS}	Gate-body leakage current	$V_{GS} = \pm 10V, V_{DS} = 0V$	-	-	± 100	nA
On Characteristics						
$V_{GS(th)}$	Gate threshold voltage	$V_{DS} = V_{GS}, I_D = 250\mu A$	0.5	0.7	1.2	V
$R_{DS(on)}$	Drain-source on-resistance ^{note1}	$V_{GS} = 4.5V, I_D = 2A$	-	53	80	m Ω
		$V_{GS} = 2.5V, I_D = 2A$	-	72	115	
Dynamic characteristics ^{note2}						
C_{iss}	Input Capacitance	$V_{DS} = 10V, V_{GS} = 0V, f = 1MHz$	-	300	-	pF
C_{oss}	Output Capacitance					
C_{rss}	Reverse Transfer Capacitance					
Q_g	Total gate charge	$V_{DS} = 10V, V_{GS} = 4.5V, I_D = 3.6A$	-	4	10	nC
Q_{gs}	Gate-source charge					
Q_{gd}	Gate-drain charge					
Switching Characteristics ^{note2}						
$t_{d(on)}$	Turn-on delay time	$V_{DD} = 10V,$ $R_L = 5.5\Omega, I_D = 3.6A,$ $V_{GEN} = 4.5V, R_g = 6\Omega$	-	7	15	nS
t_r	Rise time					
$t_{d(off)}$	Turn-off delay time					
t_f	Fall time					
Source-Drain Diode characteristics						
V_{SD}	Diode Forward voltage	$V_{GS} = 0V, I_S = 1A$	-	0.7	1.2	V

Notes :

1. Pulse Test : Pulse Width < 300 μs , Duty Cycle $\leq 2\%$.
2. Guaranteed by design, not subject to production testing.

TYPICAL PERFORMANCE CHARACTERISTICS

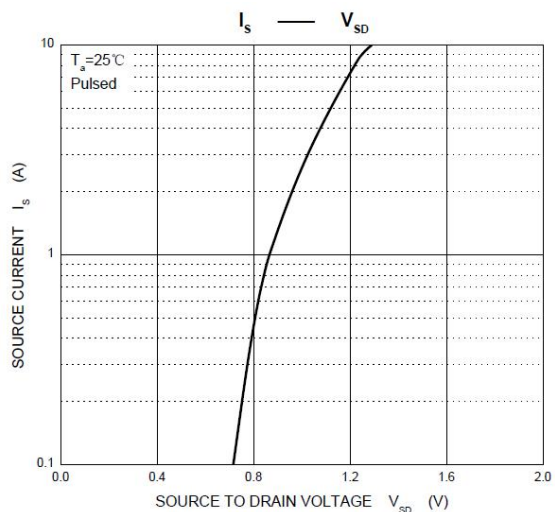
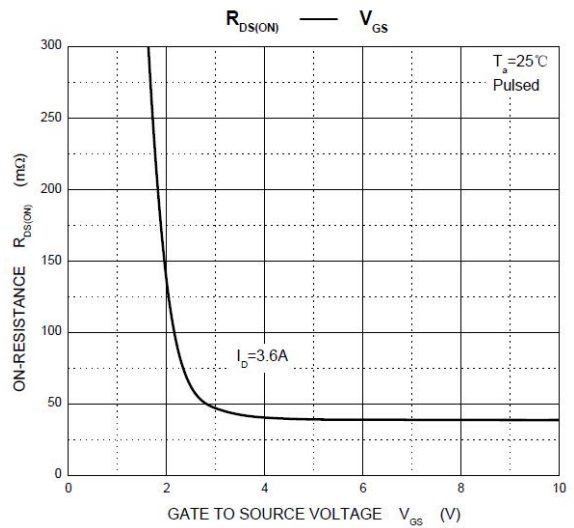
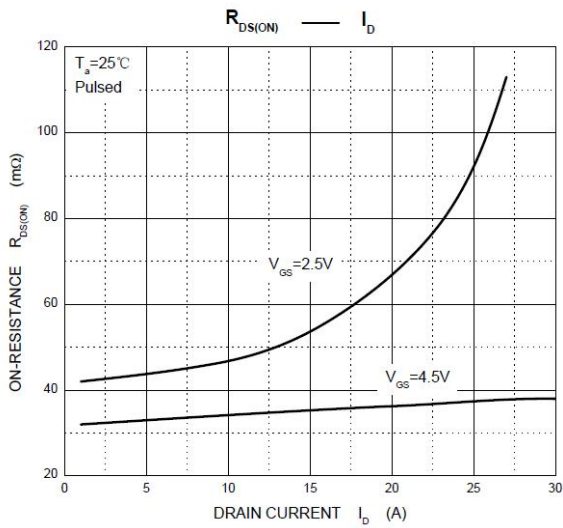
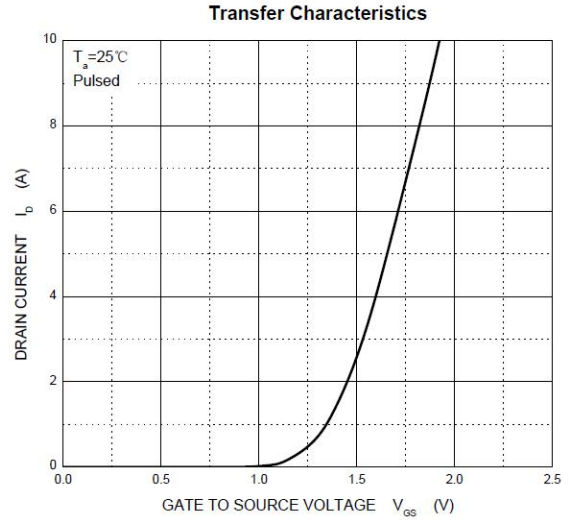
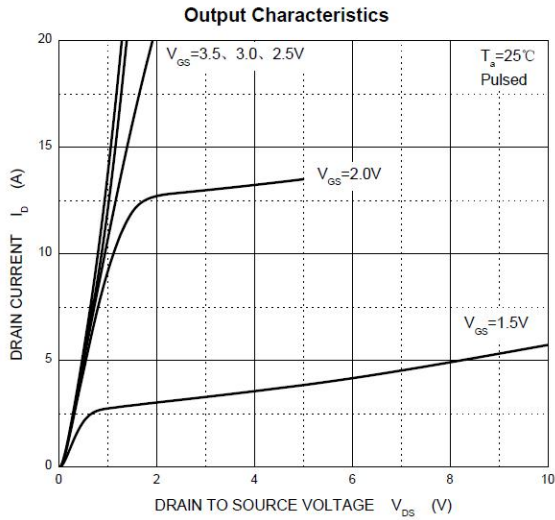

KY2302S

SOT-23 PACKAGE OUTLINE DRAWING

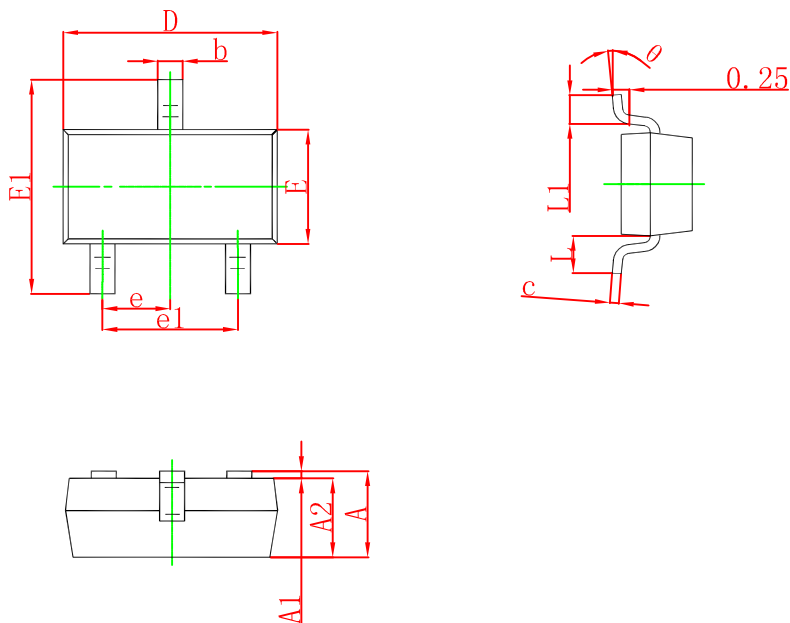

Symbol	Dimensions In Millimeters		Dimensions In Inches	
	Min	Max	Min	Max
A	0.900	1.150	0.035	0.045
A1	0.000	0.100	0.000	0.004
A2	0.900	1.050	0.035	0.041
b	0.300	0.500	0.012	0.020
c	0.080	0.150	0.003	0.006
D	2.800	3.000	0.110	0.118
E	1.200	1.400	0.047	0.055
E1	2.250	2.550	0.089	0.100
e	0.950 TYP		0.037 TYP	
e1	1.800	2.000	0.071	0.079
L	0.550 REF		0.022 REF	
L1	0.300	0.500	0.012	0.020
θ	0°	8°	0°	8°

SOT-23 Tape and reel

SOT-23 Embossed Carrier Tape

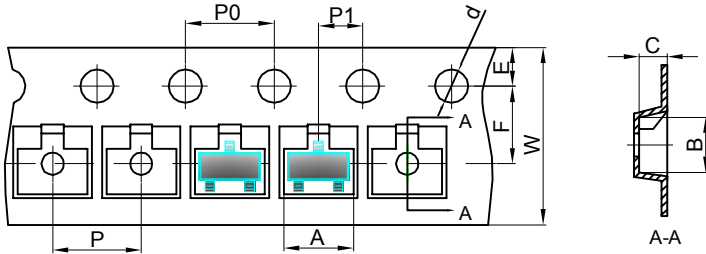

Dimensions are in millimeter										
Pkg type	A	B	C	d	E	F	P0	P	P1	W
SOT-23	3.15	2.77	1.22	Ø1.50	1.75	3.50	4.00	4.00	2.00	8.00

SOT-23 Tape Leader and Trailer

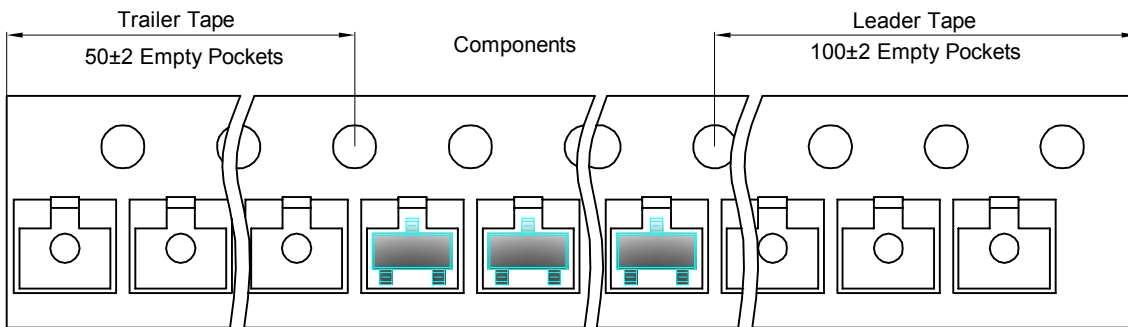

SOT-23 Reel

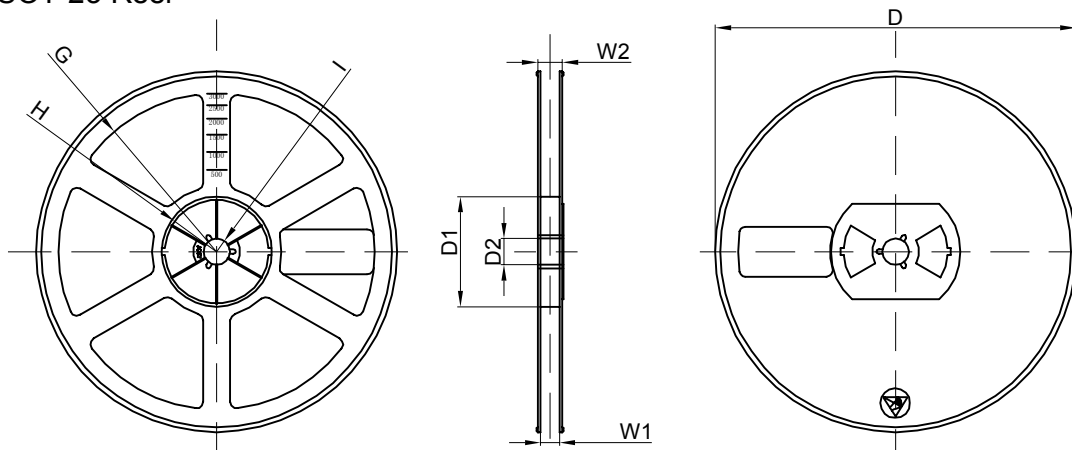

Dimensions are in millimeter								
Reel Option	D	D1	D2	G	H	I	W1	W2
7" Dia	Ø178.00	54.40	13.00	R78.00	R25.60	R6.50	9.50	12.30

REEL	Reel Size	Box	Box Size(mm)	Carton	Carton Size(mm)	G.W.(kg)
3000 pcs	7 inch	30,000 pcs	203×203×195	120,000 pcs	438×438×220	

X-ON Electronics

Largest Supplier of Electrical and Electronic Components

Click to view similar products for [MOSFET](#) category:

Click to view products by [Kang Yang](#) manufacturer:

Other Similar products are found below :

[614233C](#) [648584F](#) [MCH3443-TL-E](#) [MCH6422-TL-E](#) [NTNS3A92PZT5G](#) [IRFD120](#) [IRFF430](#) [JANTX2N5237](#) [2N7000](#) [AOD464](#)
[2SK2267\(Q\)](#) [2SK2545\(Q,T\)](#) [405094E](#) [423220D](#) [MIC4420CM-TR](#) [VN1206L](#) [614234A](#) [715780A](#) [SSM6J414TU,LF\(T](#) [751625C](#)
[IPS70R2K0CEAKMA1](#) [BSF024N03LT3 G](#) [PSMN4R2-30MLD](#) [TK31J60W5,S1VQ\(O](#) [2SK2614\(TE16L1,Q\)](#) [DMN1017UCP3-7](#)
[EFC2J004NUZTDG](#) [FCAB21350L1](#) [P85W28HP2F-7071](#) [DMN1053UCP4-7](#) [NTE2384](#) [NTE2969](#) [NTE6400A](#) [DMC2700UDMQ-7](#)
[DMN2080UCB4-7](#) [DMN61D9UWQ-13](#) [US6M2GTR](#) [DMN31D5UDJ-7](#) [SSM6P54TU,LF](#) [DMP22D4UFO-7B](#) [IPS60R3K4CEAKMA1](#)
[DMN1006UCA6-7](#) [DMN16M9UCA6-7](#) [STF5N65M6](#) [IRF40H233XTMA1](#) [IPSA70R950CEAKMA1](#) [IPSA70R2K0CEAKMA1](#) [STU5N65M6](#)
[C3M0021120D](#) [DMN6022SSD-13](#)