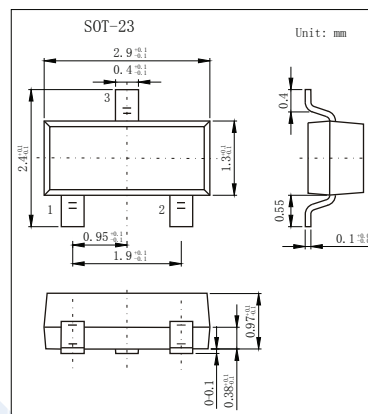
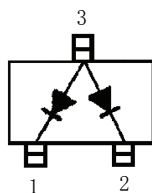

Switching Diodes

1SS181

■ Features

- Low forward voltage. : $V_F(3)=0.92V(\text{Typ.})$
- Fast reverse recovery time : $t_{rr}=1.6ns(\text{Typ.})$
- Small total capacitance : $C_T=2.2pF(\text{Typ.})$

■ Absolute Maximum Ratings $T_a = 25^\circ\text{C}$

Parameter	Symbol	Rating	Unit
Peak reverse voltage	V_{RM}	85	V
Reverse voltage	V_R	80	V
Average forward current	I_o	100	mA
Peak forward current	I_{FM}	300	mA
Surge current (10ms)	I_{FSM}	2	A
Power dissipation	P	150	mW
Junction temperature	T_j	125	$^\circ\text{C}$
Storage temperature	T_{stg}	-55 to +125	$^\circ\text{C}$

■ Electrical Characteristics $T_a = 25^\circ\text{C}$

Parameter	Symbol	Test Conditions	Min	Typ	Max	Unit
Reverse breakdown voltage	V_R	$I_R=100\ \mu\text{A}$	80			V
Forward voltage	V_{F1}	$I_F=1\ \text{mA}$		0.61		
	V_{F2}	$I_F=10\ \text{mA}$		0.74		
	V_{F3}	$I_F=100\ \text{mA}$		0.92	1.2	
Reverse voltage leakage current	I_{R1}	$V_R=30\ \text{V}$			0.1	uA
	I_{R2}	$V_R=80\ \text{V}$			0.5	
Capacitance between terminals	C_T	$V_R=0\ \text{V}, f=1\ \text{MHz}$		2.2	4	pF
Reverse recovery time	t_{rr}	$I_F=10\ \text{mA}$		1.6	4	ns

■ Marking

Marking	A3
---------	----

1SS181

Typical Characteristics

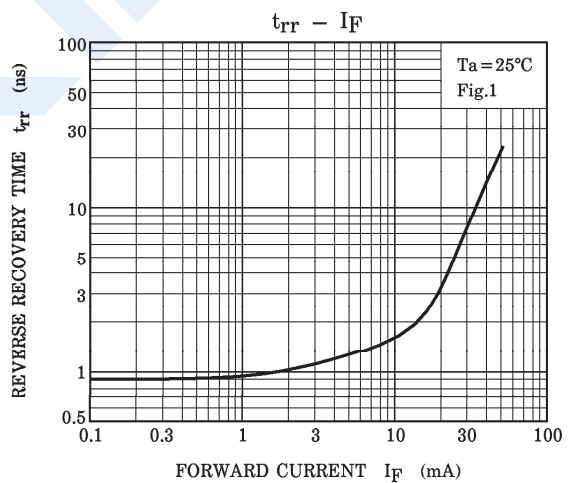
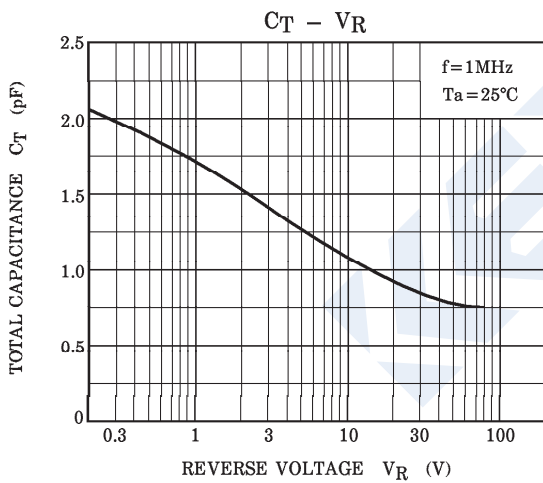
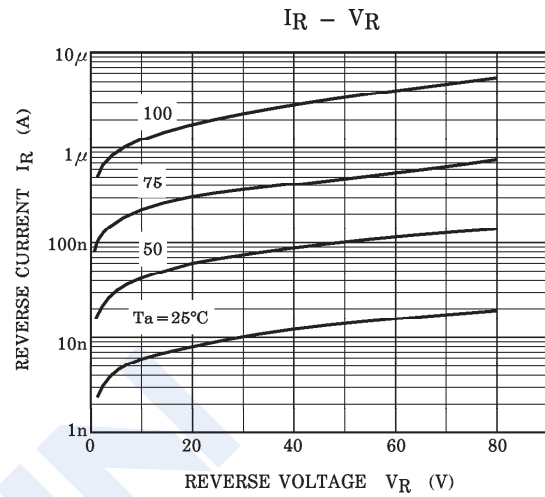
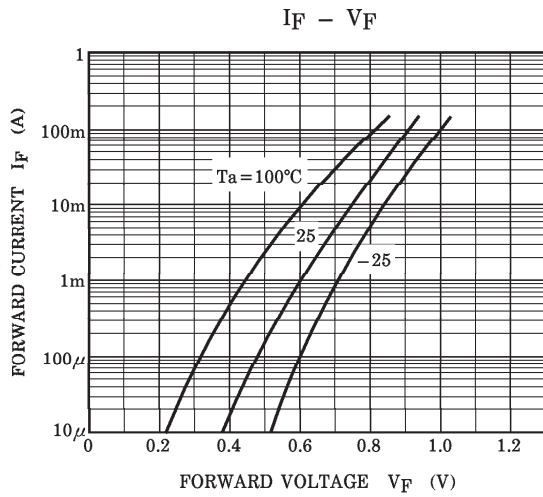

X-ON Electronics

Largest Supplier of Electrical and Electronic Components

Click to view similar products for [Diodes - General Purpose, Power, Switching category](#):

Click to view products by [KEXIN manufacturer](#):

Other Similar products are found below :

[053684A](#) [057245E](#) [10A06-TP](#) [10A10](#) [10A10](#) [10A10](#) [10A10G](#) [10A2](#) [10A4](#) [150K20A](#) [150K60A](#) [150K80A](#) [150KR80A](#) [1A1](#) [1A2](#) [1A3](#) [1A4](#)
[1A4](#) [1A5](#) [1A6](#) [1A7](#) [1A7](#) [1A7](#) [1A7](#) [1A7A](#) [1G7](#) [1N3064TR](#) [1N3070](#) [1N3070TR](#) [1N3295A](#) [1N3295AR](#) [1N3296A](#) [1N3493R-SGS](#) [1N3595](#)
[1N3595TR](#) [1N3595US](#) [1N3600](#) [1N3600 TR](#) [1N4001](#) [1N4001](#) [1N4001](#) [1N4001](#) [1N4001](#) [1N4001](#) [1N4001](#) [1N4001](#) [1N4001A](#) [1N4001G](#) [1N4001G](#)
[1N4001-T](#) [1N4001W](#)