

THIS DOCUMENT IS THE PROPERTY OF KEYSTONE ELECTRONICS CORP. AND SHALL NOT BE REPRODUCED, DISTRIBUTED OR USED AS A BASIS FOR MANUFACTURE WITHOUT PRIOR WRITTEN PERMISSION FROM KEYSTONE ELECTRONICS CORP.

ACTUAL SIZE

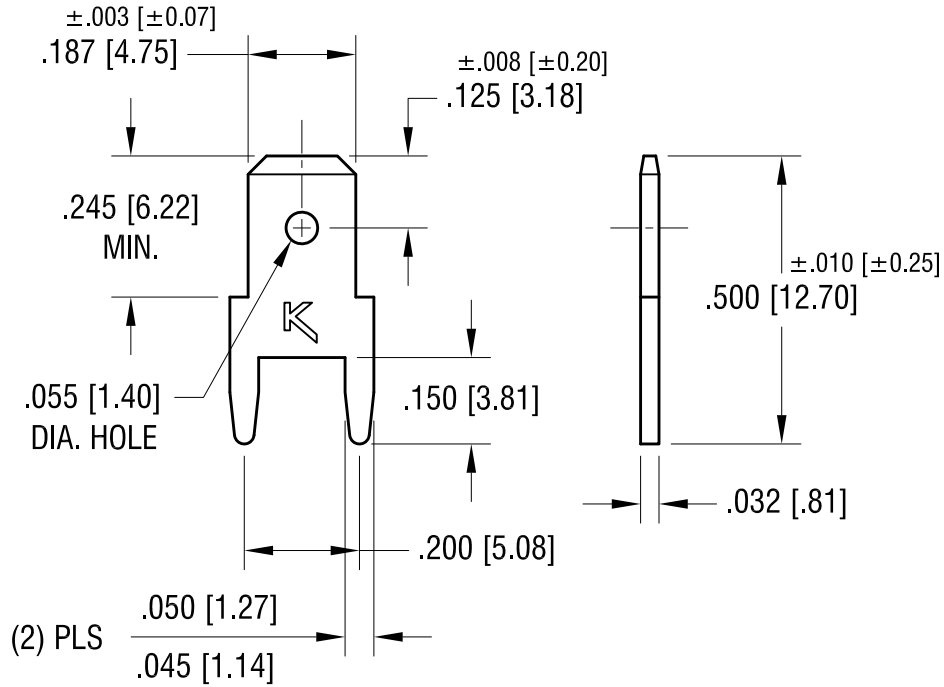
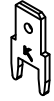

NOTE:

MOUNTING HOLE SIZE:  
 $.052$  [ $1.32$ ] DIA.

|          |                          |      |
|----------|--------------------------|------|
| 8.21.12  | CHANGE AS PER ECN 12-109 | C    |
| 6.16.09  | CHANGE AS PER ECN 09-071 | B    |
| 12.10.01 | CHANGE AS PER ECN 01-103 | A    |
| DATE     | DESCRIPTION              | REV. |

|   |                           |                              |             |
|---|---------------------------|------------------------------|-------------|
| <b>KEYSTONE ELECTRONICS CORP.</b>                               |                           |                              |             |
| www.keyelco.com • ASTORIA, N.Y. 11105-2017 • Tel (718) 956-8900 |                           |                              |             |
| PART NAME   |                           | PC QUICK-FIT TERMINAL        |             |
| MATERIAL  |                           | $.032$ [ $0.81$ ] TH'K BRASS |             |
| FINISH  |                           | DRN BY                       | DATE        |
| MATTE TIN PLATE   |                           | BOONE                        | 6.22.94     |
|   |                           | APP'D                        | SCALE       |
|   |                           |                              | 3X          |
| TOLERANCES  | INCH [MM]                 | CODE                         | DWG NO.     |
| DECIMAL   | $\pm .005$ [ $\pm 0.15$ ] | C                            | <b>1212</b> |
| ANGULAR   | $\pm 1^\circ$             |                              |             |
| UNLESS OTHERWISE SPECIFIED                                      |                           |                              |             |

## X-ON Electronics

Largest Supplier of Electrical and Electronic Components

*Click to view similar products for [Terminals](#) category:*

*Click to view products by [Keystone](#) manufacturer:*

Other Similar products are found below :

[00-054007-01074-6](#) [00-054007-70206-1](#) [00-054007-70210-8](#) [00-054007-70217-7](#) [00-054007-70226-9](#) [00-054007-70228-3](#) [00-054007-70248-1](#) [00-054007-70256-6](#) [00-054007-70301-3](#) [00-054007-70316-7](#) [00-054007-49560-4](#) [00-054007-70209-2](#) [00-054007-70225-2](#) [00-054007-70227-6](#) [00-054007-70231-3](#) [00-054007-70241-2](#) [00-054007-70242-9](#) [00-054007-70244-3](#) [00-054007-70246-7](#) [00-054007-70263-4](#) [00-054007-70288-7](#) [00-054007-70290-0](#) [00-054007-70300-6](#) [00-054007-70304-4](#) [01-2065-1-0216](#) [01-2900-1-04412](#) [00581P0075](#) [600TS-10](#) [60205-1](#) [604200-1](#) [605601-1](#) [60598-1-CUT-TAPE](#) [61314-6-C](#) [61810-3](#) [61-S](#) [62149-1](#) [626-0194](#) [62-NBM-A](#) [62-SN](#) [62-SP](#) [640179-1](#) [M55155/059I03](#) [M55155/079C01](#) [M55155/099H02](#) [M55155/109H01](#) [M55155/109H02](#) [M55155/12XH05](#) [M55155/16XH02](#) [M55155/29-5S](#) [M55155/29XJ08](#)