

# MICRO PINS



- Precision engineered and manufactured
- Space saving design for high density packaging
- Micro pins are available in .017 (.43) to .080 (2.03) diameters
- Ideal for mating with our standard line of micro jacks
- Available for press-fit, swage or solder mounting
- Custom micro pins manufactured to your specifications
- Other platings available upon request

### SPECIFICATIONS

**Material:** Brass, ASTM-B16  
**Plating:**  
**Gold:** .000010 per MIL-G-45204, Type II  
**Tin:** .000200 to .000300 per MIL-T-10727, Type 1  
**RoHS** (RoHS Compliant)

### DASH NUMBERS (L Dimension)

-1 for .032 (.81) thick Board  
 -2 for .062 (1.57) thick Board  
 -3 for .093 (2.36) thick Board  
 -4 for .125 (3.2) thick Board  
**Example:** 1967-1 for .032 (.81) thick Board  
 1967-2 for .062 (1.57) thick Board

### .017 (.43) PIN - SWAGE MOUNT

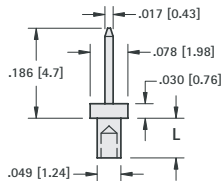

GOLD CAT. NO.	TIN CAT. NO.	L Length	Mtg. Hole Dia.
1967-1	1968-1	.051 (1.3)	.052
1967-2	1968-2	.082 (2.0)	(1.32)

### .018 (.46) PIN - PRESS-FIT

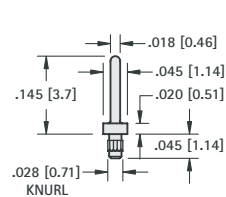

GOLD CAT. NO.	TIN CAT. NO.	Mtg. Hole Dia.
1986-1	1987-1	.026 (.66)

### .018 (.46) PIN - PRESS-FIT

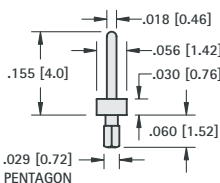

GOLD CAT. NO.	TIN CAT. NO.	Mtg. Hole Dia.
1988-2	1989-2	.026 (.66)

### .018 (.46) PIN - PRESS-FIT

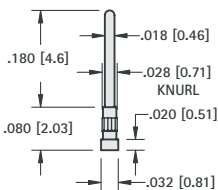

GOLD CAT. NO.	TIN CAT. NO.	Mtg. Hole Dia.	MATERIAL:
1990-2	1991-2	.026 (.66)	Phosphor Bronze

### .018 (.46) PIN - PRESS-FIT

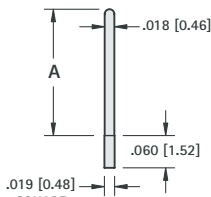

GOLD CAT. NO.	TIN CAT. NO.	A Dim.	Mtg. Hole Dia.
1992-2	1994-2	.243 (6.2)	.022
1993-2	1995-2	.140 (3.6)	(.56)

### .020 (.51) PIN - PRESS-FIT

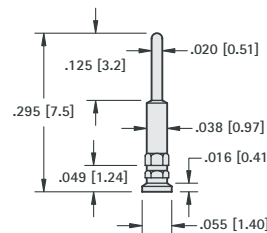

GOLD CAT. NO.	TIN CAT. NO.	Mtg. Hole Dia.
1996-2	1997-2	.040 (1.0)

### .020 (.51) PIN - PRESS-FIT

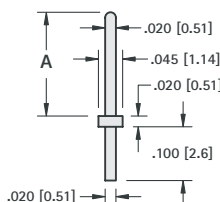

GOLD CAT. NO.	TIN CAT. NO.	A Dim.	Mtg. Hole Dia.
1998-3	2000-3	.250 (6.4)	.024
1999-3	2001-3	.425 (3.6)	(.61)

### .025 (.51) PIN - SWAGE MOUNT

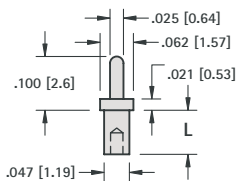

GOLD CAT. NO.	TIN CAT. NO.	L Length	Mtg. Hole Dia.
1404-1	1424-1	.051 (1.3)	.052
1404-2	1424-2	.082 (2.1)	(1.32)

### .025 (.51) PIN - SWAGE MOUNT

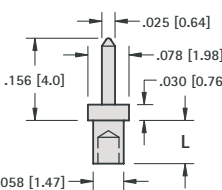

GOLD CAT. NO.	TIN CAT. NO.	L Length	Mtg. Hole Dia.
1408-1	1428-1	.062 (1.6)	.062
1408-2	1428-2	.094 (2.4)	(1.57)

### .025 (.51) PIN - SWAGE MOUNT

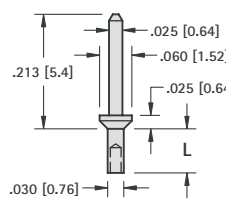

GOLD CAT. NO.	TIN CAT. NO.	L Length	Mtg. Hole Dia.
1406-1	1426-1	.047 (1.2)	.035
1406-2	1426-2	.078 (1.9)	(.89)

### .025 (.51) PIN - SWAGE MOUNT

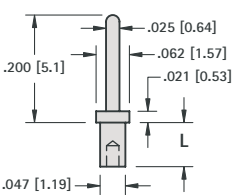

GOLD CAT. NO.	TIN CAT. NO.	L Length	Mtg. Hole Dia.
1407-1	1427-1	.051 (1.3)	.052
1407-2	1427-2	.082 (2.1)	(1.32)

### .025 (.51) PIN - SWAGE MOUNT

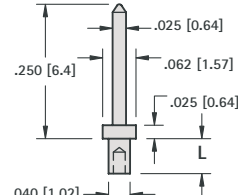

GOLD CAT. NO.	TIN CAT. NO.	L Length	Mtg. Hole Dia.
1401-1	1421-1	.065 (1.6)	.043 (1.09)

### .040 (1.0) PIN - SWAGE MOUNT

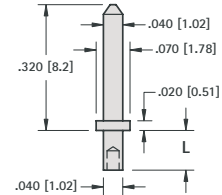

GOLD CAT. NO.	TIN CAT. NO.	L Length	Mtg. Hole Dia.
1405-1	1425-1	.051 (1.3)	.043
1405-2	1425-2	.082 (2.1)	(1.09)
1405-3	1425-3	.113 (2.9)	

### .040 (1.0) PIN - SWAGE MOUNT

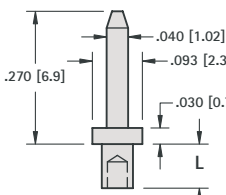

GOLD CAT. NO.	TIN CAT. NO.	L Length	Mtg. Hole Dia.
1402-3	1422-3	.125 (3.2)	.062 (1.57)

### .040 (1.0) KAY PIN - PRESS-FIT

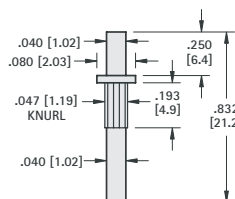

**MATERIAL:** Solid Nickel Silver  
**CAT. NO. 1218**  
 Mtg. Hole .043 (1.09) Dia.

### .040 (1.0) HOLLOW PIN - SWAGE MOUNT

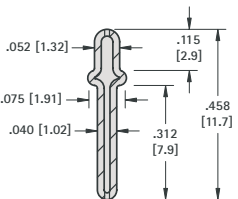

**MATERIAL:** Brass, Tin Plate  
**CAT. NO. 1219**  
 Mtg. Hole .059 (1.50) Dia.

### .080 (2.0) PIN - SWAGE MOUNT

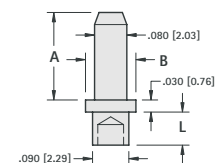

Mtg. Hole .094 (2.4) Dia.

GOLD CAT. NO.	TIN CAT. NO.	A Dim.	B Dim.	L Dim.
1447-1	1455-1	.335 (8.5)	.156 (4.0)	.051 (1.3)
1447-2	1455-2	.400 (10.2)	.125 (3.2)	.094 (2.4)
1447-3	1455-3	.400 (10.2)	.125 (3.2)	.125 (3.2)
1447-4	1455-4	.400 (10.2)	.125 (3.2)	.156 (4.0)

### .040 (1.0) PINS - INSULATED SHORTING PLUG

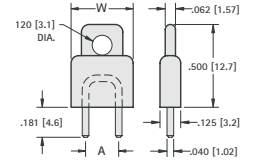

**MATERIAL:** Insulator: Plastic, Red or Black  
**Pins:** Brass, Gold Plate

RED CAT. NO.	BLACK CAT. NO.	A Dim.	W Dim.
1460R	1460B	.200 (5.1)	.375 (9.5)
1461R	1461B	.250 (6.4)	.375 (9.5)
1462R	1462B	.400 (10.2)	.620 (15.7)
1463R	1463B	.500 (12.7)	.620 (15.7)

MICRO PINS

## X-ON Electronics

Largest Supplier of Electrical and Electronic Components

*Click to view similar products for [Circuit Board Hardware - PCB category](#):*

*Click to view products by [Keystone manufacturer](#):*

Other Similar products are found below :

[8919-0-00-15-00-00-03-0](#) [0135-0-15-01-30-27-04-0](#) [5970-1-15-01-32-14-04-0](#) [0149-0-15-15-30-27-04-0](#) [MBI 1 BLUE](#) [7305-0-15-15-47-14-10-0](#) [MLN 150/1 BLACK](#) [8579-0-15-80-11-27-10-0](#) [8579-1-15-15-11-27-10-0](#) [8830-0-15-01-22-14-10-0](#) [8836-0-00-21-00-00-03-0](#) [PRUEF 2 RED](#) [9976-0-00-00-00-00-03-0](#) [PW1616](#) [1215-3-05-00-00-00-01-0](#) [1231](#) [1303-0-15-15-47-14-04-0](#) [1404-3](#) [1404-4](#) [1406-4](#) [1407-3](#) [1406-3](#) [1407-4](#) [1408-3](#) [1424-4](#) [1427-3](#) [1419-4](#) [1426-4](#) [1548-103](#) [1938-0-00-00-00-00-03-0](#) [1942-0-00-00-00-00-03-0](#) [2101-3-00-44-00-00-07-0](#) [2108-2-00-50-00-00-07-0](#) [2109-2-00-44-00-00-07-0](#) [2110-2-00-44-00-00-07-0](#) [2111-2-00-00-00-00-07-0](#) [2113-4-00-44-00-00-07-0](#) [2301-3-00-44-00-00-07-0](#) [2308-1-00-50-00-00-07-0](#) [2313-2-00-00-00-00-07-0](#) [2315-2-01-44-00-00-07-0](#) [2333-1-00-50-00-00-07-0](#) [9000-0-00-00-00-00-03-0](#) [2506-2-00-50-00-00-07-0](#) [2507-2-01-44-00-00-07-0](#) [2508-2-00-44-00-00-07-0](#) [2561-2-00-44-00-00-07-0](#) [9220](#) [9234-0-15-15-30-14-10-0](#) [LAS S G BLACK](#)