

THIS DOCUMENT IS THE PROPERTY OF  
KEYSTONE ELECTRONICS CORP. AND  
SHALL NOT BE REPRODUCED, DISTRIBUTED  
OR USED AS A BASIS FOR MANUFACTURE  
WITHOUT PRIOR WRITTEN PERMISSION  
FROM KEYSTONE ELECTRONICS CORP.

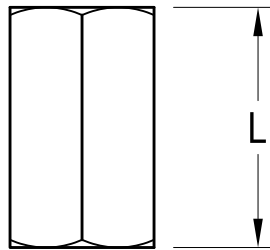
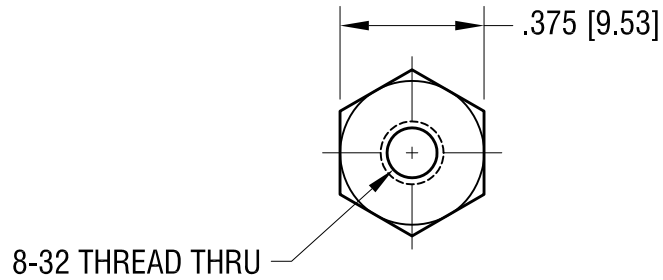

| PART NO. | 'L' DIM.     |
|----------|--------------|
| 1926A    | .375 [9.53]  |
| 1926B    | .500 [12.70] |
| 1926C    | .625 [15.88] |
| 1926D    | .750 [19.05] |
| 1926E    | 1.000 [25.4] |

**KEYSTONE ELECTRONICS CORP.**

www.keyelco.com • ASTORIA, N.Y. 11105-2017 • Tel (718) 956-8900

|               |  |        |  |                            |  |         |  |
|---------------|--|--------|--|----------------------------|--|---------|--|
| PART NAME     |  |        |  | THREADED HEX STANDOFF      |  |         |  |
| MATERIAL      |  |        |  | ALUMINUM                   |  |         |  |
| FINISH        |  | DRN BY |  | DATE                       |  | SCALE   |  |
| CLEAR IRIDITE |  | BOONE  |  | 3.24.98                    |  | 2X      |  |
| TOLERANCES    |  | INCH   |  | [MM]                       |  | CODE    |  |
| DECIMAL       |  | ± .005 |  | [± 0.13 ]                  |  | C       |  |
| ANGULAR       |  | ± 1°   |  | UNLESS OTHERWISE SPECIFIED |  | DWG NO. |  |
|               |  |        |  |                            |  | 1926A-E |  |

|      |             |      |
|------|-------------|------|
| DATE | DESCRIPTION | REV. |
|      |             |      |

## X-ON Electronics

Largest Supplier of Electrical and Electronic Components

*Click to view similar products for [Standoffs & Spacers](#) category:*

*Click to view products by [Keystone](#) manufacturer:*

Other Similar products are found below :

[588-6208-02](#) [599-9844-02](#) [M0516-3-N](#) [M0518-3-N](#) [M0521-3-N](#) [M0524-3-N](#) [M0532-35-N](#) [M0543-4-AL](#) [M0544-35-N](#) [M0544-3-N](#) [M0545-3-AL](#) [M0553-3-N](#) [M0608-5-SS](#) [M0609-5-SS](#) [M0651-5-SS](#) [M0653-35-N](#) [M0654-4-SS](#) [M0655-5-AL](#) [M0658-35-AL](#) [M0660-4-AL](#) [M0670-35-N](#) [M0671-5-N](#) [M0671-5-SS](#) [M0722-5-N](#) [M0725-6-N](#) [M0904-B-25-AL](#) [M1273-2545-AL](#) [M1273-2545-SS](#) [M1273-3005-AL](#) [M1273-3005-SS](#) [M1274-3005-AL](#) [60187](#) [60202-SP](#) [60273](#) [60348-SP](#) [60419-SP](#) [60425-SP](#) [60473-SP](#) [60475-SP](#) [60477-SP](#) [60489-SP](#) [60491-SP](#) [60585-SP](#) [60762-SP](#) [60763-SP](#) [60872-SP](#) [M1303-3506-AL](#) [M1307-3506-AL](#) [M1314-3005-AL](#) [M1314-3005-SS](#)