



Designers' Choice

PLUGS & JACKS

PANEL MOUNT PHONO JACKS

- Mats with 1/8" diameter pin
- Mounts to panel in .296 Dia. Hole
- Color coded for ease of identification
- Complete with nut and soldering lug

MATERIAL: Brass, Nickel Plate

ROUND BASE

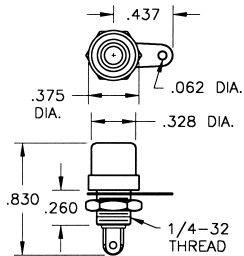

CAT. NO. 580 (RED INSULATOR)
CAT. NO. 574 (BLACK INSULATOR)

HEX BASE

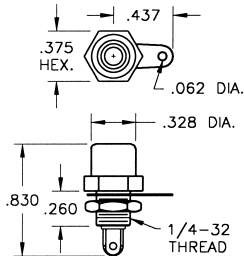

CAT. NO. 576 (BLACK INSULATOR)

RIVET TYPE PHOTO JACKS

- Mates with 1/8" diameter pin
- Rivet type-mounts in .296 Dia. Hole
- Available for 1/16" 3/32" 1/8" thick

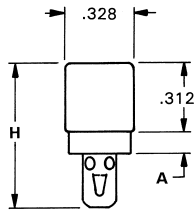

MATERIAL
Shell: Steel
Contract: Brass
Plating: Tin

CAT. NO.	A	H	INSULATOR THICKNESS
568	.078	.656	1/16"
569	.109	.812	3/32"
570	.140	.812	1/8"

BNC TO DUAL BANANA PLUGS

BNC MALE TO DUAL BANANA PLUGS

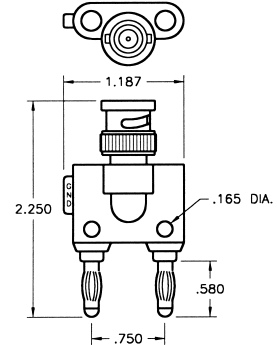

MATERIAL

Body: Molded Plastic
Connector: Brass, Nickel Plate
Center Contract: Brass, Gold Plate
Banana Plug: Beryllium Copper, Nickel Plate

CAT. NO. 7020

BNC FEMALE TO DUAL BANANA PLUGS

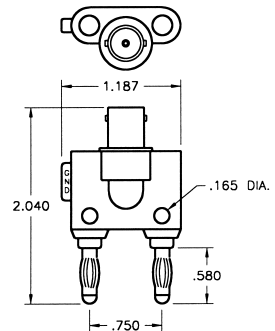
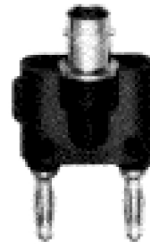

MATERIAL

Body: Molded Plastic
Connector: Brass, Nickel Plate
Center Contract: Brass, Gold Plate
Banana Plug: Beryllium Copper, Nickel Plate

CAT. NO. 7021

BNC MALE TO DUAL BINDING POSTS (BLACK & RED)

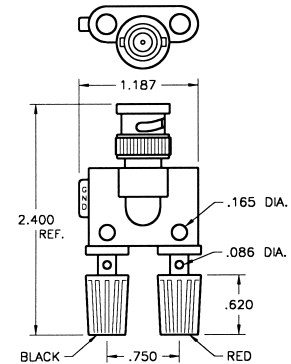

MATERIAL

Body: Molded Plastic
Connector: Brass, Nickel Plate
Center Contract: Brass, Gold Plate
Banana Plug: Brass, Nickel Plate

CAT. NO. 7022

PHONO PLUGS

Mates with 1/8" diameter jacks

MATERIAL: Shell: Steel, Tin Plate Pins: Brass, Nickel Plate

Longer Skirt for Better Grip

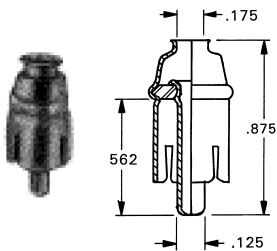

CAT. NO. 566

Strain Relief Lug Crimps to Wire Insulation

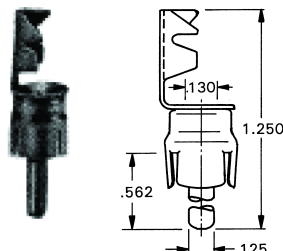

CAT. NO. 565

Conventional Type

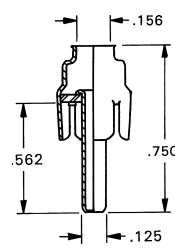

CAT. NO. 561

Crimp or Solder Type Extra Long Handle

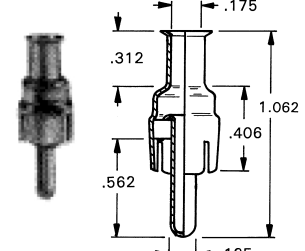

CAT. NO. 567

X-ON Electronics

Largest Supplier of Electrical and Electronic Components

Click to view similar products for [Test Plugs & Test Jacks](#) category:

Click to view products by [Keystone](#) manufacturer:

Other Similar products are found below :

[01-2601-4-0210](#) [01-2601-4-0212](#) [01-2604-4-0212](#) [01-2604-5-0210](#) [01-2150-1-0312](#) [01-2350-1-02](#) [01-2352-1-02](#) [01-2368-1-02](#) [01-2604-4-0210](#) [01-2604-5-0212](#) [01-2606-4-0210](#) [01-2606-4-0212](#) [01-2606-5-0212](#) [M39024/10-01G](#) [M39024/10-17G](#) [M39024/11-09G](#) [M39024/11-42](#) [M39024/11-43](#) [M39024/12-08](#) [707-5311](#) [707-5402-01-19](#) [707-5410](#) [923739-40-I](#) [R644543000](#) [R948161000](#) [R999351000](#) [1408-4](#) [1499-101](#) [1533-1](#) [1659559](#) [1659567](#) [1663921](#) [1663939](#) [1696-102](#) [174-R825B-EX](#) [NYS508-BU](#) [NYS508-O](#) [211-101](#) [RS100GBL](#) [RS250GBL](#) [251-102](#) [25-2251-2-03](#) [25-2259-2-03](#) [923743-16-I](#) [923743-24-I](#) [923743-28-I](#) [2854-BLU](#) [2970-BLK](#) [30-443G](#) [1680](#)