



Designers' Choice

# PLUGS & JACKS

## PANEL MOUNT PHONO JACKS

- Mats with 1/8" diameter pin
- Mounts to panel in .296 Dia. Hole
- Color coded for ease of identification
- Complete with nut and soldering lug

**MATERIAL:** Brass, Nickel Plate

### ROUND BASE

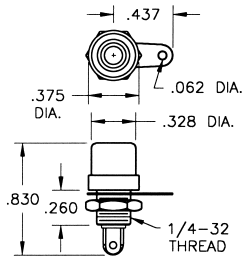

**CAT. NO. 580 (RED INSULATOR)**  
**CAT. NO. 574 (BLACK INSULATOR)**

### HEX BASE

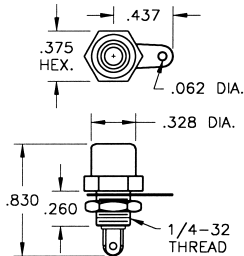

**CAT. NO. 576 (BLACK INSULATOR)**

## RIVET TYPE PHOTO JACKS

- Mates with 1/8" diameter pin
- Rivet type-mounts in .296 Dia. Hole
- Available for 1/16" 3/32" 1/8" thick

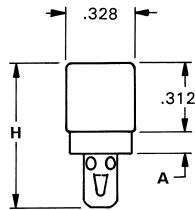

**MATERIAL**  
**Shell:** Steel  
**Contract:** Brass  
**Plating:** Tin

CAT. NO.	A	H	INSULATOR THICKNESS
568	.078	.656	1/16"
569	.109	.812	3/32"
570	.140	.812	1/8"

## BNC TO DUAL BANANA PLUGS

### BNC MALE TO DUAL BANANA PLUGS

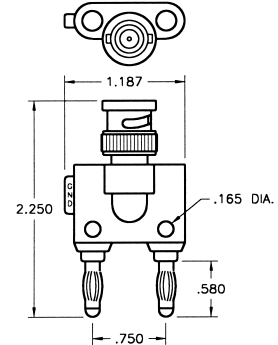

**MATERIAL**  
**Body:** Molded Plastic  
**Connector:** Brass, Nickel Plate  
**Center Contract:** Brass, Gold Plate  
**Banana Plug:** Beryllium Copper, Nickel Plate

**CAT. NO. 7020**

### BNC FEMALE TO DUAL BANANA PLUGS

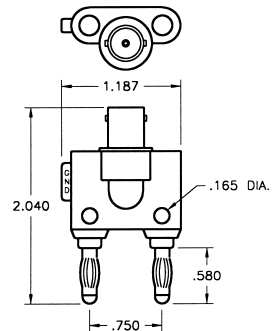
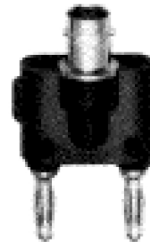

**MATERIAL**  
**Body:** Molded Plastic  
**Connector:** Brass, Nickel Plate  
**Center Contract:** Brass, Gold Plate  
**Banana Plug:** Beryllium Copper, Nickel Plate

**CAT. NO. 7021**

### BNC MALE TO DUAL BINDING POSTS (BLACK & RED)

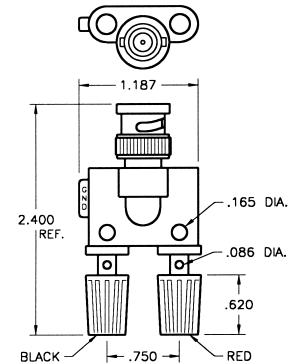

**MATERIAL**  
**Body:** Molded Plastic  
**Connector:** Brass, Nickel Plate  
**Center Contract:** Brass, Gold Plate  
**Banana Plug:** Brass, Nickel Plate

**CAT. NO. 7022**

## PHONO PLUGS

Mates with 1/8" diameter jacks

**MATERIAL:** Shell: Steel, Tin Plate Pins: Brass, Nickel Plate

### Longer Skirt for Better Grip

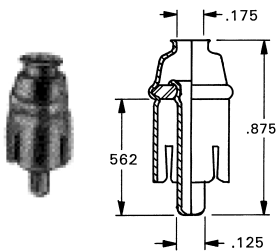

**CAT. NO. 566**

### Strain Relief Lug Crimps to Wire Insulation

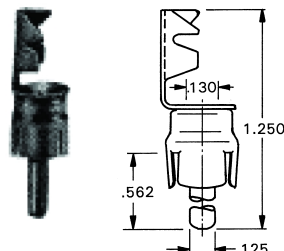

**CAT. NO. 565**

### Conventional Type

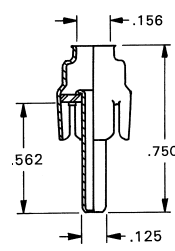

**CAT. NO. 561**

### Crimp or Solder Type Extra Long Handle

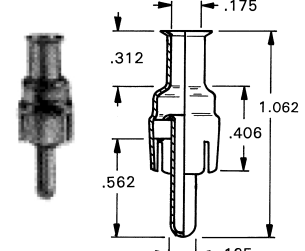

**CAT. NO. 567**

## X-ON Electronics

Largest Supplier of Electrical and Electronic Components

*Click to view similar products for [RF Adapters - Between Series category](#):*

*Click to view products by [Keystone manufacturer](#):*

Other Similar products are found below :

[5945-9503-000](#) [MCX/F-SMA/M](#) [R192417010](#) [ADBJ20-E1-BJ379](#) [ADM2](#) [ADPL75-A1-PL75](#) [242191](#) [9317505](#) [AD130](#) [ADBJ20-E1-PL74](#)  
[ADBJ77-A1PL3155](#) [ADBJ77-E1-UPL20](#) [ADRMF370](#) [242190](#) [242215](#) [242228](#) [R125680000W](#) [R192430000](#) [UAD95](#) [1057367-1](#) [8311505](#)  
[R114704000](#) [R451034500](#) [R451030500](#) [R451543000](#) [HDVDPN](#) [ADBJ20-K1-PL20](#) [R451570000](#) [R192419000](#) [R451034000](#) [J9](#) [J3WE-5](#)  
[R451032500](#) [242201RP](#) [17K132-K00S5](#) [03K719-S22S3](#) [AD-RSMAF-RTNC](#) [53K156-K00N5](#) [53K160-KIMN1](#) [02K119-K00E3](#) [29S132-](#)  
[K01N5](#) [53S156-K00N5](#) [02S119-S00E3](#) [28K132-K00N5](#) [02S109-K00S3](#) [27-8200TP](#) [242235](#) [ADBJ20-E1-BJ89](#) [ADP-SMAF-MMCXM](#) [000-](#)  
[2900](#)