

THIS DOCUMENT IS THE PROPERTY OF  
KEYSTONE ELECTRONICS CORP. AND  
SHALL NOT BE REPRODUCED, DISTRIBUTED  
OR USED AS A BASIS FOR MANUFACTURE  
WITHOUT PRIOR WRITTEN PERMISSION  
FROM KEYSTONE ELECTRONICS CORP.

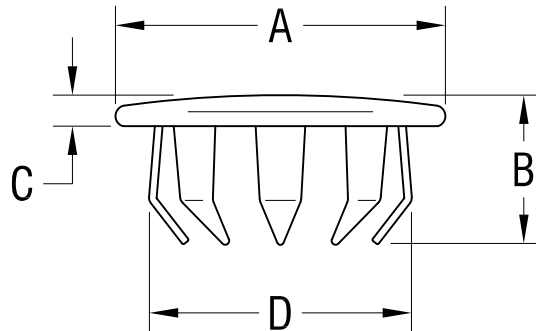

PART NO.	NO. OF PRONGS	'A' DIM.	'B' DIM.	'C' DIM.	±.005 [±0.13] 'D' DIM.
7600	6	.406 [10.3]	.234 [5.9]	.062 [1.57]	.260 [6.6]
7601	6	.437 [11.1]	.250 [6.4]	.062 [1.57]	.330 [8.4]
7602	6	.500 [12.7]	.234 [5.9]	.062 [1.57]	.390 [9.9]
7603	8	.656 [16.7]	.281 [7.1]	.078 [1.98]	.520 [13.2]
7604	8	.812 [20.6]	.296 [7.5]	.078 [1.98]	.637 [16.2]
7605	12	.921 [23.4]	.296 [7.5]	.078 [1.98]	.760 [19.3]
7606	12	1.062 [27.0]	.296 [7.5]	.062 [1.57]	.890 [22.6]
7607	12	1.140 [29.0]	.328 [8.3]	.093 [2.36]	1.020 [25.9]
7608	12	1.312 [33.3]	.343 [8.7]	.093 [2.36]	1.150 [29.2]
7609	12	1.437 [36.5]	.343 [8.7]	.093 [2.36]	1.281 [32.5]
7610	12	1.562 [39.7]	.406 [10.3]	.078 [1.98]	1.395 [35.4]

**KEYSTONE ELECTRONICS CORP.**

www.keyelco.com • ASTORIA, N.Y. 11105-2017 • Tel (718) 956-8900

PART NAME

STEEL HOLE PLUG

MATERIAL

STEEL

FINISH

NICKEL PLATE

DRN BY

BOONE

DATE

11.22.06

APP'D

SCALE

NONE

2.09.15 CHANGE AS PER ECN 15-020

A

TOLERANCES INCH [MM]  
DECIMAL ± .010 [± 0.25]  
ANGULAR ± 1°  
UNLESS OTHERWISE SPECIFIED

CODE

DWG NO.

C

7600-7610

DATE

DESCRIPTION

REV.

## X-ON Electronics

Largest Supplier of Electrical and Electronic Components

*Click to view similar products for [Conduit Fittings & Accessories](#) category:*

*Click to view products by [Keystone](#) manufacturer:*

Other Similar products are found below :

[M3231GAB](#) [M3231GAC](#) [M3231GAE](#) [M3231GL](#) [M3231GT](#) [VC-937-16/RED](#) [VC-562-16/RED](#) [VC-1125-16/RED](#) [DM0240-1/2A](#) [3408B](#)  
[G6002](#) [M4340GAE](#) [C2016-P](#) [C2012-P](#) [3407B](#) [1660-P](#) [561-87BG11BLK](#) [561-75BG11B](#) [1.533.1201.50](#) [1.533.1601.51](#) [1.533.4001.50](#)  
[1.533.5001.50](#) [BVNV-P428](#) [BVBV-P366](#) [2276](#) [2663-P](#) [3405B](#) [C2070-P](#) [3582V](#) [4975](#) [2644-P](#) [2955](#) [M50](#) [2404-P](#) [2291](#) [2133-P](#) [3048F](#)  
[VC12516](#) [RC156-0500](#) [DM0523-1/2A](#) [1035A](#) [DMS0250-1A](#) [DMS0313-1A](#) [1040A](#) [1050A](#) [R1/8A](#) [DMPC0490-1/2A](#) [DMPC0521-1/2A](#)  
[DMPC0552-1/2A](#) [1070A](#) [R1/2A](#)