

THIS DOCUMENT IS THE PROPERTY OF
KEYSTONE ELECTRONICS CORP. AND
SHALL NOT BE REPRODUCED, DISTRIBUTED
OR USED AS A BASIS FOR MANUFACTURE
WITHOUT PRIOR WRITTEN PERMISSION
FROM KEYSTONE ELECTRONICS CORP.

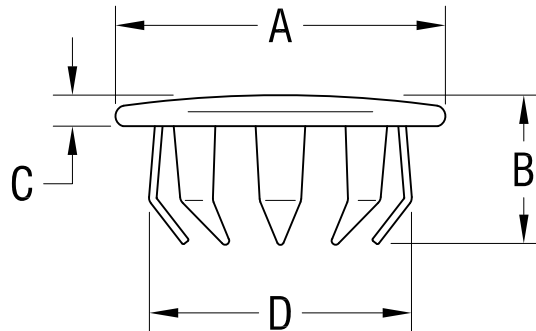

| PART NO. | NO. OF PRONGS | 'A' DIM. | 'B' DIM. | 'C' DIM. | ±.005 [±0.13] 'D' DIM. |
|----------|---------------|--------------|-------------|-------------|---------------------------|
| 7600 | 6 | .406 [10.3] | .234 [5.9] | .062 [1.57] | .260 [6.6] |
| 7601 | 6 | .437 [11.1] | .250 [6.4] | .062 [1.57] | .330 [8.4] |
| 7602 | 6 | .500 [12.7] | .234 [5.9] | .062 [1.57] | .390 [9.9] |
| 7603 | 8 | .656 [16.7] | .281 [7.1] | .078 [1.98] | .520 [13.2] |
| 7604 | 8 | .812 [20.6] | .296 [7.5] | .078 [1.98] | .637 [16.2] |
| 7605 | 12 | .921 [23.4] | .296 [7.5] | .078 [1.98] | .760 [19.3] |
| 7606 | 12 | 1.062 [27.0] | .296 [7.5] | .062 [1.57] | .890 [22.6] |
| 7607 | 12 | 1.140 [29.0] | .328 [8.3] | .093 [2.36] | 1.020 [25.9] |
| 7608 | 12 | 1.312 [33.3] | .343 [8.7] | .093 [2.36] | 1.150 [29.2] |
| 7609 | 12 | 1.437 [36.5] | .343 [8.7] | .093 [2.36] | 1.281 [32.5] |
| 7610 | 12 | 1.562 [39.7] | .406 [10.3] | .078 [1.98] | 1.395 [35.4] |

KEYSTONE ELECTRONICS CORP.

www.keyelco.com • ASTORIA, N.Y. 11105-2017 • Tel (718) 956-8900

PART NAME

STEEL HOLE PLUG

MATERIAL

STEEL

FINISH

NICKEL PLATE

DRN BY

BOONE

DATE

11.22.06

APP'D

SCALE

NONE

TOLERANCES

INCH [MM]

DECIMAL ±.010 [±0.25]

CODE

DWG NO.

C

7600-7610

2.09.15 CHANGE AS PER ECN 15-020

A

DATE

DESCRIPTION

REV.

X-ON Electronics

Largest Supplier of Electrical and Electronic Components

Click to view similar products for [Conduit Fittings & Accessories](#) category:

Click to view products by [Keystone](#) manufacturer:

Other Similar products are found below :

[M3231GAB](#) [M3231GAC](#) [M3231GAE](#) [M3231GL](#) [M3231GN](#) [M3231GT](#) [VC-937-16/RED](#) [VC-562-16/RED](#) [VC-1125-16/RED](#) [DM0240-1/2A](#) [3408B](#) [G6002](#) [M4340GAE](#) [C2016-P](#) [C2012-P](#) [3407B](#) [1660-P](#) [561-87BG11BLK](#) [561-75BG11B](#) [BVNV-P428](#) [BVBV-P366](#) [2276](#) [2663-P](#) [3405B](#) [C2070-P](#) [3582V](#) [4975](#) [2644-P](#) [2955](#) [M50](#) [2404-P](#) [2291](#) [2133-P](#) [3048F](#) [VC12516](#) [RC156-0500](#) [DM0523-1/2A](#) [1035A](#) [DMS0250-1A](#) [DMS0313-1A](#) [1040A](#) [1050A](#) [R1/8A](#) [DMPC0490-1/2A](#) [DMPC0521-1/2A](#) [DMPC0552-1/2A](#) [1070A](#) [R1/2A](#) [E1-7/8B](#) [061A](#) [R3/4A](#)