

THIS DOCUMENT IS THE PROPERTY OF KEYSTONE ELECTRONICS CORP. AND SHALL NOT BE REPRODUCED, DISTRIBUTED OR USED AS A BASIS FOR MANUFACTURE WITHOUT PRIOR WRITTEN PERMISSION FROM KEYSTONE ELECTRONICS CORP.

ACTUAL SIZE

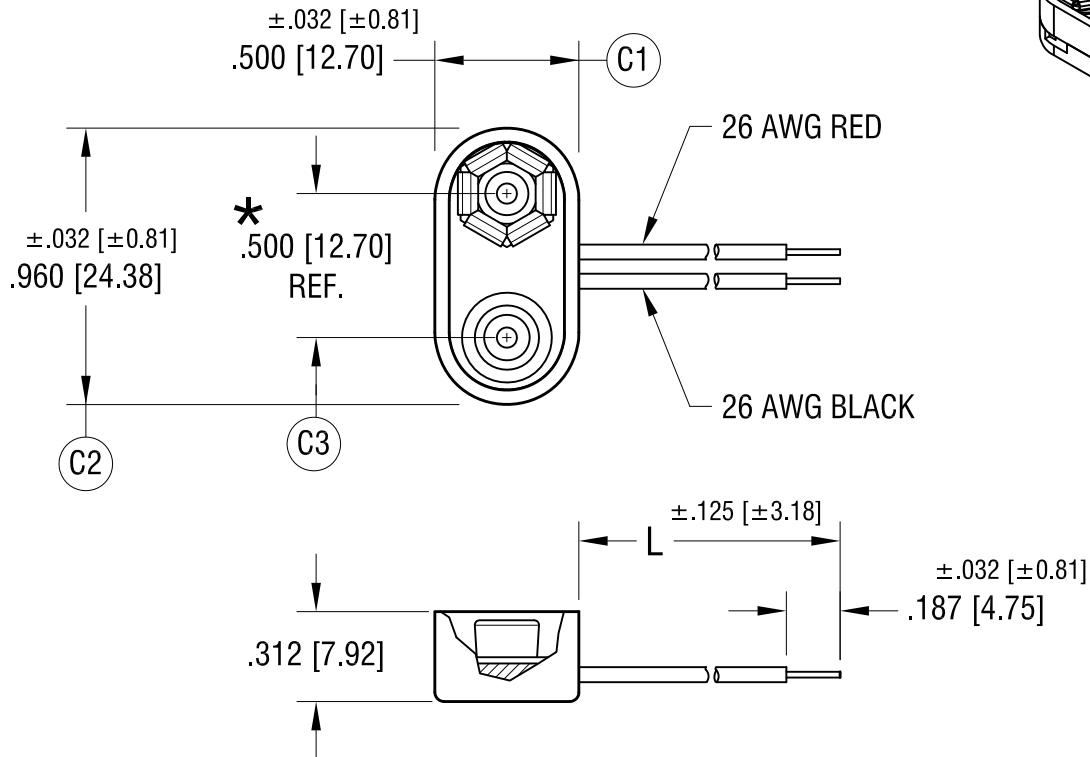
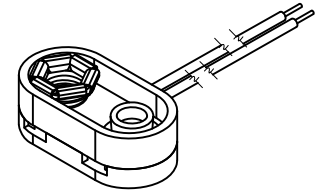

NOTES:

1. WIRE: 26 AWG, 1007 UL/CSA APPROVED
 .052 [1.32] O.D. PVC INSULATION.
 RED WIRE CONNECTED TO FEMALE CONTACT;
 BLACK WIRE TO MALE CONTACT.
2. BASE: MAT'L- ABS
3. CONTACT: MAT'L- BRASS
 FINISH - NICKEL PLATE
4. EYELET: MAT'L- BRASS
5. * REF. DIMENSION MUST FIT
 INDUSTRY STANDARD 9 VOLT BATTERY.

| PART NO. | 'L' DIM. |
|----------|----------------|
| 81-4 | 4.000 [101.60] |
| 81-6 | 6.000 [152.40] |
| 81-8 | 8.000 [203.20] |

| DATE | DESCRIPTION | REV. |
|----------|--|------|
| 8.11.21 | TOLERANCE FOR C1, C2 WAS $\pm .010$ ECN 21-084 ADD C3 & NOTE 5. | C |
| 11.10.03 | CHANGE AS PER ECN 03-083 | B |
| 4.1.98 | CHANGE AS PER ECR 98-020 | A |

| | | | |
|--|-----------------------------------|-----------------|----------------|
| KEYSTONE ELECTRONICS CORP. | | | |
| www.keyelco.com • NEW HYDE PARK, NY 11040 • Tel (516) 328-7500 | | | |
| PART NAME SHIELDED 9 VOLT 'T' TYPE BATTERY STRAP | | | |
| MATERIAL AS NOTED | | | |
| FINISH AS NOTED | | DRN BY BOONE | DATE 1.7.97 |
| | | APP'D | SCALE 1.5X |
| TOLERANCES INCH [MM] | DECIMAL $\pm .010$ [± 0.25] | CODE C | DWG NO. 81- |
| ANGULAR $\pm 1^\circ$ | | | |
| UNLESS OTHERWISE SPECIFIED | | | |

X-ON Electronics

Largest Supplier of Electrical and Electronic Components

Click to view similar products for [9V Battery Snaps & Contacts](#) category:

Click to view products by [Keystone](#) manufacturer:

Other Similar products are found below :

[139B](#) [173P](#) [274](#) [532-SWH](#) [266](#) [1295](#) [12BC2202-GR](#) [271](#) [12BH615D-GR](#) [121-0624/O-GR](#) [636](#) [67](#) [68](#) [72](#) [724](#) [79](#) [265](#) [967](#) [968](#) [80](#)
[BX0023](#) [BX0026](#) [BX0033](#) [1290](#) [1290-79](#) [1291](#) [1291-79](#) [1294](#) [203-P](#) [2239](#) [2240](#) [229](#) [232](#) [232-M](#) [233](#) [233-M](#) [234](#) [234-M](#) [235](#) [235-M](#)
[237-M](#) [245](#) [261](#) [263](#) [264](#) [269](#) [272](#) [303-P](#) [593](#) [594](#)