

THIS DOCUMENT IS THE PROPERTY OF
KEYSTONE ELECTRONICS CORP. AND
SHALL NOT BE REPRODUCED, DISTRIBUTED
OR USED AS A BASIS FOR MANUFACTURE
WITHOUT PRIOR WRITTEN PERMISSION
FROM KEYSTONE ELECTRONICS CORP.

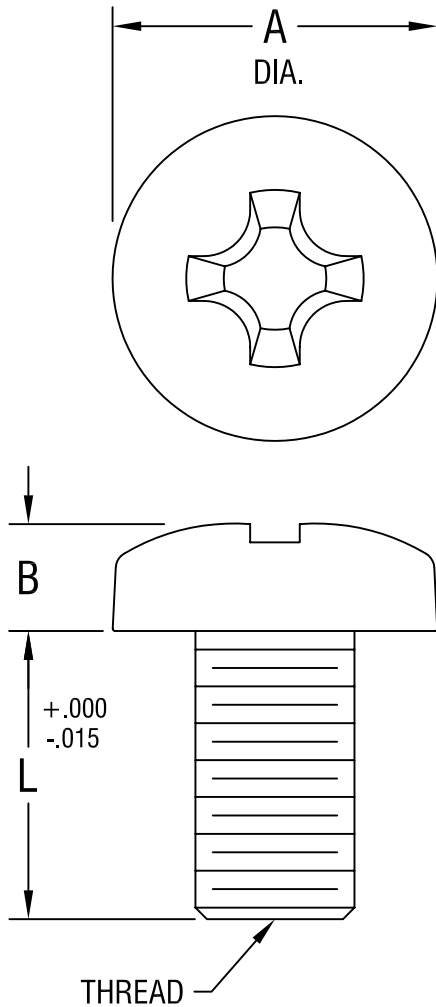

| PART NO. | 'L' DIM. | THREAD | 'A' DIM. | 'B' DIM. | DRIVER |
|----------|------------|--------|----------|----------|--------|
| 9900 | 1/4 (.250) | 4-40 | .212 | .075 | 1 |
| 9901 | 3/8 (.375) | | | | |
| 9902 | 1/2 (.500) | | | | |
| 9903 | 1/4 (.250) | 6-32 | .263 | .092 | 2 |
| 9904 | 3/8 (.375) | | | | |
| 9905 | 1/2 (.500) | | | | |
| 9906 | 3/8 (.375) | 8-32 | .314 | .110 | 2 |
| 9907 | 1/2 (.500) | | | | |
| 9908 | 3/4 (.750) | | | | |
| 9909 | 3/8 (.375) | 10-32 | .365 | .128 | 2 |
| 9910 | 1/2 (.500) | | | | |
| 9911 | 3/4 (.750) | | | | |

KEYSTONE ELECTRONICS CORP.

ASTORIA, N.Y. 11105-2017

PART NAME

PHILIPS PAN HEAD SCREW

MATERIAL

STAINLESS STEEL

FINISH

-

DRN BY

BOONE

DATE

4.23.99

APPD

SCALE

6X

TOLERANCES

INCH [MM]

DECIMAL $\pm .010$ [± 0.25]

ANGULAR $\pm 1^\circ$

UNLESS OTHERWISE SPECIFIED

CODE

C/M

DWG NO.

9900-9911

DATE

DESCRIPTION

REV.

X-ON Electronics

Largest Supplier of Electrical and Electronic Components

Click to view similar products for [Screws & Fasteners](#) category:

Click to view products by [Keystone](#) manufacturer:

Other Similar products are found below :

[5721-1440-1/4-SS](#) [593503FX](#) [0098.0094](#) [0098.9206](#) [0098.9219](#) [0098.9262](#) [596-2114-013](#) [59781-6](#) [0098.0026](#) [0098.9210](#) [0098.9212](#) [60227-01](#) [60227-04](#) [60227-08](#) [60687-01](#) [LOCK WASHER Black](#) [62153-03](#) [62153-11](#) [M316-KSSTMCZ100](#) [M3440-SS](#) [M3442-SS](#) [M3448-SS](#) [6292-1](#) [6-306105-9](#) [6-306131-4](#) [690432-1](#) [699161-000](#) [7230-3](#) [7244](#) [7248-1](#) [7248-2](#) [745564-1](#) [F1209](#) [751-00001](#) [7680](#) [809704-1](#) [8700](#) [8860220](#) [9047](#) [9521](#) [992326-6](#) [992763-3](#) [1-18024-0](#) [1-18028-2](#) [A168P1](#) [A495P1](#) [1-24921-1](#) [125416-1](#) [1260](#) [13-0036](#) [1301810148](#)