

| <b>#4 CLEAR HOLE SPACER ENGINEERING KIT CAT. NO. SCR-4</b> |             |              |             |            |             |
|--|-------------|--------------|-------------|------------|-------------|
| O. D. = .250 [6.35]  |             | Brass        | Aluminum    | Nylon      | Alum.-Econ. |
| Length   | Hole Dia.   | Cat. No.     | Cat. No.    | Cat. No.   | Cat. No.    |
| .250 [6.35]  | .120 [3.05] | <b>1454A</b> | <b>3457</b> | <b>876</b> | <b>398</b>  |
| .500 [12.70]   | .120 [3.05] | <b>1454C</b> | <b>3459</b> | <b>878</b> | <b>402</b>  |
| .750 [19.05]   | .120 [3.05] | <b>1454D</b> | <b>3460</b> | <b>880</b> | <b>418</b>  |
| 1.00 [25.40]   | .120 [3.05] | <b>1454E</b> | <b>3461</b> | <b>882</b> | <b>420</b>  |

| <b>#6 CLEAR HOLE SPACER ENGINEERING KIT CAT. NO. SCR-6</b> |             |              |             |            |             |
|--|-------------|--------------|-------------|------------|-------------|
| O. D. = .250 [6.35]  |             | Brass        | Aluminum    | Nylon      | Alum.-Econ. |
| Length   | Hole Dia.   | Cat. No.     | Cat. No.    | Cat. No.   | Cat. No.    |
| .250 [6.35]  | .144 [3.65] | <b>1457A</b> | <b>3464</b> | <b>884</b> | <b>405</b>  |
| .500 [12.70]   | .144 [3.65] | <b>1457C</b> | <b>3466</b> | <b>886</b> | <b>409</b>  |
| .750 [19.05]   | .144 [3.65] | <b>1457D</b> | <b>3467</b> | <b>888</b> | <b>425</b>  |
| 1.00 [25.40]   | .144 [3.65] | <b>1457E</b> | <b>3468</b> | <b>890</b> | <b>427</b>  |

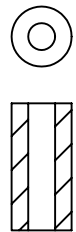

| <b>#8 CLEAR HOLE SPACER ENGINEERING KIT CAT. NO. SCR-8</b> |             |             |             |            |             |
|--|-------------|-------------|-------------|------------|-------------|
| O. D. = .250 [6.35]  |             | Brass       | Aluminum    | Nylon      | Alum.-Econ. |
| Length   | Hole Dia.   | Cat. No.    | Cat. No.    | Cat. No.   | Cat. No.    |
| .250 [6.35]  | .171 [4.34] | <b>1480</b> | <b>3471</b> | <b>892</b> | <b>412</b>  |
| .500 [12.70]   | .171 [4.34] | <b>1482</b> | <b>3473</b> | <b>894</b> | <b>416</b>  |
| .750 [19.05]   | .171 [4.34] | <b>1483</b> | <b>3474</b> | <b>896</b> | <b>432</b>  |
| 1.00 [25.40]   | .171 [4.34] | <b>1484</b> | <b>3475</b> | <b>898</b> | <b>434</b>  |

**NOTES:**

1. A KIT HAS 25 PIECES OF EACH CAT.NO. FOR A TOTAL QUANTITY OF 400 PIECES AND IS HOUSED IN A 16 TRAY, LABELED ENCLOSURE.
2. MAT'L - .BRASS, NICKEL PLATE  
 MAT'L - ALUMINUM, CLEAR IRIDITE  
 MAT'L - NYLON 6/6  
 MAT'L - ALUMINUM, ROLLED, UNFINISHED
3. DRAWS WILL BE ASSEMBLED WITH PLASTIC DIVIDER INSTALLED AND PRODUCT PLACED IN THE FRONT PORTION OF EACH DRAW.

|  |           |                 |                        |
|--|-----------|-----------------|------------------------|
| <b>KEYSTONE ELECTRONICS CORP.</b>                                      |           |                 |                        |
| ASTORIA, N.Y. 11105-2017   |           |                 |                        |
| PART NAME<br>.250 O.D. SPACER HARDWARE KITS                            |           |                 |                        |
| MATERIAL<br>AS NOTED   |           |                 |                        |
| FINISH<br>AS NOTED   |           | DRN BY<br>BOONE | DATE<br>10.20.03       |
|  |           | APPD            | SCALE<br>-             |
| TOLERANCES<br>DECIMAL ± [±]<br>ANGULAR ±<br>UNLESS OTHERWISE SPECIFIED | INCH [MM] | CODE<br>C/M     | DWG NO.<br><b>SCR-</b> |

| DATE | DESCRIPTION | REV. |
|------|-------------|------|
|      |             |      |

## X-ON Electronics

Largest Supplier of Electrical and Electronic Components

*Click to view similar products for [Tool Kits & Cases](#) category:*

*Click to view products by [Keystone](#) manufacturer:*

Other Similar products are found below :

[217434-1](#) [4263](#) [1055420-1](#) [11-18-3023](#) [63860-8170](#) [856600-2](#) [690372163](#) [11-40-3247](#) [63883-2870](#) [63885-0270](#) [63866-1070](#) [63863-5070](#)  
[63892-7370](#) [11-18-3209](#) [63860-4070](#) [63881-0970](#) [A0403641](#) [11-18-3040](#) [63865-2070](#) [63910-1470](#) [63861-5070](#) [63850-7470](#) [11-18-3201](#)  
[63910-7570](#) [FM 0501 146](#) [63883-0670](#) [63830-0070](#) [63902-9170](#) [11-18-3147](#) [11-18-3079](#) [63883-2670](#) [63900-1770](#) [11-18-3190](#) [63851-1070](#)  
[63912-4770](#) [63911-5270](#) [63895-1070](#) [63860-1470](#) [63850-6070](#) [1-69411-3](#) [63852-9270](#) [63802-6270](#) [63902-4870](#) [11-18-3202](#) [63852-9170](#)  
[63850-1070](#) [63830-0170](#) [63910-2870](#) [11-18-3010](#) [63820-7070](#)