

THIS DOCUMENT IS THE PROPERTY OF
KEYSTONE ELECTRONICS CORP. AND
SHALL NOT BE REPRODUCED, DISTRIBUTED
OR USED AS A BASIS FOR MANUFACTURE
WITHOUT PRIOR WRITTEN PERMISSION
FROM KEYSTONE ELECTRONICS CORP.

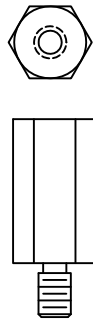

HEX. M/F STANDOFF ENGINEERING KIT			
DIA. =	THREAD SIZE		
	.250 [6.35]	4-40	6-32
Length	Cat. No.	Cat. No.	Cat. No.
.500 [12.70]	1944	1952	1957
.750 [19.05]	1946	1954	1959
1.000 [25.40]	1947	1644	1960
1.250 [31.75]	1948	1955	1961
1.500 [38.10]	1950	1645	1963

NOTES:

1. A KIT HAS 50 PIECES OF EACH CAT.NO. FOR A TOTAL QUANTITY OF 750 PIECES AND IS HOUSED IN A 16 DRAW DISPLAY CASE.
2. CASE: MAT'L - THERMOPLASTIC
SPACER: MAT'L- BRASS
FINISH: NICKEL PLATE
3. EACH CAT. NO. WILL BE PLACED IN INDIVIDUAL DRAW

KEYSTONE ELECTRONICS CORP.			
www.keyelco.com • ASTORIA, N.Y. 11105-2017 • Tel (718) 956-8900			
PART NAME			
HEX. M/F STANDOFF KIT			
MATERIAL			
AS NOTED			
FINISH		DRN BY	DATE
AS NOTED		NT	3.08.12
		APP'D	SCALE
			-
TOLERANCES	INCH	[MM]	CODE
DECIMAL	±	[±]	DWG NO.
ANGULAR	±		C/M
UNLESS OTHERWISE SPECIFIED			STH-19

DATE	DESCRIPTION	REV.

X-ON Electronics

Largest Supplier of Electrical and Electronic Components

Click to view similar products for [Standoffs & Spacers](#) category:

Click to view products by [Keystone](#) manufacturer:

Other Similar products are found below :

[588-6208-02](#) [599-9844-02](#) [M0516-3-N](#) [M0518-3-N](#) [M0521-3-N](#) [M0524-3-N](#) [M0532-35-N](#) [M0543-4-AL](#) [M0544-35-N](#) [M0544-3-N](#) [M0545-3-AL](#) [M0553-3-N](#) [M0608-5-SS](#) [M0609-5-SS](#) [M0651-5-SS](#) [M0653-35-N](#) [M0654-4-SS](#) [M0655-5-AL](#) [M0658-35-AL](#) [M0660-4-AL](#) [M0670-35-N](#) [M0671-5-N](#) [M0671-5-SS](#) [M0722-5-N](#) [M0725-6-N](#) [M0904-B-25-AL](#) [M1273-2545-AL](#) [M1273-2545-SS](#) [M1273-3005-AL](#) [M1273-3005-SS](#) [M1274-3005-AL](#) [60187](#) [60202-SP](#) [60273](#) [60348-SP](#) [60419-SP](#) [60425-SP](#) [60473-SP](#) [60475-SP](#) [60477-SP](#) [60489-SP](#) [60491-SP](#) [60585-SP](#) [60762-SP](#) [60763-SP](#) [60872-SP](#) [M1303-3506-AL](#) [M1307-3506-AL](#) [M1314-3005-AL](#) [M1314-3005-SS](#)