

RECOMMEND P.C.B LAYOUT
PCB TOLERANCE: ±0.05 (TOP VIEW)

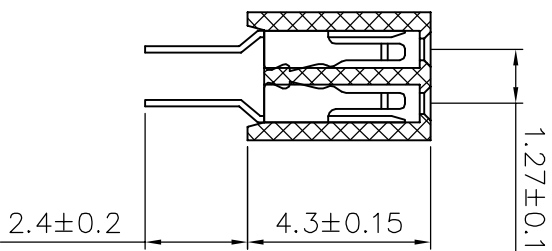
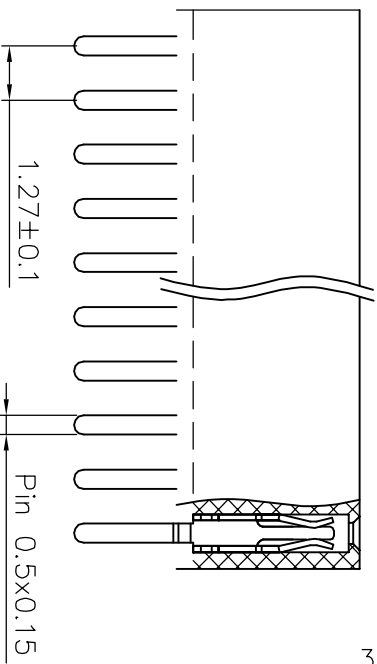

SPECIFICATIONS

Current Rating: 1.0 Amps
 Withstanding Voltage: AC 500V
 Insulation Resistance: 1000MΩ Min
 Contact Resistance: 20mΩ Max
 Operation Temperature: -40 ° to +105 °
 Insulator Material: Polyester (UL94V-0)
 Contact Material: Phosphor bronze
 Standard: PA6T
 Contact Plating: Gold Flash
 Max. Processing Temp: 240 ° C for 30-60seconds
 (260 ° C for 5seconds)

- (1) Pin Spacing: 127=1.27mm
- (2) Product Name: FH=Female Header
- (3) No. of Rows: 1=Single Row ; 2=Dual Row
- (4) No. of Pins Per Row: 1~50
- (5) Insulator Material Height: 20=2.0mm; 43=4.3mm
- (6) Connector Type: S=Straight; R=Right; Angle M=SMT
- (7) Connector Material Length: 24=2.4mm; 30=3.0mm
- (8) Insulator Material Width: 18=1.8mm 21=2.1mm
- (9) Contact Plating: 60=Gold Flash; AU10=Au 1.0u"
- (10) Insulator Material Option:
 A=BK-PA6T; B=BK-PA46; C=KB-LCP; S=Special

深圳市金航标电子有限公司

WWW.BDS666.COM

KH-1.27FH-2X10P-H4.3

0755-83044319

UNLESS OTHERWISE SPECIFIED TOLERANCE

X : ±0.3 X° : ±5°
 X.X : ±0.2 X.X° : ±1°
 X.XX: ±0.1 X.XX° : ±0.5°

DRAWN NAME 1.27FH 2X10P H4.3 DIP

SIZE	A4	SCALE	N:1	PRODUCT NO.	PAGE	1/1
REV	A	UNIT	mm	PROJECT	APPROVED:	
CHECKED:						

LI BEI LIN 12/03/07

1	2	3	4	5	6	7	8	9
No. of	DIM. A	DIM. B	No. of	DIM. A	DIM. B	No. of	DIM. A	DIM. B
1	—	—	11	12.70	13.97	21	25.40	26.67
2	1.27	2.54	12	13.97	15.24	22	26.67	27.94
3	2.54	3.81	13	15.24	16.51	23	27.94	29.21
4	3.81	5.08	14	16.51	17.78	24	29.21	30.48
5	5.08	6.35	15	17.78	19.05	25	30.48	31.75
6	6.35	7.62	16	19.05	20.32	26	31.75	33.02
7	7.62	8.89	17	20.32	21.59	27	33.02	34.29
8	8.89	10.16	18	21.59	22.86	28	34.29	35.56
9	10.16	11.43	19	22.86	24.13	29	35.56	36.83
10	11.43	12.70	20	24.13	25.40	30	36.83	38.10
						31	38.10	39.37
						32	39.37	40.64
						33	40.64	41.91
						34	41.91	43.18
						35	43.18	44.45
						36	44.45	45.72
						37	45.72	46.99
						38	46.99	48.26
						39	48.26	49.53
						40	49.53	50.80
						41	50.80	52.07
						42	52.07	53.34
						43	53.34	54.61
						44	54.61	55.88
						45	55.88	57.15
						46	57.15	58.42
						47	58.42	59.69
						48	59.69	60.96
						49	60.96	62.23
						50	62.23	63.50

X-ON Electronics

Largest Supplier of Electrical and Electronic Components

Click to view similar products for [Headers & Wire Housings](#) category:

Click to view products by [Kinghelm](#) manufacturer:

Other Similar products are found below :

[0015917161](#) [0022155065](#) [57102-F02-18ULF](#) [58102-G61-06LF](#) [582553-1](#) [01.001.5753.1](#) [0050291907](#) [02.125.8002.8](#) [609-3404](#) [61062-3](#)
[CSU011177004](#) [622-0430](#) [622-3653LF](#) [63453-116](#) [636-1030](#) [636-1427](#) [636-3427](#) [636-4007](#) [641938-9](#) [65495-038](#) [65692-001LF](#) [65781-018](#)
[65781-047](#) [65817-010LF](#) [65817-015LF](#) [67095-007LF](#) [67601157](#) [68631-112](#) [68645-018](#) [699319-000](#) [70.362.1628.0](#) [70-4210](#) [70-4226B](#) [70-](#)
[4853B](#) [71.350.2428.0](#) [733-134](#) [733-162](#) [760-3052](#) [MHR-64-VUAL](#) [80.063.4001.1](#) [800-90-001-10-001000](#) [801-43-002-10-013000](#)
[801-43-006-10-002000](#) [803-43-024-10-001000](#) [803-93-012-10-001000](#) [8-1437020-4](#) [819-22-004-30-001101](#) [820-22-006-30-001101](#)
[820-22-008-30-001101](#) [821-22-002-10-001101](#)