

REVISION RECORD			
REV	ECO	DESCRIPTION	DRFT

NOTES:

MATERIAL :

- 1 HOUSING MATERIAL
- 2 CONTACT MATERIAL
- 3 PLATING
- 4 SHIELD
- 5 LED

- ELECTRICAL:
- 1 VOLTAGE RATING :125 VAC RMS.
 - 2 CURRENT RATING :1.5 AMP.
 - 3 CONTACT RESISTANCE :30 MILLIOHMS MAX.
 - 4 INSULATION RESISTANCE :500 MEGOHMS MIN @ 500V DC.
 - 5 DIELECTRIC WITHSTANDING RESISTANCE :1000V AC RMS 50HZ 1MIN.

- MECHANICAL:
- 1 DURABILITY :750 CYCLES MIN.
 - 2 PCB RETENTION PRE-SOLDER :1LB MIN.
- ENVIRONMENTAL:
- 1 STORAGE : -40°C~+85°C
 - 2 OPERATION : 0°C TO 70°C
- PART NUMBER:

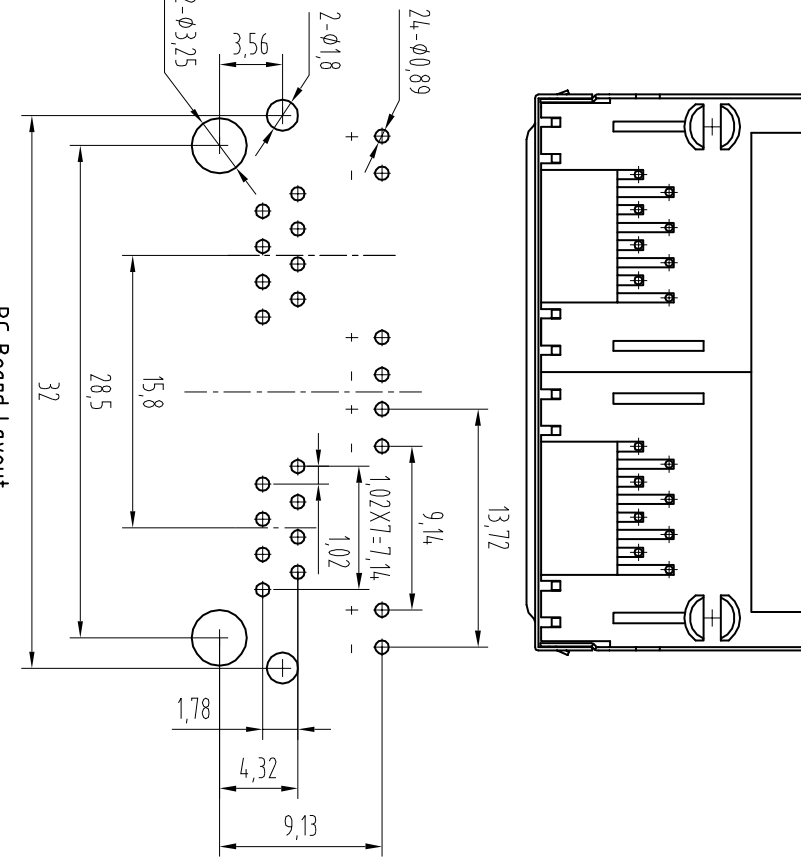
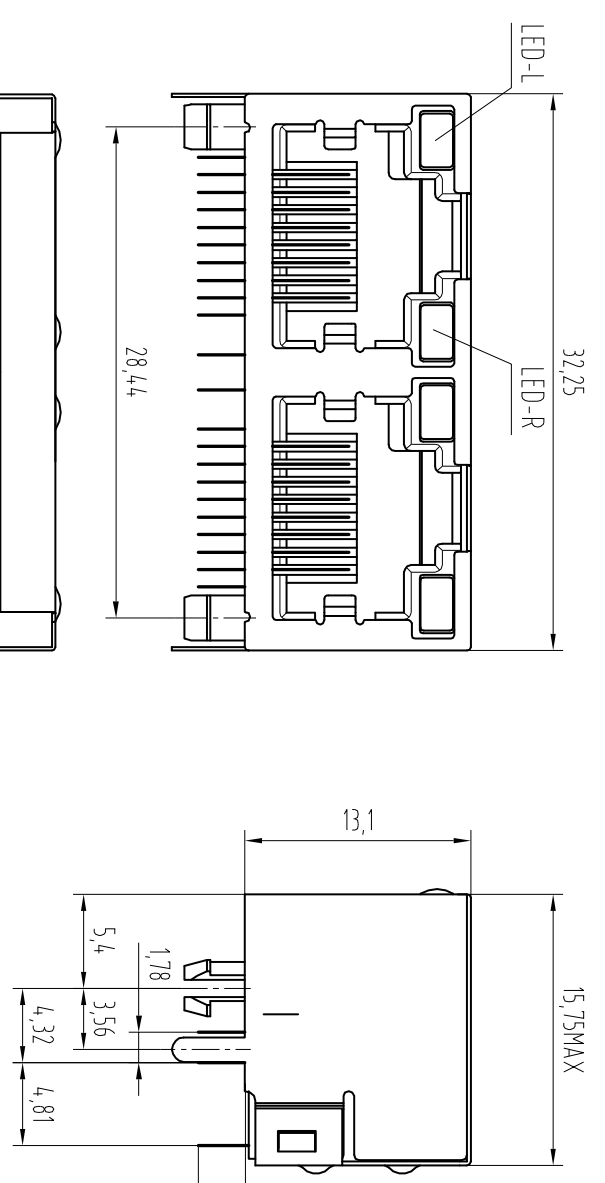

POSITIONS	CONTACTS	PORTS	LED STYLE	SHIELD	BACK PEG	PLASTIC	LOGO	GOLD PLATING
8-8 POSITIONS	1-4 CONTACTS 6-6 CONTACTS 8-8 CONTACTS	1-1X1 2-1X2 4-1X4 5-1X5 6-1X6 8-1X8	0-W/O LED 1-V/G 2-G/Y 3-R/G 4-G/R 5-Y/Y 6-G/G 7-OTHERS	0-W/O SHIELD 1-SHIELD W/ EMI 2-SHIELD W/O EMI	0-W/O BACK PEG 1-1 BACK PEG 2-2 BACK PEG	1-PBT 2-NYLON66 3-NYLON66	0-W/O LOGO 1-W/ 2P 2-W/ 1U 3-W/ 2P+8UL	1-15μ" 2-30μ" 3-60μ" 4-150μ" 5-300μ" 6-500μ"

DETACHED LISTS		DATE		DATE	
MM	J 4 415	DRFD SHB	20080315	CHKD LMBD	20080315
MM	JH 4 415	PRO		APRVL	
MM	JH 4 415	APRVL		DATE	

TOLERANCES UNLESS AS NOTED	
MM	± 0.15
MM	± 0.15
MM	± 0.15

ANGLES ± 0.5	
MM	± 0.5

THIRD ANGLE PROJECTION	
SCALE :	

TITLE	
深圳市金航标电子有限公司	WWW.BDS666.COM
KH-56-8P8C-1X2-D	0755-83044319
SJA SERIES 1X2 LED JACK SHIELDED	

DRAWING NO. TESJA106	
PART NO.	SIZE
DO NOT SCALE DRAWING	A3

SHEET	
X	OF

X-ON Electronics

Largest Supplier of Electrical and Electronic Components

Click to view similar products for [Modular Connectors](#) / [Ethernet Connectors](#) category:

Click to view products by [Kinghelm](#) manufacturer:

Other Similar products are found below :

[8949-H88/06BLKA/SN](#) [74441-0010/BKN](#) [PHP-6P6C-5](#) [GAX-3-66](#) [GDCX-PN-66](#) [GLX-A-44](#) [GLX-N-1010M-BLK](#) [GLX-S-88M-BLK](#)
[GMX-SMT4-N-88](#) [GSGX-N-2-88](#) [GSGX-N-4-88](#) [GSX-NS2-88-3.05](#) [GSX-NS-88-3.68](#) [PT-108A-8C-UL](#) [PTS-J531-8CS-50UL](#) [A-2014-0-4](#)
[GWLX-S9-88-YG](#) [DC-1021-8-WH-6](#) [1300530003](#) [1324640-4](#) [132764-001](#) [1413235](#) [MPS88RX-5000](#) [E5288-S000K3-L](#) [155302-001](#)
[AX101050](#) [AX101063](#) [AX101065](#) [AX101072](#) [AX101307](#) [AX101315](#) [AX101318](#) [AX102271](#) [AX102277](#) [AX102651](#) [AX102660](#) [AX104024](#)
[203475](#) [J0026D01ENL](#) [PC4D0018P](#) [KIT38082NI](#) [8949-B88/6](#) [2-6609208-5](#) [30-8956](#) [30-8964-100](#) [SM85](#) [17-103540](#) [191587](#) [PDI-68-RV](#)
[PHP-8P8C-S-5](#)