

| 版本<br>REV. | 日期<br>DATE | ECN NO. | 变更内容<br>DESCRIPTION | 制图<br>DRAWN |
|------------|------------|---------|---------------------|-------------|
|            |            |         |                     |             |

SPECIFICATIONS

- 1、Current Rating: 3A AC, DC
- 2、Voltage Rating: 250V AC, DC
- 3、Temperatuer Range: -25°C~+85°C
- 4、Contact Resistance: 30mΩ Max
- 5、Insulation Resistance: 1000MΩ Min
- 6、Withstanding Voltang: 800V AC/minute
- 7、Material:Housing PA66, UL94V-0

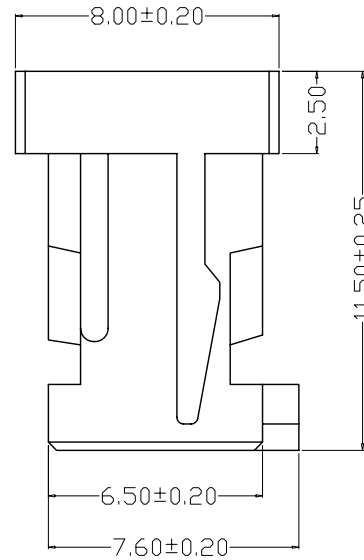
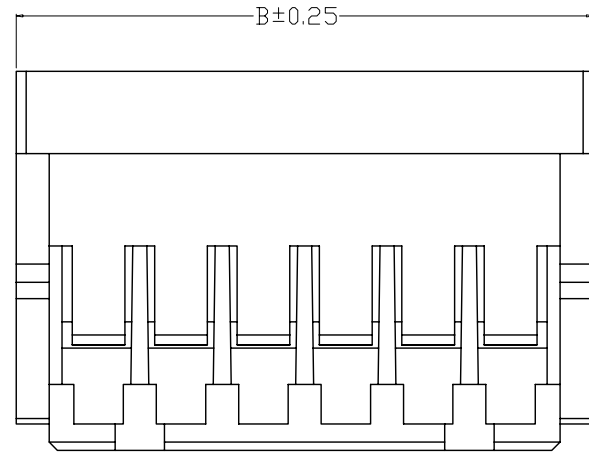
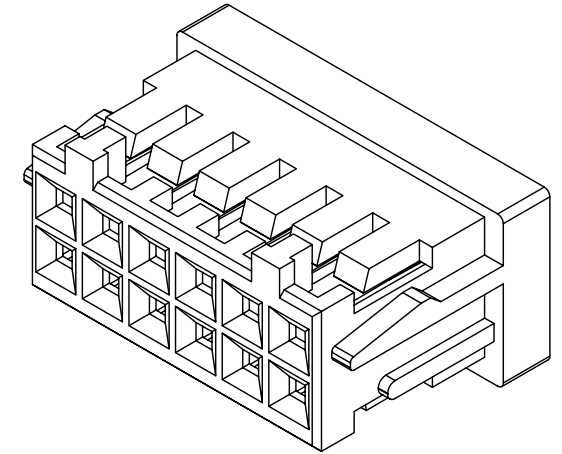
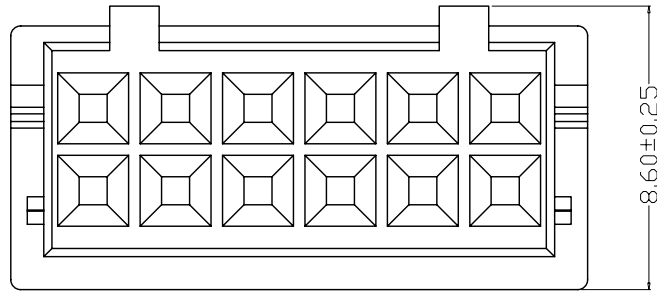

| 编 号         | 尺寸 (mm) |       |
|-------------|---------|-------|
|             | A       | B     |
| A2557-2*02Y | 2.50    | 7.50  |
| A2557-2*03Y | 5.00    | 10.00 |
| A2557-2*04Y | 7.50    | 12.50 |
| A2557-2*05Y | 10.00   | 15.00 |
| A2557-2*06Y | 12.50   | 17.50 |
| A2557-2*07Y | 15.00   | 20.00 |
| A2557-2*08Y | 17.50   | 22.50 |
| A2557-2*09Y | 20.00   | 25.00 |
| A2557-2*10Y | 22.50   | 27.50 |
| A2557-2*11Y | 25.00   | 30.00 |
| A2557-2*12Y | 27.50   | 32.50 |
| A2557-2*20Y | 47.50   | 52.50 |

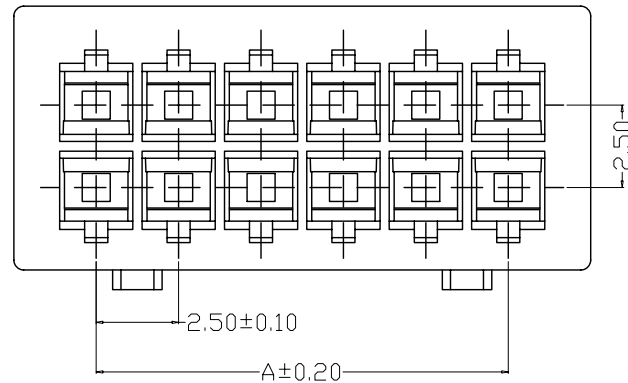

|                   |        |          |            |       |              |                |                      |               |     |
|-------------------|--------|----------|------------|-------|--------------|----------------|----------------------|---------------|-----|
| GENERAL TOLERANCE |        | 制图       | 钱岳生        |       | 料号           | A2557-2*02nY   |                      | 版本            | A   |
| X.X±0.25          | X.*±2' | DRAWING  | 2016、09、22 |       | PART NO.     | XHD2.5孔座       |                      | REV.          | 1/1 |
| X.XX±0.20         |        | 审核       | 张名         |       | TITLE        |                |                      | SHEET         |     |
| X.XXX±0.10        |        | CHECK    | 2016、09、23 |       | 客户料号         |                |                      |               |     |
|                   |        | 核准       | 张名         |       | CUTM. NO.    |                |                      |               |     |
|                   |        | APPROVAL | 2016、09、24 |       | 深圳市金航标电子有限公司 |                | www.kinghel.m.com.cn |               |     |
|                   |        | 单位       | MM         | 比例    | 1:1          | KH-A2557-2X07Y |                      | 0755-28190160 |     |
|                   |        | UNITS    |            | SCALE |              |                |                      |               |     |

## X-ON Electronics

Largest Supplier of Electrical and Electronic Components

*Click to view similar products for [Headers & Wire Housings](#) category:*

*Click to view products by [Kinghelm](#) manufacturer:*

Other Similar products are found below :

[57102-F02-18ULF](#) [58102-G61-06LF](#) [582553-1](#) [009176003701906](#) [01.001.5753.1](#) [0050291907](#) [02.125.8002.8](#) [609-3404](#) [61062-3](#)  
[CSU011177004](#) [622-0430](#) [622-3653LF](#) [63453-116](#) [636-1030](#) [636-1427](#) [636-3427](#) [636-4007](#) [641938-9](#) [644827-2](#) [65495-038](#) [65692-001LF](#)  
[65781-018](#) [65781-047](#) [65817-010LF](#) [65817-015LF](#) [66207-023LF](#) [67095-007LF](#) [67601157](#) [68631-112](#) [68645-018](#) [699319-000](#)  
[M90C108951C](#) [70.362.1628.0](#) [70-4210](#) [70-4226B](#) [70-4853B](#) [707-5028](#) [71.350.2428.0](#) [71961-016LF](#) [733-134](#) [733-162](#) [754199-000](#) [760-](#)  
[3052](#) [80.063.4001.1](#) [800-90-001-10-001000](#) [800-90-010-10-002000](#) [801-43-002-10-013000](#) [801-43-006-10-002000](#) [803-41-018-10-001000](#)  
[803-43-024-10-001000](#)