

PCB LAYOUT
S=2:1

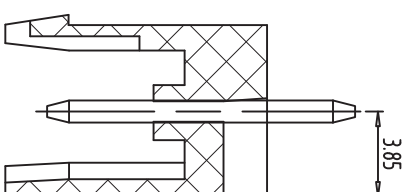

SECTION:A-A

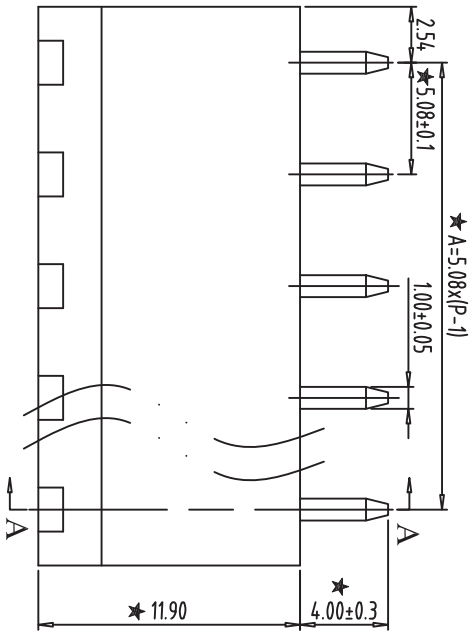
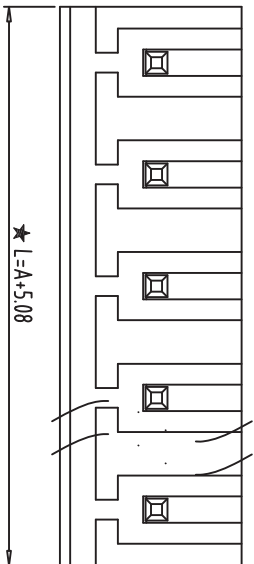
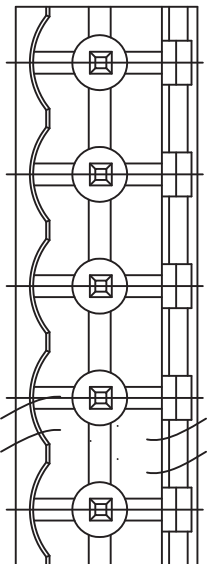
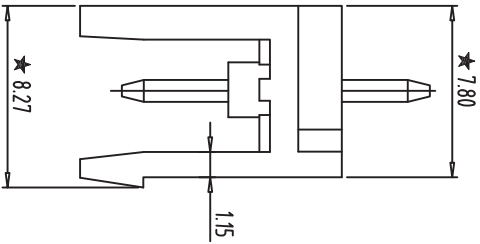

- NOTES:
1. Rating:300V 15A ;
 2. Insulation Withstands Voltage: AC2000V/MIN
 3. Insulation Resistance: 500MΩ or more at DC500V
 4. Using Temperature Range: -40°C~+105°C
 5. "★" is the important dimension
 6. RoHS compliance

Total Pitch Tolerances		Nominal dimension range																																				
In mm		In mm																																				
0	to	0	to	30	to	53	to	70	to	90	to	115	to	150	to	200	to	250	to	320	to	10	to	100	to	150	to	0.2	to	0.3	to	0.3	to	0.2	to	0.3	to	0.5

Total Pitch Tolerances		Nominal dimension range																																										
In mm		In mm																																										
±0.18	to	±0.25	to	±0.3	to	±0.35	to	±0.44	to	±0.60	to	±0.70	to	±0.85	to	±0.20	to	±0.25	to	±0.30	to	±0.35	to	±0.44	to	±0.55	to	±0.70	to	±0.80	to	±0.90	to	0.2	to	0.3	to	0.3	to	0.2	to	0.3	to	0.5

REV	CONTENT	CHK	DATE
V0.0	CONTENT	SK	2014/08/19

ITEM	NAME OF PART	NO. OF PART	Q'TY	MATERIAL	NOTE
DWG	SK	DATE 2014/08/19	SIZE A4	UNITS mm	SHEET/OF 1/1
CHK	DATE		SCALE 3:1		2EDG-5.08
APP.	DATE		NAME		

深圳市金航标电子有限公司
KH-F400V-6P-5.08G
WWW.BDS666.COM
0755-83044319

X-ON Electronics

Largest Supplier of Electrical and Electronic Components

Click to view similar products for [Pluggable Terminal Blocks](#) category:

Click to view products by [Kinghelm](#) manufacturer:

Other Similar products are found below :

[57.510.0053](#) [721-104/026-047](#) [721-204/026-045](#) [MC 1.5/ 6-ST-3.5 GY AU](#) [ET02015000J0G](#) [860505](#) [860516](#) [860810](#) [GBPACX-12](#)
[93.731.4953.0](#) [PVP03-3,50](#) [PVS02-5,00](#) [1-1986160-3](#) [1377680000](#) [1531000000](#) [1546228-5](#) [ELFP03110](#) [ELFP10210](#) [ELFT07250](#)
[ELVD12100](#) [ELVF09400](#) [ELXH071G0E](#) [1725220000](#) [1760336](#) [1855000000](#) [19346](#) [1946309](#) [1973592](#) [19892](#) [25.320.4053.1](#) [25.320.4553.9](#)
[25.320.4753.1](#) [25.320.5453.1](#) [25.340.0353.1](#) [25.340.1053.1](#) [25.345.3553.0M001](#) [25.640.3553.1](#) [SH02-5,08](#) [SH06-3,81](#) [SH08-5,08](#) [SH08-](#)
[5,08-K](#) [SH12-5,08](#) [SHS04-5,00](#) [30.303](#) [30.305](#) [30.306](#) [PHP09-5,08](#) [25.193.0453.0](#) [25.320.4653.1](#) [25.332.2453.1](#)